



# INSTRUCTIONS

J05153

2010-04-26



## SOFTAIL SOLO SEAT KITS

### GENERAL

#### Kit Number

54380-11, 54381-11

#### Models

For model fitment information, see the P&A Retail Catalog or the Parts and Accessories section of [www.harley-davidson.com](http://www.harley-davidson.com) (English only).

#### ⚠ WARNING

Rider and passenger safety depend upon the correct installation of this kit. Use the appropriate service manual procedures. If the procedure is not within your capabilities or you do not have the correct tools, have a Harley-Davidson dealer perform the installation. Improper installation of this kit could result in death or serious injury. (00333b)

#### Kit Contents

There are no service parts available with this kit.

### INSTALLATION

#### For Vehicles Equipped with Stock Solo Seat

##### NOTE

When a solo seat is installed without a passenger seat, the passenger footpegs or footboards and the passenger grabstrap must be removed.

1. See Figure 1. Remove the seat per owner's manual instructions. Retain hardware.

#### ⚠ WARNING

After installing seat, pull upward on seat to be sure it is locked in position. While riding, a loose seat can shift causing loss of control, which could result in death or serious injury. (00070b)

2. Install the new solo seat by sliding seat into position until front tab engages frame and secure rear seat bracket to fender with fasteners saved in step 1.
3. If installing seat with a passenger pillion refer to pillion instruction sheet to install pillion and grab strap.

#### For Vehicles Equipped with Stock 2-UP seat

1. See Figure 2. Remove the seat per owner's manual instructions. Retain hardware.

2. Remove grab strap and mounting hardware. Retain grab strap and hardware. If installing seat with a passenger pillion refer to pillion instruction sheet to install pillion and grab strap.

#### ⚠ WARNING

After installing seat, pull upward on seat to be sure it is locked in position. While riding, a loose seat can shift causing loss of control, which could result in death or serious injury. (00070b)

3. Slide the new solo seat into position until front tab engages frame and secure bracket to fender using fasteners saved in step 1.

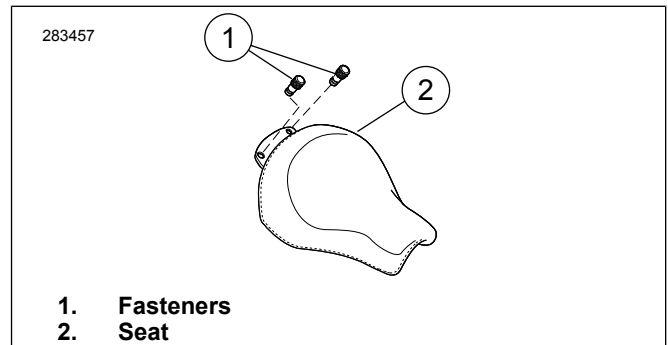

Figure 1. Solo Seat

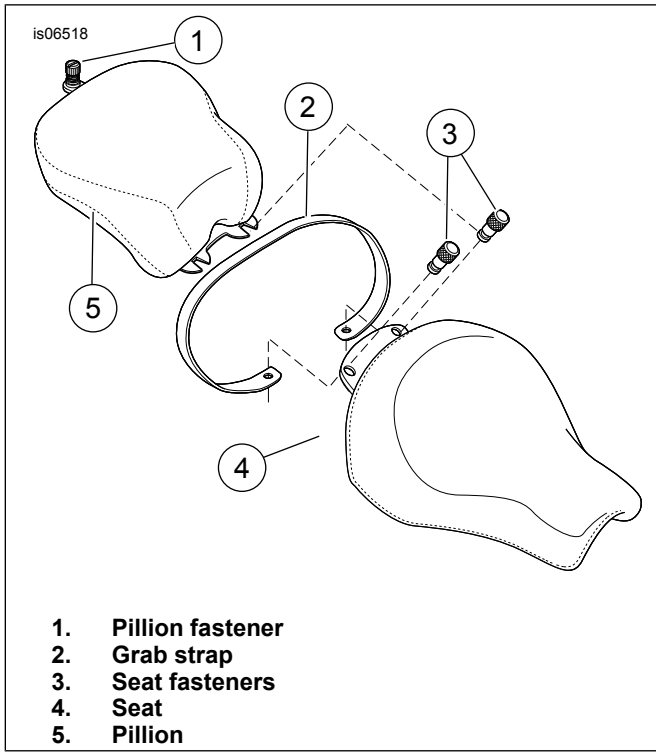

Figure 2. 2-Up Seat