



# INSTRUCTIONS

J05654

2016-07-01



## ENGINE GUARD KIT

### GENERAL

It is **strongly advised** that this kit be installed by an authorized Harley-Davidson dealer.

### Kit Number

49000015B, 49000047B

### Models

For model fitment information, see the P&A retail catalog or the Parts and Accessories section of [www.harley-davidson.com](http://www.harley-davidson.com) (English only).

### Installation Requirements

#### ⚠ WARNING

**Rider and passenger safety depend upon the correct installation of this kit. If the procedure is not within your capabilities or you do not have the correct tools, have a Harley-Davidson dealer perform the installation. Improper installation of this kit could result in death or serious injury. (00308b)**

#### NOTE

*This instruction sheet refers to service manual information. A service manual for this year/model motorcycle is available from a Harley-Davidson dealer.*

### Kit Contents

See Figure 1 and Table 1.

### PREPARATION

1. See the service manual and remove the main fuse.

2. See the service manual and remove front upper engine mount screws (two each side) and nut plate assemblies. Discard hardware.

#### NOTE

*Left engine mount screws also secure horn bracket.*

3. Remove existing engine guard, if equipped.

### INSTALLATION

#### NOTE

- Do not tighten hardware until all hardware is installed.
- Do not damage wiring when securing upper guard brackets.

1. See Figure 1. Secure right guard and engine mount using the hardware (3, 4) provided.
2. Secure upper guard bracket to frame with hardware (5, 6).
3. **2015 and earlier:** Secure left guard, horn bracket and engine mount using hardware (4, 5, 6, 7). **2016 and later:** Secure left guard, horn bracket and engine mount using hardware (4, 5, 6, 7, 8).
4. Tighten the upper hardware (5, 6) to 22.5–27.5 N·m (17–20 ft-lbs).
5. Tighten the lower hardware (3, 4, 7) to 42.7–47.3 N·m (32–35 ft-lbs).
6. Verify the starter cable is routed downward and is at least 6.4 mm (1/4 in) from the end of the right side screws.
7. See the service manual and install the main fuse.

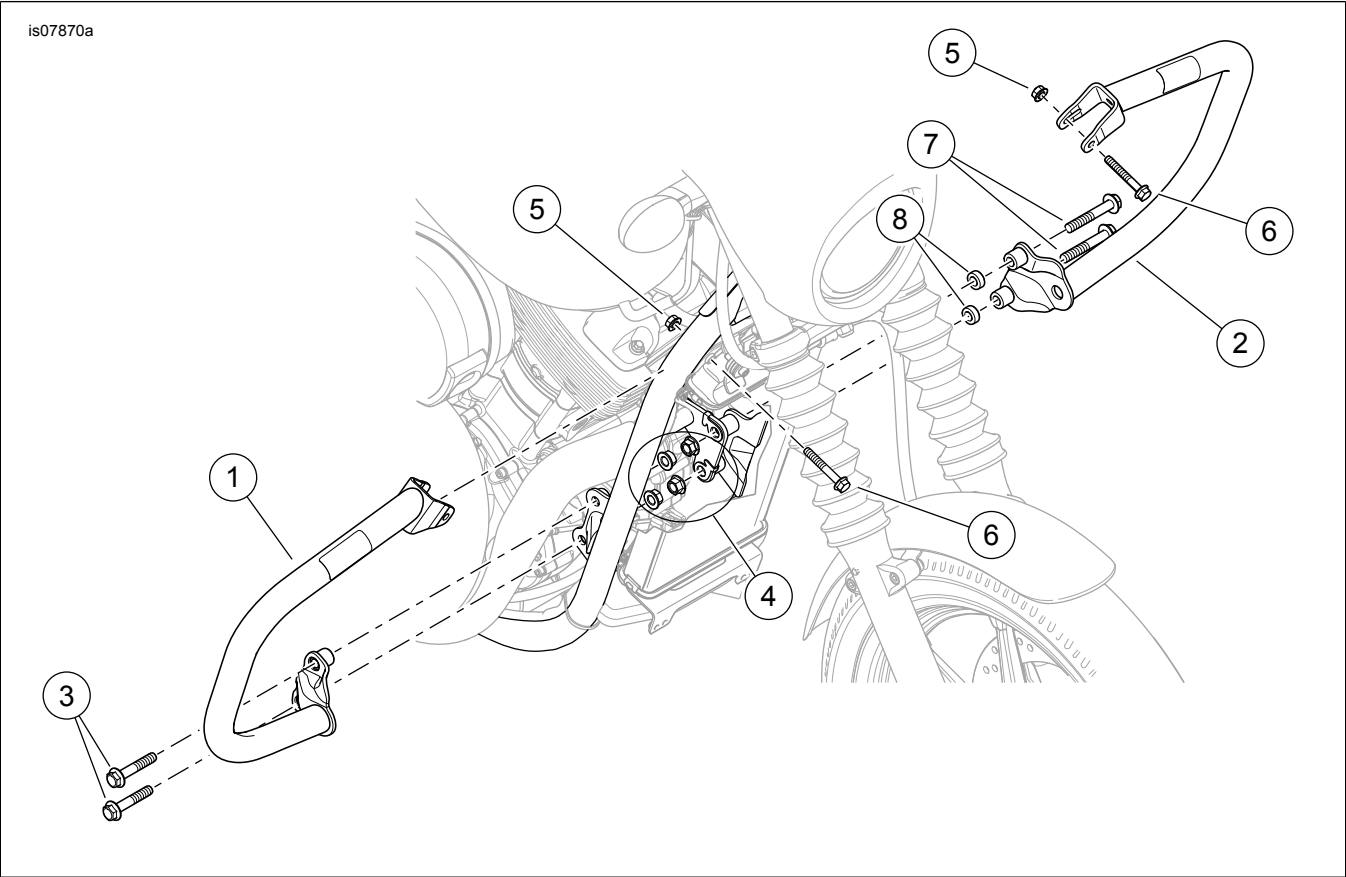

Figure 1. Kit Contents: Engine Guard Kit

Table 1. Kit Contents

Item	Description (Quantity)	Part Number
1	Guard weldment, right	Not Sold Separately
2	Guard weldment, left	Not Sold Separately
3	Screw, right, M10 x 1.5 x 60 (2)	10200244
4	Flange Locknut, M10 x 1.5 (4)	10100045
5	Flange Locknut, M8 x 1.25 (2)	10100042
6	Screw, M8 x 1.25 x 55 (2)	10200247
7	Screw, left, M10 x 1.5 x 70 (2)	10200245
8	Spacer (2)	10300110