



INSTRUCTIONS

J05248

2010-10-25



XL REAR AXLE COVER KIT

GENERAL

Kit Number

46399-05A, 43013-09A

Models

For model fitment information, see the P&A Retail Catalog or the Parts and Accessories section of www.harley-davidson.com (English only).

Kit Contents

See Figure 1 and Table 1.

NOTE

It may be necessary to change the orientation of the axle or axle nut to provide clearance for the cover.

INSTALLATION

1. Verify that the flat of the axle nut is parallel to the top of the swingarm. If it is not, then perform the following:
 - a. Loosen the axle nut and rotate the axle.
 - b. Tighten the axle nut to 98–106 N·m (72–78 ft-lbs). Verify that the axle nut is oriented properly and that the axle cover fits over it.
 - c. Repeat if necessary until the necessary orientation has been achieved.
2. Place axle covers in position over ends of swingarm. When oriented on the proper side of the motorcycle, the Bar&Shield logo will be in the upright position.
3. Start installing the top screw to the mounting strap (3). After the threads of the top screw have started into the mounting strap, begin to install the lower screw. Tighten the screws, alternating from the top screw to the bottom screw, to 2.8–3.4 N·m (25–30 in-lbs).

SERVICE PARTS

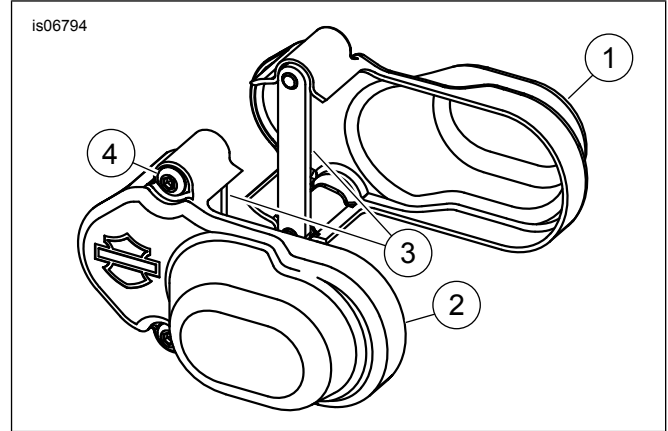

Figure 1. Service Parts: XL Rear Axle Cover Kit

Table 1. Service Parts: XL Rear Axle Cover Kit

Item	Description (Quantity)	Part Number
1	Axle cover, right	Not Sold Separately
2	Axle cover, left	Not Sold Separately
3	Mounting strap (2)	Not Sold Separately
4	Screw with threadlock, #10-32 x 1.0 in (chrome) (4)	Not Sold Separately

