



# INSTRUCTIONS

J05904

2013-12-15



## CRUISER CRADLE E-TRACK ADAPTER

### GENERAL

#### Kit Number

92900043

#### Models

The Harley-Davidson E-Track Adapter can be used with the CRUISER CRADLE TRAILER WHEEL CHOCK (part no. 92900042) or CRUISER CRADLE WHEEL CHOCK (part no. 92900001).

#### Kit Contents

See Figure 2 for kit contents.

There are no service parts available with this kit.

### INSTALLATION

#### Install E-Track Adapter

##### ▲ WARNING

Properly tie down motorcycle when transporting. Failure to secure properly can cause motorcycle to tip or fall which could cause death or serious injury. (00617c)

##### NOTE

- The E-Track Adapter and Wheel Chock are not designed to hold your motorcycle in-place during transportation without the use of ratcheting tie downs. When using the E-Track Adapter, make sure to use four straps when tying down your motorcycle.
  - Only install the wheel chock on a well-maintained trailer or vehicle which is rated to carry the motorcycles weight. See the motorcycle's owner's manual for vehicle weights.
1. Make sure the center-to-center distances of the E-track adapter is no less than the width of the wheel chock and no farther apart than 1.17 m (46 in). The E-Track Adapter can be adjusted to a minimum width of 0.69 m (27 in) and a maximum width of 1.17 m (46 in).

2. See Figure 2. Insert the small square tube (1) into the large square tube (2). If the smaller tube does not slide all the way into the larger tube, rotate the smaller tube 90 degrees then install.
3. **Wheel Chock (92900001):** Slide bracket without locking pin (3) on end of large tube. Slide bracket with locking pin (4) on large tube. Install small bracket (10) over end of small tube. **Wheel Chock (92900042):** Slide bracket with locking pin (4) on end of large tube. Slide bracket without locking pin (3) on large tube. Install small bracket (10) over end of small tube.

##### NOTE

*In next step, make sure that the clips face the same direction.*

4. Insert the pin (5) through one E-track clip (6) then through bracket (7). Install another clip onto end of pin. Insert pin clip into the pin. Repeat this process for other end.
5. Attach the clip assemblies to the end of the tubes using the two shoulder bolts (9). Place the bolt through either slot of the E-track bracket vertical slot and thread into the end of the square tube. Tighten securely.

#### Install Cruiser Cradle Wheel Chock (92900001)

##### NOTE

- See Figure 1. Boomerang Bar (6) does not have non-skid material adhered to the bottom of the bar. It is not intended for use without the E-track adapter.
1. See Figure 1. Position wheel chock (4) over the outside brackets (1 and 3) of the E-Track (2). Align wheel chock mounting holes with bracket threaded holes. Slide mounting brackets as necessary for proper alignment.
  2. Secure wheel chock to small tube bracket with screw (5).
  3. Secure wheel chock to large tube bracket with screw (5).
  4. Tighten both screws securely.



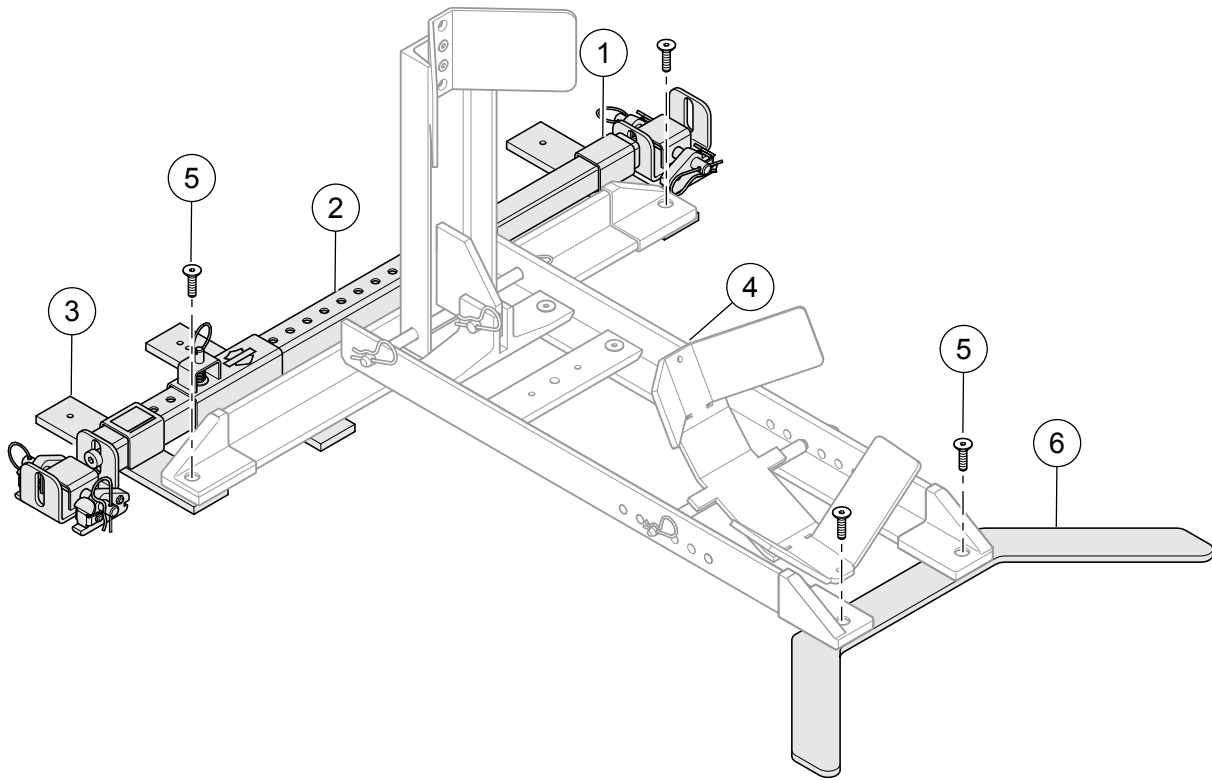

- |                                |                               |
|--------------------------------|-------------------------------|
| 1. Small bracket               | 4. Cruiser Cradle Wheel Chock |
| 2. E-Track Adapter             | 5. Screw                      |
| 3. Bracket without locking pin | 6. Boomerang bar              |

Figure 1. Mounting Cruiser Cradle Wheel Chock

## Install Cruiser Cradle Trailer Wheel Chock (92900042)

### NOTE

Make sure that all 4 E-track clips are securely locked into the tracks before mounting the wheel chock.

1. Pull back the locking lever on the end of the clips and insert the end into tracks. Then lower and insert the other end of the clip. After lowering the clips, make sure to slide the clips side-to-side to verify that the locking lever is securely locked in place.

### NOTE

- Boomerang Bar (11) does not have non-skid material adhered to the bottom of the bar. It is not intended for use without the E-track adapter.
- To complete the next steps, see the instructions for the CRUISER CRADLE WHEEL CHOCK (part number 92900042).

2. Using the button head screws, attach the boomerang bar to the rear of the wheel chock.
3. Remove the front-stop channel from the wheel chock.
4. Position the wheel chock over the E-track brackets and align with the threaded hole.
5. Starting at the bracket with locking pin, insert a button head screw through the holes located next to the upwards bent tab on the base of the wheel chock. Do not tighten screw.
6. Align the chock to the bracket without locking pin. Slide the bracket to the hole location on the wheel chock or slide the chock to the bracket with locking pin.
7. Install the remaining button head screw. Tighten both screws.
8. Attach the front-stop channel to the wheel chock.

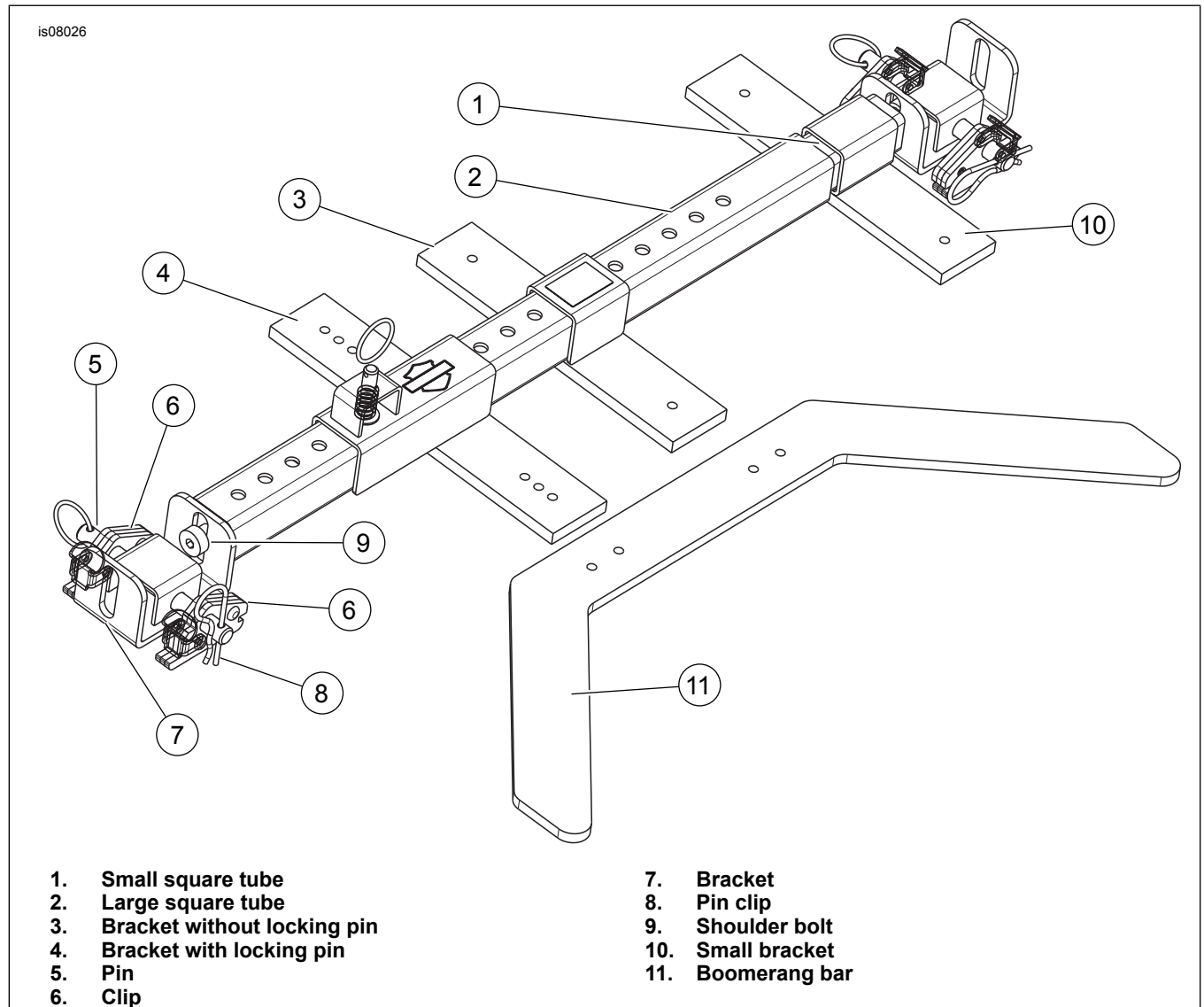

Figure 2. E-Track Adapter