



# INSTRUCTIONS

J05343

2015-11-23



## XL DRAG HANDLEBAR

### GENERAL

#### Kit Number

55800035A

#### Models

For model fitment information, see the P&A Retail Catalog or the Parts and Accessories section of [www.harley-davidson.com](http://www.harley-davidson.com) (English only).

#### Additional Parts or Accessories Required

**Separate purchase** of additional parts or accessories is required for proper installation of this handlebar kit on your model motorcycle. Refer to the latest Harley-Davidson Genuine Motor Accessories and Genuine Motor Parts catalog for a list of required parts or accessories for your model.

Fresh, uncontaminated brake fluid will also be needed. Refer to your owner's manual or the service manual to determine the correct brake fluid.

#### ⚠ WARNING

**Replace brake line gaskets. Re-using original gaskets can cause brake failure and loss of vehicle control, which could result in death or serious injury. (00318a)**

Motorcycles equipped with a **glued** left-side hand grip will require a new grip, sold separately. Refer to the Parts Catalog for replacement stock hand grips.

Ask a Harley-Davidson dealer about the selection of Genuine Motor Accessory hand grips that are available.

#### ⚠ WARNING

**Rider and passenger safety depend upon the correct installation of this kit. Use the appropriate service manual procedures. If the procedure is not within your capabilities or you do not have the correct tools, have a Harley-Davidson dealer perform the installation. Improper installation of this kit could result in death or serious injury. (00333b)**

#### NOTE

*This instruction sheet references service manual information. A service manual for your model motorcycle is required for this installation and is available from a Harley-Davidson dealer.*

#### Kit Contents

See Figure 2 and Table 2.

### REMOVAL

1. See the service manual and remove the main fuse, original equipment (OE) handlebar, clutch and throttle/idle cables and front brake lines.
2. See Figure 1. Loosen pinch bolt (3).
3. Remove fork stem bolt (1) and fork stem washer (2) from the upper fork bracket (4).

### INSTALLATION

#### NOTE

*Proper installation of this kit requires installation of a new fork stem washer and a steering head fall-away measurement and adjustment. See the service manual for the fall-away procedure, but use the specifications included in the procedure below.*

1. See Figure 1. Install new fork stem bolt (1) and fork stem washer (2) from the handlebar kit to the upper fork bracket (4). The fork stem washer is installed with the engraved face up.
2. See the service manual. Perform the Fall-Away Adjustment according to the instructions included in the service manual using the specifications found in Table 1.

#### NOTE

*When installing the XL Drag Handlebar, make sure that there is adequate clearance between the handlebar and the fuel tank.*

3. The XL Drag Handlebar installs in the same manner as the OE handlebar. See the service manual and install the new handlebar according to those instructions.

#### NOTE

*Route throttle/idle cables to the rear of the front forks.*

4. Install the new clutch cables, throttle/idle cables and front brake lines according to the instruction sheets included in those kits.

#### NOTE

*When routing and securing control wires, make sure to leave enough slack that wires do not pull tight at either steer stop.*

5. See the service manual. Install the left and right hand controls.
6. Install the hand grips according to the instruction sheets included in that kit.



**Table 1. Drag Handlebar Fall-Away Specifications**

Model	Model Years	Minimum		Maximum	
		inch	mm	inch	mm
XL883N	2007-2015	2.5	63.5	3.0	76.2
	2016-later	7.0	177.8	8.0	203.2
XL883L	2007-2010	2.5	63.5	3.0	76.2
XL1200N	2007-2012	2.5	63.5	3.0	76.2
XL1200V	2012-later	2.5	63.5	3.0	76.2
XL1200X	2010-2015	2.5	63.5	3.0	76.2
	2016-later	7.0	177.8	8.0	203.2

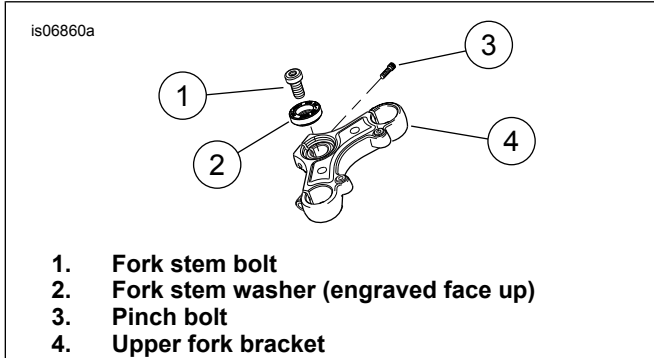

**Figure 1. Fork Stem Bolt and Fork Stem Washer**

**SAFETY CHECK**

**⚠ WARNING**

Be sure that steering is smooth and free without interference. Interference with steering could result in loss of vehicle control and death or serious injury. (00371a)

- Be sure throttle/idle control cables do not pull tight when handlebars are turned fully to left or right fork stops.
- 1. Verify that wires, clutch cables, throttle/idle cables and brake lines do not pull tight when handlebars are turned fully to left or right fork stops.
- 2. Verify that there is adequate clearance between the handlebar and the fuel tank when the handlebars are turned to the left and right stops.
- 3. Verify that the ignition/light key switch is turned to the OFF position.
- 4. Install the main fuse.

**⚠ WARNING**

Be sure that all lights and switches operate properly before operating motorcycle. Low visibility of rider can result in death or serious injury. (00316a)

- 5. Turn the ignition/light key switch to IGNITION, but do not start the engine. Test each handlebar switch for proper operation.

**⚠ WARNING**

Before starting engine, be sure throttle control will snap back to idle position when released. A throttle control that prevents engine from automatically returning to idle can lead to loss of control, which could result in death or serious injury. (00390a)

**SERVICE PARTS**

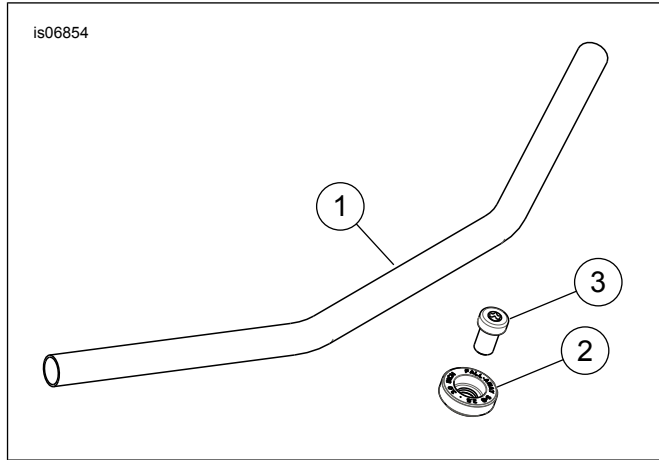

**Figure 2. Service Parts: XL Drag Handlebar**

**Table 2. Service Parts**

Item	Description (Quantity)	Part Number
1	Handlebar	Not Sold Separately
2	Fork stem washer	Not Sold Separately
3	Fork stem bolt	4993