



INSTRUCTIONS

J05374

2011-07-29



FLHX/FLTRX LED REAR AUXILIARY LAMP

GENERAL

Kit Number

68000029

Models

For model fitment information, see the P&A retail catalog or the Parts and Accessories section of www.harley-davidson.com (English only).

Service Manual Required

⚠ WARNING

Rider and passenger safety depend upon the correct installation of this kit. Use the appropriate service manual procedures. If the procedure is not within your capabilities or you do not have the correct tools, have a Harley-Davidson dealer perform the installation. Improper installation of this kit could result in death or serious injury. (00333b)

NOTE

This instruction sheet refers to service manual information. A service manual for this year/model motorcycle is required for this installation and is available from a Harley-Davidson dealer.

Electrical Overload

NOTICE

It is possible to overload the vehicle's charging system by adding too many electrical accessories. If the combined electrical accessories operating at any one time consume more electrical current than the vehicle's charging system can produce, the electrical consumption can discharge the battery and cause damage to the vehicle's electrical system. (00211d)

⚠ WARNING

When installing any electrical accessory, be certain not to exceed the maximum amperage rating of the fuse or circuit breaker protecting the affected circuit being modified. Exceeding the maximum amperage can lead to electrical failures, which could result in death or serious injury. (00310a)

This Rear Auxiliary Lamp kit requires up to **500 mA** additional current from the electrical system.

Kit Contents

See Figure 2 and Table 1.

PREPARATION

NOTE

For vehicles equipped with security siren:

- Verify that the Hands-Free Fob is present.
- Turn the ignition key switch to **IGNITION**.

⚠ WARNING

To prevent accidental vehicle start-up, which could cause death or serious injury, remove main fuse before proceeding. (00251b)

1. Refer to the service manual and follow instructions to remove the left-side saddlebag. Remove the main fuse.

INSTALLATION

1. See Figure 2. Assemble the auxiliary lamp bracket (2) to the auxiliary lamp (1) with two #8-32 screws (3) and lock washers (4) from the kit. Tighten securely.
2. Remove the two 5/16-18 hex head screws (D) holding the rear light bar (A) and license plate bracket (B) assembly to the rear fender.
3. Remove the two 1/4-20 TORX® screws and lock washers (C) holding the license plate bracket to the rear light bar assembly.
4. Position the auxiliary lamp and bracket assembly on top of the rear light bar assembly. Insert 1/4-20 TORX® screws and tighten to 6.8–9 N·m (60–80 in-lbs).
5. Route the auxiliary lamp wires through the rear fender grommet (E) alongside the rear lamp wires.
6. Fasten the rear light bar, assembly to the rear fender with the two 5/16-18 hex head screws removed earlier, and tighten to 9.5–16.2 N·m (84–144 in-lbs).
7. See Figure 1. Using cable straps to secure, route the auxiliary lamp wires,
 - a. under the fender (1),
 - b. over to the left-side under the rear fascia (2),
 - c. follow antenna lead (3),
 - d. upward in front of the saddlebag rear mounting bracket (4),
 - e. below the upper frame tube (5).



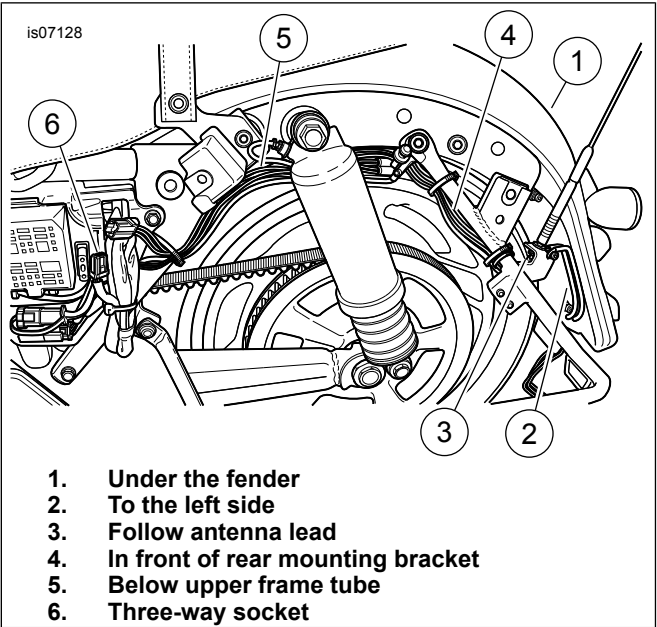

Figure 1. Auxiliary Lamp Wire Harness Routing

8. See Figure 2. Get the three-way pin housing (5) from the kit. Follow the instructions in the service manual appendix to insert the auxiliary lamp wires and terminals into the pin housing as follows:
- **Blue** wire to cavity 1.
 - **Red/yellow** wire to cavity 2.
 - **Black** wire to cavity 3.
9. See Figure 1. Connect the auxiliary lamp pin housing to the black three-way socket housing (6) located to the rear of the fuse panel.
10. Use 2 straps from the kit to secure the auxiliary lamp harness to existing harnesses routed along the frame.

RETURN TO SERVICE

NOTE

Verify that the ignition key switch is in the OFF position **before** installing the main fuse.

1. Refer to the service manual and follow the instructions to install the main fuse.
2. Turn the ignition key switch to IGNITION, but do not start the vehicle. Test for proper rear auxiliary lamp operation. Proper operation of auxiliary lamp is:
 - a. The rear auxiliary lamp is lit at all times when the ignition is ON.
 - b. With brake lever or brake pedal actuation, the rear auxiliary lamp will brighten.
3. Install the left-side saddlebag.

SERVICE PARTS

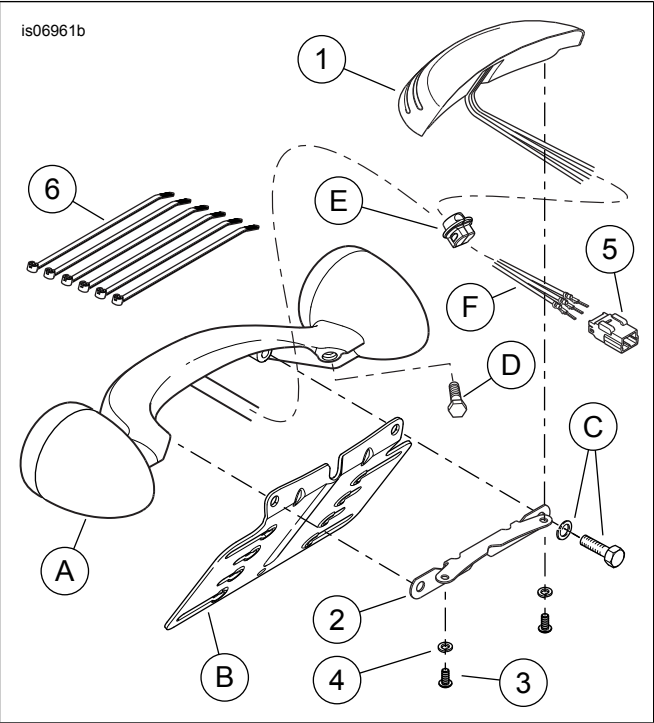

Figure 2. Service Parts, FLHX/FLTRX LED Rear Auxiliary Lamp

Table 1. Service Parts

Item	Description (Quantity)	Part Number
1	Rear auxiliary lamp assembly	Not sold separately
2	Bracket, rear auxiliary lamp	Not sold separately
3	Screw, #8-32 x 9.5 mm (3/8 in) long (2)	Not sold separately
4	Split lockwasher #8 (2)	Not sold separately
5	Three-way pin housing	73103-96BK
6	Cable strap (6)	10006
Items mentioned in text, but not included in kit.		
A	Rear light bar assembly	
B	License plate bracket	
C	1/4-20 TORX screw and lock washer (2)	
D	5/16-18 hex head screw (2)	
E	Rear fender grommet	