



# INSTRUCTIONS

J05378

2011-02-07



## TRIKE TOUR-PAK LUGGAGE INTERIOR LIGHT KIT

### GENERAL

#### Kit Number

69200289

#### Models

For model fitment information, see the P&A retail catalog or the Parts and Accessories section of [www.harley-davidson.com](http://www.harley-davidson.com) (English only).

#### Electrical Overload

##### NOTICE

It is possible to overload the vehicle's charging system by adding too many electrical accessories. If the combined electrical accessories operating at any one time consume more electrical current than the vehicle's charging system can produce, the electrical consumption can discharge the battery and cause damage to the vehicle's electrical system. (00211d)

##### ⚠ WARNING

When installing any electrical accessory, be certain not to exceed the maximum amperage rating of the fuse or circuit breaker protecting the affected circuit being modified. Exceeding the maximum amperage can lead to electrical failures, which could result in death or serious injury. (00310a)

The Tour-Pak® Interior Light Kit requires up to **33 milliamps** additional current from the electrical system.

#### Kit Contents

See Figure 5 and Table 1.

#### PREPARATION

##### NOTE

*For vehicles equipped with security siren:*

- Verify that the Hands-Free Fob is present.
- Turn the ignition key switch to **IGNITION**.

##### ⚠ WARNING

To prevent accidental vehicle start-up, which could cause death or serious injury, disconnect battery cables (negative (-) cable first) before proceeding. (00307a)

##### ⚠ WARNING

Disconnect negative (-) battery cable first. If positive (+) cable should contact ground with negative (-) cable connected, the resulting sparks can cause a battery explosion, which could result in death or serious injury. (00049a)

1. Refer to the owner's manual and follow the instructions to remove the seat and disconnect the battery cables, negative (-) cable first. Retain all seat mounting hardware.

### INSTALLATION

#### Tour-Pak Interior Light Installation

1. Open the Tour-Pak® lid.
2. See Figure 1. Remove the retaining nut (1) and lockwasher (2) from the latch arm (cam hook) (3) on the lid latch. Remove the cam lock.

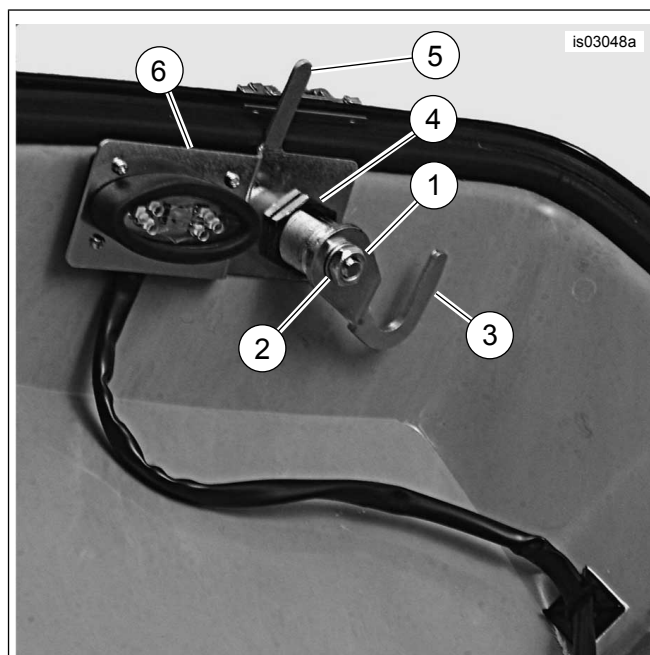

1. Retaining nut
2. Lockwasher
3. Cam hook
4. Large lock nut
5. Long tab on light bracket
6. Light and bracket

Figure 1. Mount Light to Tour-Pak Lid Latch

3. Remove the large lock nut (4) and the lock guide (with tab, as on 5).
4. Slide the light and bracket (6) with the long tab (5) oriented into the Tour-Pak over the flats on the lock.
5. Thread on the large lock nut (4) and tighten.
6. Orient and slide the cam hook (3) over the flats on the lock.

7. Install the lockwasher (2) and retaining nut (1) and tighten securely.

## Wire Harness Routing

1. Using the alcohol wipe from the kit, prepare the interior surface of the Tour-Pak **lid and base** for adhesive backed wire retainers at equally spaced locations around the front of the Tour-Pak lid (see Figure 2 ) and several locations on the interior surface of the Tour-Pak **base**(Figure 3 ).
2. Peel the backing from three wire retainers (1) and press them into position on the inside of the Tour-Pak **lid**, as shown in Figure 2 ).
3. Run the wire harness (2) from the light (3) around the inside face of the front edge of the Tour-Pak lid.
4. Install cable straps from the kit through the wire retainers and around the harness conduit.

### NOTE

*Allow sufficient slack so that the Tour-Pak lid will open and close without pinching the harness at either the front or along the hinge line of the Tour-Pak.*

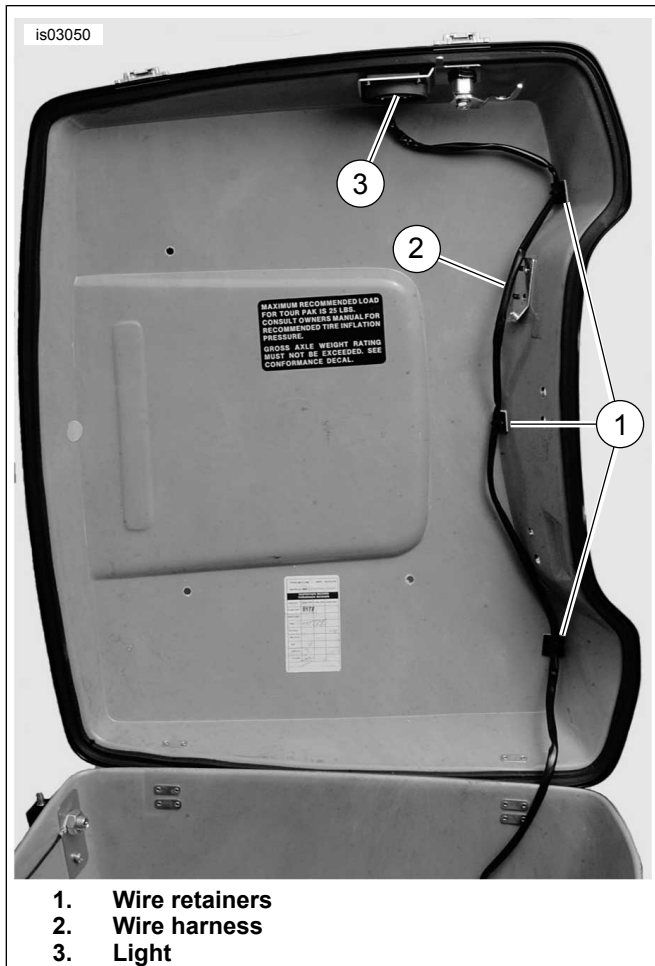

**Figure 2. Suggested Wire Retainer Locations on Lid**

5. See Figure 3. Peel the backing from the wire retainers and press them into position on the inside of the Tour-Pak base.

6. Loop the long side of the light harness forward of the front hinge and down the side of the Tour-Pak base.
7. Fold the light conduit back on itself, and loosely install cable straps through the wire retainers and around the wire conduit.
8. Lay the harness connector over toward the opposite corner along the front face of the Tour-Pak.
9. Install cable straps through the remaining wire retainers and around the harness conduit.



**Figure 3. Suggested Wire Retainer Locations in Base**

## Connection to Vehicle Harness

1. See Figure 4. Remove the large split grommet (1) from the corner of the Tour-Pak.

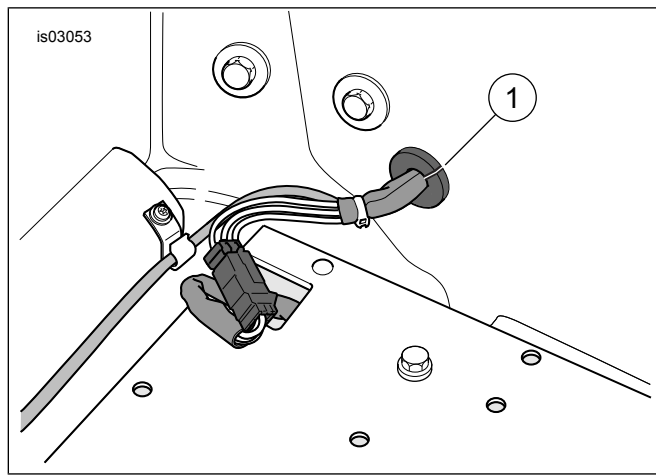

**Figure 4. Split Grommet**

2. See Figure 5. Obtain the harness extension (2) with the in-line fuse (3) from the kit. Fit the connector end through the grommet hole in the Tour-Pak. The conduit end with the in-line fuse, black and red wires and ring terminals will be routed to the battery.
3. Mate the harness extension two-way socket housing to the two-way pin housing on the Tour-Pak light harness (2).
4. Fit the grommet over the harness extension conduit, and press the grommet groove into the grommet hole in the Tour-Pak.
5. Route the ring terminated wire leads along the inside of the frame rails so that the red power lead fits to the positive (+) battery terminal and the black ground lead fits to the negative (-) battery terminal.

**NOTE**

Verify that the ignition key switch is in the OFF position **before** attaching the battery cables.

**⚠ WARNING**

**Connect positive (+) battery cable first. If positive (+) cable should contact ground with negative (-) cable connected, the resulting sparks can cause a battery explosion, which could result in death or serious injury. (00068a)**

6. Coat the ring terminal on the red lead with dielectric grease (6) from the kit. Thread the battery bolt through the ring terminal and through the red positive (+) cable into the battery positive (+) terminal.
7. Coat the ring terminal on the black lead with dielectric grease. Thread the battery bolt through the ring terminal and through the black negative (-) cable into the battery negative (-) terminal.
8. Tighten the terminal bolts to 6.8–10.9 N·m (60–96 in-lbs).
9. With the red and black leads routed to avoid chafing or heat points, use cable straps (5) to attach the wire leads to the vehicle wire harness in at least two locations.
10. Verify that the Tour-Pak lid opens and closes without pinching the harness, then tighten the cable straps and cut off the ends.

**RETURN TO SERVICE**

1. **Models equipped with mat:** Straighten the mat at the bottom of the Tour-Pak. **Models equipped with liner:** Install the liner, and secure the owner's manual pouch to the back wall of the liner with the fasteners removed earlier.
2. Check the light for proper operation. Press in firmly on the center of the lens to activate the switch and turn the light on. Press again to turn the light off.

**NOTE**

The Tour-Pak light has a feature that disables the light after five minutes if the Tour-Pak contents press against the light and activate the switch.

If the light has been disabled in this manner, it can be reset by disconnecting the two-way pin housing on the Tour-Pak light harness from the harness extension socket housing, and then re-connecting the harnesses.

SERVICE PARTS

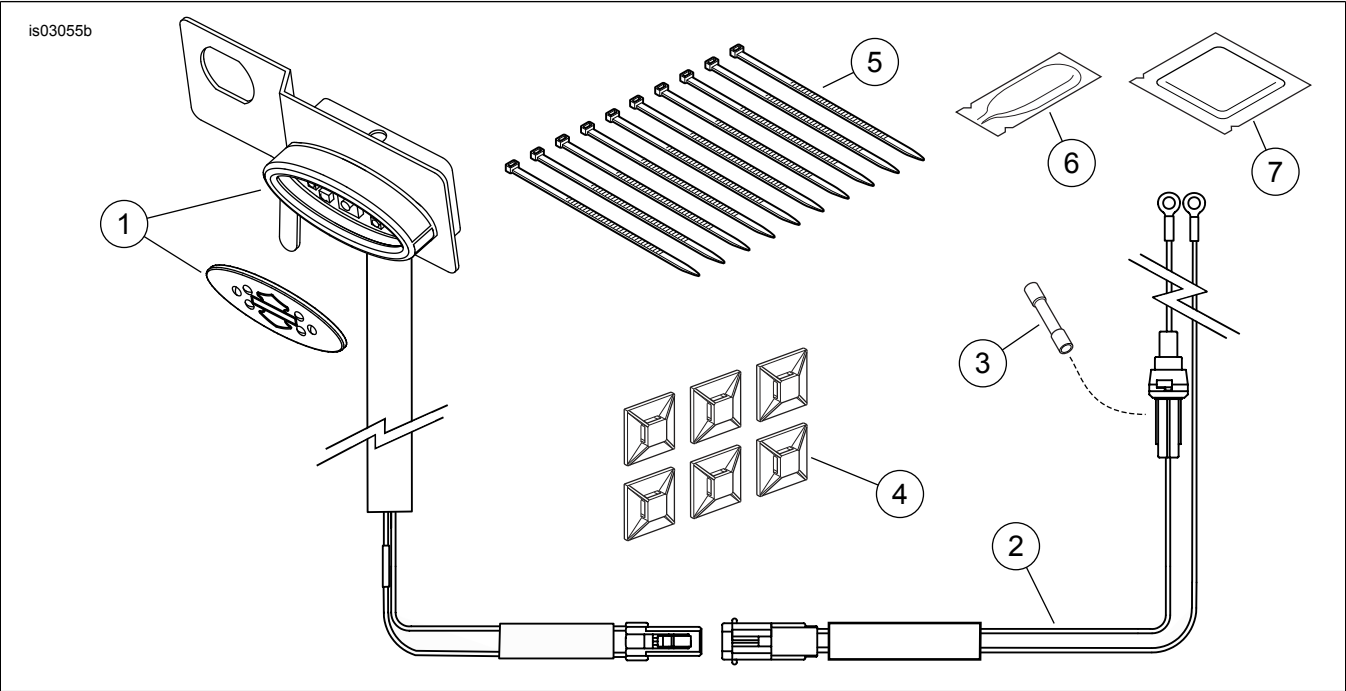

Figure 5. Service Parts, Tour-Pak Luggage Interior Light Kit

Table 1. Service Parts Table

| Item | Description (Quantity)                         | Part Number         |
|------|--|---------------------|
| 1    | Tour-Pak light, lens and wire harness assembly | Not sold separately |
| 2    | Harness extension                              | 90103-06A           |
| 3    | Fuse, glass, 5 Amp                             | 70333-06            |
| 4    | Wire retainer (6)                              | 11769               |
| 5    | Cable strap (10)                               | 10126               |
| 6    | Dielectric grease packet, 5 gram               | Not sold separately |
| 7    | Alcohol wipe                                   | 94678-00Y           |