



# INSTRUCTIONS

J05611

2012-10-19



## TURN SIGNAL SWITCH EXTENSION CAP KITS

### GENERAL

#### Kit Numbers

71500177, 71500178, 71500179, 71500180

#### Models

For model fitment information, see the P&A retail catalog or the Parts and Accessories section of [www.harley-davidson.com](http://www.harley-davidson.com) (English only).

These turn signal switch extension caps are a direct replacement for the original equipment (OE) turn signal switch caps, and install in the same manner.

#### Installation Requirements

##### ▲ WARNING

Rider and passenger safety depend upon the correct installation of this kit. Use the appropriate service manual procedures. If the procedure is not within your capabilities or you do not have the correct tools, have a Harley-Davidson dealer perform the installation. Improper installation of this kit could result in death or serious injury. (00333b)

##### NOTE

This instruction sheet refers to service manual information. A service manual for this year/model motorcycle is required for this installation and is available from a Harley-Davidson dealer.

#### Kit Contents

See Figure 3 and Table 2.

#### PREPARATION

##### NOTE

**For vehicles equipped with security siren:**

- **2007 and later:** Verify that the Hands-Free Fob is present. Turn the ignition key switch to IGNITION.
- **2006 and earlier:** Disarm the siren with the key fob.

#### For Vehicles With Main Fuse:

##### ▲ WARNING

To prevent accidental vehicle start-up, which could cause death or serious injury, remove main fuse before proceeding. (00251b)

1. See the service manual and remove the main fuse.

#### For Vehicles With Main Circuit Breaker (Except VRSC):

##### ▲ WARNING

To prevent accidental vehicle start-up, which could cause death or serious injury, disconnect negative (-) battery cable before proceeding. (00048a)

##### NOTE

For 2004 and later Sportster® models, the negative battery cable is most easily disconnected at the engine crankcase.

1. **All models except VRSC:** See the service manual to remove the seat and disconnect the negative (black) battery cable from the negative (-) battery terminal. Retain all seat mounting hardware. **VRSC models:** See the service manual to disconnect the negative (black) battery cable from the negative (-) battery terminal.
2. **For ALL models:** Turn the ignition key switch OFF if not already done.

#### REMOVAL

1. Remove the left- and right-side handlebar switch housing assemblies per the service manual.

##### NOTE

It is not necessary to disconnect the switch wiring to replace the turn signal switch caps.

2. **Type I:** See Figure 3 (top view). **Type II:** See Figure 3 (bottom view).
  - a. Remove one turn signal switch (C or D) from the switch assembly (A or B) per service manual instructions.
  - b. See Figure 1. Carefully pry the currently installed turn signal switch cap (1) up off of the splined shaft (2) or pivot pin (3) on the switch.
  - c. Remove the switch cap from the switch. The switch cap can be recycled or properly disposed of.
  - d. Repeat for the opposite-side turn signal switch and cap.
  - e. Remove one switch module (H or I) from the handlebar switch housing per service manual instructions.
  - f. See Figure 1. Carefully pry the currently installed turn signal switch cap (1) up off one of the pivot pins (2 or 3) on the switch module.



- g. Lift the switch cap from the remaining pivot pin, and remove the cap from the module. The switch cap can be recycled or properly disposed of.
- h. Repeat for the opposite-side switch module and cap.

**Table 1. Switch Extension Cap Styles**

Type	Fits
I	All models EXCEPT: <ul style="list-style-type: none"> <li>• 2011 and Later Softail</li> <li>• 2012 and Later Dyna</li> </ul>
II	2011 and Later Softail models 2012 and Later Dyna models

## INSTALLATION

### NOTE

The clear protective cover film is provided to protect the turn signal switch cap surface during installation. Remove the film only after installation is complete.

### For Type I Switch Assemblies:

1. See Figure 3. Select the correct turn signal switch extension cap (2 or 3) from the kit.
2. See Figure 2. Insert the switch (3), from inside the lower housing (1), through the rectangular opening (2) as far as it will go.
3. Place the cap (7) onto the switch, angling the smooth hole over the pivot pin (5) on the turn signal switch.

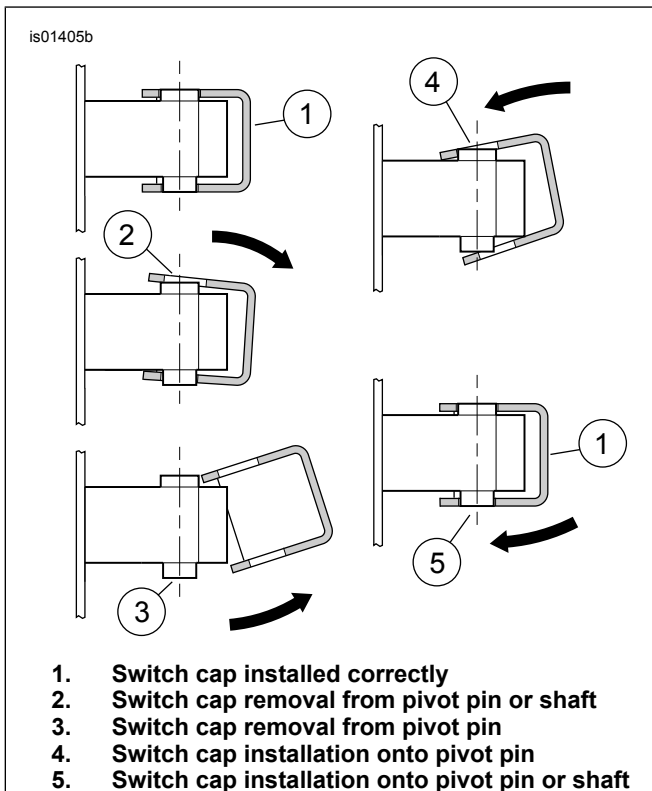

1. **Switch cap installed correctly**
2. **Switch cap removal from pivot pin or shaft**
3. **Switch cap removal from pivot pin**
4. **Switch cap installation onto pivot pin**
5. **Switch cap installation onto pivot pin or shaft**

**Figure 1. Switch Cap Removal and Replacement**

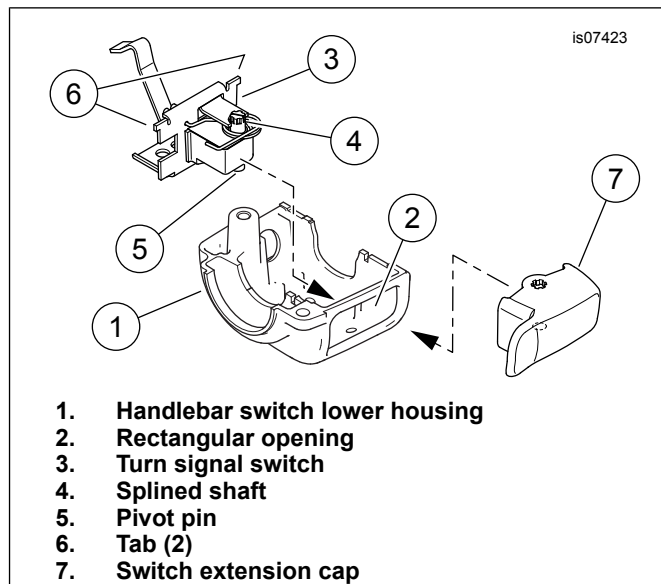

1. **Handlebar switch lower housing**
2. **Rectangular opening**
3. **Turn signal switch**
4. **Splined shaft**
5. **Pivot pin**
6. **Tab (2)**
7. **Switch extension cap**

**Figure 2. Switch Cap Installation (Type I, Left Side Shown)**

4. Carefully press the switch cap onto the splined shaft (4), rocking and moving the cap until the pin snaps into place in the hole.
5. Pull the switch back into the housing, and press the tabs (6) on the side of the switch into the slots in the housing.
6. Toggle the switch back and forth, checking for proper operation.
7. See Figure 3. Fasten the switch to the lower housing with the screw (G) removed earlier.
8. Repeat Steps 1-7 for the opposite-side turn signal switch.
9. Assemble the turn signal switches back into the handlebar switch assemblies per the service manual. Use care when installing switches to avoid damage.
10. Assemble the left and right side switch housing assemblies. Refer to the service manual. Remove and properly dispose of the clear protective installation covers.

### For Type II Switch Modules:

1. See Figure 3. Select the correct turn signal switch extension cap (5 or 6) from the kit.
2. See Figure 1. Place the cap onto the switch, angling the hole (4) on the top over the pivot pin on the switch module.
3. Carefully press the switch cap onto the second pivot pin (5), rocking and moving the cap until the pin snaps into place in the hole.
4. Toggle the switch cap back and forth, checking for proper operation.
5. Assemble the switch modules back into the switch housings per the service manual. Use care when installing switches to avoid damage.
6. Assemble the left and right side switch housing assemblies. Refer to the service manual. Remove and discard the clear protective installation covers.

## COMPLETION

### NOTE

To prevent possible damage to the sound system, verify that the ignition key switch is in the OFF position **before** installing the main fuse or attaching the negative battery cable.

1. **Models with main fuse:** See the service manual and install the main fuse. **Models with main circuit breaker:**
  - a. **For ALL models except XL:** See the service manual and attach the negative battery cable. Apply a light coat of Harley-Davidson electrical contact lubricant (Part No. 99861-02), petroleum jelly or corrosion retardant material to the negative battery terminal.

- b. **For XL models only:** See the service manual, and connect the negative (-) battery cable at the engine crankcase.

### ⚠ WARNING

**After installing seat, pull upward on seat to be sure it is locked in position. While riding, a loose seat can shift causing loss of control, which could result in death or serious injury. (00070b)**

2. **For ALL models:** See the service manual and install the seat.
3. Test all the handlebar switches for proper operation.

## SERVICE PARTS

Table 2. Service Parts

Kit	Item	Description (Quantity)	Part Number
Kit 71500179 (Black, Type I) Models EXCEPT • 2011+ Softail • 2012+ Dyna	1	Turn Signal Switch Extension Cap Kit (includes Items 2-3)	71500179
	2	• Switch extension cap, right turn (black)	Not sold separately
	3	• Switch extension cap, left turn (black)	Not sold separately
Kit 71500180 (Chrome, Type I) Models EXCEPT • 2011+ Softail • 2012+ Dyna	1	Turn Signal Switch Extension Cap Kit (includes Items 2-3)	71500180
	2	• Switch extension cap, right turn (chrome)	Not sold separately
	3	• Switch extension cap, left turn (chrome)	Not sold separately
Kit 71500177 (Black, Type II) 2011+ Softail models 2012+ Dyna models	4	Turn Signal Switch Extension Cap Kit (includes Items 5-6)	71500177
	5	• Switch extension cap, right turn (black)	Not sold separately
	6	• Switch extension cap, left turn (black)	Not sold separately
Kit 71500178 (Chrome, Type II) 2011+ Softail models 2012+ Dyna models	4	Turn Signal Switch Extension Cap Kit (includes Items 5-6)	71500178
	5	• Switch extension cap, right turn (chrome)	Not sold separately
	6	• Switch extension cap, left turn (chrome)	Not sold separately
<b>Items mentioned in text, but not included in kit:</b>			
	A	Right-side handlebar control switch assembly (Type I)	
	B	Left-side handlebar control switch assembly (Type I)	
	C	Right turn signal switch assembly (Type I)	
	D	Left turn signal switch assembly (Type I)	
	E	Right turn signal switch cap	
	F	Left turn signal switch cap	
	G	Original equipment (OE) switch mounting screw	
	H	Right-side handlebar control switch module (Type II)	
	I	Left-side handlebar control switch module (Type II)	

# SERVICE PARTS

is06575a

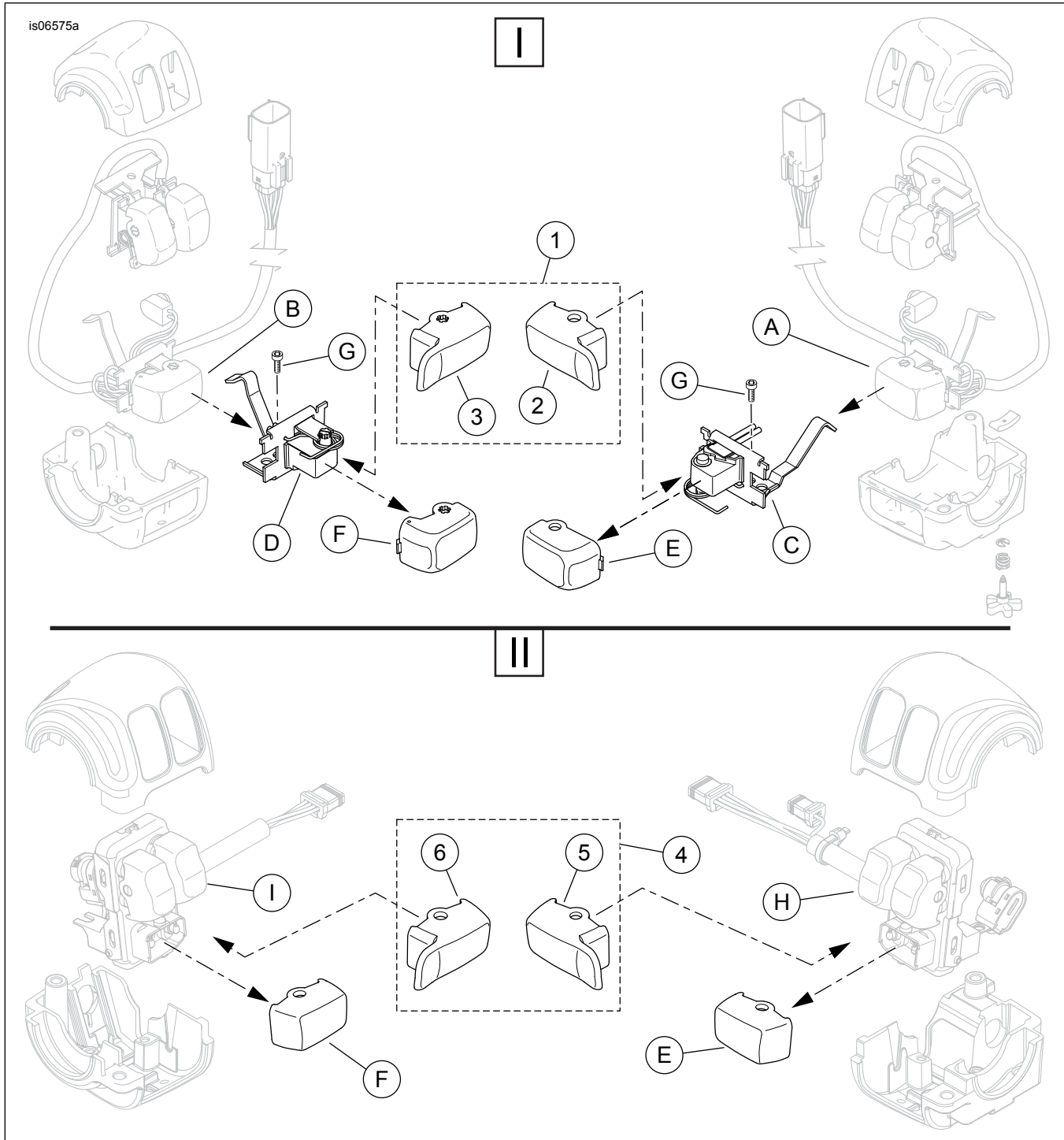

Figure 3. Service Parts, Turn Signal Switch Extension Cap Kits