



# INSTRUCTIONS

J05767

2018-11-28



## BOOM! BOX CB RADIO KIT

### KIT CONTENTS

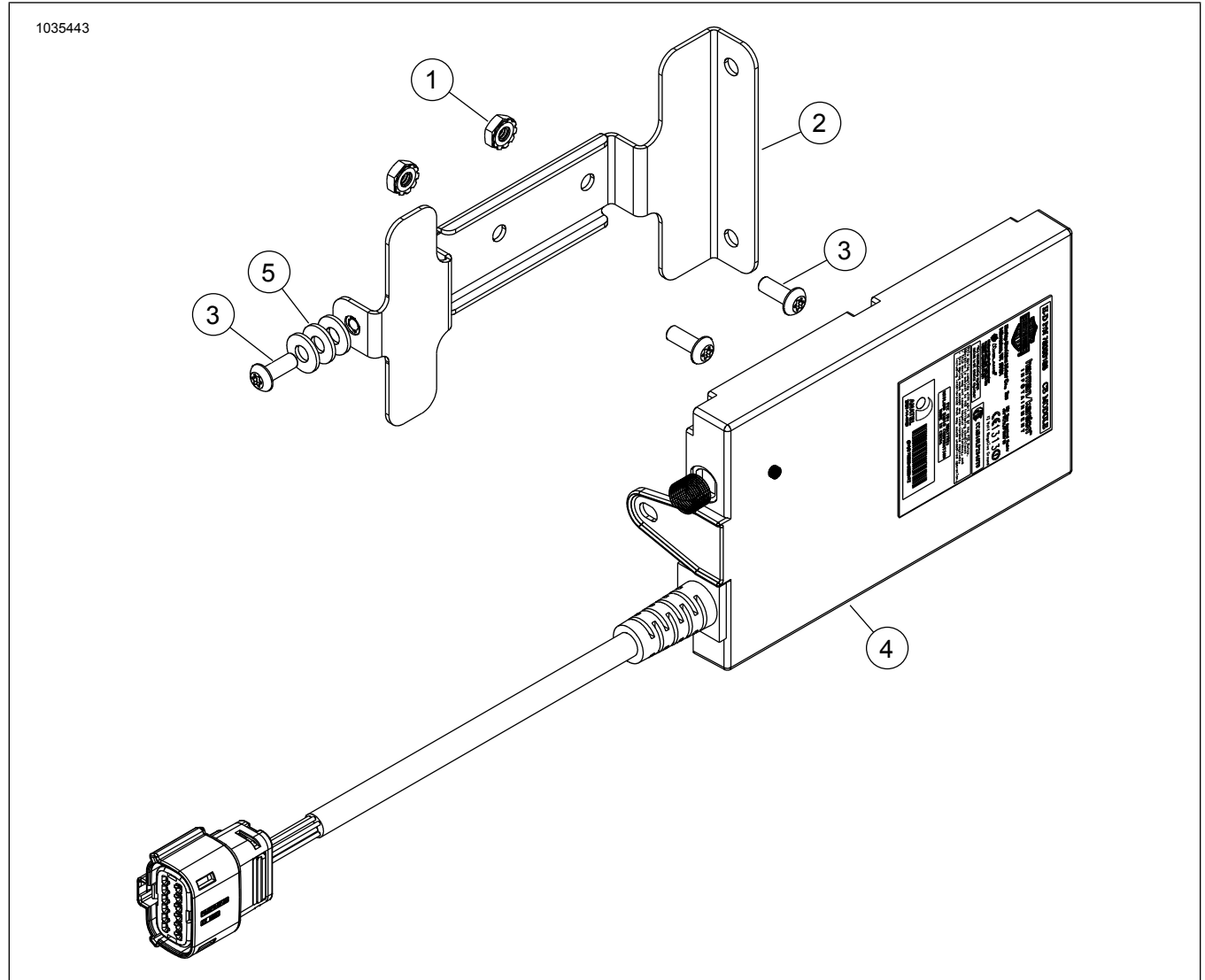

Figure 1. Boom! Box CB Radio Components

**Table 1. Boom! Box CB Radio Components**

<input checked="" type="checkbox"/>	Item	Qty	Description	Part No.	Notes
<input type="checkbox"/>	1	2	Keps™ nut	7838	
<input type="checkbox"/>	2	1	Mounting bracket	57000247	
<input type="checkbox"/>	3	3	Screw	2478	2.8–4 N·m (25–35 in-lbs)
<input type="checkbox"/>	4	1	CB Module	Not Sold Separately	
<input type="checkbox"/>	5	3	Washer	6716	Fork-mounted fairing models only

**NOTE**

Verify all contents are present in the kit before installing or removing items from vehicle.

**NOTE**

This instruction sheet references service manual information. A service manual for this year/model motorcycle is required for this installation. One is available from a Harley-Davidson dealer.

**GENERAL**

**Kit Number**

76000486A

**Models**

For model fitment information, see the P&A Retail Catalog or the Parts and Accessories section of [www.harley-davidson.com](http://www.harley-davidson.com) (English only).

Visit <https://serviceinfo.harley-davidson.com> for the latest instruction sheet.

Contact Harley-Davidson Customer Support Center at 1-800-258-2464 (U.S. only) or 1-414-343-4056.

**Installation Requirements**

**▲ WARNING**

Rider and passenger safety depend upon the correct installation of this kit. Use the appropriate service manual procedures. If the procedure is not within your capabilities or you do not have the correct tools, have a Harley-Davidson dealer perform the installation. Improper installation of this kit could result in death or serious injury. (00333b)

These items are available at your local Harley-Davidson dealership.

- **2014 and later Touring and Trike models:** Separate purchase of CB antenna (Part No. 76250-09 or 76386-09A) is required for this installation.
- **2014 and later Touring and Trike models without a PTT button:** Separate purchase of right hand control module (Part No. 71500130C) is required for this installation.

A radio software update is needed after installing the CB module for the system to perform properly. See a Harley-Davidson dealer.

2019 and later Trike models will re-use the Original Equipment (OE) Hazard/Start/Reverse cap on the new hand control.

**Electrical Overload**

**NOTICE**

It is possible to overload the vehicle's charging system by adding too many electrical accessories. If the combined electrical accessories operating at any one time consume more electrical current than the vehicle's charging system can produce, the electrical consumption can discharge the battery and cause damage to the vehicle's electrical system. (00211d)

**▲ WARNING**

When installing any electrical accessory, be certain not to exceed the maximum amperage rating of the fuse or circuit breaker protecting the affected circuit being modified. Exceeding the maximum amperage can lead to electrical failures, which could result in death or serious injury. (00310a)

The CB Radio requires up to **2.0 Amps** additional current from the electrical system.

**PREPARE**

**▲ WARNING**

To prevent accidental vehicle start-up, which could cause death or serious injury, remove main fuse before proceeding. (00251b)

1. Remove main fuse. See service manual.
2. Remove outer fairing. See service manual.

**INSTALLATION**

**Fork-Mounted Fairing:**

1. See Figure 2. Align hole (3) in mounting bracket (5) with anti-rotation boss (4).
2. Install screws (2). Tighten.  
Torque: 2.8–4 N·m (25–35 in-lbs)
3. Install CB module (1) into bracket (5).

4. Install screw (6). Tighten.  
Torque: 2.8–4 N·m (25–35 in-lbs)
5. See Figure 3. Connect 12-place socket housing to CB [184] (1).

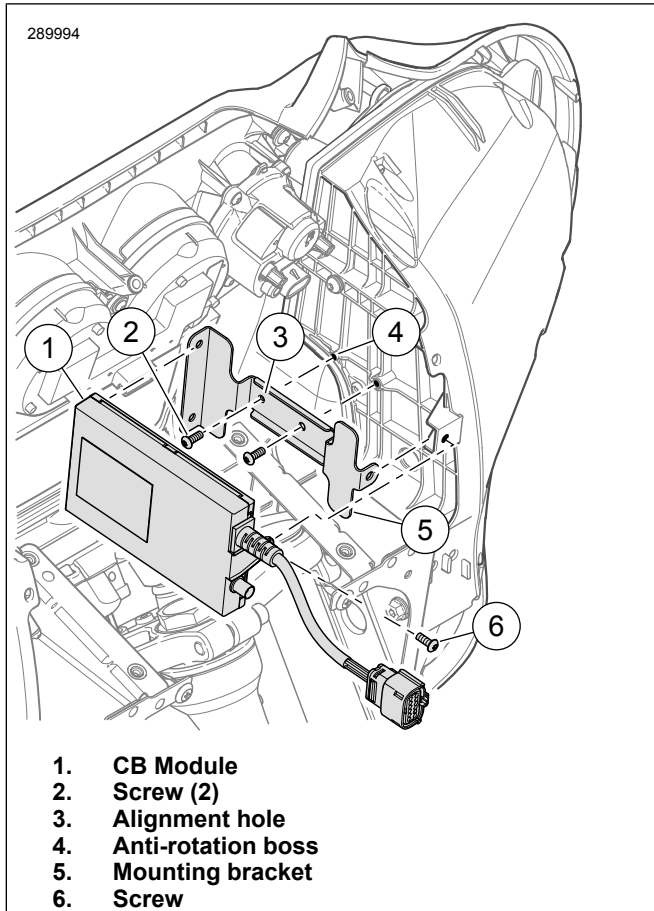

Figure 2. Install CB Module: Fork-Mounted Fairing

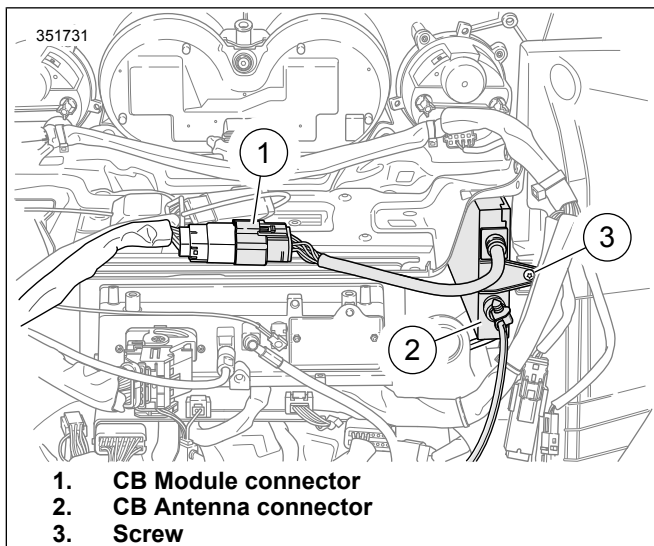

Figure 3. Inner Fairing Harness Connectors

### Frame-Mounted Fairing:

1. See Figure 4. Install mounting bracket (2).

2. Install screws (1) and nuts (6). Tighten.  
Torque: 2.8–4 N·m (25–35 in-lbs)
3. Install CB module (5) into bracket (2).
4. Install washers (3) between CB module (5) and bracket (2).
5. Install screw (4). Tighten.  
Torque: 2.8–4 N·m (25–35 in-lbs)
6. See Figure 5. Connect 12-place socket housing to CB [184] (1).

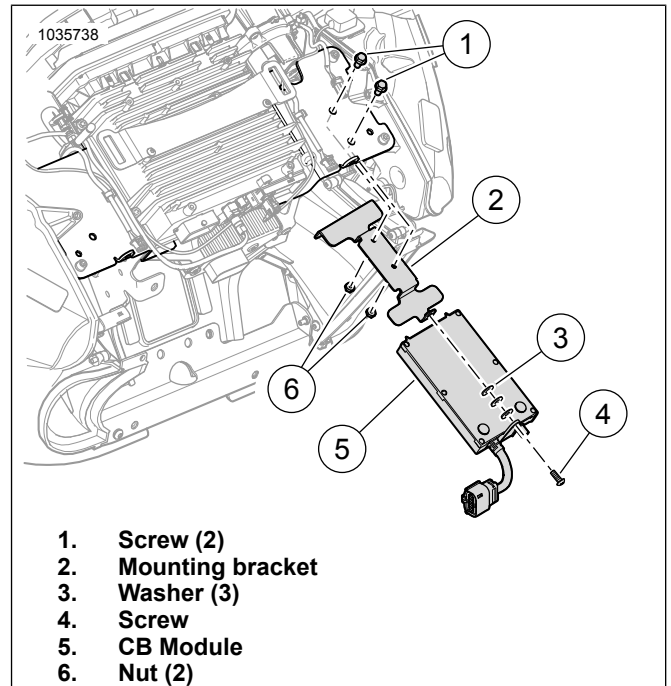

Figure 4. Install CB Module: Frame-Mounted Fairing

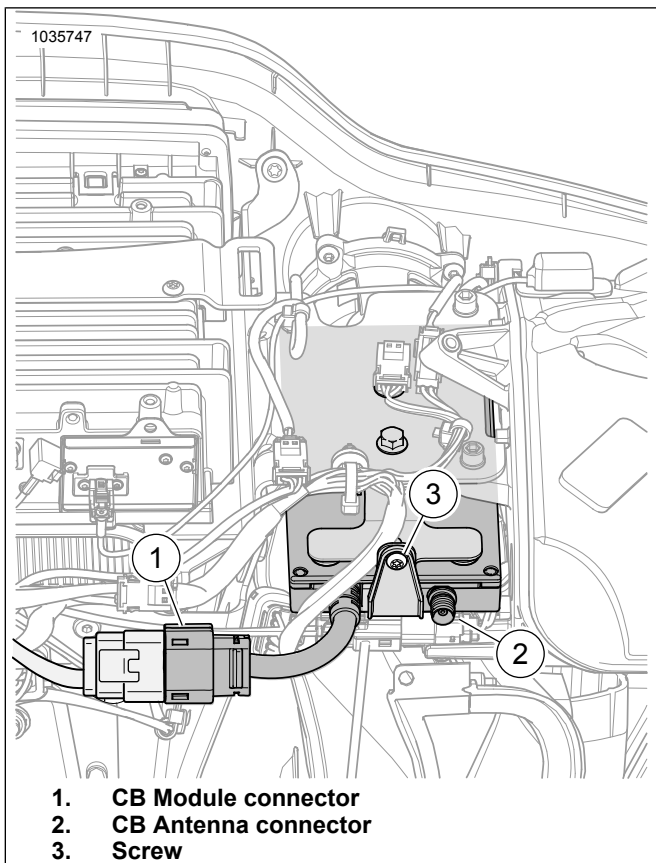

Figure 5. Inner Fairing Harness Connectors

## Push-to Talk (PTT) Button - 2014 to 2018 Touring and Trike Models

1. See Figure 6. Replace right hand control module with Part No. 71500130C. See service manual.
2. Use Digital Technician II to enable radio software. See Harley Davidson dealer.  
Special Tool: DIGITAL TECHNICIAN II (HD-48650)

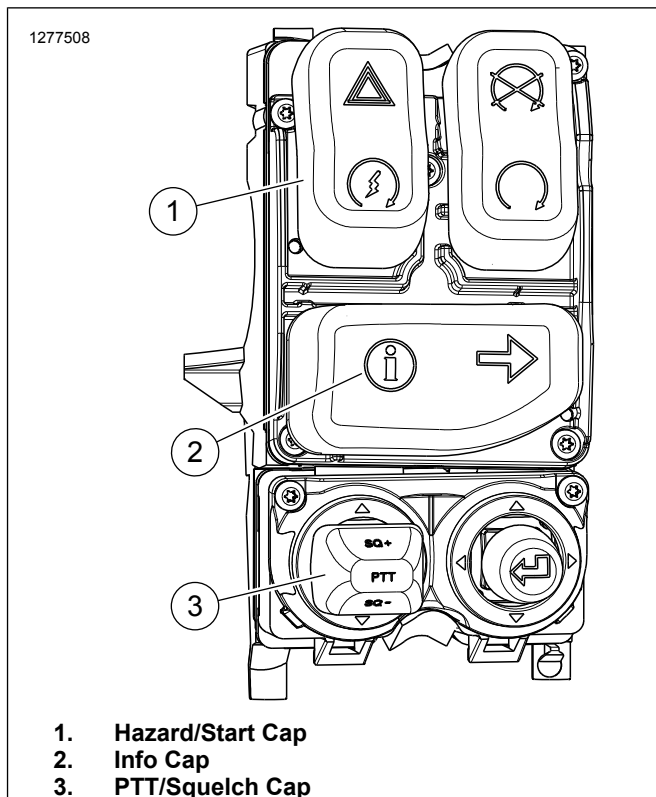

Figure 6. 2014 and Later Right Control (71500130C)

## Push-to Talk (PTT) Button - 2019 and Later Touring and Trike Models

1. Remove OE right hand control module. See service manual.
2. **Touring models:** See Figure 7. Install right hand control module Part No. 71500130C. See service manual.
  - a. Disassemble switch housing.
  - b. See Figure 6. Remove Info cap (2) from new control module.
  - c. See Figure 7. Install Back/Right Turn Signal cap (5) to new control module.
  - d. Assemble switch housing.
3. **Trike models:** Install right hand control module Part No. 71500130C. See service manual.
  - a. Disassemble switch housing.
  - b. See Figure 6. Remove Info cap (2) and Hazard/Start cap (1) from new control module.
  - c. See Figure 8. Remove Hazard/Start/Reverse cap (7) from OE control module.
  - d. See Figure 8. Install Back/Right Turn Signal cap (8) to new control module.
  - e. See Figure 8. Install Hazard/Start/Reverse cap (7) to new control module.

f. Assemble switch housing.

4. Use Digital Technician II to enable radio software. See Harley Davidson dealer.

Special Tool: DIGITAL TECHNICIAN II (HD-48650)

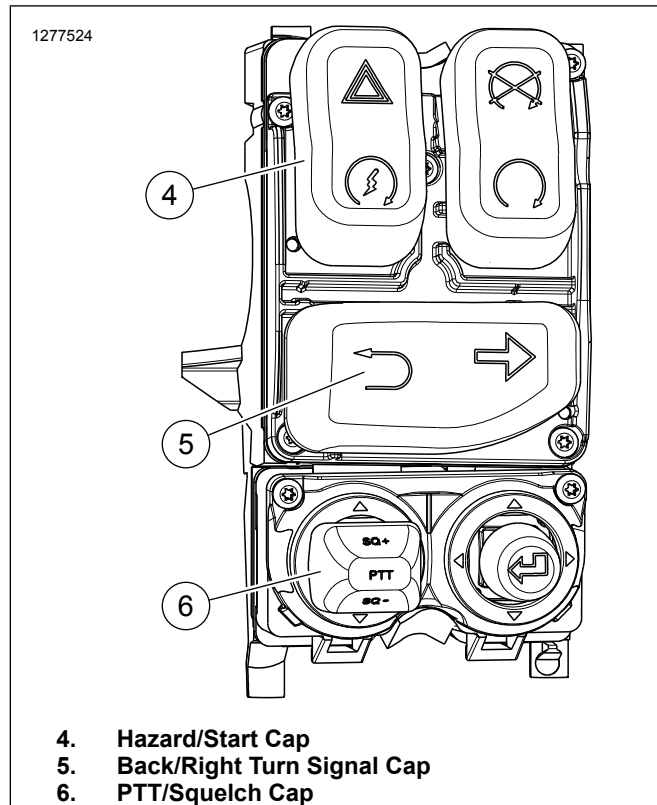
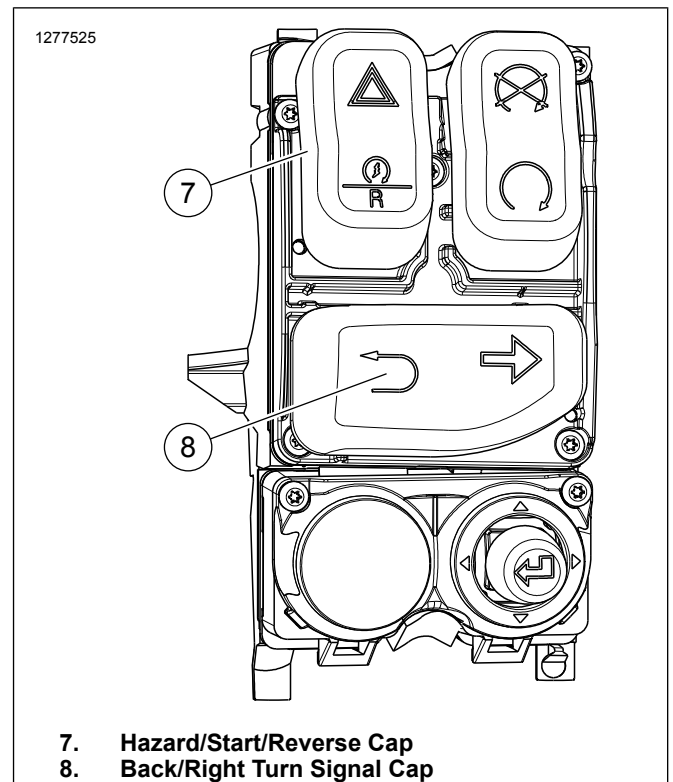

Figure 7. 2019 and Later Right Control view after Switch Cap Replacement



- 7. Hazard/Start/Reverse Cap
- 8. Back/Right Turn Signal Cap

Figure 8. 2019 and Later Trike Right Control (OE)

## COMPLETE

1. Install outer fairing. See service manual.
2. Install main fuse. See service manual.

## SWR ADJUSTMENT

Standing wave ratio (SWR) is a technical term for the procedure that checks how well the CB transmitter and antenna are matched. If poor CB reception or transmission is noticed, the SWR should be checked.

To check SWR, an SWR meter or bridge is required. A Harley-Davidson dealer will either have an SWR meter and the appropriate adapters, or can direct you to a CB repair shop for an SWR check.

Since the operating procedures for SWR meters vary, be sure the operating instructions for the SWR meter being used are carefully followed.

## OPERATION

See Boom! Box Owner's manual for operating instructions. See [Harley-Davidson.com](http://Harley-Davidson.com) to view owner's manual online.