



INSTRUCTIONS

J06351

2015-11-03



SOLO SEAT KIT FOR TOURING MODELS

GENERAL

Kit Number

52000268

Kit Contents

See Figure 3 and Table 1.

Installation Requirements

▲ WARNING

Rider and passenger safety depend upon the correct installation of this kit. Use the appropriate service manual procedures. If the procedure is not within your capabilities or you do not have the correct tools, have a Harley-Davidson dealer perform the installation. Improper installation of this kit could result in death or serious injury. (00333b)

NOTE

This instruction sheet references service manual information. A service manual for your model motorcycle is required for this installation. One is available from a Harley-Davidson dealer.

REMOVAL

NOTE

When a solo seat is installed without a passenger seat, the passenger footpegs or footboards and the passenger grab strap must be removed.

Avoid scratching painted surfaces with tools or metal seat tabs.

1. **2014 and Later Models:** Skip to step 7. **2014 and Later Models:** Remove the left and right saddlebags following the instructions in the owner's manual.

NOTE

Note the mounting orientation of the saddlebag mounting brackets before removing.

2. See Figure 1. Remove the left side forward saddlebag mounting bracket bolt and washer to remove the bracket and disconnect the grab strap. Save the hardware for installation.
3. Remove the right side forward saddlebag mounting bracket bolt and washer. Save the hardware for installation.
4. Install the saddlebag mounting brackets with the bolts and washers in the same orientation as removed. Leave fasteners loose.
5. See the service manual. Install saddlebag hardware and saddlebags.
6. Remove the grab strap and all hardware.

7. Remove the screw and lockwasher from the rear of the seat. Pull the seat rearward to remove the seat.
8. See Figure 2. Remove the 2 hex nuts (1) from the studs near the front of the rear fender and save for installation.
9. Remove the passenger footpegs or footboards, if installed. See the service manual.

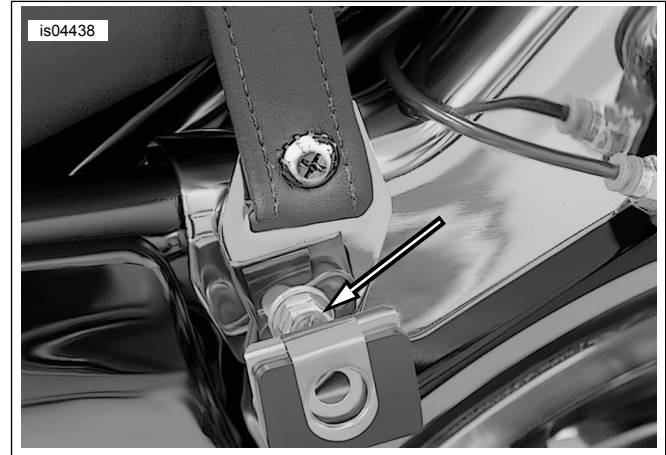

Figure 1. Passenger Grab Strap Removal (2008 Shown)

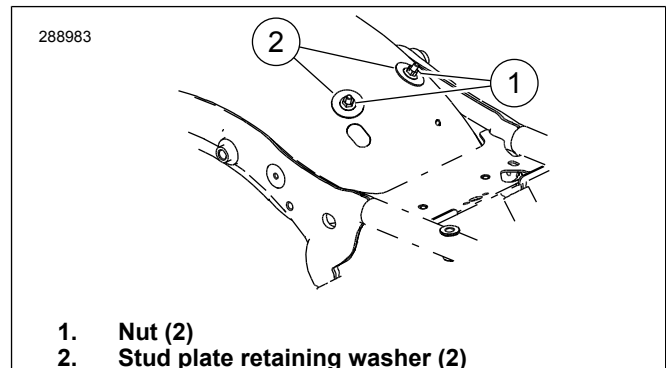

Figure 2. Nuts and Stud plate washers

INSTALLATION

1. Install the new seat (2), with the slot in seat bottom engaged with the tongue on the fuel tank bracket and the rear of the seat is secured with the nuts removed earlier.
2. Complete seat installation. After installing seat, pull up on the seat to verify that it is secure.



SERVICE PARTS

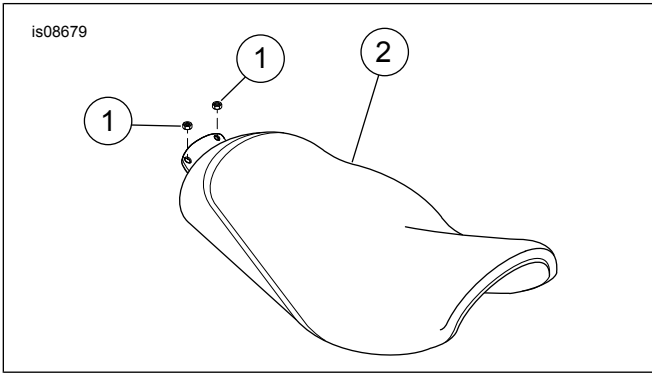

Figure 3. Service Parts: Solo Seat Kit for Touring Models

Table 1. Service Parts: Solo Seat Kit For Touring Models

Item	Description (Qty)	Part Number
1	Seat	Not sold separately
2	Leather dressing (not shown)	Not sold separately