



# INSTRUCTIONS

J06386

2017-10-16



## SOLO TOURING SEAT

### GENERAL

#### Kit Number

52000253

#### Models

For model fitment information, see the P&A retail catalog or the Parts and Accessories section of [www.harley-davidson.com](http://www.harley-davidson.com) (English only).

#### ⚠ WARNING

Rider and passenger safety depend upon the correct installation of this kit. If the procedure is not within your capabilities or you do not have the correct tools, have a Harley-Davidson dealer perform the installation. Improper installation of this kit could result in death or serious injury. (00308b)

#### Kit Contents

This kit contains one solo seat.

### INSTALLATION

1. See the owner's manual. Remove seat.
2. Remove grab strap and nuts. Retain the nuts.
3. See Figure 1. Remove two nuts (1). Leave the plastic stud plate retaining washers (2) in place.
4. If installing seat with a passenger pillion, refer to pillion instruction sheet to install pillion and grab strap. Additional hardware may be required to mount a pillion.

#### ⚠ WARNING

After installing seat, pull upward on seat to be sure it is locked in position. While riding, a loose seat can shift causing loss of control, which could result in death or serious injury. (00070b)

5. Slide the new solo seat into position until front tab engages frame and rear of seat locates over mounting studs. Install seat mounting nuts onto the studs.

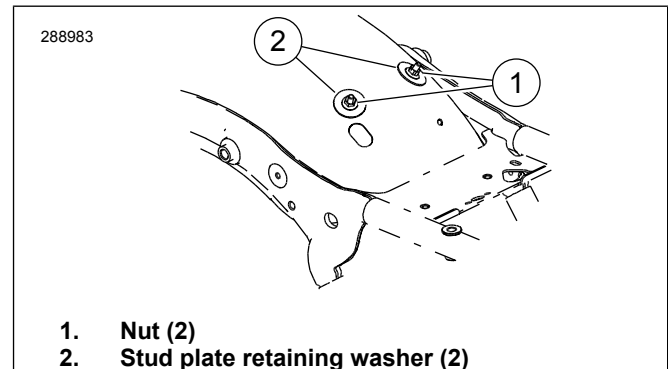

Figure 1. Remove Nuts