



INSTRUCTIONS

J05775

2013-11-01



AIR CLEANER COVER INSERT

GENERAL

Kit Numbers

61300219, 61300220, 61300221, 61300222

Models

For model fitment information, see the P&A Retail Catalog or the Parts and Accessories section of www.harley-davidson.com (English only).

Additional Parts Required

Separate purchase of LOCTITE® 243 MEDIUM STRENGTH THREADLOCKER AND SEALANT (blue) (part no. 99642-97) or equivalent is required for proper installation of this kit.

Kit Contents

See Figure 1 and Table 1.

PREPARATION

- See Figure 1. Remove original equipment (OE) insert (A or B) from the air cleaner cover.
 - Style "A"**: Pull on front edge of trim to release 3M™ Dual Lock™ Reclosable Fastener. Do not remove fastener from the air cleaner cover.
 - Style "B"**: Push a thin-blade putty knife between trim and air cleaner cover while pulling trim away from cover. Remove all tape and adhesive residue from the air cleaner cover.
- Remove screw (C). Air cleaner cover and gasket do not require removal.

INSTALLATION

- Style "A"**: The original Dual Lock fastener is compatible with the new components.
- Style "B":
 - See Figure 1. Thoroughly clean area (D) with a 50:50 mix of rubbing alcohol and water. Allow to dry completely.
 - Leave Dual Lock fastener halves attached. Remove tape protecting adhesive.
 - Visually align trim plate (3) with cover and press firmly in fastener area (D) to secure. Hold for 30 seconds.
 - Remove trim plate.

- Apply LOCTITE 243 MEDIUM STRENGTH THREADLOCKER AND SEALANT (blue) to threads of screw (C).

NOTE

Verify that seal (F) has not become dislodged.

- Install trim plate (3) and gasket (4) with original screw (C). Tighten to 4.1–6.8 N·m (36–60 in-lbs). Press firmly in area of Dual Lock fastener (D) to secure.
- Install the decorative insert (2) with screws (1). Tighten securely. Press firmly on insert in area of Dual Lock fastener (arrow) to secure.

SERVICE PARTS

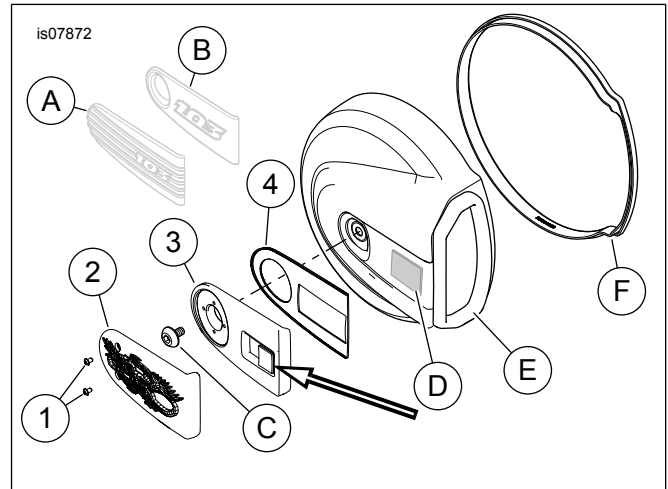

Figure 1. Service Parts: Air Cleaner Trim Kit

Table 1. Service Parts: Air Cleaner Trim Kit

Item	Description (Quantity)	Part Number
1	Insert screw, 8-36 x 1/4, Torx® (2)	10500039
2	Decorative insert	Not Sold Separately
3	Trim plate	Not Sold Separately
4	Gasket	Not Sold Separately
Items mentioned in text but not provided.		
A	Original trim retained with Dual Lock fastener	
B	Original trim retained with double-sided tape	
C	Screw	
D	New Dual Lock fastener	
E	Air cleaner cover assembly	
F	Seal	

