



INSTRUCTIONS

J05970

2014-11-18



VINTAGE WHITE FOOTPEGS

GENERAL

Kit Number

50500406, 50500407

Models

For model fitment information, see the P&A Retail Catalog or the Parts and Accessories section of www.harley-davidson.com (English only).

Kit Contents

See Figure 2 and Table 1.

INSTALLATION

1. Remove the hardware fastening the stock footpeg to the motorcycle footpeg support.
2. Remove the existing footpegs and spring washers. Note the orientation of the spring washers.

NOTE

See Figure 1. When installing the footpeg mount on the motorcycle footpeg support (3), make sure the spring washer (1) is positioned inside of the footpeg support with the straight edge (2) toward the inside of the footpeg support.

3. Install the new footpeg mount in reverse order of stock footpeg mount removal. Place spring washer and footpeg mount inside the slots of the footpeg supports.

⚠ WARNING

Footrests must fold up and toward rear of motorcycle if struck. Failure to set footrests to fold up and back could result in death or serious injury. (00366a)

4. Secure each footpeg mount and spring washer with a screw and locknut from this kit. Tighten the locknuts to 26 N·m (19 ft-lbs).

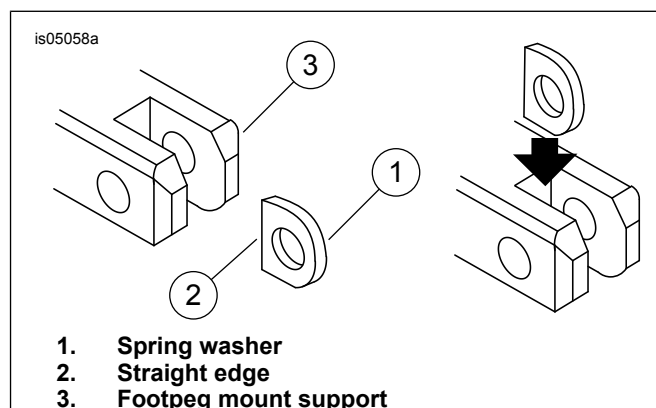

Figure 1. Vintage White Footpeg Spring Washer Installation

In Use

If your white footpegs become discolored, the use of a clean white cloth and common dish soap or Harley-Davidson Wheel and Tire Cleaner (Part No. 93600024) to clean the footpegs will aid in removing any discoloration or stains. Rinse with clean water and dry thoroughly.



Service Parts

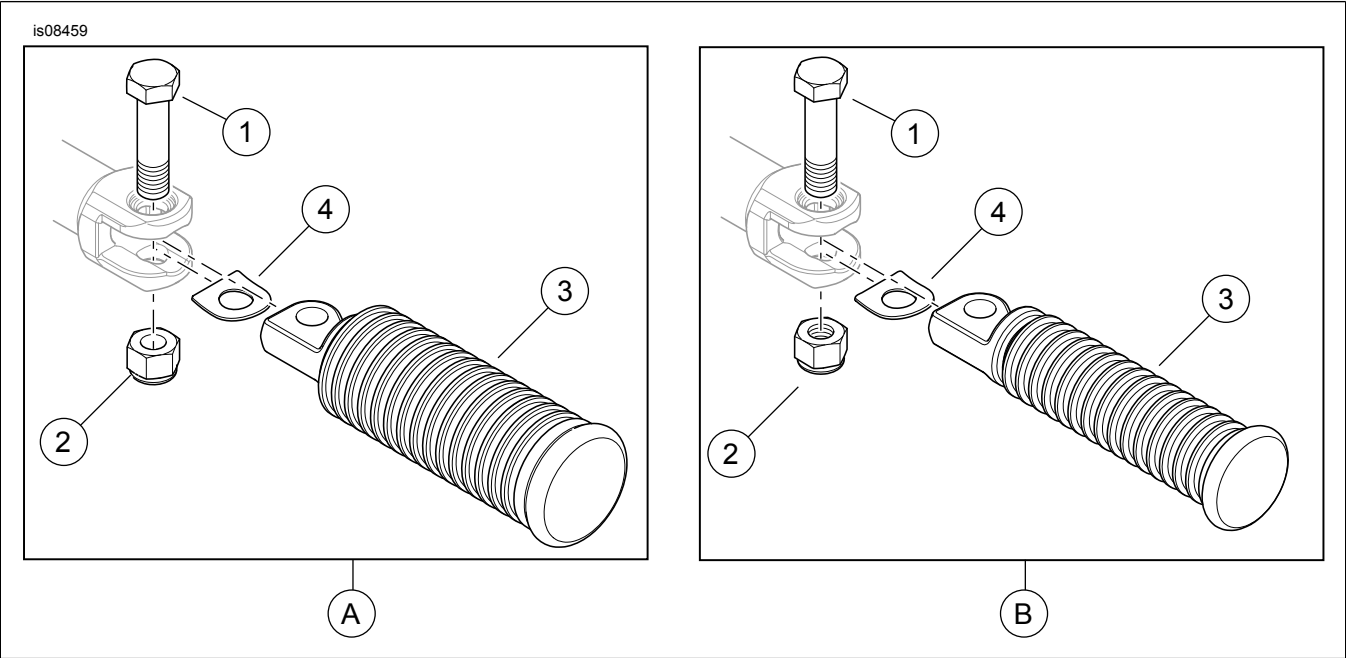

Figure 2. Service Parts: Footpegs

Table 1. Service Parts Table

| Item | Description (Quantity) | Part Number |
|-------------------------|---------------------------------|-------------|
| A - Kit 50500406 | | |
| 1 | Screw (2) | 4721 |
| 2 | Lock nut (2) | 7778 |
| 3 | Footpeg assembly, vintage white | 50500417 |
| 4 | Washer, spring (2) | 50912-72 |
| B - Kit 50500407 | | |
| 1 | Screw (2) | 4721 |
| 2 | Lock nut (2) | 7778 |
| 3 | Footpeg assembly, vintage white | 50500420 |
| 4 | Washer, spring (2) | 50912-72 |