



# INSTRUCTIONS

J05619

2014-11-18



## CHROME SWITCH HOUSING KIT

### GENERAL

#### Kit Number

71500185

#### Models

For model fitment information, see the P&A retail catalog or the Parts and Accessories section of [www.harley-davidson.com](http://www.harley-davidson.com) (English only).

These switch housings are a direct replacement for the original equipment (OE) switch housings and install the same way.

#### Installation Requirements

##### ⚠ WARNING

Rider and passenger safety depend upon the correct installation of this kit. Use the appropriate service manual procedures. If the procedure is not within your capabilities or you do not have the correct tools, have a Harley-Davidson dealer perform the installation. Improper installation of this kit could result in death or serious injury. (00333b)

##### NOTE

This instruction sheet refers to service manual information. A service manual for this year/model motorcycle is required for this installation. One is available from a Harley-Davidson dealer.

#### Kit Contents

See Figure 2 and Table 1.

### PREPARATION

Thoroughly review the entire HANDLEBAR CONTROL MODULES section of the service manual before installing this kit.

##### ⚠ WARNING

To prevent accidental vehicle start-up, which could cause death or serious injury, remove main fuse before proceeding. (00251b)

##### NOTE

- **For vehicles equipped with security siren:** With security fob present, turn ignition switch ON. After system is disarmed, turn ignition switch OFF. **IMMEDIATELY** remove the main fuse per the service manual.
- **For vehicles WITHOUT security siren:** See the service manual to remove the main fuse.

### INSTALLATION

##### NOTE

- Save all hardware for assembly onto the chrome handlebar switch housings.
- Cover painted parts to protect finish.

Refer to the service manual for specific information on the following generalized steps.

1. Remove one handlebar control module.
  - a. Remove two screws and the handlebar clamp.
  - b. Remove hand control lever assembly.
  - c. **For clutch side only:** Gently pry up trigger finger switch cap (A) with a small, flat blade screwdriver. Slide cap left to remove. See Figure 2.
  - d. **Loosen** switch housing captive screws (9). Remove switch housing.
2. Get the correct **new** chrome switch housing front and rear sections from the kit.

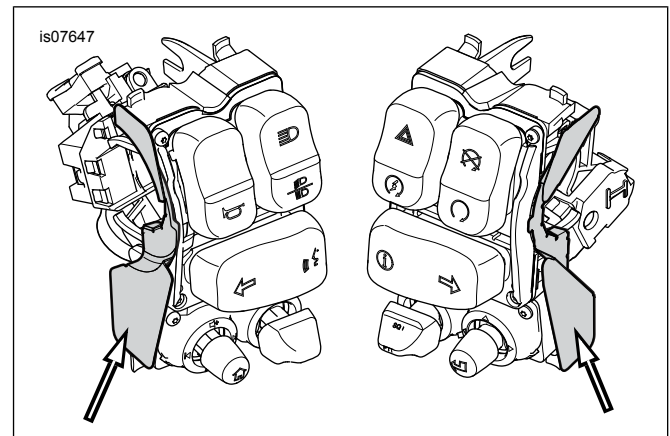

Figure 1. Verify That Shield Is In Correct Position

3. Verify that the shield is in correct position on the outboard side of the switch module. See Figure 1.

##### NOTE

Refer to the service manual for specific information on the following generalized steps.

4. Install the hand control lever assembly.
  - a. Install the switch housing sections onto the switch module. Tighten captive screws (9) until snug.



- b. Install hand control lever assembly.
- c. Install handlebar clamp with two screws removed earlier, but do not tighten. Position hand control lever assembly and switch housing for rider comfort. Tighten hand control clamp screws to 8.1–12.2 N·m (72–108 in-lbs).
- d. Tighten switch housing screws to 4–5 N·m (35–45 in-lbs).
- e. **For brake side only:** Verify free hand grip rotation and slight inboard-outboard free play. **For clutch side only:** Slide trigger finger switch cap right to install.

5. Repeat Steps 1-4 for the remaining handlebar control.

## Completion

### ▲ WARNING

Be sure that steering is smooth and free without interference. Interference with steering could result in loss of vehicle control and death or serious injury. (00371a)

- Make sure wires, clutch cables and brake lines do not pull tight when handlebars are turned fully to left or right fork stops.

### NOTE

Verify that the ignition switch is OFF before installing the main fuse.

- 1. See the service manual to install the main fuse.

### ▲ WARNING

After installing seat, pull upward on seat to be sure it is locked in position. While riding, a loose seat can shift causing loss of control, which could result in death or serious injury. (00070b)

- 2. See the service manual to install the seat.
- 3. Turn the ignition switch ON, but do not start the motorcycle. Check operation of all lamps. Turn the handlebar to the left and right steering stops, testing the handlebar control functions at each stop.

### ▲ WARNING

The left hand control switch pack controls the clutch interlock. A motorcycle with the wrong switch pack installed can start in gear causing loss of control, which could result in death or serious injury. Verify clutch interlock function whenever switch pack is replaced. (00632b)

- 4. Verify clutch interlock function. Perform the following steps in order. **Do not skip any steps. If any test fails, stop and diagnose the condition before proceeding.**
  - a. Turn ignition switch OFF. Remove spark plug cables from spark plugs.

- b. Straddle vehicle. Press and hold the rear brake pedal.
- c. Turn ignition switch ON. Turn the run/stop switch to RUN.
- d. Shift into neutral and release the clutch lever. Briefly push the start switch. The starter should operate.
- e. Shift into the highest gear. Pull in the clutch lever and briefly press the start switch. The starter should operate.
- f. With the clutch lever released and transmission in gear, briefly press the start switch. The starter should not operate.
- g. Turn off the ignition and run/stop switches.
- h. Install spark plug cables.

## SERVICE PARTS

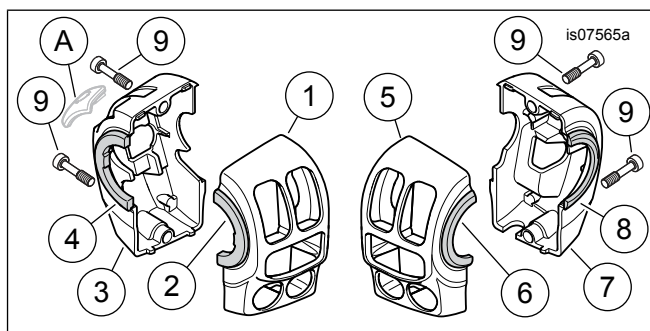

Figure 2. Service Parts, Chrome Switch Housing Kit

Table 1. Service Parts

Item	Description (Quantity)	Part Number
1	Switch housing, left front, chrome (includes Item 2)	71500279
2	• Bushing, left front housing	Not sold separately
3	Switch housing, left rear, chrome (includes Items 4 and 9)	71500280
4	• Bushing, left rear housing	Not sold separately
5	Switch housing, right front, chrome (includes Item 6)	71500281
6	• Bushing, right front housing	Not sold separately
7	Switch housing, right rear, chrome (includes Items 8 and 9)	71500282
8	• Bushing, right rear housing	Not sold separately
9	Screw, #10-24 (4)	Not sold separately
<b>Item mentioned in text.</b>		
A	Trigger finger switch cap (left side only)	