



INSTRUCTIONS

J05979

2016-06-28



BOOM! AUDIO STAGE II FAIRING LOWER SPEAKER KIT

GENERAL

Dealer installation is recommended.

Kit Number

76000353A

Models

For model fitment information, see the P&A retail catalog or the Parts and Accessories section of www.harley-davidson.com (English only).

This kit **does not fit** Twin-Cooled models.

Installation Requirements

FLHX models require prior or concurrent installation of a Harley-Davidson Vented Fairing Lower Kit (Part No. 57100258, unpainted).

ALL models require separate purchase of a Fairing Lower Speaker Box Kit (Part No. 57100233, unpainted).

See the P&A retail catalog or the Parts and Accessories section of www.harley-davidson.com (English only) for color matched versions of these items.

Loctite® 243 Medium Strength Threadlocker and Sealant - Blue (Part No. 99642-97) is required for proper installation of this kit.

NOTE

DO NOT mix Stage I and Stage II speakers on the same vehicle.

These speakers are for use **ONLY** on **2014 and later** Harley-Davidson audio systems. Using these speakers on **2006-2013** Harley-Davidson audio systems **WILL permanently damage these speakers**. Using these speakers on **2005 or earlier** Harley-Davidson audio systems **WILL permanently damage those systems**.

NOTICE

Radio EQ MUST be updated by a Harley-Davidson dealer BEFORE operating the audio system. Operating the audio system prior to radio EQ update will IMMEDIATELY damage the speakers. (00645d)

Radio EQ update using the Digital Technician® II diagnostic tool is:

- Recommended before speaker INSTALLATION
- Required before audio system OPERATION.
- Only available through authorized Harley-Davidson dealers.

NOTE

- These speakers **MUST** be used with an amplifier. **Prior installation of an amplifier (Part No. 76000277A) and a Fairing Lower Speaker Installation Kit (Part No. 76000586) are required. The amplifier mounts inside the right side saddlebag.**

▲ WARNING

Rider and passenger safety depend upon the correct installation of this kit. Use the appropriate service manual procedures. If the procedure is not within your capabilities or you do not have the correct tools, have a Harley-Davidson dealer perform the installation. Improper installation of this kit could result in death or serious injury. (00333b)

NOTE

This instruction sheet references service manual information. A service manual for this year/model motorcycle is required for this installation. One is available from a Harley-Davidson dealer.

Electrical Overload

▲ WARNING

When installing any electrical accessory, be certain not to exceed the maximum amperage rating of the fuse or circuit breaker protecting the affected circuit being modified. Exceeding the maximum amperage can lead to electrical failures, which could result in death or serious injury. (00310a)

NOTICE

It is possible to overload the vehicle's charging system by adding too many electrical accessories. If the combined electrical accessories operating at any one time consume more electrical current than the vehicle's charging system can produce, the electrical consumption can discharge the battery and cause damage to the vehicle's electrical system. (00211d)

The purchase of this kit entitles you to a specially developed sound equalization software that is used with the Advanced Audio System. This unique equalization was designed to optimize the performance and sound response of the BOOM! Audio fairing lower speakers. If this kit is not installed by a Harley-Davidson dealer, this special equalization software is available without charge from any dealer through Digital Technician II. Dealer labor rates may apply for the upgrade procedure.

This amplifier requires up to **8 amps** more current from the electrical system.

Kit Contents

See Figure 12 and Table 1.



PREPARATION

▲ WARNING

To prevent accidental vehicle start-up, which could cause death or serious injury, remove main fuse before proceeding. (00251b)

NOTE

- **WITH security siren:** With security fob present, turn ignition switch ON. See the service manual. After system is disarmed, turn ignition switch OFF. **IMMEDIATELY** remove the main fuse.
- **WITHOUT security siren:** See the service manual. Remove main fuse.

NOTE

See the service manual for specific information on the following generalized steps.

1. **Fairing Lower-Equipped Models:** Remove lower fairings.
2. **ALL Models:** Install an amplifier (Part No. 76000277A) and a Fairing Lower Speaker Installation Kit (Part No. 76000586) inside the right saddlebag per the instructions in that kit.

LOWER FAIRING ASSEMBLY AND INSTALLATION

NOTE

Assemble and install the lower fairing on one side before starting on the second side.

1. See Figure 1. From the back of one fairing, remove rear screws (1).
2. See Figure 2. From the front, remove the screws (3), block-off panel (4) and glove box (2). Disconnect the vent door linkage.
3. See Figure 3. Remove the three glove box screws. Remove the glove box assembly (2).
4. See Figure 4. Remove screw (1). Remove linkage (2). Install on the new enclosure front. Tighten the screw to 1.3–2 N·m (12–18 in-lbs).
5. See Figure 5. Prepare speaker enclosure and bottom tray for gasket seal installation. Clean with a mixture of 50-70 percent isopropyl alcohol and 50-30 percent distilled water.

NOTE

To ease assembly, first install the screws (see Figure 12, item 10) into the enclosure without the tray. Remove the screws.

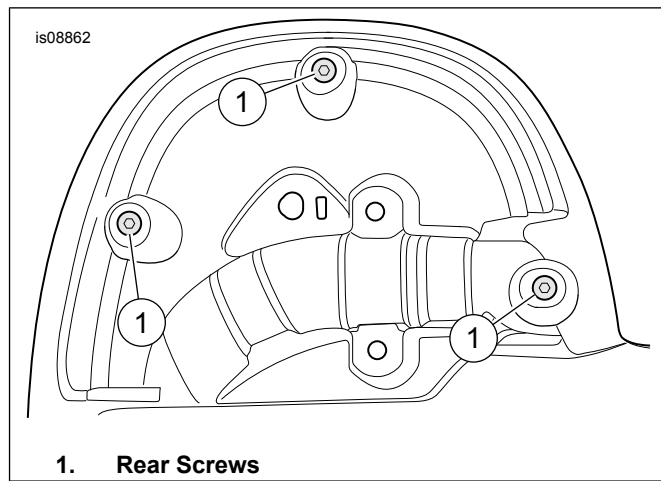

Figure 1. Rear Screws

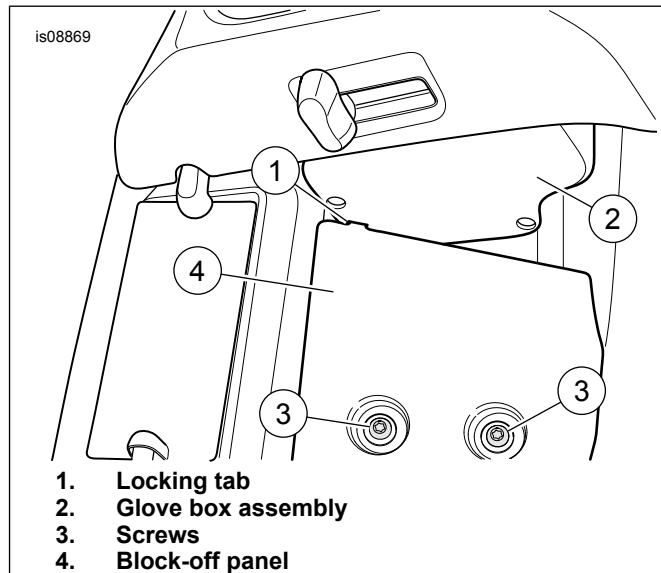

Figure 2. Locking Tab and Block-off Panel

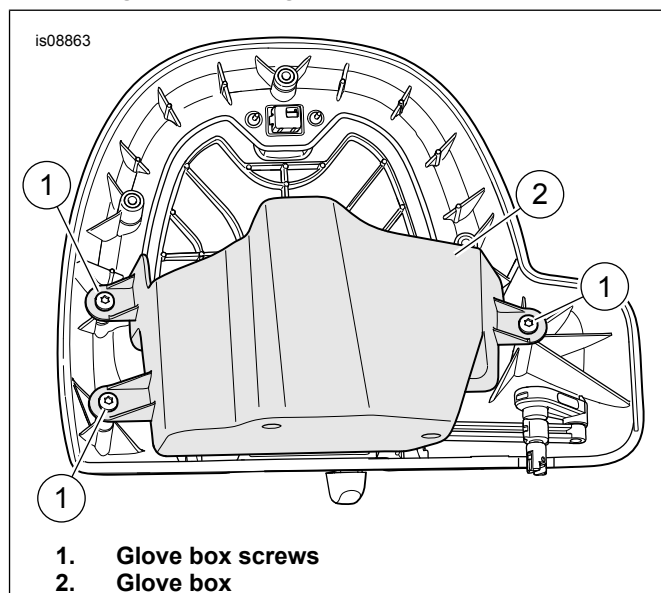

Figure 3. Glove Box Screws

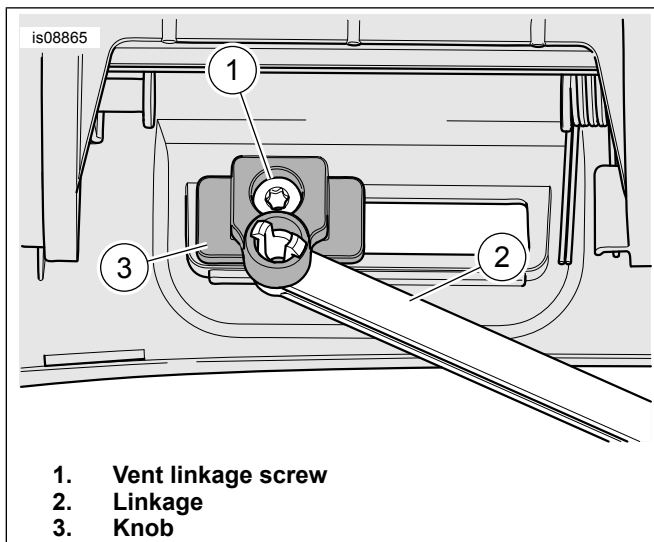

Figure 4. Vent Linkage Screw

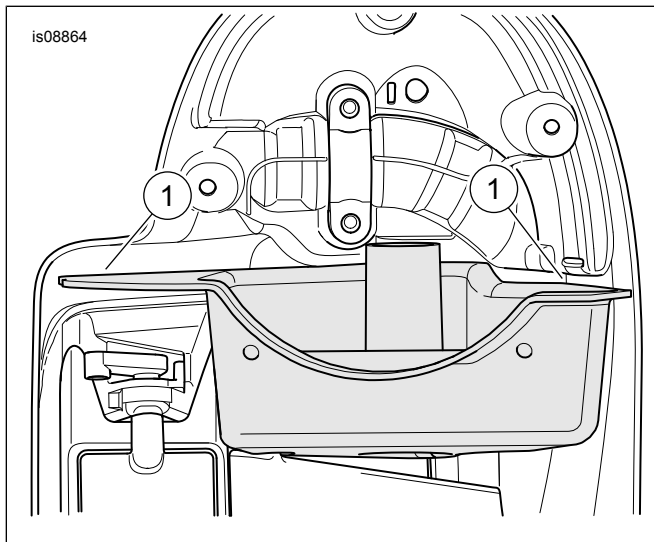

Figure 5. Gasket Mating Surface of Lower Fairing

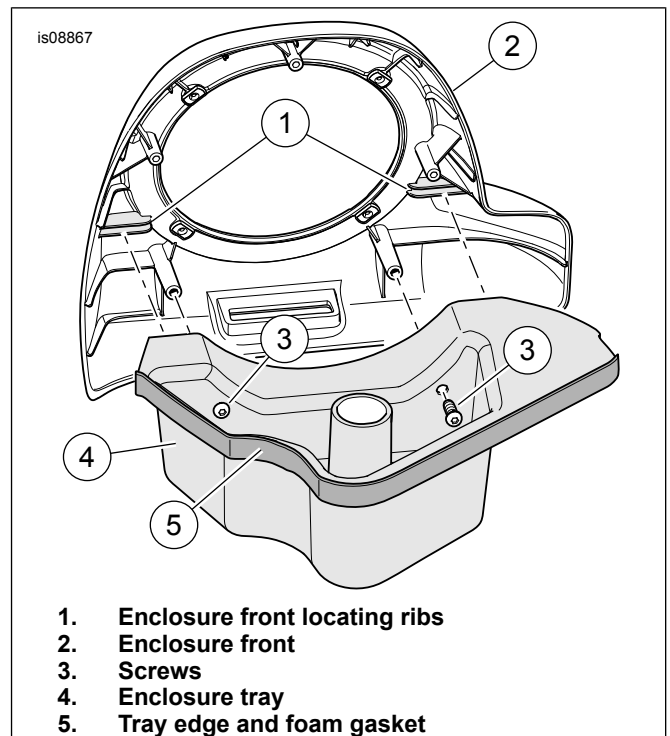

Figure 6. Enclosure Assembly

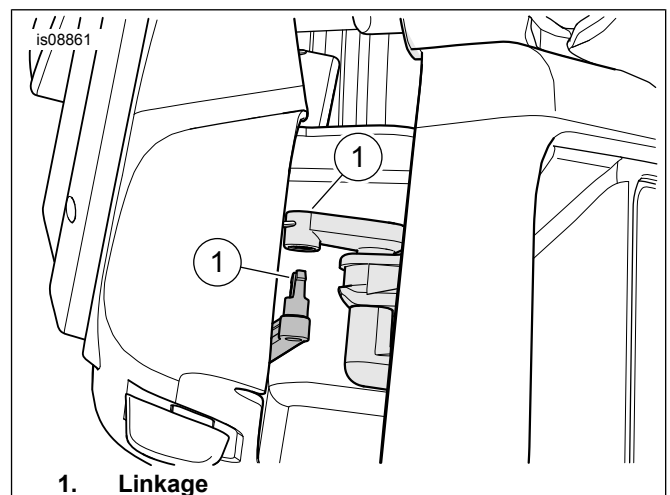
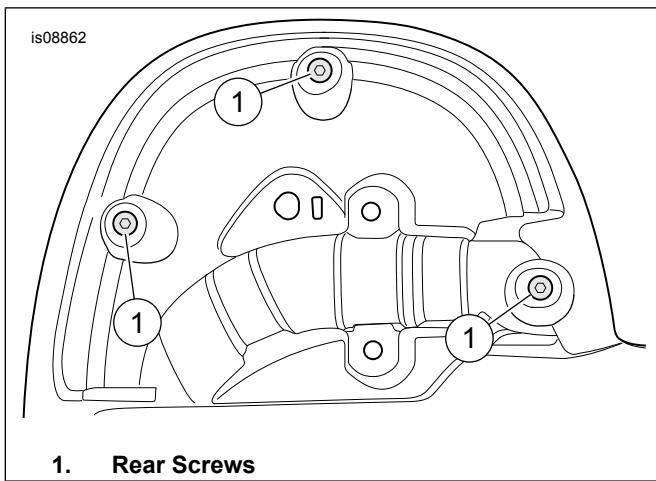

Figure 7. Connect Linkage

6. See Figure 6. Assemble the enclosure tray (4) to the front enclosure (2). Install two self-tapping screws (3). Remove the paper backing from one side of the double-sided foam gasket (5). Install the seal as shown. Trim and save excess foam gasket seal for later use.
7. See Figure 7. Position the enclosure assembly. Connect the linkage.
8. Remove the paper backing from the foam gasket seal before assembling the enclosure sub-assembly. Position the enclosure assembly.
9. See Figure 8. From the rear, install three self-tapping enclosure screws (1). Tighten the screws to 1.3–2 N·m (12–18 in-lbs).



1. Rear Screws

Figure 8. Rear Screws

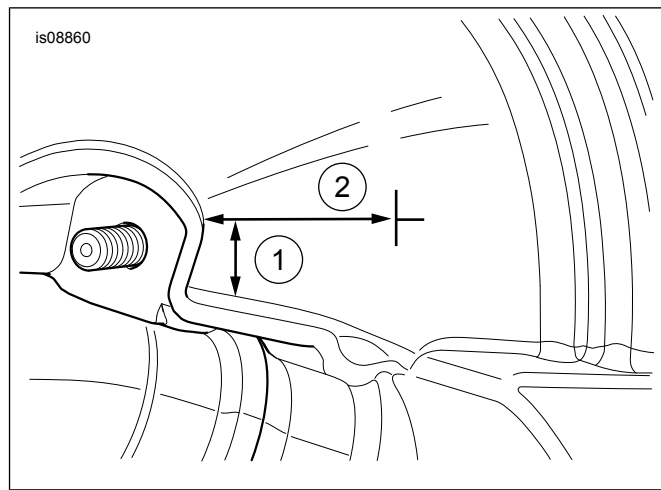
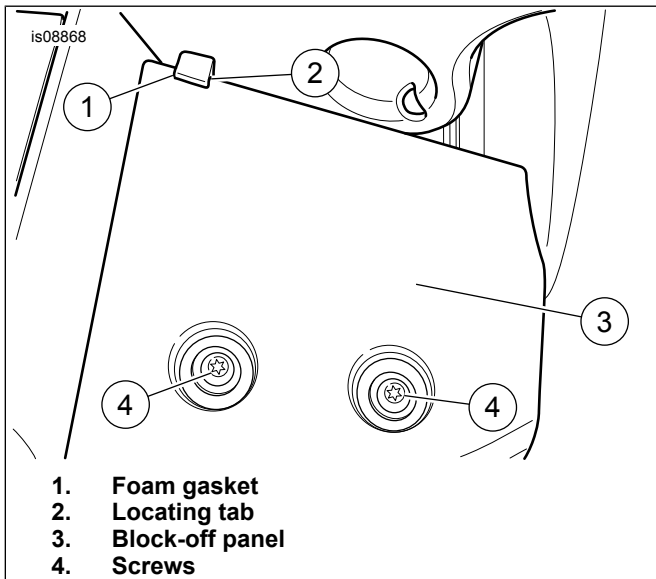

Figure 10. Drill Location



1. Foam gasket
2. Locating tab
3. Block-off panel
4. Screws

Figure 9. Block-off Panel and Locating Tab Foam

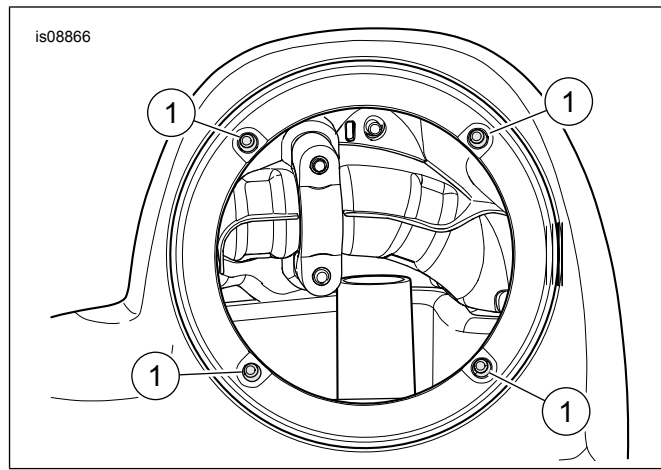

Figure 11. Captive Nuts

10. See Figure 9. Fold a piece of trimmed gasket (1) over the locating tab (2) of the block-off panel. Install the panel (3). Apply a drop of Loctite 243-Blue to the clean screw (4) threads. Install the screws. Tighten to 7.3–8.4 N·m (65–75 in-lbs).
11. See Figure 10. Cover the back side of the glove box in the hole drilling area with masking tape to prevent cracking or chipping of paint. Measure about 25 mm (1.0 in) inboard and 9.5 mm (3/8 in) up from the lower fairing cap mating flange. Mark the location to drill the hole. Drill a 25 mm (1.0 in) hole in the glove box wall.

12. See Figure 11. Insert the four captive nuts from inside the large opening.
13. See the service manual. Install the lower fairing. DO NOT install the lower fairing cap now.
14. Route the speaker wires through the hole in the lower fairing.
 - Light Blue and Light Blue/Black wires to right side.
 - Light Blue/Orange and Light Blue/Gray wires to left side.
15. See Figure 12. Separate the split grommet (12). Install the grommet around the harness leg. Install into the drilled hole in the fairing.
16. Install lower fairing cap.
17. Repeat steps 1-16 for the remaining fairing.
18. Secure wire harness with cable straps. Verify that wiring does not interfere with steering or suspension travel.

NOTE

The fairing lower speakers are side-specific. The left speaker trim ring has the text "BOOM! AUDIO STAGE II" at the top. The right has no text.

19. See Figure 12. Attach the speaker wire connectors inside the speaker enclosure to the spade terminals on the back of the **new** woofer. Different size spade contacts prevent improper assembly.
20. Connect the two-way audio connector of the amplifier harness to the mid-range and tweeter connector (D).
21. Rotate the speaker assembly (1) so the tweeter (C) is 45 degrees outboard from the top.
22. Install the speaker assembly onto the speaker enclosure with the four screws (5) from the kit.
 - a. Start screws carefully to avoid pushing the captive nuts through the mounting holes.
 - b. Use a cross-wise pattern to tighten all four screws to 1.13 N·m (10 **in-lbs**).
23. Repeat steps 19-22 for the remaining speaker enclosure.

▲ WARNING

Be sure that steering is smooth and free without interference. Interference with steering could result in loss of vehicle control and death or serious injury. (00371a)

1. Make sure that wires, harnesses or lines do not pull tight when handlebars are turned fully to left or right fork stops.
2. Verify that steering is smooth and clear from stop to stop.

SERVICE PARTS

Table 1. Service Parts

Item	Description (Quantity)	Part Number
1	Speaker assembly, lower fairing pod (left) (includes items 2-4) Speaker assembly, lower fairing pod (right) (includes items 2-4)	76000627 76000626
2	• Speaker assembly, woofer	Not sold separately
3	• Speaker assembly, tweeter/midrange	Not sold separately
4	• Screw, flat head (3)	Not sold separately
5	Screw, pan head TORX, #6-32 x 25.4 mm (1.0 in) long (black) (8)	10200294
6	Captive nut (8)	10100064
7	Tray, speaker enclosure bottom (left)	76000368
8	Tray, speaker enclosure bottom (right)	76000369
9	Gasket seal, adhesive-backed (2)	25700311
10	Screw, TORX pan head, 1/4-14 x 19 mm (0.75 in) long, self-tapping, black (4)	Not sold separately
11	Screw, TORX pan head, #10-16 x 19 mm (0.75 in) long, self tapping, black (6)	2995
12	Grommet, harness seal (2)	11410
Fairing Lower Speaker Box Kit (not part of Fairing Lower Speaker Kit).		
A	Speaker box kit (includes left and right boxes)	
B	Fairing lower (left shown)	
Items mentioned in text:		
C	Tweeter	
D	Mid-range and tweeter connector	

COMPLETION

NOTE

*To prevent possible damage to the audio system, verify that the ignition and audio system are OFF **before** installing the main fuse.*

NOTICE

Radio EQ MUST be updated by a Harley-Davidson dealer BEFORE operating the audio system. Operating the audio system prior to radio EQ update will IMMEDIATELY damage the speakers. (00645d)

1. See the service manual. Install main fuse.
2. Have a Harley-Davidson dealer update the radio EQ using Digital Technician II.
3. Turn the ignition ON, but do not start the motorcycle.
4. Refer to the BOOM! BOX INFOTAINMENT SYSTEM section of the owner's manual. Turn the radio ON. Make sure that all speakers are working and front/rear fader function is operating correctly. If not, check speaker wiring.
5. See the service manual. Install the outer fairing and windshield.

NOTE

If objectionable vibration occurs due to high levels of bass response, add extra foam between block-off panels and fairing lowers.

IN USE

Avoid direct contact with speaker grilles by a pressure washer. Damage to speakers can result.

SERVICE PARTS

is08435

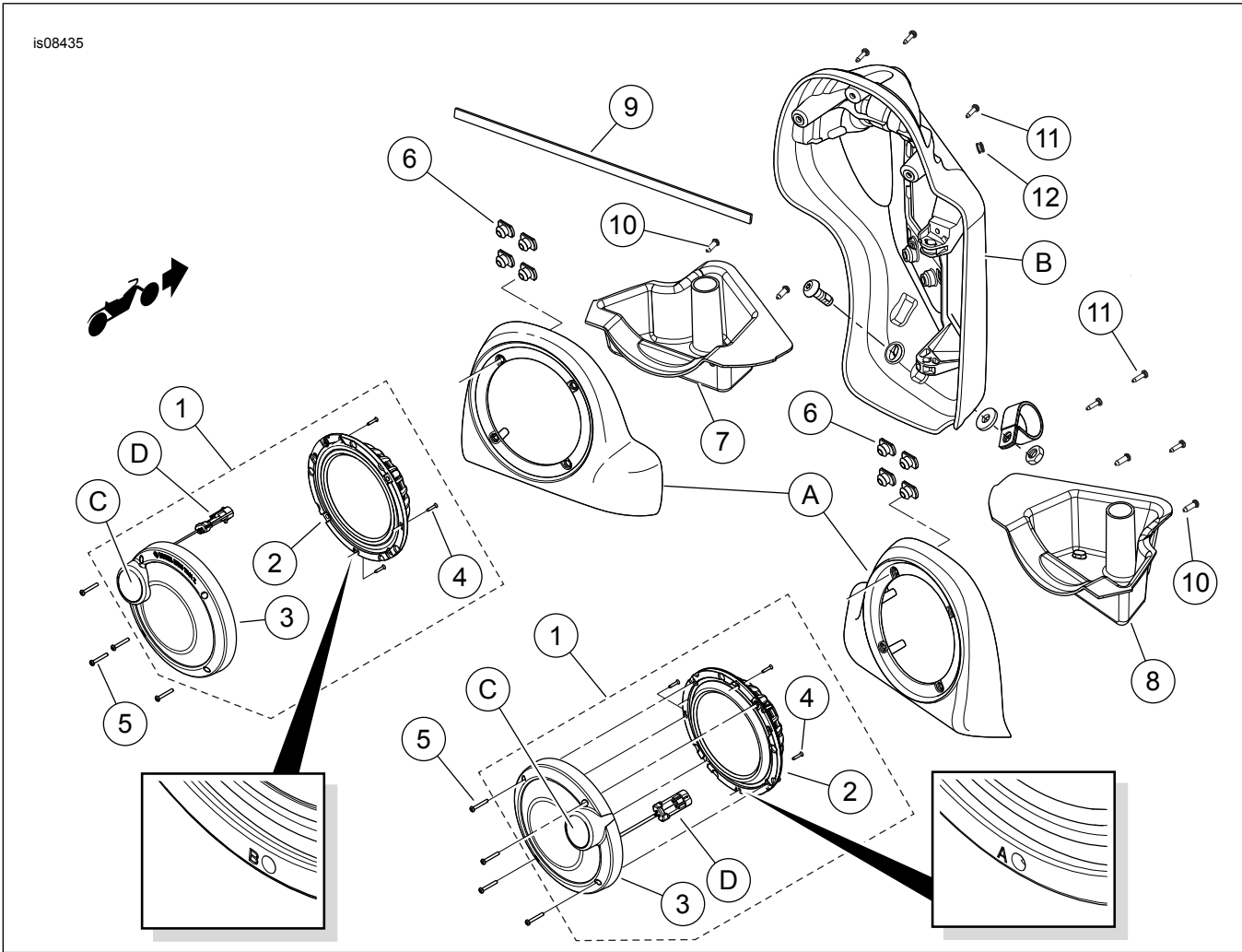

Figure 12. Service Parts, Boom! Audio Stage II Fairing Lower Speaker Kit