



INSTRUCTIONS

J06087

2014-09-05



ROAD ZEPPELIN SEAT

GENERAL

Kit Number

52000201

Models

For model fitment information, see the P&A Retail Catalog or the Parts and Accessories section of www.harley-davidson.com (English only).

Installation Requirements

2014-2016 Touring Models: Separate purchase of an Electrical Connector (Part No. 69200722) is required to connect the accessory circuit connector.

2017 and Later Touring Models: Separate purchase of an Electrical Connector (Part No. 69201599) is required to connect the accessory circuit connector.

NOTE

Models With Tour-Pak® and Rear Speakers: The Tour-Pak may require being moved slightly back in order to install the seat.

⚠ WARNING

Rider and passenger safety depend upon the correct installation of this kit. Use the appropriate service manual procedures. If the procedure is not within your capabilities or you do not have the correct tools, have a Harley-Davidson dealer perform the installation. Improper installation of this kit could result in death or serious injury. (00333b)

NOTE

This instruction sheet references service manual information. A service manual for this year/model motorcycle is required for this installation. One is available from a Harley-Davidson dealer.

Electrical Overload

NOTICE

It is possible to overload the vehicle's charging system by adding too many electrical accessories. If the combined electrical accessories operating at any one time consume more electrical current than the vehicle's charging system can produce, the electrical consumption can discharge the battery and cause damage to the vehicle's electrical system. (00211d)

⚠ WARNING

When installing any electrical accessory, be certain not to exceed the maximum amperage rating of the fuse or circuit breaker protecting the affected circuit being modified. Exceeding the maximum amperage can lead to electrical failures, which could result in death or serious injury. (00310a)

This Road Zeppelin® Seat kit requires up to **6.0 amps** of current from the electrical system.

Kit Contents

NOTICE

There are no serviceable parts inside the unit; leave all servicing to qualified service personnel. Disassembly of the unit could result in equipment damage and/or equipment malfunction. (00172a)

- Disassembly of the seat voids the manufacturer's warranty.

See Figure 7 and Refer to Table 1.

REMOVAL

⚠ WARNING

To prevent accidental vehicle start-up, which could cause death or serious injury, remove main fuse before proceeding. (00251b)

1. Remove main fuse. See the service manual.

NOTE

Cover painted parts to protect finish.

2. Remove the left and right side saddlebags. See the owner's manual.
3. **Models With Tour-Pak:** Loosen mounting screws. Position Tour-Pak in rear-most location. Tighten mounting screws 6.8–8.1 N·m (60–72 in-lbs). Open the Tour-Pak.
4. **Models with fender trim strips:** Remove fender trim strips.
 - a. Cover the tip of a regular screwdriver with a piece of tape to protect chrome and painted surfaces.
 - b. See Figure 1. Insert the tip of the screwdriver between the chrome bezel and the rubber trim strip.
 - c. Pry up the bezel enough to get a hold of it. Pull it up and away from the rubber trim strip.



- d. Starting at either end, peel the rubber trim strip away from the fender.
- e. Clean with a mixture of 50 percent isopropyl alcohol and 50 percent distilled water.

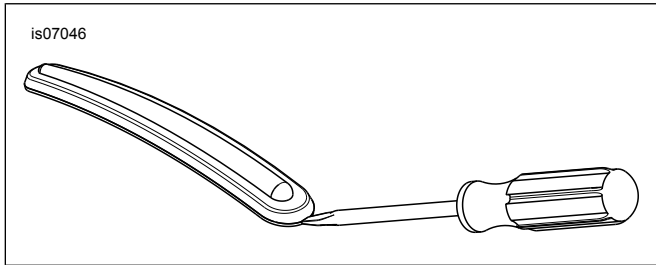

Figure 1. Remove Fender Trim Strip

5. Remove seat. See the service manual.
6. **Models with Tour-Pak:** See the service manual. Loosen or remove Tour-Pak.

INSTALLATION

2017 and Later Touring Models

1. Follow the instructions for installation of electrical connector harness (Part No. 69201599). Route harness under seat. Plug the seat electrical connector into the accessory connector (325B) behind right side panel.

2014-2016 Touring Models

1. Follow the instructions for installation of electrical connector harness (Part No. 69200722). Route harness under seat. Plug the seat electrical connector into the accessory connector (4A) behind left side panel.

2013 and Earlier Models

1. See Figure 2. Remove rubber plug from accessory connector (1) located under seat. Route harness under seat. Plug the seat electrical connector into the accessory connector. The connectors lock together with an audible click.

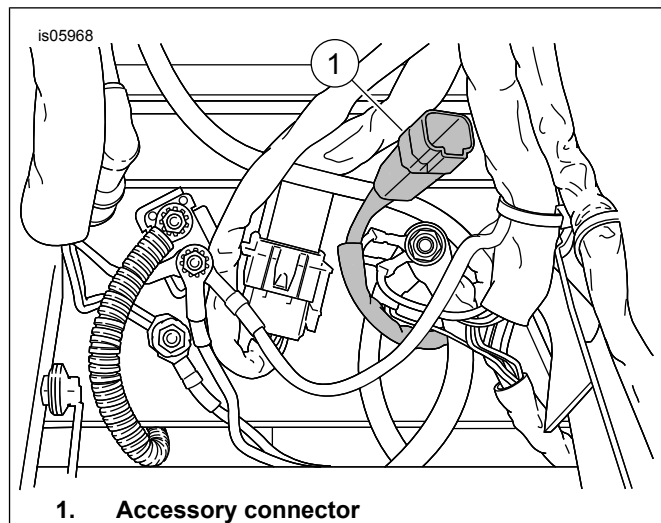

Figure 2. Accessory Connector Location (Under Seat)

All Models

1. Secure loose wires with cable straps.
2. Position the seat on the frame. Make sure that the electrical harness and connector are not pinched between the seat and frame.

▲ WARNING

After installing seat, pull upward on seat to be sure it is locked in position. While riding, a loose seat can shift causing loss of control, which could result in death or serious injury. (00070b)

3. Install seat. See the service manual.
4. See Figure 3. Install the grab strap using the holes shown. Secure with brackets and screws removed earlier.
5. Tighten screws to 20–27 N·m (15–20 ft-lbs).

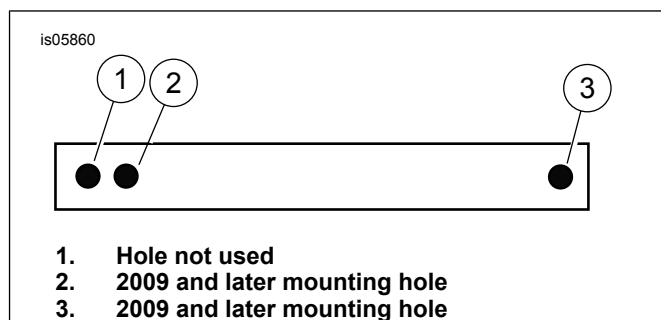

Figure 3. Grab Strap Mounting Holes

6. If a Tour-Pak was loosed or removed, tighten or install now. See the installation instructions or the service manual.
7. Install main fuse. See the service manual.

OPERATION

The seat operates with the ignition switch ON or in the ACCESSORY position. For vehicles with a fairing, verify that the accessory switch in the fairing is ON.

At start-up, the compressor may operate briefly.

Press the raised surface of each button to inflate the chambers. The flat side of the button deflates the chambers.

Rider Thigh Zone

See Figure 4. The first button on the seat control panel inflates and deflates the thigh chambers.

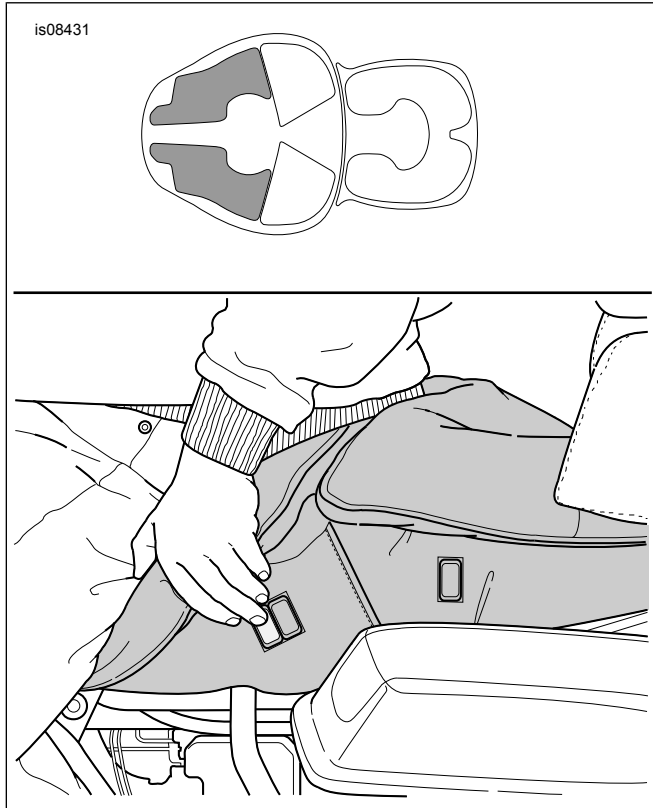

Figure 4. Rider Thigh Control

Rider Lower Back Zone

See Figure 6. The second button on the seat control panel inflates and deflates the lower back chambers.

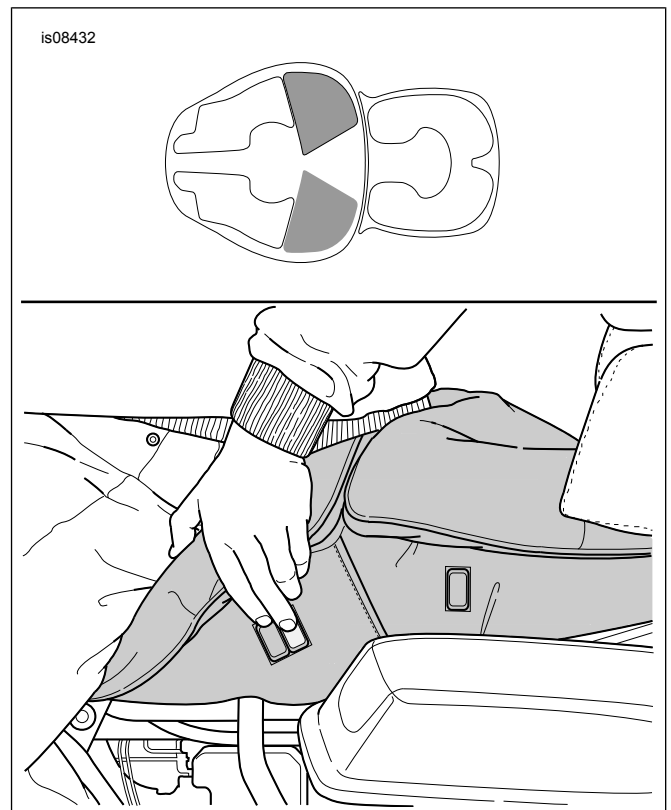

Figure 5. Rider Lower Back

Passenger Seating Area

See Figure 6. The third button on a separate seat control panel inflates and deflates the passenger chambers.

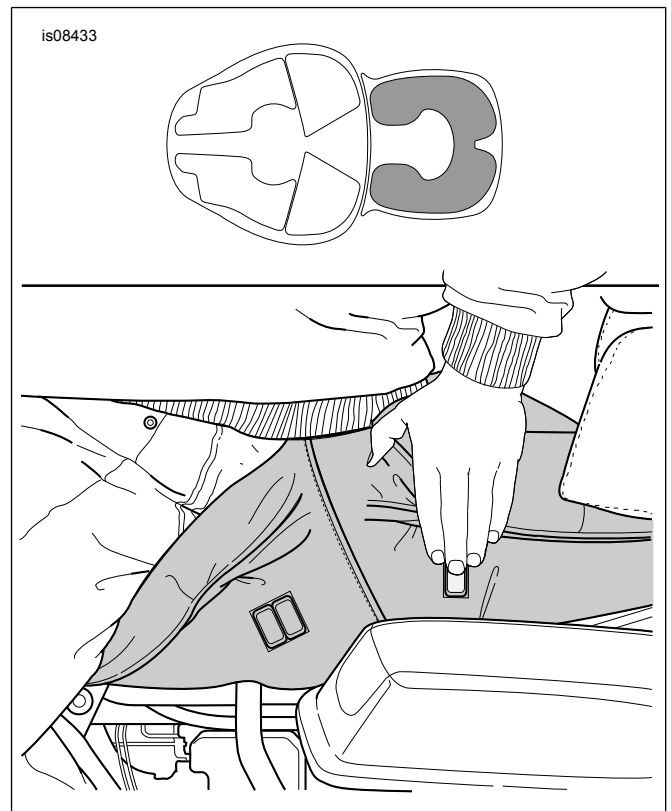

Figure 6. Passenger Seating Area

Riding Recommendations

⚠ WARNING

Do not adjust seat while riding. Adjusting seat while riding can distract the rider and lead to loss of control, which could result in death or serious injury. (00598c)

Before you ride:

- Deflate all chambers completely.
- Adjust the thigh chamber to press firmly, but comfortably, against you.
- Adjust the lower back chamber to press comfortably against you.

City Riding: When riding requires frequent stops, it can be more comfortable to keep the thigh chamber only slightly filled or empty.

Touring: Adjust the thigh chamber to apply firm but comfortable pressure. If desired, adjust the lower back chambers while your feet are in a touring position. On long rides, it may be desired to adjust the seat at every rest stop to change position. This adjustment improves the blood circulation. This change results in less fatigue and improved long-distance comfort.

Passenger Comfort: While seated but not moving:

- Practice finding the switch without looking for the buttons.
- Deflate all the chambers completely.
- Adjust the thigh chamber to press firmly but comfortably against you.

Troubleshooting

- If the compressor continues to run without pressing the inflation buttons, disconnect power to the seat immediately.
- If the seat does not inflate either the rider or the passenger areas when the inflation buttons are pressed, check all electrical connections.

If conditions persist, disconnect the seat electrical power and return to the dealer for further investigation.

SERVICE PARTS

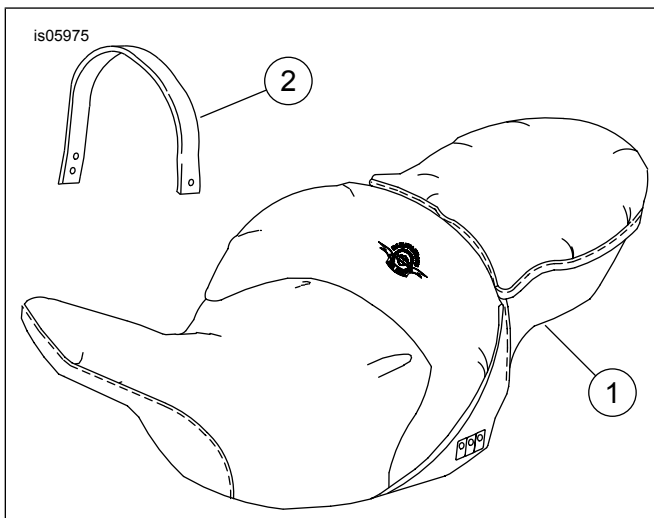

Figure 7. Service Parts: Road Zeppelin Seat

Table 1. Service Parts

Item	Description (Quantity)	Part Number
1	Seat	Not Sold Separately
2	Grab strap	51051-09