



2013-04-26



## SADDLEBAG HINGE COVER AND LEVER KIT

## Kit Number

## Models

## Additional Parts Required

**⚠ WARNING**

## Kit Contents

## REMOVAL

- ## INSTALLATION

## ⚠ WARNING

2. Remove the adhesive backing from the reflector (2). Install the reflector in the faceplate.

3. Install the faceplate assembly with screws (7). Tighten to 4.5–5.1 N·m (40–45 **in-lbs**).
4. Verify the quad seal (9) is fully seated on lever shaft prior to installation. Install lever (6) in saddlebag lid, matching the keyed end of the lever shaft to the pocket in saddlebag lid. Do not pinch or damage quad seal.
5. Install screw (8) and tighten to 4.5–5.1 N·m (40–45 **in-lbs**).
6. Install tether screws. Tighten screws to 4.5–5.1 N·m (40–45 **in-lbs**).
7. Repeat all steps for the other saddlebag.

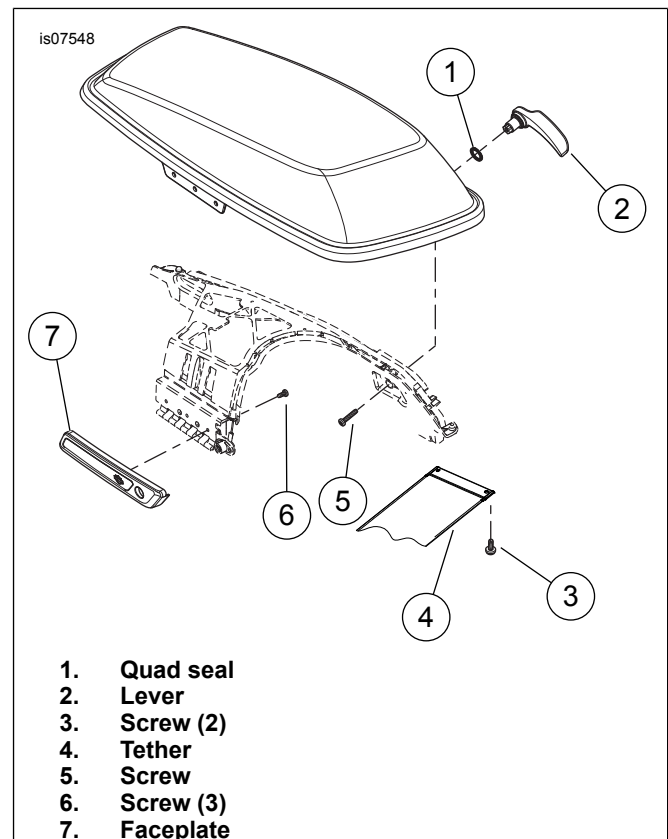

**Figure 1. Hinge Cover and Lever Kit**

SERVICE PARTS

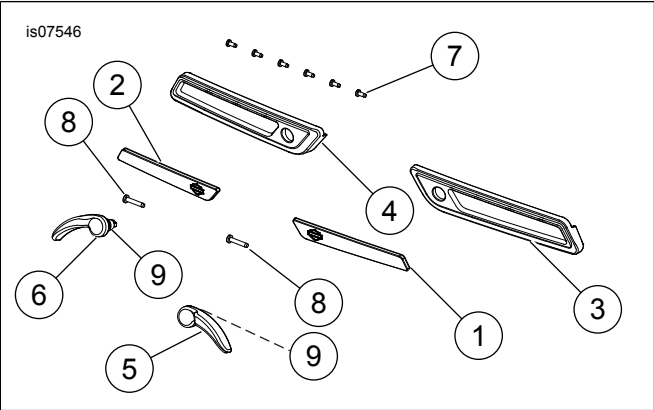

Figure 2. Service Parts: Hinge Cover and Lever Kit

Table 1. Service Parts Table

Item	Description (Quantity)	Part Number
1	Reflector, red, left	67900065
2	Reflector, red, right	67900067
3	Faceplate, left	90200983DH
4	Faceplate, right	90200984DH
5	Lever assembly, left*	Not Sold Separately
6	Lever assembly, right*	Not Sold Separately
7	Screw (6)	10200062
8	Screw (2)	10200064
9	Quad seal (2)	Not Sold Separately
* Lever Kit (Part No. 90201052) is available for separate purchase. Kit includes items 5, 6, 8 and 9.		