



INSTRUCTIONS

J05760

2024-01-19



QUICK-RELEASE SISSY BAR UPRIGHT KIT

GENERAL INFORMATION

Table 1. General Information

Kits	Suggested Tools	Skill Level ⁽¹⁾
52300324A, 52300415	Safety Glasses, Torque Wrench	
(1) Tightening to torque value or other moderate tools and techniques required		

KIT CONTENTS

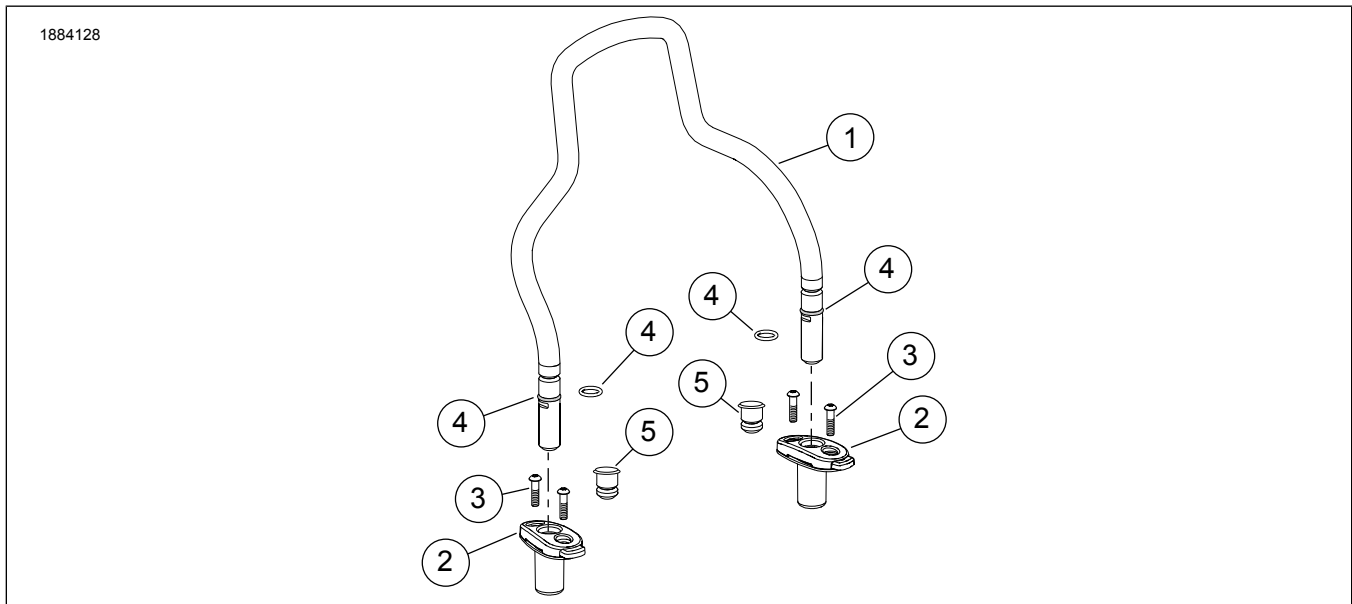

Figure 1. Kit Contents: Quick-Release Sissy Bar Upright Kit

Table 2. Kit Contents: Quick-Release Sissy Bar Upright Kit

<input checked="" type="checkbox"/>	Verify that all contents are present in the kit before installing or removing items from vehicle.				
	Item	Qty	Description	Part No.	Notes
<input type="checkbox"/>	1	1	Upright, backrest, chrome	Not sold separately	
<input type="checkbox"/>		1	Upright, backrest, black	Not sold separately	
<input type="checkbox"/>	2	2	Backrest dock assembly, chrome	52300326A	
<input type="checkbox"/>		2	Backrest dock assembly, black	52300419	
<input type="checkbox"/>	3	4	Screw	94595-98	
<input type="checkbox"/>	4	1	O-ring service kit	91700038	Includes small and large diameter O-rings
<input type="checkbox"/>	5	2	Plug, chrome	12100080	
<input type="checkbox"/>		2	Plug, black	12100098	

GENERAL

NOTE

This instruction sheet **may have a Supplemental Video** to assist installer in clarifying a certain part of the assembly. A linked video would be located at the end of this instruction sheet.

Models

For model fitment information, see the Parts and Accessories (P&A) Retail Catalog or the Parts and Accessories section of www.harley-davidson.com.

Verify that the most current version of the instruction sheet is used. It is available at: h-d.com/isheets

Contact Harley-Davidson Customer Support Center at 1-800-258-2464 (U.S. only) or 1-414-343-4056.

Installation Requirements

⚠ WARNING

Rider and passenger safety depend upon the correct installation of this kit. If the procedure is not within your capabilities or you do not have the correct tools, have a Harley-Davidson dealer perform the installation. Improper installation of this kit could result in death or serious injury. (00308b)

This item is available from a Harley-Davidson dealer.

- Electrical Contact Lube (Part No. 11300004) or equivalent, is required for proper installation of this kit.

REMOVE

1. See Figure 2. Remove trim covers (2) from body (1).
 - a. To prevent damage to paint, use plastic prying tool or equivalent.

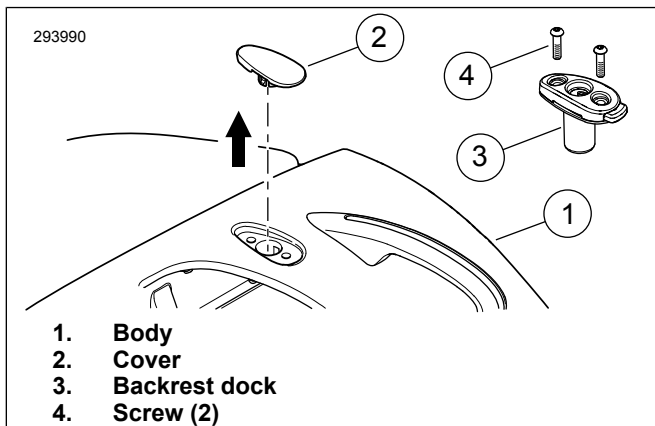

Figure 2. Trim Cover

INSTALL

1. See Figure 2. Install backrest docks (3) to body (1).
2. Install two screws (4) for each dock. Tighten.
Torque: 13.6 N·m (120 in-lbs)
3. See Figure 3. Align and install upright.
 - a. Press release button (1) on backrest dock while inserting one leg of upright.
 - b. Press release button (1) on other backrest dock while inserting opposite leg of upright.
4. While holding both legs of upright, firmly press upright further into backrest docks.
 - a. Release buttons must return to original, extended position to complete installation.

5. See Figure 1. If fit of upright in docks is not snug, remove installed O-rings and replace with larger diameter O-rings. Repeat steps 3 and 4.
 - a. A small amount of electrical contact lube can be applied to surface of each O-ring to aid in installation.

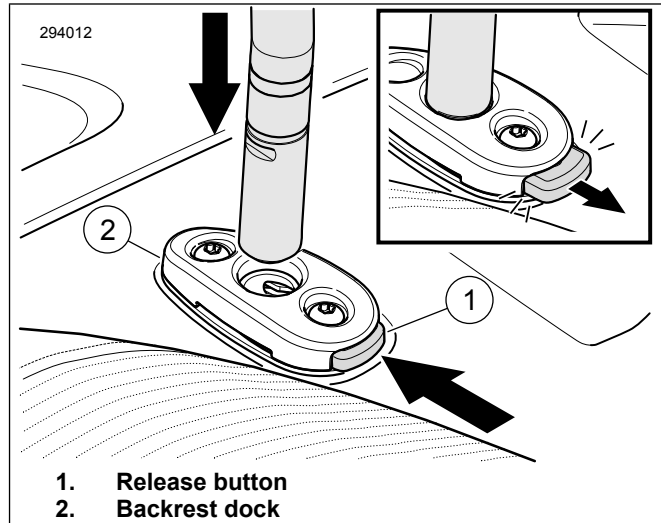

Figure 3. Release Button Locked Position

PLUG

NOTE

Plugs do not require or use O-rings.

1. See Figure 1. When upright (1) is removed, install plugs (5).
2. Follow steps 3-5 for installing or removing upright. Refer to INSTALL.