



INSTRUCTIONS

J04964

2016-09-20



REAR STINGER WHEELS

GENERAL

⚠ WARNING

Install only wheels and installation kits approved for your model motorcycle. Contact a Harley-Davidson dealer to verify fitment. Mismatching wheels and installation kits or installing wheels not approved for your model can cause loss of control, which could result in death or serious injury. (00610c)

Kit Numbers

47835-10, 41509-10

Models

For model fitment information, see the P&A Retail Catalog or the Parts and Accessories section of www.harley-davidson.com (English only).

Kit Contents

See Figure 1 and Table 2.

Additional Parts Required

Kit 41509-10 request the separate purchase of tire (41771-10). Kit 47835-10 requires the separate purchase of tire (43173-01).

Proper installation of this kit requires the separate purchase of the following parts which are available at a Harley-Davidson dealer:

- Wheel Installation Kit (Refer to Table 3. through Table 6 to determine required installation kit.)
- Brake Disc Screws (Refer to Table 1. to determine proper hardware.)
- Rear Sprocket Screws (Refer to Table 1. to determine proper hardware.) See the P&A Retail Catalog for chrome sprocket hardware.
- Wheel Bearing Remover and Installer (94134-09A)

⚠ WARNING

Rider and passenger safety depend upon the correct installation of this kit. Use the appropriate service manual procedures. If the procedure is not within your capabilities or you do not have the correct tools, have a Harley-Davidson dealer perform the installation. Improper installation of this kit could result in death or serious injury. (00333b)

NOTE

This instruction sheet references service manual information. A service manual for this year/model motorcycle is required for this installation. One is available from a Harley-Davidson dealer.

Recommended Additional Parts

Install a floating brake rotor (purchased separately) if objectionable brake noise is experienced from the brake rotors. See the P&A Retail Catalog or the Parts and Accessories section of www.harley-davidson.com (English only).

The following Harley-Davidson Genuine Motor Accessories are recommended for proper maintenance and cleaning:

- Harley® Bright™ Chrome Cleaner (94683-99)
- Harley® Glaze™ Polish and Sealant (99701-84)
- Harley® Wheel and Spoke Brush (43078-99)
- Harley-Davidson® Wheel and Tire Cleaner (94658-98)
- Harley® Preserve Bare Aluminum Protectant (99845-07)

Table 1. Rear Disc and Sprocket Hardware Fitment

| Hardware | Fitment |
|---|---|
| Rear Disc Screws (select stock or chrome hardware) | |
| 5 Stock disc screws (43567-92) | All models |
| Chrome screw kit (46647-05) includes 5 screws | All models |
| Rear Sprocket Screws (select stock or chrome hardware) | |
| 5 Sprocket screw, stock (3109) | 2007 and later Dyna and Softail, 2007 Touring |
| Chrome screw kit (94773-07) includes 5 screws and washers | 2007 and later Dyna and Softail |
| 5 Sprocket screw, stock (3737A) | 2000-2005 Dyna, 2000-2006 Softail, 2004-2006 Touring |
| Chrome screw kit (94773-00A) includes 5 screws and washers | 2000-2005 Dyna, 2000-2006 Softail |
| 5 Sprocket screw, stock (3814) | 2008 Touring |
| 5 Sprocket screw, stock (3873) | 2006 Dyna |
| 5 Sprocket screw, stock (3899) | 2000-2003 Touring, 2001 and later Sportster (except Japanese models) |
| 5 Sprocket screw, stock (40439-01) | 2002-2006 VRSC and 2007 VRSCR models |
| 5 Sprocket screw, stock (4552) | 2007 and later VRSC models (except VRSCR and VRSCSE models) |
| Rear Sprocket Washers | |
| 5 Sprocket washer, stock (6516HW) | 2006 and earlier Dyna, Softail and Touring and 2000 and later Sportster models (except Japanese models) |
| 5 Sprocket washer, stock (7039) | 2002 and later VRSC |

INSTALLATION

NOTE

Before removing or installing the wheel, the rear brake caliper must be removed. The cotter pin or spring clip for the axle nut must be replaced. They are available for separate purchase



from a Harley-Davidson dealer. See dealer for the correct part number.

1. Remove existing rear wheel assembly. Save axle, axle nut, brake disc and wheel spacers for kit installation. See the service manual.

NOTE

For Kit 41509-10 install short valve stem (43157-83A) included in the installation kit.

For Kit 47835-10 install long valve stem (43206-01) included in the installation kit.

2. See Figure 1. Install valve stem assembly (H or I) on wheel. See the service manual.

NOTICE

Do not re-use brake disc/rotor screws. Re-using these screws can result in torque loss and damage to brake components. (00319c)

NOTICE

Do not re-use sprocket mounting screws. Re-using sprocket mounting screws can result in torque loss and damage to the sprocket and/or belt assembly. (00480b)

3. Assemble wheel installation kit components, brake disc and sprocket to wheel, using the appropriate service parts table. See the service manual.

4. Install primary bearing with a Wheel Bearing Remover and Installer. See the service manual. The hub face with the machined groove(s) indicates the primary bearing side.

NOTE

Only install the required (separately purchased) tire.

If the wheel has a yellow dot sticker on the rim, orient the tire so the white dot is opposite of the sticker. If the wheel has a green dot sticker on the rim, orient the tire so the white dot is aligned with the sticker. If no rim dot sticker is present, see the service manual.

5. Mount new tire (purchased separately) to the wheel. See the service manual.
6. Install rear wheel (1), stock axle, sprocket and stock spacers to motorcycle. See the service manual.

MAINTENANCE AND CLEANING

Chrome parts must be maintained regularly so they keep their original shine and luster.

1. Clean heavily-soiled wheel surfaces using Harley-Davidson Wheel and Tire Cleaner, applied with Harley Wheel and Spoke Brush.
2. Thoroughly clean chrome with a good quality chrome cleaner, such as Harley Bright Chrome Cleaner.
3. After cleaning and polishing, seal the finish with a good quality sealer, such as Harley Glaze Polish and Sealant.

SERVICE PARTS

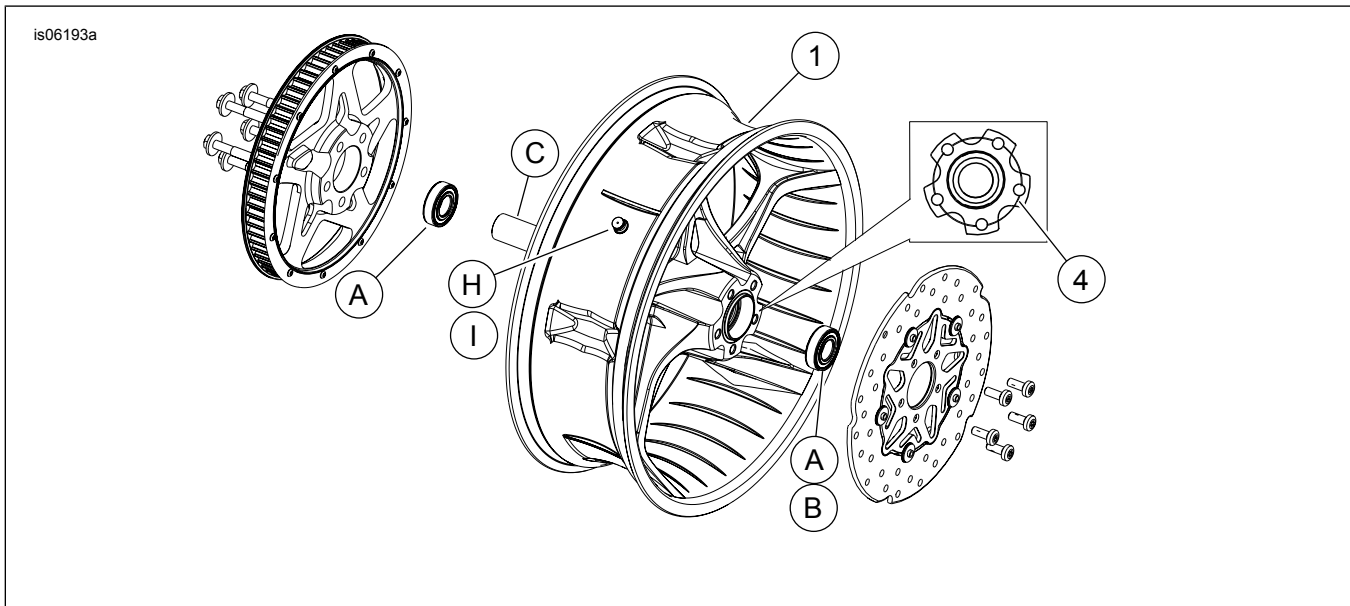

Figure 1. Service Parts: Rear Stinger Wheel

Table 2. Service Parts and Wheel Kit Contents

| Kit | Item | Description (Quantity) | Part Number |
|--------------------|------|-------------------------------------|---------------------|
| 47835-10, 41509-10 | 1 | Wheel | Not Sold Separately |
| | | Visual indicator mentioned in text: | |
| | 4 | Machined groove (all wheels) | |

Table 3. REAR 25 MM Bearing Wheel Installation Kit (41451-08B)

| REAR 25 MM Bearing Wheel Installation Kit (41451-08B) | | Item (Quantity Used and Description) | | | | | |
|---|-------------|--------------------------------------|-----------------------|----|-----------|---|---|
| Fitment | Wheel Size | A | C | F | H | I | J |
| 2008 and later FXDF | 16 x 5.0 in | 2 | 1 | 0 | * | * | * |
| 2008 and later Dyna (except FXDF) and 2012 and later FLD | 17 x 4.5 in | 2 | 1 | ** | * | * | * |
| 2008 and later FXDF | 18 x 6.0 in | 2 | 1 | 0 | * | * | * |
| Installation kits are designed to work with many different wheel styles and fitments. Contact a Harley-Davidson dealer to verify that the wheel and installation kits are both designed and approved for the motorcycle they are being installed on. NOTES: * See NOTE above valve installation step in INSTALLATION to determine which valve stem to use for your particular kit. Discard other valve stem(s). ** See NOTES for your wheel kit above the wheel assembly step in INSTALLATION to determine which bearing shim to use for your particular wheel kit and fitment. *** Bearing shim installed under the primary bearing. | | A | Bearing, regular (2) | | 9276 | | |
| | | C | Axle sleeve | | 43905-08 | | |
| | | F | Bearing shim*** | | 43904-08 | | |
| | | H | Valve stem, short | | 43157-83A | | |
| | | I | Valve stem, long | | 43206-01 | | |
| | | J | Valve stem, pull-thru | | 40999-87 | | |

Table 4. REAR 25mm Bearing Wheel Installation Kit (43878-08B)

| REAR 25 MM Bearing Wheel Installation Kit (43878-08B) | | Item (Quantity Used and Description) | | | | | | |
|---|-------------|--------------------------------------|-----------------------|---|-----------|---|---|---|
| Fitment | Wheel Size | A | C | D | F | H | I | J |
| 2008 and later FLSTN, FLSTC, FLS and FXS without ABS | 16 x 3.0 in | 2 | 1 | 0 | 0 | * | * | 0 |
| 2008 FLT without ABS | 16 x 3.0 in | 2 | 0 | 1 | 1 | * | * | 0 |
| 2008 and later XL (except 2011 and later XL883L) | 16 x 3.0 in | 2 | 0 | 1 | ** | * | * | * |
| 2008 and later FXSTB, FXSTC, FLSTF, FLSTSB and FLSTFB without ABS | 17 x 6.0 in | 2 | 1 | 0 | 0 | * | * | 0 |
| 2008 and later FXSTB, FXSTC, FLSTF, FLSTSB and FLSTFB without ABS | 18 x 6.0 in | 2 | 1 | 0 | 0 | * | * | 0 |
| Installation kits are designed to work with many different wheel styles and fitments. Contact a Harley-Davidson dealer to verify that the wheel and installation kits are both designed and approved for the motorcycle they are being installed on. NOTES: * See NOTE above valve installation step in INSTALLATION to determine which valve stem to use for your particular kit. Discard other valve stem(s). ** See NOTES for your wheel kit above the wheel assembly step in INSTALLATION to determine which bearing shim to use for your particular wheel kit and fitment. *** Bearing shim installed under primary bearing. | | A | Bearing, regular (2) | | 9276 | | | |
| | | C | Axle sleeve | | 41696-08 | | | |
| | | D | Axle sleeve | | 41900-08 | | | |
| | | F | Bearing shim*** | | 43904-08 | | | |
| | | H | Valve stem, short | | 43157-83A | | | |
| | | I | Valve stem, long | | 43206-01 | | | |
| | | J | Valve stem, pull thru | | 40999-87 | | | |

Table 5. REAR 25 MM Bearing ABS Wheel Installation Kit (43077-11A)

| REAR 25 MM Bearing ABS Wheel Installation Kit (43077-11A) | | Item (Quantity Used and Description) | | | | | | |
|--|-------------|--------------------------------------|-------------------|---|-----------|---|---|---|
| Fitment | Wheel Size | A | B | C | D | E | H | I |
| 2011 and later FLSTN, FLSTC, FLS and FXS with ABS | 16 x 3.0 in | 1 | 1 | 0 | 1 | 0 | * | * |
| 2011 and later FXST, FLSTF and FLSTFB with ABS | 17 x 6.0 in | 1 | 1 | 0 | 1 | 0 | * | * |
| 2011 and later FXST, FLSTF and FLSTFB with ABS | 18 x 6.0 in | 1 | 1 | 0 | 1 | 0 | * | * |
| 2011 and later FXCWC with ABS | 18 x 8.0 in | 1 | 1 | 1 | 0 | 0 | * | * |
| 2017 and later XG500 and XG750 with ABS | 15 x 3.5 in | 1 | 1 | 0 | 0 | 1 | * | * |
| Installation kits are designed to work with many different wheel styles and fitments. Contact a Harley-Davidson dealer to verify that the wheel and installation kits are both designed and approved for the motorcycle they are being installed on. NOTES: * See NOTE above valve installation step in INSTALLATION to determine which valve stem to use for your particular kit. Discard other valve stem(s). ** Primary bearing. Bearing must be installed with red side facing the wheel. | | A | Bearing, regular | | 9276 | | | |
| | | B | Bearing, ABS** | | 9252 | | | |
| | | C | Axle sleeve | | 41358-08 | | | |
| | | D | Axle sleeve | | 41696-08 | | | |
| | | E | Axle sleeve | | 43300098 | | | |
| | | H | Valve stem, short | | 43157-83A | | | |
| | | I | Valve stem, long | | 43206-01 | | | |

Table 6. REAR 25 MM Bearing ABS Wheel Installation Kit (42400003)

| REAR 25 MM Bearing ABS Wheel Installation Kit (42400003) | | Item (Quantity Used and Description) | | | | | | |
|--|-------------|--------------------------------------|---|---|---|---|---|---|
| Fitment | Wheel Size | A | B | C | F | H | I | J |
| 2008 and later FXDF | 16 x 5.0 in | 1 | 1 | 1 | 0 | * | * | * |
| 2008 and later Dyna (except FXDF and FLD) | 17 x 4.5 in | 1 | 1 | 1 | 1 | * | * | * |
| 2012 FLD | 17 x 4.5 in | 1 | 1 | 1 | 0 | * | * | * |
| 2008 and later FXDF | 18 x 6.0 in | 1 | 1 | 1 | 0 | * | * | * |

Table 6. REAR 25 MM Bearing ABS Wheel Installation Kit (42400003)

| REAR 25 MM Bearing ABS Wheel Installation Kit (42400003) | | Item (Quantity Used and Description) | | | | | | |
|--|------------|--------------------------------------|-----------------------|---|---|---|-----------|---|
| Fitment | Wheel Size | A | B | C | F | H | I | J |
| Installation kits are designed to work with many different wheel styles and fitments. Contact a Harley-Davidson dealer to verify that the wheel and installation kits are both designed and approved for the motorcycle they are being installed on. NOTES: * See <i>NOTE</i> above valve installation step in <i>INSTALLATION</i> to determine which valve stem to use for your particular kit. Discard other valve stem(s). ** Primary bearing. Bearing must be installed with red side facing the wheel. | | A | Bearing, regular | | | | 9276 | |
| | | B | Bearing, ABS** | | | | 9252 | |
| | | C | Axle sleeve | | | | 43905-08 | |
| | | F | Bearing shim | | | | 43904-08 | |
| | | H | Valve stem, short | | | | 43157-83A | |
| | | J | Valve stem, pull-thru | | | | 40999-87 | |