



INSTRUCTIONS

J06362

2017-01-16



XL OIL TANK BEZEL, GLOSS BLACK

GENERAL

Kit Number

61400428

Models

For model fitment information, see the P&A retail catalog or the Parts and Accessories section of www.harley-davidson.com (English only).

Kit Contents

This kit consists of a new gloss black oil tank bezel, a push nut and these instructions. The push nut (Part No. 8135B) is also available separately.

REMOVAL

1. See Figure 1. Remove filler cap/dipstick (1) from oil tank (2) on right side of vehicle.
 - a. Press straight down on filler cap/dipstick, then release. Cap pops up.
 - b. Pull up on filler cap/dipstick while turning counterclockwise one-quarter turn to unscrew cap. Remove filler cap/dipstick.
2. Remove right hand side cover (3) by gently prying bottom lip of cover off tab on oil tank. Lift cover up slightly so mounting holes (7) on top of cover clear mounting posts (8) on oil tank. Remove cover.
3. To remove bezel (4), remove the push nut (6). Press outward on the locating pin (5) on the inside of the bezel until the bezel separates from the side cover. Discard the push nut.

INSTALLATION

1. See Figure 1. Press the **new** gloss black bezel (4) into position on the side cover (3), aligning the locating pin (5) with the small hole.
2. Secure the bezel with the **new** push nut (6) from the kit.
3. Place top of side cover onto right side of oil tank (2) so that mounting holes (7) in top of cover fit onto mounting posts (8) on oil tank.
4. Press bottom of side cover in place on oil tank so that slot in bottom of cover snaps onto mounting tab on oil tank.

NOTE

See Figure 2. Note that filler cap/dipstick has a wide slot (1) and a narrow slot (2) and can only be inserted in oil tank one way.

5. See Figure 1. Insert filler cap/dipstick (1) into oil tank (2). Press down on filler cap while turning clockwise one-quarter turn to screw filler cap into oil tank. When cap stops turning, it is fully seated. Press down on cap until it snaps into place, flush with top of right hand side cover (3).

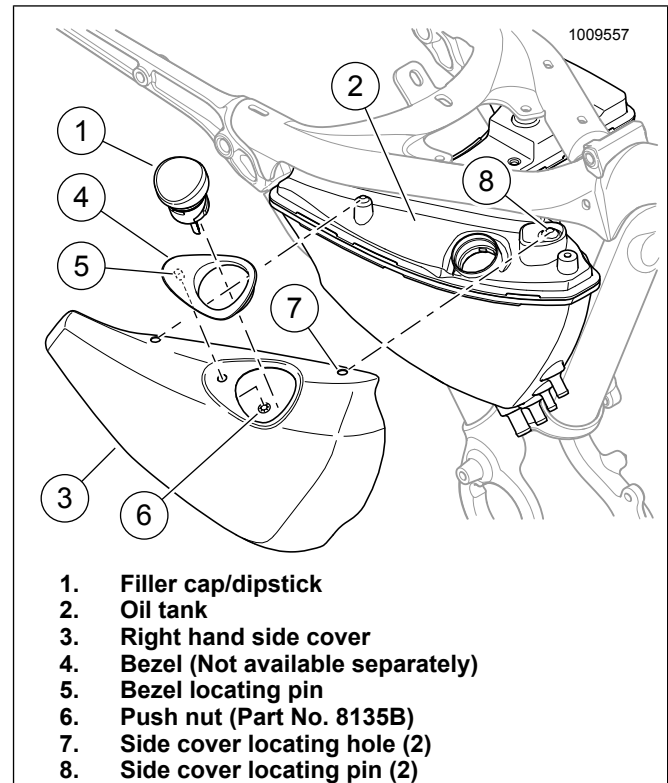

Figure 1. Right Hand Side Cover Installation

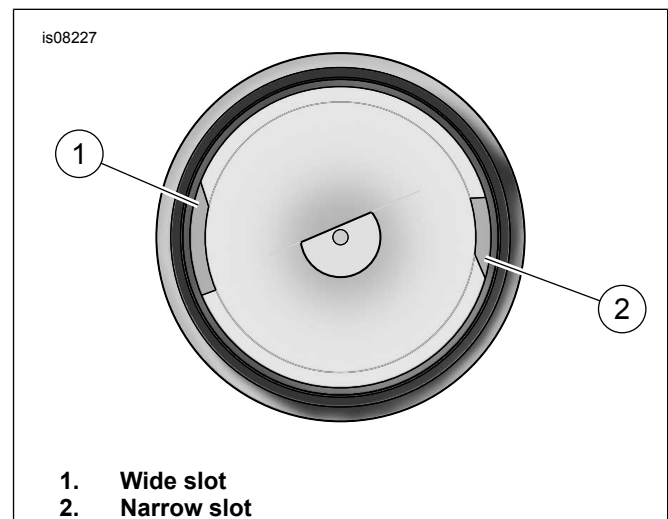

Figure 2. Filler Cap/Dipstick