



# INSTRUCTIONS

J05927

2017-08-23



## PASSING LAMP TRIM RINGS

### GENERAL

#### Kit Number

61400255, 61400353, 61400354, 61400355

#### Models

For model fitment information, see the P&A Retail Catalog or the Parts and Accessories section of [www.harley-davidson.com](http://www.harley-davidson.com) (English only).

#### ⚠ WARNING

Rider and passenger safety depend upon the correct installation of this kit. If the procedure is not within your capabilities or you do not have the correct tools, have a Harley-Davidson dealer perform the installation. Improper installation of this kit could result in death or serious injury. (00308b)

#### Kit Contents

See Figure 1 and Table 1.

### INSTALLATION

- Loosen the screw from one original equipment passing lamp trim ring. Remove the ring.
- See Figure 1. Remove the screw (2) from the accessory trim ring (1) and set aside temporarily.
- Insert the passing lamp sealed unit (B) inside the new trim ring.

#### NOTE

*Rotating the lamp unit may help insertion.*

- Position the bottom of the lamp unit to line up with the split in the trim ring.
- 2002 and later models:**
  - Install the adapter ring (C) onto the passing lamp housing.
  - Install the trim ring and lamp assembly onto the adapter ring.
  - Align the lug (or lugs) on the back of the glass lamp unit with the notches in the adapter ring.
- 1962 through 2001 models:**
  - Install the trim ring and lamp assembly onto the passing lamp housing.

- Align the lug (or lugs) on the back of the glass lamp unit with the notches in the passing lamp housing.

- Assemble the screw into the trim ring. Tighten to:  
Torque: 0.8–1 N·m (7–9 in-lbs) *Trim Ring Screw*

### SERVICE PARTS

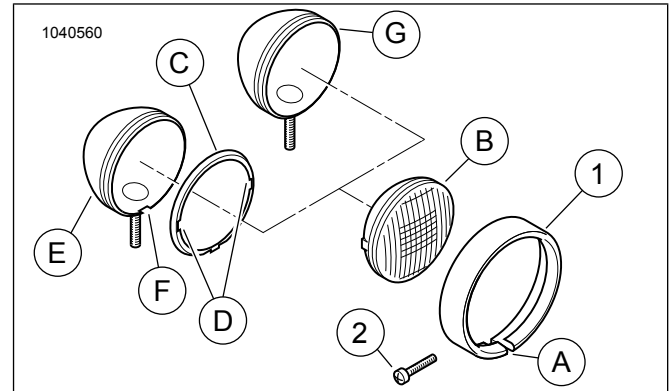

Figure 1. Passing Lamp Trim Rings

Table 1. Service Parts: Passing Lamp Trim Rings

Item	Description (Quantity)	Part Number
1	Trim Ring	Not Sold Separately
2	Screw (6-32 x .625) (Kit 61400255)	10200394
	Screw (6-32 x .650) (Kits 61400353, 61400354, 61400355)	12600072
A	Split in trim ring	Reference only
B	Passing lamp sealed unit	Reference only
C	Adapter ring (2002 and later)	Reference only
D	Alignment notches	Reference only
E	Passing lamp housing (2002 and later)	Reference only
F	Alignment notch	Reference only
G	Passing lamp housing (1962-2001)	Reference only