



INSTRUCTIONS

J03842

2023-11-30



SECURITY SYSTEM SMART SIREN II KIT

GENERAL

Kit Numbers

68328-06A, 68328-06B

Models

For model fitment information, see the P&A retail catalog or the Parts and Accessories section of www.harley-davidson.com (English only).

Installation Requirements

The vehicle must be equipped with a Harley-Davidson® Factory Security System or Smart Security System before this kit can be installed. See the P&A retail catalog or the Parts and Accessories section of www.harley-davidson.com (English only) for Security System and model fitment information.

⚠ WARNING

Rider and passenger safety depend upon the correct installation of this kit. Use the appropriate service manual procedures. If the procedure is not within your capabilities or you do not have the correct tools, have a Harley-Davidson dealer perform the installation. Improper installation of this kit could result in death or serious injury. (00333b)

NOTE

This instruction sheet references to service manual information. A service manual for this year/model motorcycle is required for this installation. One is available from a Harley-Davidson dealer.

Kit Contents

See Figure 33 and Table 2.

PREPARATION

For Vehicles With Main Fuse:

⚠ WARNING

To prevent accidental vehicle start-up, which could cause death or serious injury, remove main fuse before proceeding. (00251b)

NOTE

- **For 2007- later vehicles equipped with security siren:** With security fob present, turn ignition switch ON. After system is disarmed, turn ignition switch OFF. **IMMEDIATELY** remove the main fuse per the service manual.
- **For 2006- earlier vehicles equipped with security siren:** Disarm the siren with the key fob or security code. See the service manual to remove the main fuse.

- **For vehicles WITHOUT security siren:** See the service manual to remove the main fuse.

1. **All models except VRSC:** Remove seat. Retain the seat and all mounting hardware.

For Vehicles With Main Circuit Breaker:

⚠ WARNING

To prevent accidental vehicle start-up, which could cause death or serious injury, disconnect battery cables (negative (-) cable first) before proceeding. (00307a)

⚠ WARNING

Disconnect negative (-) battery cable first. If positive (+) cable should contact ground with negative (-) cable connected, the resulting sparks can cause a battery explosion, which could result in death or serious injury. (00049a)

1. **For vehicles equipped with security siren:** Disarm the siren with the key fob or security code. **All models except VRSC:** See the service manual to remove the seat. Retain all seat mounting hardware. Disconnect negative battery cable. Disconnect positive battery cable. Retain all seat mounting hardware. **VRSC models:** See the service manual to remove the main fuse. Disconnect negative battery cable. Disconnect positive battery cable.
2. **ALL models:** Turn ignition switch OFF unless already done.

Adhesive Strips

1. **NOTE**

- Ambient temperature between 21–38 °C (70–100 °F) for proper adhesion. Do not apply below 10 °C (50.0 °F).
- Parts cannot be repositioned after initial adhesive installation.
- Allow **at least** 24 hours after application before exposing the area to vigorous washing, strong water spray or extreme weather.
- The adhesive bond will increase to maximum strength after about 72 hours at normal room temperature.
- Do not clean with denatured alcohol, mineral spirits or other solvents. Damage to components occurs.

Using a 50:50 isopropyl alcohol/water solution, thoroughly clean cover insert surfaces. Allow to dry completely.

2. Install item into area.
 - a. With the adhesive backing still in place, test fit the item to the area.

- b. Remove the adhesive backing.
- c. Install the item to the area.
- d. Press surface of the item firmly to make sure that there is good adhesion.

INSTALLATION

2002-2006 VRSCA, VRSCB, VRSCD Models

1. Open the seat.
2. See Figure 1. Remove the splash guard (mud flap) nuts.
3. See Figure 2. Lower the mud flap from the installed position. Allow it to rest on the rear tire.

▲ WARNING

When servicing the fuel system, do not smoke or allow open flame or sparks in the vicinity. Gasoline is extremely flammable and highly explosive, which could result in death or serious injury. (00330a)

4. Remove the fuel cap. Remove the fuel filler boot. Save the boot for installation. Install the fuel cap.

NOTE

See Figure 3. The security siren connector is a three-wire connector. Do not confuse this connector with the two-wire connector (3) tied to the harness (except on California models).

5. Locate the security siren connector (2) at the end of the harness lead that wraps around the top of the fuel tank. Disconnect the fuel pump and sender connector (1) to free the security siren connector. The protective cap and cable strap on the security siren connector can be discarded.
6. See Figure 4. Route the siren harness lead out from under the right side of the fender. Get the siren (1) from the kit. Insert connector [142B] (2) into the siren receptacle until the connector latches securely.
7. With the sounder disc (3) facing the mud flap, position the siren on the mud flap as shown in Figure 5. Make sure that the pager antenna lies in the groove alongside the connector and is not pinched. Secure the siren (1) to the existing hook fasteners on the mud flap with the plain-backed loop fastener (2) from the kit.
8. See Figure 3. Feed the siren pager antenna wire upwards through the slot (4) in the frame.

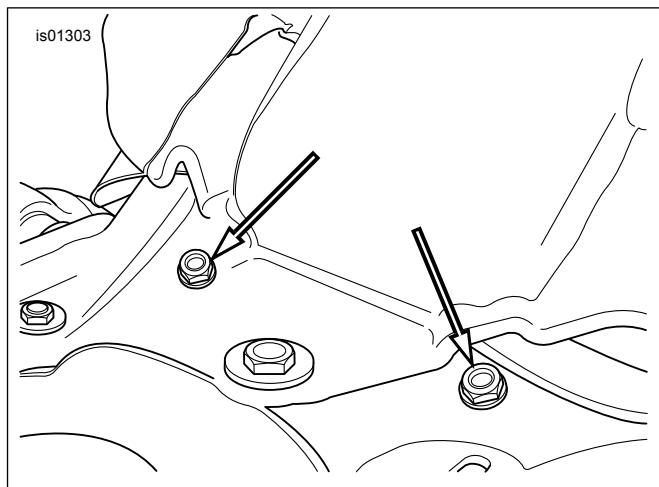

Figure 1. Remove Mud Flap Nuts (2002-2006 VRSCA/B/D)

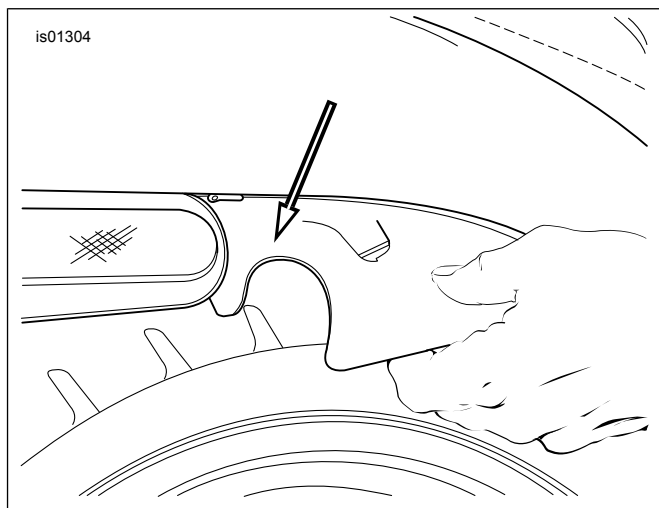

Figure 2. Lower the Mud Flap (2002-2006 VRSCA/B/D)

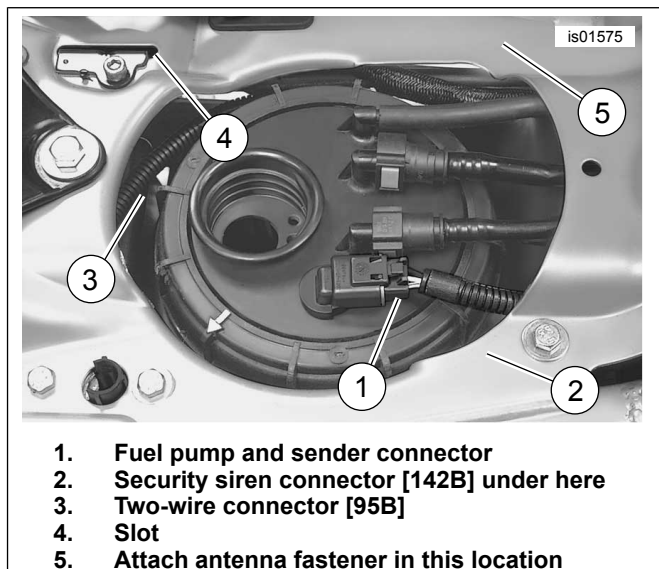

Figure 3. Locate Connector [142B] (2002-2006 VRSC Models) (Shown with Fuel Cap and Filler Boot Removed)

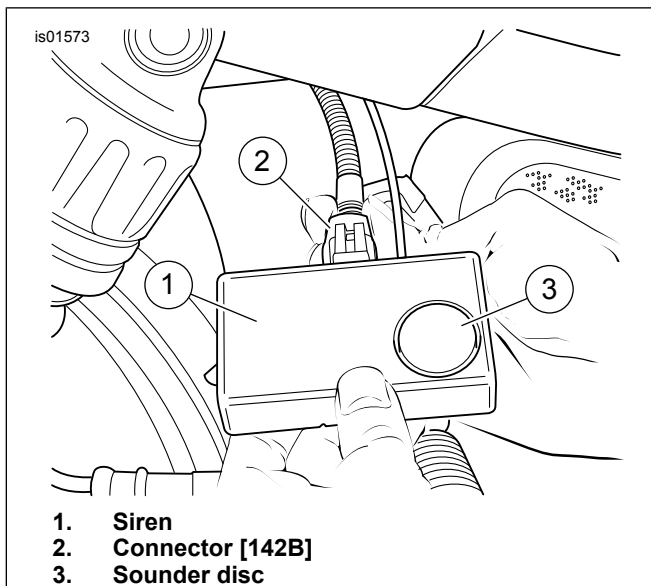

Figure 4. Install Siren Connector (2002-2006 VRSC Models)

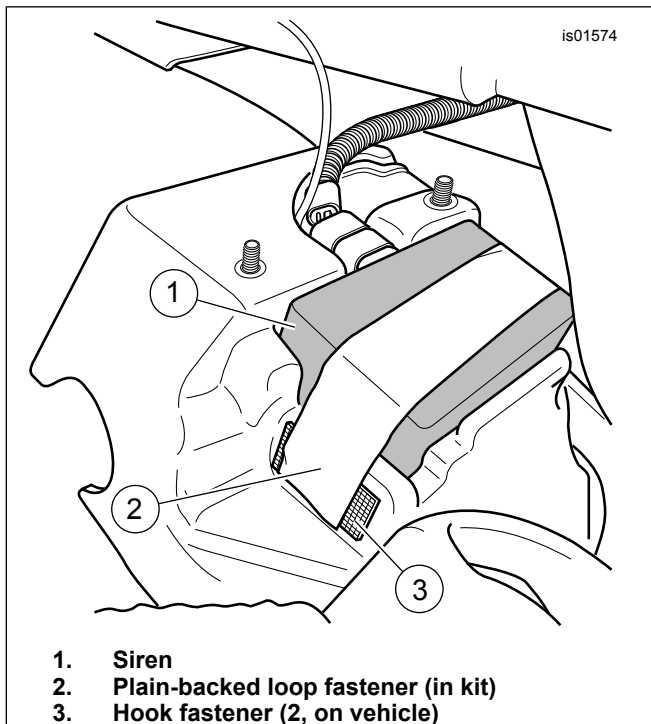

Figure 5. Secure Siren Box (2002-2006 VRSCA/B/D Models)

9. Install the mud flap to the underside of the fender. Install the mud flap nuts. Remove the fuel cap. Install the fuel filler boot. Install the fuel cap.

Torque: 8–12 N·m (71–106 in-lbs) *Mud flap nuts*

10. Clean the area on the frame (5) forward of the slot (4), along the space to the left of the fuel filler boot. See Adhesive Strips.
11. See Figure 33. Remove the protective tape from the adhesive backing of the hook fastener (2). Attach the fastener to the frame in the cleaned area.

12. Route the siren (1) pager antenna wire down the center of the installed fastener half. Straighten the pager antenna along the length of the fastener.

NOTE

In order for the pager antenna to work properly, none of the small diameter portion should touch metal parts of the vehicle.

13. Install the plain-backed loop fastener (3) onto the hook fastener installed on the frame, capturing the pager antenna wire to hold it firmly in place.

NOTICE

When closing the seat, make sure the ignition switch is in the FUEL position. If the ignition switch is in any other position when the seat is closed, the seat latch mechanism could be damaged. (00196a)

14. See the service manual to close the seat.

NOTE

*Verify that the ignition is OFF **before** installing the main fuse.*

15. Install the main fuse per the service manual.

2006-2007 VRSCR Models

1. Open the seat.

⚠ WARNING

When servicing the fuel system, do not smoke or allow open flame or sparks in the vicinity. Gasoline is extremely flammable and highly explosive, which could result in death or serious injury. (00330a)

2. Remove the fuel cap. Remove the fuel filler boot. Save the boot for installation. Install the fuel cap.

NOTE

See Figure 3. The security siren connector is a three-wire connector. Do not confuse this connector with the two-wire connector (3) tied to the harness (except on California models).

3. Locate the security siren connector (2) at the end of the harness lead that wraps around the top of the fuel tank. Disconnect the fuel pump and sender connector (1) to free the security siren connector. The protective cap and cable strap on the security siren connector can be discarded.
4. See Figure 6. Remove the flanged hex nut (2) and flat washer (3) that retain the passenger seat (1). Remove seat.

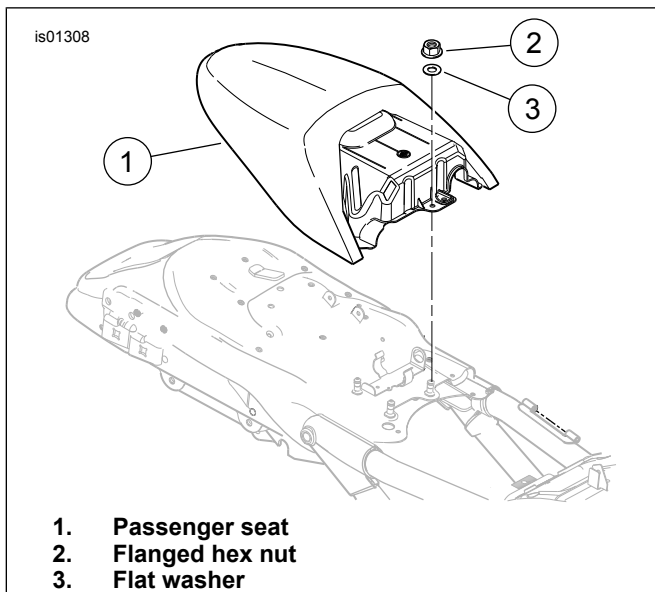

Figure 6. Remove Passenger Seat (2006-2007 VRSCR)

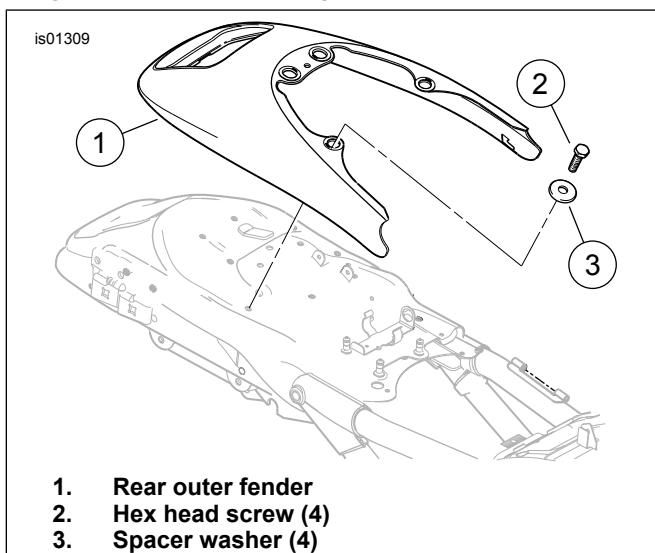

Figure 7. Fender Mounting Fasteners (2006-2007 VRSCR)

5. See Figure 7. Remove the four hex head screws (2) and spacer washers (3) that retain the rear outer fender (1). Slide the fender back. Lift to remove.
6. See Figure 4. Route the siren harness lead out from under the right side of the fender. Get the siren (1) from the kit. Insert connector [142B] (2) into the siren receptacle until the connector latches securely.
7. See Figure 8. With the sounder disc (2) facing out, clip the siren (1) onto the mud flap (3) as shown.

NOTE

Verify that the outer fender tabs are latched with the inner fender locking tabs.

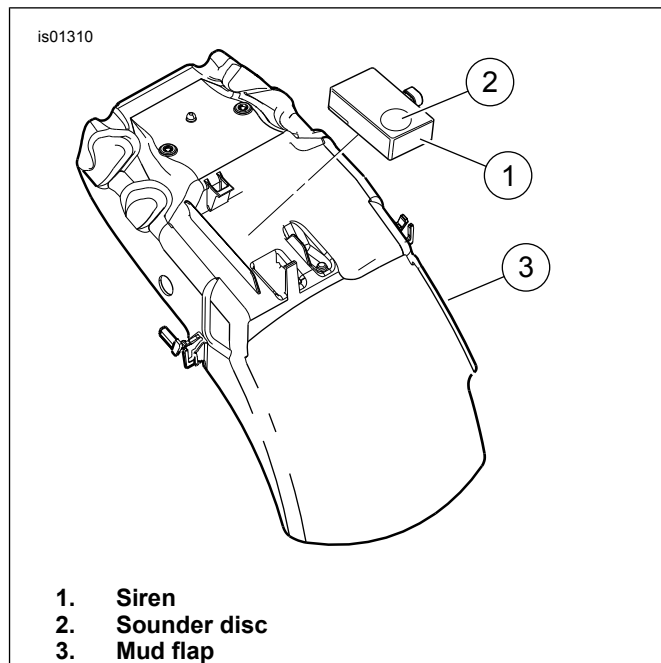

Figure 8. Secure Siren Box (2006-2007 VRSCR Models)

8. Press down gently on the outer fender to seat the fender against the frame.
9. Install the four screws and flat washers that retain the rear outer fender.
Torque: 4.5–7.5 N·m (40–66 in-lbs) *Rear outer fender screws*
10. Refer to Figure 3. Clean the area on the frame (5) forward of the slot (4), along the space to the left of the fuel filler boot. See Adhesive Strips.
11. See Figure 33. Remove the protective tape from the adhesive backing of the hook fastener (2). Attach the fastener to the frame in the cleaned area.
12. Route the siren (1) pager antenna wire down the center of the installed fastener half. Straighten the pager antenna along the length of the fastener.

NOTE

In order for the pager antenna to work properly, none of the small diameter portion should touch metal parts of the vehicle.

13. Install the plain-backed loop fastener (3) onto the hook fastener installed on the frame, capturing the pager antenna wire to hold it firmly in place.

NOTE

The remaining plain-backed loop fastener is not used in this application. It can be discarded.

14. Install the passenger seat with the flanged hex nut and flat washer removed earlier.
Torque: 20–25 N·m (15–18 ft-lbs) *Passenger seat nut*
15. Remove the fuel cap. Install the fuel filler boot. Install the fuel cap.

NOTICE

When closing the seat, make sure the ignition switch is in the FUEL position. If the ignition switch is in any other position when the seat is closed, the seat latch mechanism could be damaged. (00196a)

⚠ WARNING

After installing seat, pull upward on seat to be sure it is locked in position. While riding, a loose seat can shift causing loss of control, which could result in death or serious injury. (00070b)

16. See the service manual to close the seat.

NOTE

*Verify that the ignition is OFF **before** installing the main fuse.*

17. Install the main fuse per the service manual.

2007-2017 VRSCA, VRSCD/X, VRSCF Models

1. Open the seat.
2. Remove the passenger seat (pillion) mounting nut and washer at the left front of the seat. Remove the rider seat retaining post at the right front.
3. Slide the pillion forward slightly to detach it from the mounting tab on the fender. Slide the pillion back and out from under the grab strap. Lift the pillion away from the vehicle.
4. See Figure 9. Locate the three-wire security siren connector [142B] (2), tied back to the harness lead (1) that travels alongside the TSSM mounting caddy. Cut the tape to free the connector and wires.
5. Insert siren connector [142B] into the siren receptacle until the connector latches securely.
6. With the sounder disc (4) facing out, clip the siren onto the TSSM mounting caddy as shown.
7. Clean the area on the frame forward of the TSSM mounting caddy. See Adhesive Strips.
8. Remove the protective tape from the adhesive backing of the hook fastener (Figure 33, Item 2). Without covering any part of the warning label, attach the fastener to the frame in the cleaned area (5), allowing it to extend as needed beyond the flat area.

NOTE

In order for the pager antenna to work properly, none of the small diameter portion should touch metal parts of the vehicle.

9. Gently position the siren pager antenna wire (6) down the path along the TSSM caddy, tucking it beneath the main harness (7). Route the siren pager antenna wire down the center of the installed fastener, straightening the pager antenna along the length of the fastener. Observe where the small-diameter portion of the wire begins. Verify that point is on the fastener.

10. Install the plain-backed loop fastener (3) onto the hook fastener installed on the frame, capturing the pager antenna wire to hold it firmly in place. Loop the end of the pager antenna back so it remains captured between the fastener components.

11. If necessary, secure the connector wiring to the existing wiring with a cable strap (not provided).

NOTE

The remaining plain-backed loop fastener is not used in this application. It can be discarded.

12. Slide the passenger seat under the grab strap. Engage the mounting tab on the fender into the slot in the underside of the seat. Make sure that harnesses are not pinched under the passenger seat frame.

⚠ WARNING

After installing seat, pull upward on seat to be sure it is locked in position. While riding, a loose seat can shift causing loss of control, which could result in death or serious injury. (00070b)

13. Fasten the passenger seat with the rider seat retaining post at the right front, and the seat mounting nut and washer at the left front.

Torque: 11–17 N·m (97–150 in-lbs) *Seat mounting nut*

NOTE

*Verify that the ignition is OFF **before** installing the main fuse.*

14. Install main fuse.

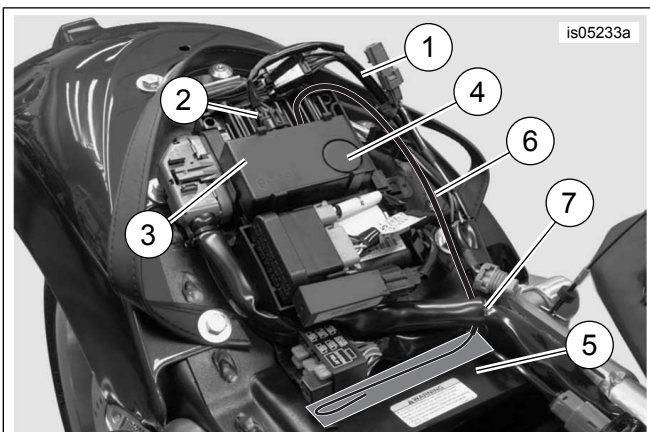

1. Main harness lead
2. Security siren connector [142B]
3. Siren
4. Sounder disc
5. Cleaned area of frame
6. Antenna wire
7. Main harness

Figure 9. Secure Siren Box (2007-2017 VRSCA, VRSCD, VRSCF Models)

2002-2007 FL Touring Models

1. Remove the right side saddlebag per the service manual. Gently pull the side cover from the frame downtubes.
2. See Figure 10. Remove the two flange nuts (2) from the electrical bracket (1). Pull the bracket assembly, with the Electronic Control Module (ECM) and connector attached, away from the side of the battery box.

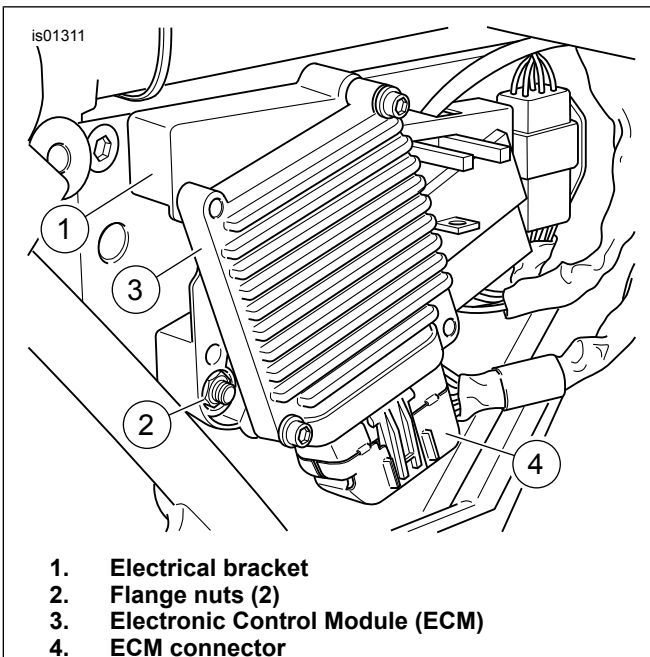

Figure 10. Electrical Bracket (2002-2007 FL Touring Models)

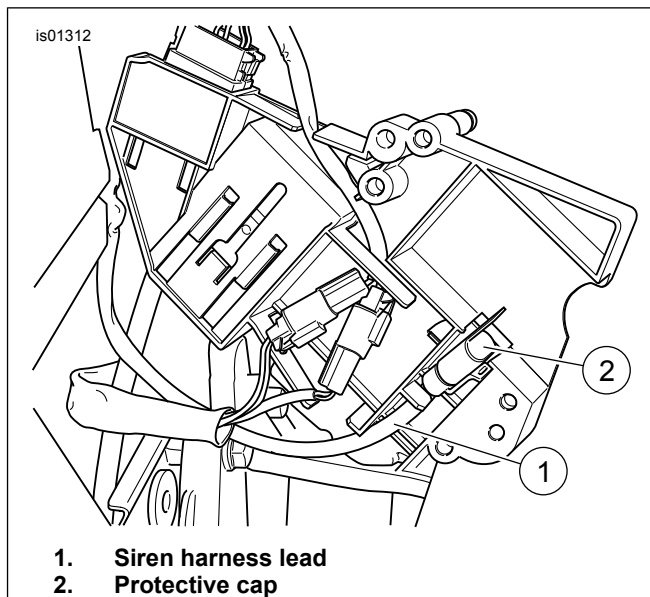

Figure 11. Siren Wire Harness (2002-2007 FL Touring)

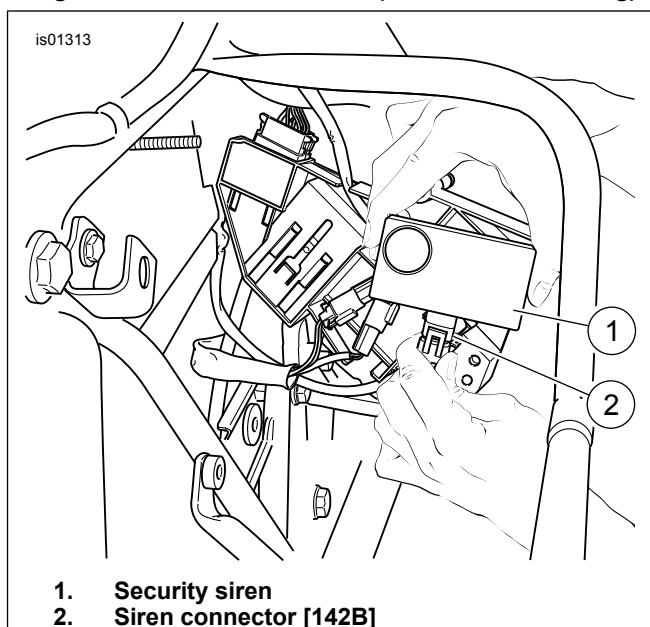

Figure 12. Insert Siren Connector (2002-2007 FL Touring)

3. See Figure 11. Remove the siren harness lead (1) from the back of the electrical bracket. Take the protective cap (2) off the security siren connector [142B].
4. See Figure 12. Insert the security siren connector [142B] (2) into the siren box receptacle until the connector latches securely.
5. See Figure 13. Slide the siren (2) into place on the back of the electrical bracket (1) so the sounder disc faces out.

NOTE

Make sure that the cables and conduit are properly routed so they are not pinched during assembly.

6. Feed the siren pager antenna wire (3) rearward under the siren, out the back of the electrical bracket.

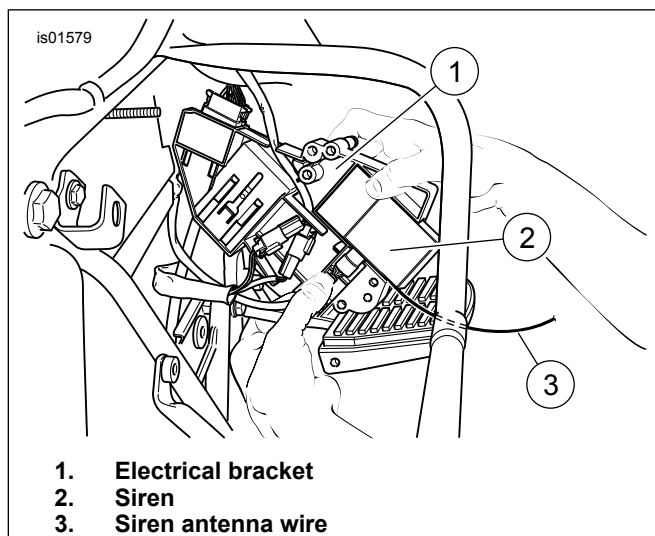

Figure 13. Slide Siren into Place (2002-2007 FL Touring)

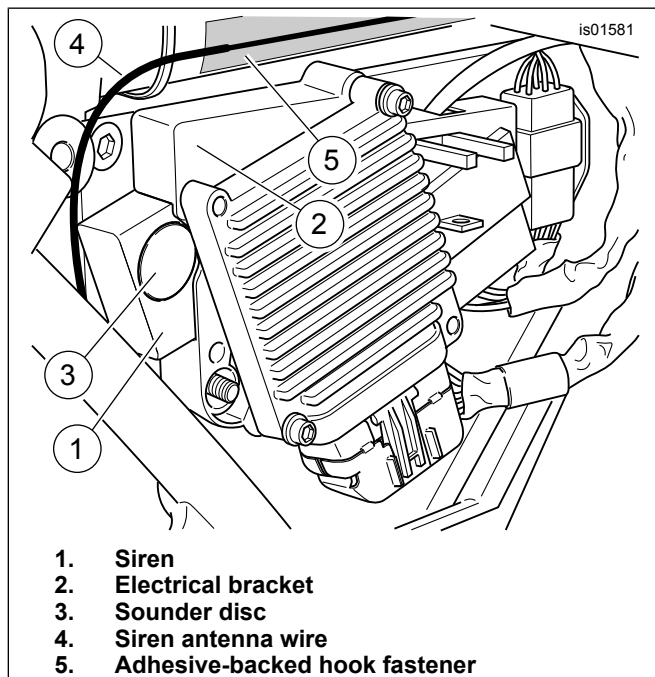

Figure 14. Siren and Electrical Bracket Installed (2002-2007 FL Touring Models)

7. See Figure 14. Install the electrical bracket assembly with siren back onto the studs on the side of the battery box. Install the two flange nuts onto the studs.
Torque: 4.1–5.4 N·m (36–48 in-lbs) *Flange nuts*
8. Clean the outboard surface of the frame tube above the electrical bracket. See Adhesive Strips.
9. See Figure 33. Remove the protective tape from the adhesive backing of the hook fastener (2). Attach the fastener to the frame in the cleaned area.
10. Route the siren (1) pager antenna wire down the center of the installed fastener half. Straighten the pager antenna along the length of the fastener.

NOTE

In order for the pager antenna to work properly, none of the small diameter portion should touch metal parts of the vehicle.

11. Install the plain-backed loop fastener (3) onto the hook fastener installed on the frame, capturing the pager antenna wire to hold it firmly in place.

NOTE

The remaining plain-backed loop fastener is not used in this application. It can be discarded.

12. Align the barbed studs on the side cover with the grommets in the frame. Push the side cover firmly into place.
13. Install the right side saddlebag per the service manual.

NOTE

Verify that the ignition is OFF before installing the main fuse or attaching the battery cables.

14. **For 2004-2007 models:** See the service manual to install the main fuse. **For 2002-2003 models:** See the service manual to attach the battery cables. Apply a light coat of H-D electrical contact lubricant, petroleum jelly or other corrosion retardant material to battery terminals.

⚠ WARNING

After installing seat, pull upward on seat to be sure it is locked in position. While riding, a loose seat can shift causing loss of control, which could result in death or serious injury. (00070b)

15. See the service manual to install the seat.

2008-2013 FL Touring Models

1. See the service manual to remove the left side saddlebag. Gently pull the side cover from the frame downtubes.
2. See Figure 15. Remove the security siren connector [142B] (3) from the retainer on the electrical caddy. Insert security siren connector [142B] into the security siren receptacle (5) until the connector latches securely.
3. Slide the siren into place on the left side of the electrical caddy so the sounder disc (6) faces out.
4. Route the siren pager antenna wire rearward under the siren, out the back of the electrical caddy.

NOTE

Make sure that the cables and conduit are properly routed so they are not pinched during assembly.

5. See Figure 16. Clean the outboard surface of the frame tube (1) above the electrical caddy. See Adhesive Strips.

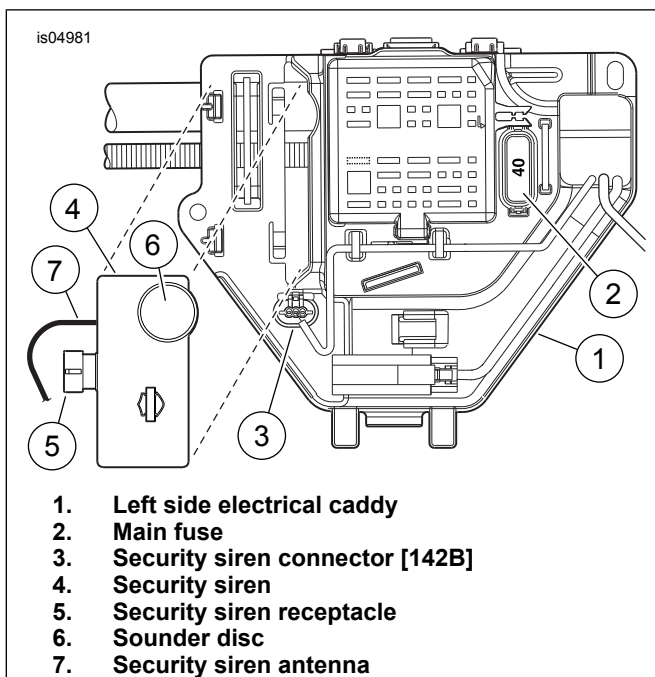

Figure 15. Siren Installation (2008-2013 FL Touring)

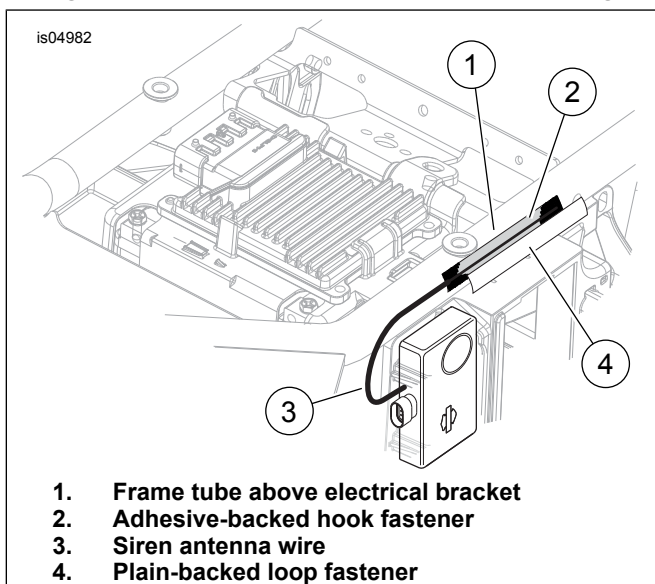

Figure 16. Siren Antenna Installation (2008-2013 FL Touring Models)

6. Remove the protective tape from the adhesive backing of the hook fastener (2). Attach the fastener to the frame in the cleaned area.
7. Route the siren (3) pager antenna wire down the center of the installed fastener half. Straighten the antenna along the length of the fastener.

NOTE

In order for the pager antenna to work properly, none of the small diameter portion should touch metal parts of the vehicle.

8. Install the plain-backed loop fastener (4) onto the hook fastener installed on the frame, capturing the pager antenna wire to hold it firmly in place. The remaining plain-backed loop fastener is not used in this application. It can be discarded.

NOTE

Verify that the ignition is OFF before installing the main fuse.

9. See the service manual to install the main fuse.
10. Align the barbed studs on the side cover with the grommets in the frame. Push the side cover firmly into place.
11. Install the left side saddlebag per the service manual.

2014-Later FL Touring Models

1. See the service manual to remove the left side saddlebag. Gently pull the side cover from the frame downtubes.
2. See Figure 17. Remove the security siren connector [142B] (3) from the retainer (2) on the electrical caddy (1). Insert security siren connector [142B] into the security siren receptacle (5) until the connector latches securely.
3. Slide the siren (4) into the pocket in the electrical caddy so the sounder disc (6) is toward the rear, facing down.
4. Clean the top surface of the electrical caddy. See Adhesive Strips.
5. Remove the protective tape from the adhesive backing of the hook fastener (8). Attach the fastener to the top of the caddy, flush with the forward and outboard edges. Fold the excess around the rear edge of the caddy.
6. Route the siren pager antenna wire (7):
 - a. rearward under the siren,
 - b. around the now-empty siren connector retainer (2) and
 - c. over the top of the electrical caddy.

NOTE

None of the small diameter portion of the pager antenna should touch metal parts of the vehicle.

7. Route the pager antenna forward along the top of the caddy to the front edge, close to the vehicle frame. Loop back and route the pager antenna rearward over the installed hook fastener. Make sure all of the smaller diameter portion of the pager antenna is contained within the fastener.
8. Install the plain-backed loop fastener (9) onto the hook fastener, capturing the smaller diameter portion of the pager antenna wire to hold it firmly in place. The remaining plain-backed loop fastener is not used in this application. It can be discarded.

NOTE

Make sure that the cables and conduit are properly routed so they are not pinched during assembly.

NOTE

Verify that the ignition is OFF **before** installing the main fuse.

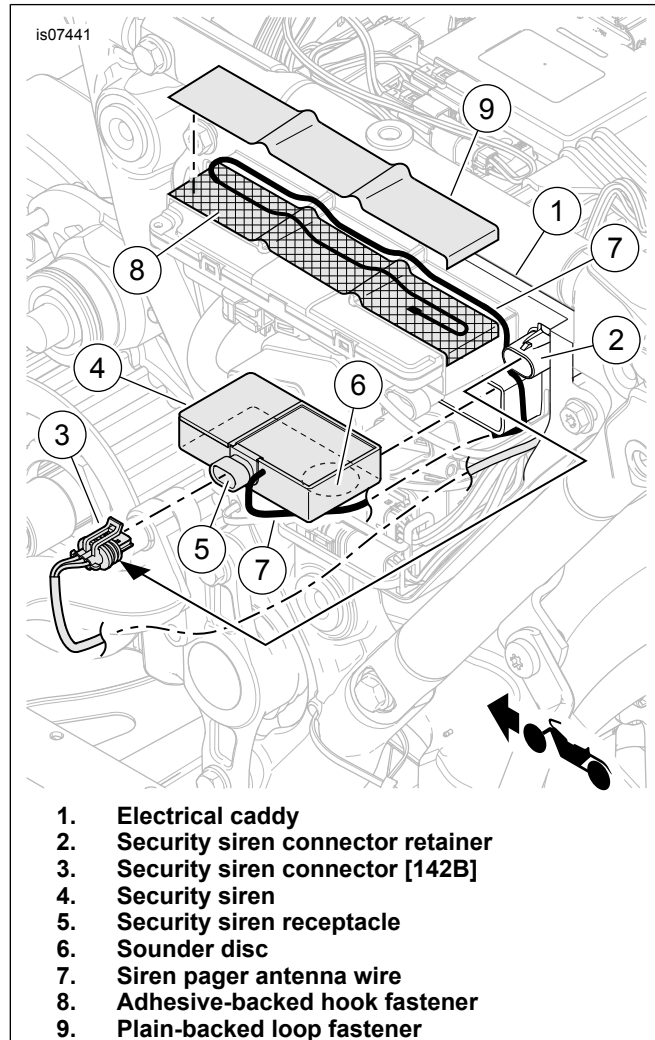

Figure 17. Siren Installation (2014-Later FL Touring Models)

9. See the service manual to install the main fuse.
10. Align the barbed studs on the side cover with the grommets in the frame. Push the side cover firmly into place.
11. Install the left side saddlebag per the service manual.

2020 FLHR & FLHRXS Touring Models

1. See Figure 18. Locate and disconnect connector [242].
2. Remove and discard cable strap (1).
3. See Figure 19. Remove connector cover.
 - a. Pry on tabs on each side.

- b. Slide cover (1) off connector body.

4. See Figure 20. Verify position of wire 180 (W/GN) (1).
 - a. Location A3 (2).
5. Verify plug in location H2 (3).
6. Remove plug from location H2 (3). Save for later use.
7. Remove (W/GN) wire from A3 (2).
8. Install (W/GN) wire in to H2 (3).
9. Install plug in to A3 (2).
10. Assemble connector and test siren.

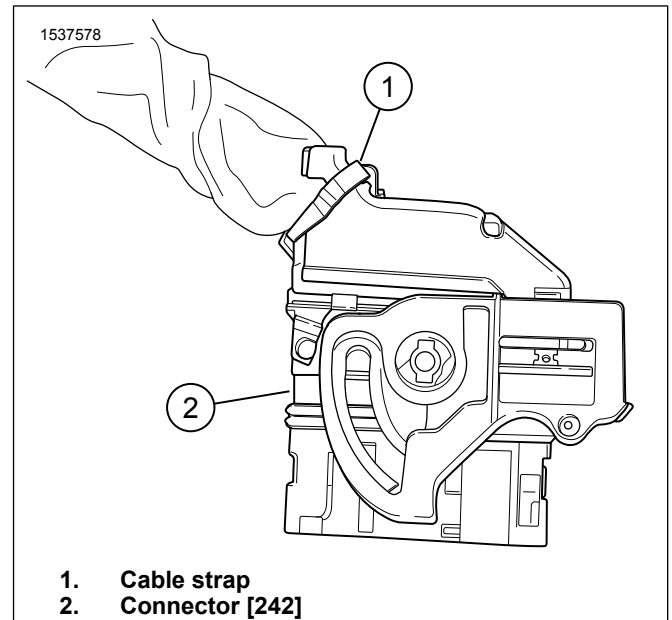

Figure 18. Connector [242]

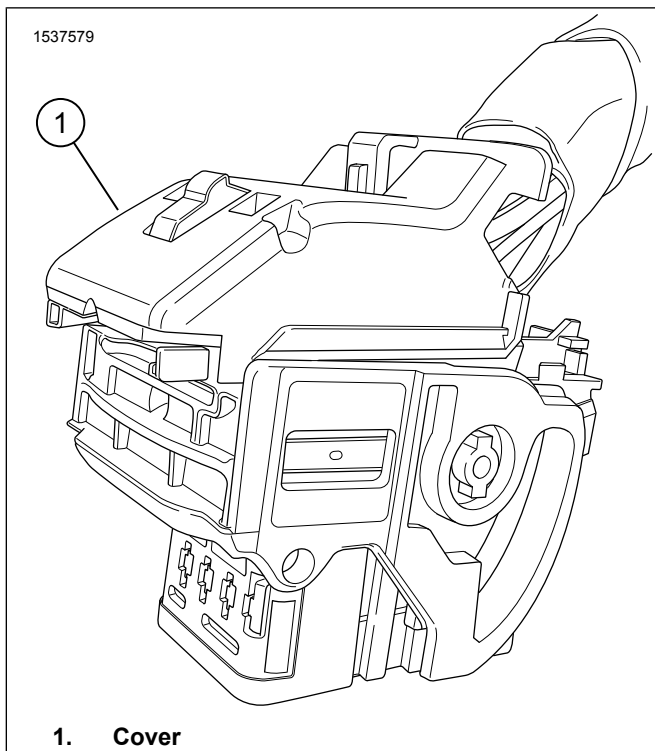

Figure 19. Connector [242] Cover

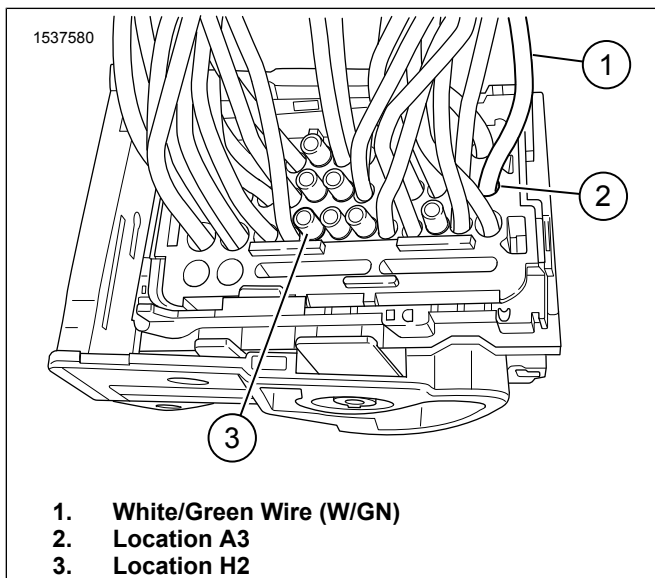

Figure 20. White/Green Wire (W/GN)

2003-2017 Softail Models EXCEPT FXCW, FXCWC

1. **Models with saddlebags:** Remove the right side saddlebag per the service manual.

NOTE

The siren connector is installed on an electrical panel under the rear fender on all Softail models. The rear of the vehicle must be raised slightly to allow removal of the splash guard.

2. Remove two bolts at the bottom of the splash guard. Bend the upper right corner of the splash guard toward the rear tire. Lift to unhook the splash guard from the tab on the rear fork. Remove the guard from beneath the fender.

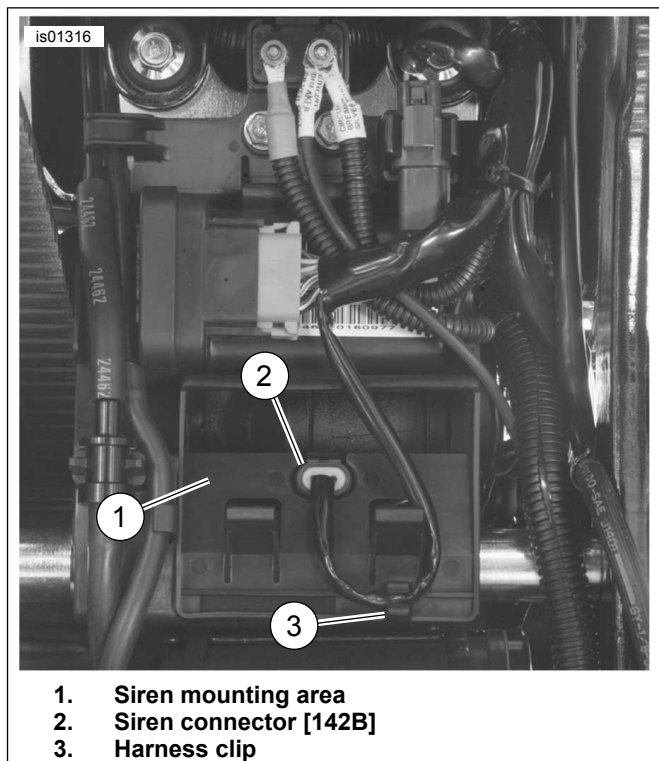

Figure 21. Siren Connector (Softail Models EXCEPT FXCW/C) (Rear Fender View with Rear Wheel Removed)

3. See Figure 21. Remove the siren connector [142B] (2) from the receptacle in the siren mounting area (1) of the electrical panel.
4. Insert the siren connector [142B] into the siren box receptacle until the connector latches securely.
5. See Figure 22. Orient the siren (1) as shown, with the harness connector (2) toward the bottom and the sounder disc (5) facing out. Route the siren pager antenna wire (6) Carefully snap the siren into the electrical panel.
 - a. upwards in front of the siren,
 - b. forward of the upper rear fork tube and
 - c. through the opening in the upper left of the rear fender.
6. Insert the siren harness lead (4) into the harness clip (3) to keep the harness clear of other components.
7. If necessary, secure the connector wiring to the electrical panel wiring with a cable strap (not provided).
8. See Figure 23. Gently pull the siren pager antenna wire upwards through the fender opening. Lay the wire across the concave surface at the base of the electrical box. Observe where the small-diameter portion of the wire begins, and where that point falls on the electrical box.

NOTE

The hook-and-loop fastener may need to extend slightly into the fender opening to make sure that the entire small-diameter portion of the pager antenna is protected from metal contact.

9. Clean the concave surface at the base of the electrical box. See Adhesive Strips.
10. See Figure 33. Remove the protective tape from the adhesive backing of the hook fastener (2). Attach the fastener to the cleaned area of the electrical box, allowing it to extend as needed into the fender opening.

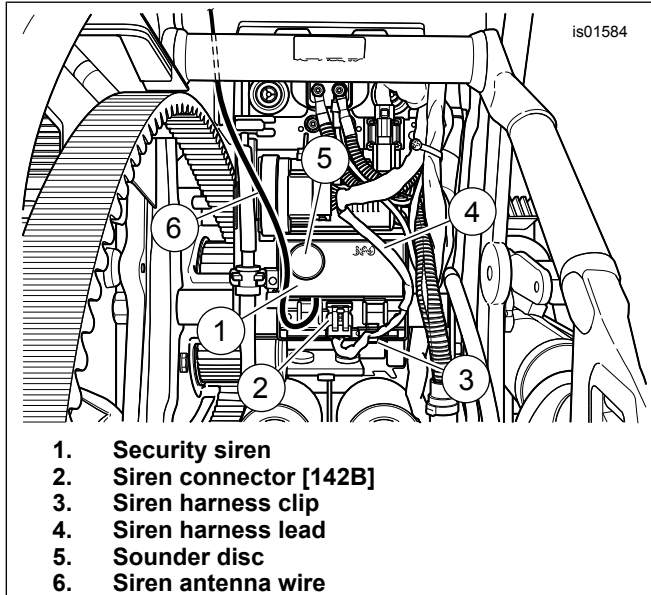

Figure 22. Siren Mounting (Softail Models EXCEPT FXCW, FXCWC)

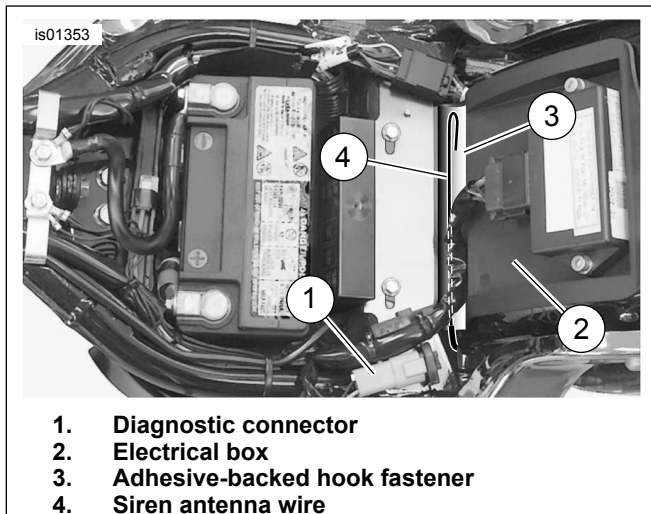

Figure 23. Siren Antenna Mounting (Softail Models EXCEPT FXCW, FXCWC)

11. Route the siren (1) pager antenna wire down the center of the installed fastener half. Straighten the pager antenna along the length of the fastener.

NOTE

In order for the pager antenna to work properly, none of the small diameter portion should touch metal parts of the vehicle.

12. Install the plain-backed loop fastener (3) onto the hook fastener installed on the frame, capturing the pager antenna wire to hold it firmly in place.

NOTE

The remaining plain-backed loop fastener is not used in this application. It can be discarded.

13. Hook the slot at the top of the splash guard over the tab on the rear fork. Install the guard with the two screws removed earlier. Tighten securely.

14. **Models with saddlebags:** Install the right side saddlebag per the service manual.

NOTE

*Verify that the ignition is OFF **before** attaching the negative battery cable.*

15. See the service manual to attach the battery cables. Apply a light coat of H-D electrical contact lubricant, petroleum jelly or other corrosion retardant material to battery terminals.

▲ WARNING

After installing seat, pull upward on seat to be sure it is locked in position. While riding, a loose seat can shift causing loss of control, which could result in death or serious injury. (00070b)

16. See the service manual to install the seat.

2008-2017 FXCW, FXCWC Models

NOTE

Record fender wire routing and hardware locations before removal.

1. Remove the rear fender from the vehicle. See the service manual to:
 - a. Disconnect the rear wiring harness connector [7] halves.
 - b. Remove the lower fender mounting bolts and washers.
 - c. Remove the upper fender mounting screws and washers.
 - d. Remove the fender.
2. See Figure 24. Unfasten the harness (1) clipped to the right side of the electrical compartment cover (splash guard, already removed in photo) forward of the rear wheel. Remove the two hex socket head screws with washers fastening the cover. Remove the cover from the vehicle.
3. Remove the siren connector [142B] from the receptacle (3) near the top of the electrical panel (2).

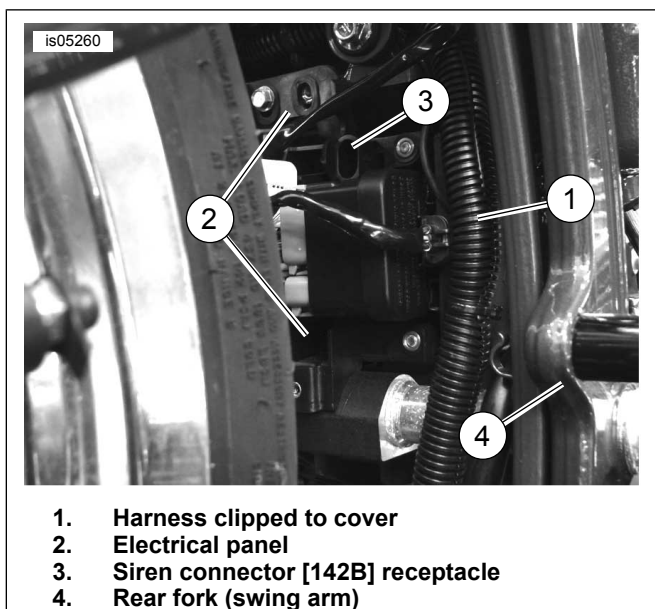

Figure 24. Electrical Panel (FXCW, FXCWC Models)

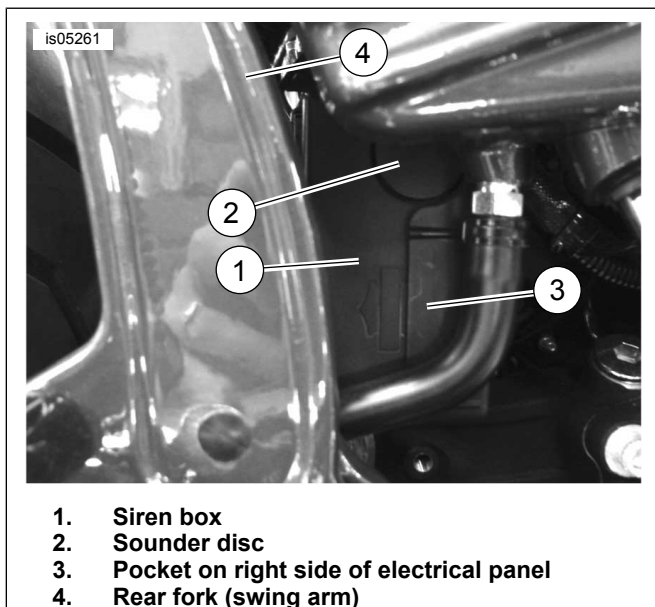

Figure 25. Siren Mounting (FXCW, FXCWC Models)

4. Insert siren connector [142B] into the siren box receptacle until the connector latches securely.
5. See Figure 25. Position the siren box (1) with the harness connector toward the rear and the sounder disc (2) facing out. Carefully snap the siren box into the pocket (3) on the right side of the electrical panel.
6. See Figure 26. Route the siren pager antenna (1) upward to the rear of the siren box. Route forward following the path of the wire bundle (3) along the right side of the vehicle battery (4).

NOTE

In order for the pager antenna to work properly, none of the small diameter portion (2) should touch metal parts of the vehicle.

7. Tuck the pager antenna within the cable straps (5) that secure the wire bundle if possible. If not, secure the pager antenna to the wiring with new cable straps (not provided).
8. Install the electrical compartment cover. Install the screws and washers removed earlier.
Torque: 4.1–6.8 N·m (36–60 **in-lbs**) *Cover screws*
9. See the service manual to:
 - a. Set the fender into position.
 - b. Loosely install the fender mounting hardware.
 - c. Tighten the fender mounting hardware, in the indicated sequence, to the specified torque.
 - d. Connect the rear wiring harness connector [7] halves.

NOTE

*Verify that the ignition is OFF **before** attaching the negative battery cable.*

10. See the service manual to attach the battery cables. Apply a light coat of H-D electrical contact lubricant, petroleum jelly or other corrosion retardant material to battery terminals.

⚠ WARNING

After installing seat, pull upward on seat to be sure it is locked in position. While riding, a loose seat can shift causing loss of control, which could result in death or serious injury. (00070b)

11. See the service manual to install the seat.

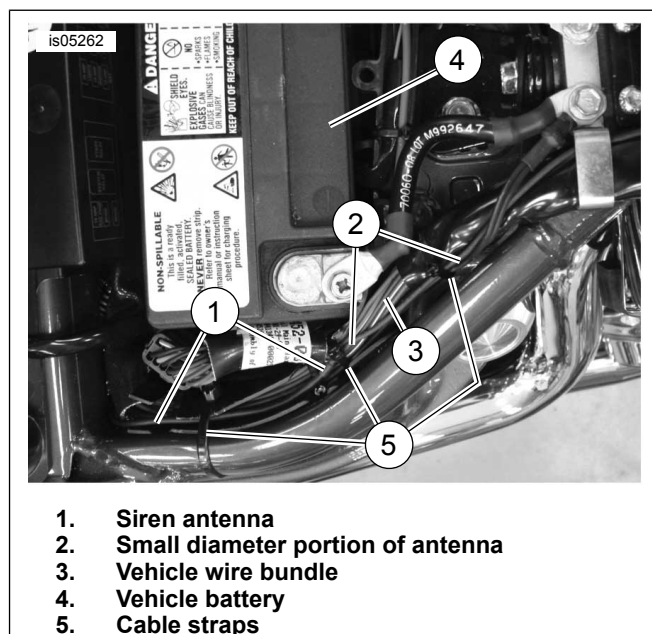

Figure 26. Siren Antenna Mounting (FXCW, FXCWC Models)

2018-Later Softail Models

1. Remove seat. See the service manual.

2. Remove right side cover. See the service manual.
3. Remove negative battery cable. See the service manual.
4. Remove battery. See the service manual.
5. Remove battery tray. See the service manual.
6. Remove Body Control Module (BCM). See the service manual.
7. See Figure 27. Remove siren connector from siren connector storage port (5) in the back side of the BCM caddy (2).
8. Remove black weather cap from siren connector.
9. Install siren. See the service manual.

NOTE

Verify when installing siren that the sounder disc (1) is facing to the back side of the BCM caddy (2).

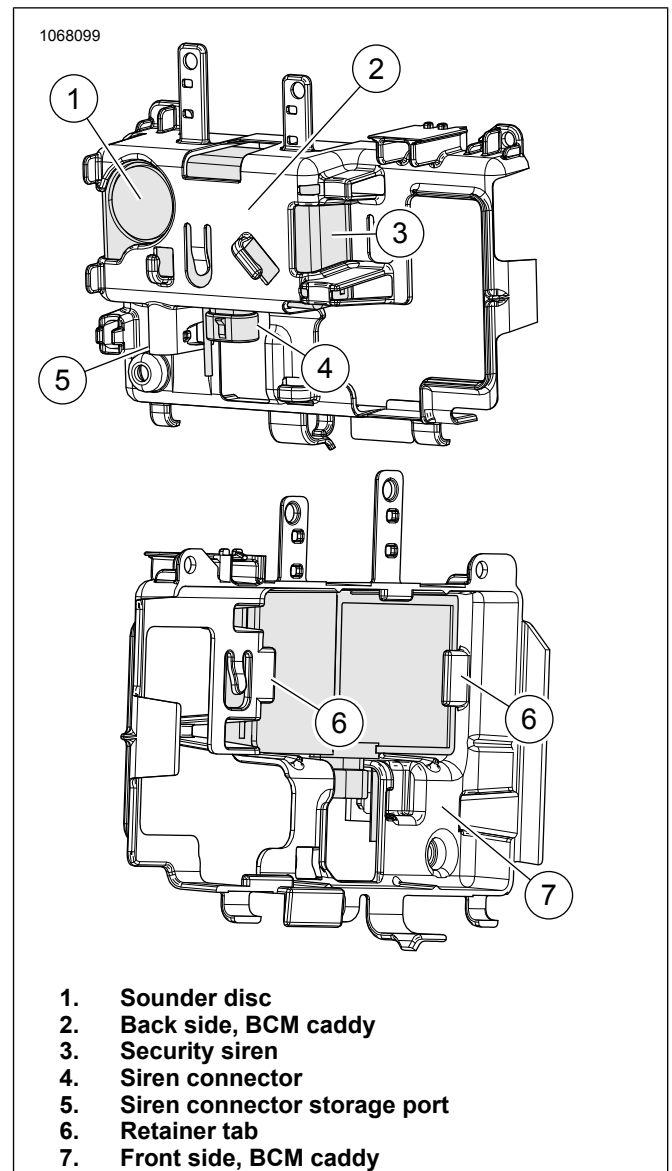

Figure 27. Security Siren and BCM Caddy: (Removed for clarity)

10. Install siren pager antenna wire.
 - a. See Figure 28. Route siren pager antenna wire (2) through siren connector opening (4) in BCM caddy (1).
 - b. Route antenna wire upwards to right side of under seat area. Use BCM caddy finger (3) to support antenna.
 - c. See Figure 29. Clean the surface of the right side of the upper rear frame crossmember. Refer to Adhesive Strips.
 - d. See Figure 33. Remove protective tape from adhesive strip backing of the hook fastener (2). Trim to size and attach the fastener to the frame crossmember in the cleaned area.
 - e. See Figure 30. Loop the antenna wire end (2). Place looped antenna end inside of hook fastener (1).

NOTE

In order for the pager antenna to work properly, none of the small diameter portion should touch metal parts of the vehicle.

- f. See Figure 33. Install the plain-backed loop fastener (4) onto the hook fastener installed on the frame, capturing the pager antenna wire to hold it firmly in place. The remaining plain-backed loop fastener is not used in this application. It can be discarded.

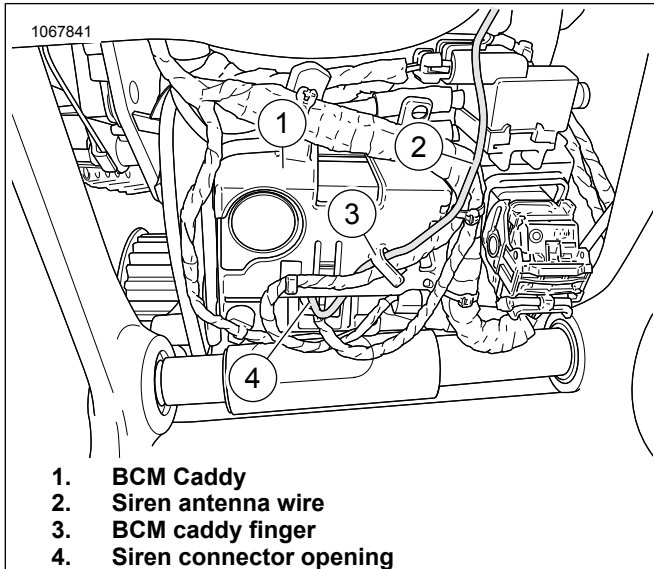

Figure 28. Siren Pager Antenna Wire Routing: (Rear tire and splash guard removed for clarity)

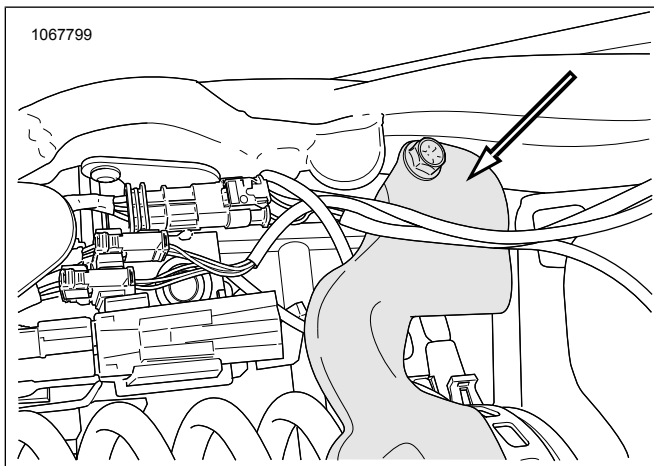

Figure 29. Cleaning Area

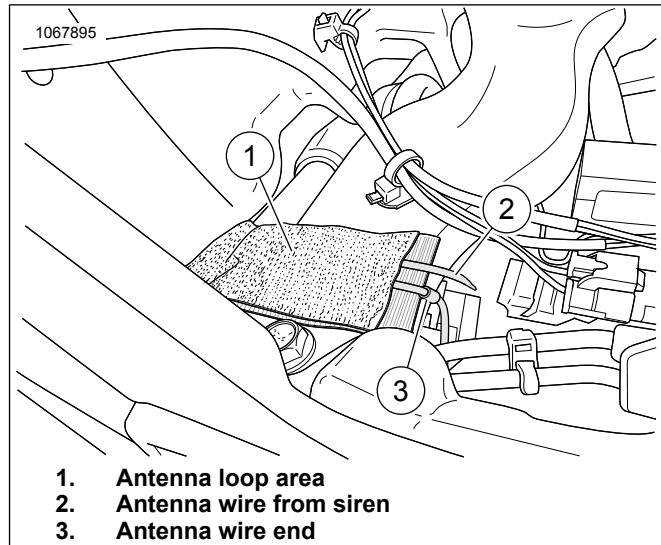

Figure 30. Antenna Wire Loop

11. Install BCM. See the service manual.
12. Install battery tray. See the service manual.
13. Install battery. See the service manual.
14. Install right side cover. See the service manual.
15. Install negative battery cable. See the service manual.
16. Install seat. See the service manual.

2004-2017 Dyna Models

1. See Figure 31. Firmly grasp both sides of the electrical caddy cover (1). Pull out to remove.
2. Remove the front electrical caddy screw and washer (2). Remove the two top electrical caddy screws and washers (7).

NOTE

When pulling the electrical caddy away from the vehicle, make sure that the wiring connections are not disturbed. Pull the caddy away only far enough to allow installing the siren.

3. Get the siren (5) from the kit. Tip the top of the electrical caddy (3) slightly away from the vehicle. Turn the siren so the sounder disc (6) faces up and the wire receptacle is facing the vehicle as shown.
4. Remove the siren harness lead from behind the electrical caddy. Remove the black dust cap from the security siren connector [142B].
5. Insert connector [142B] into the siren receptacle until the connector latches securely. Insert the siren into the back of the caddy, beneath the ignition control module (4).

6. Install, but do not tighten, the front electrical caddy screw and washer (2). Install the top electrical caddy screws and washers (7).

 - a. Tighten the top screws.
Torque: 11.3 N·m (100 **in-lbs**) *Top caddy screws*
 - b. Tighten the front screw.
Torque: 5.6 N·m (50 **in-lbs**) *Front screw*

7. Route the siren pager antenna wire (8)
 - a. under the rearmost frame crossmember,
 - b. up between the crossmember and the rear fender.
8. Clean the top surface of the crossmember. See Adhesive Strips.
9. Remove the protective tape from the adhesive backing of the hook fastener (9). Attach the fastener to the cleaned area of the crossmember.
10. Route the siren pager antenna wire (8) down the center of the installed fastener half. Straighten the pager antenna along the length of the fastener.

NOTE

In order for the pager antenna to work properly, none of the small diameter portion should touch metal parts of the vehicle.

11. Install the plain-backed loop fastener (10) onto the hook fastener installed on the crossmember, capturing the pager antenna wire to hold it firmly in place.

NOTE

*Verify that the ignition is OFF **before** installing the main fuse.*

12. See the service manual to install the main fuse.
13. Install the electrical caddy cover.

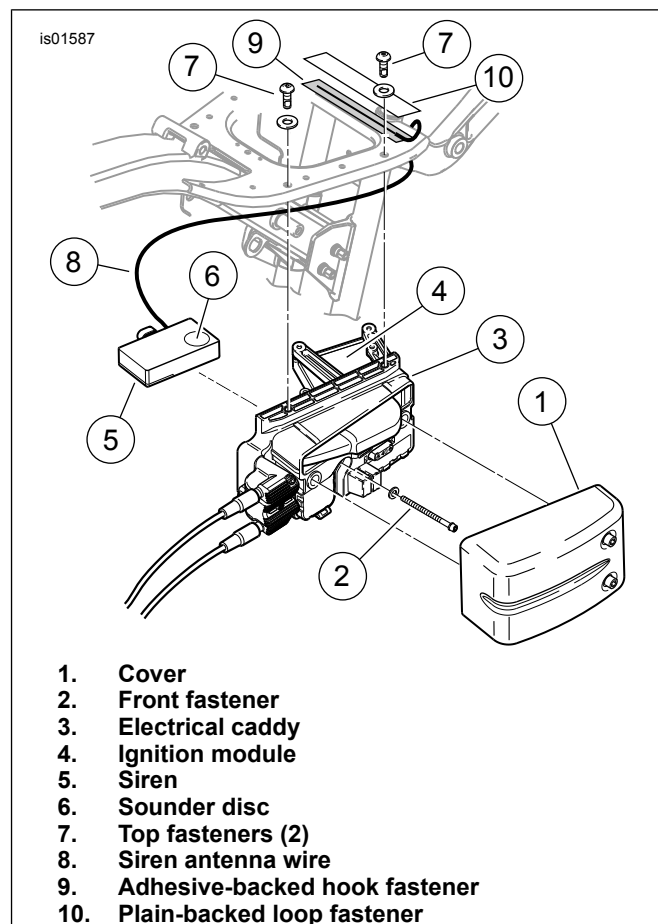

Figure 31. Install Siren in Electrical Caddy (Dyna Models)

2014-Later Sportster Models

1. Remove the left side cover from the frame downtubes.
2. Remove the rear fender per the service manual.
 - a. Remove the lower shock absorber bolts.
 - b. Raise the motorcycle to lower the rear wheel.
 - c. Disconnect rear lighting connectors [18], [19] and [40].
 - d. While supporting the fender, remove attaching hardware.
 - e. Carefully remove the rear fender with attached license plate bracket, tail lamp base and wire harness.
3. See Figure 32. Pull the fuse box (1) away from the oil tank. Remove the Body Control Module (BCM) (3) from the electrical caddy (2).
4. Remove the screw (5) retaining the ECM cover (4). Pull the ECM cover forward and out the left side of the vehicle.
5. Remove the security siren connector [142B] (6) from the retainer on the back of the electrical caddy. Route the connector and wiring under the battery tray (7) to the right side of the vehicle.
6. Remove the battery (8) from the vehicle per the service manual.
7. Insert security siren connector [142B] into the security siren (9) receptacle until the connector latches securely.
8. Snap the siren into the hooks (11) beneath the battery tray so the sounder disc (10) is toward the left front, facing downward.

NOTE

- Make sure that the cables and conduit are properly routed so they are not pinched during assembly.
- In order for the pager antenna to work properly, none of the small diameter portion should touch metal parts of the vehicle.

9. Route the siren pager antenna wire (12) over to the right side of the vehicle frame. Fasten to the top of the rear frame upright (13), away from the belt guard, with a cable strap (Item 14, not supplied) at the outward bend.
10. Bring the end of the large-diameter portion (15) of the pager antenna to the **underside** of the frame rear upper crossmember (17). Observe where the small-diameter portion (16) of the wire begins and ends on the crossmember.
11. Clean the entire area on the underside of the frame rear upper crossmember. See Adhesive Strips.
12. Remove the protective tape from the adhesive backing of the hook fastener (18). Attach the fastener to the cleaned area of the crossmember.
13. Route the siren pager antenna wire down the center of the installed fastener half. Straighten the pager antenna along the length of the fastener.

NOTE

Loop the end of the pager antenna back if needed so it remains captured between the fastener components. In order for the pager antenna to work properly, none of the small diameter portion should touch metal parts of the vehicle.

14. Install the plain-backed loop fastener (19) onto the hook fastener installed on the crossmember, capturing the pager antenna wire to hold it firmly in place on the underside of the crossmember. The remaining plain-backed loop fastener is not used in this application. It can be discarded.
15. Install the rear fender per the service manual.

NOTE

Verify that the ignition is OFF **before** attaching the battery cables and installing the main fuse.

16. Install the vehicle battery per the service manual. Attach the positive battery cable. Attach the negative battery cable. Apply a light coat of H-D electrical contact lubricant, petroleum jelly or corrosion retardant material to battery terminals.
17. Install the ECM. Install the ECM cover.
18. Install the BCM into the electrical caddy
19. See the service manual to install the main fuse.
20. Install left side cover.

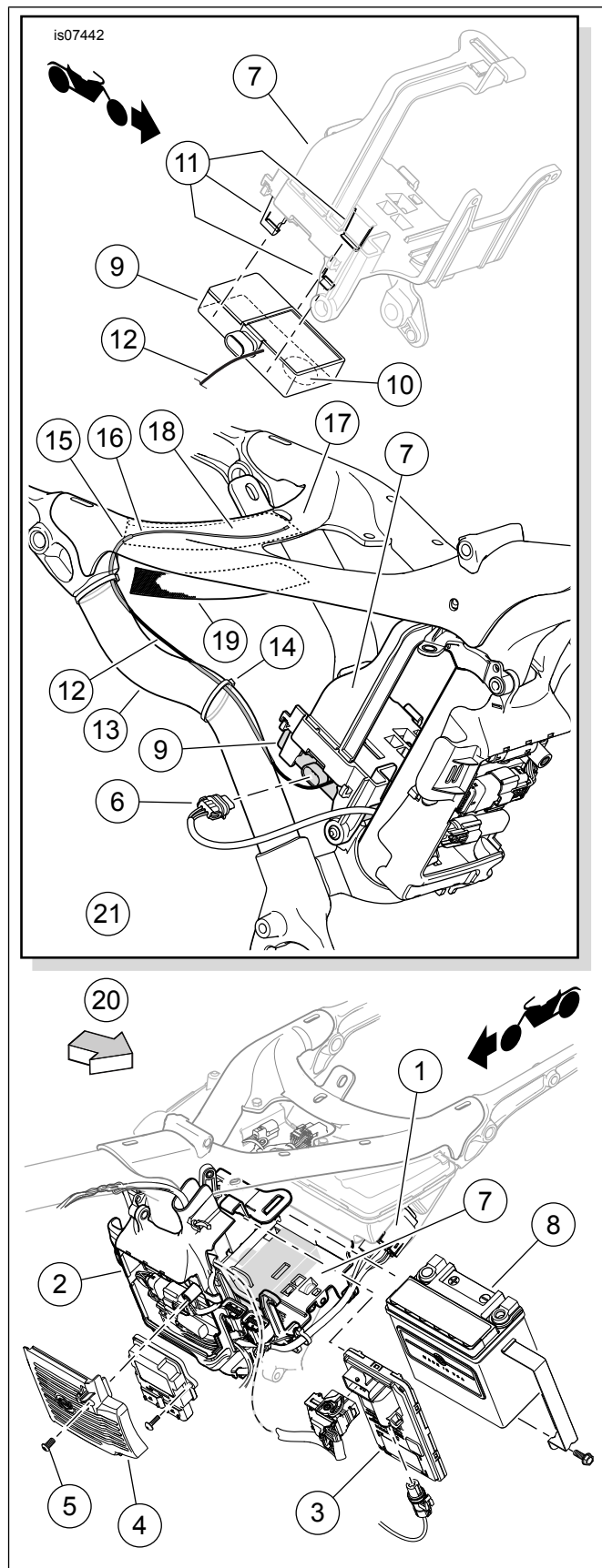

Figure 32. Siren Installation (2014-Later Sportster Models)

Table 1. Models

Item	Description (Quantity)
1.	Fuse box
2.	Electrical caddy
3.	Body Control Module (BCM)
4.	Electrical Control Module (ECM) cover
5.	ECM cover screw
6.	Security siren connector [142B]
7.	Battery tray
8.	Battery
9.	Security siren
10.	Sounder disc
11.	Hook (3) beneath battery tray
12.	Siren pager antenna
13.	Right side rear frame upright
14.	Cable strap
15.	Large-diameter portion of antenna
16.	Small-diameter portion of antenna
17.	Frame rear upper crossmember
18.	Adhesive-backed hook fastener
19.	Plain-backed loop fastener
20.	Direction of Inset views
21.	Views in direction of Arrow (19)

ALL Models

NOTE

The siren may not function properly when first installed. Nickel metal hydride (NiMH) rechargeable batteries discharge fairly rapidly when stored. They will lose as much as 1%-2% of their charge per day.

After a few months of storage at room temperature the batteries will be mostly discharged. If stored for a much longer period without charging, they may need a few charging cycles to regain their full capacity.

To charge the NiMH battery, operate the vehicle for a minimum of four hours.

SIREN DIAGNOSTICS

NOTE

Some models do not support chirpless mode. Reference owner's manual to verify support.

- If the siren is armed and the internal siren battery is dead, shorted, disconnected or has been charging for a period longer than 24 hours, the siren will respond with three chirps on arming instead of two.
- If the vehicle's charging system is producing less than 12.5 volts, the internal siren battery may not charge.
- If the siren does not chirp two or three times on a valid arming command from the security system, the siren is either in chirpless mode, not connected, not working, or the siren wiring was opened or shorted while the siren was disarmed.

- If the siren enters the self-driven mode where it is powered from the siren's internal 9 volt battery, the turn signal lamps may or may not alternately flash. If the security system activates the siren, the turn signal lamps will alternately flash. If the siren has been armed and a security event occurs, and the siren is in self-driven mode, the siren will alarm for 20-30 seconds, then turn off for 5-10 seconds. This alarm cycle will be repeated ten times if the siren is in the self-driven mode.

SMART SIREN II BATTERY REPLACEMENT

The siren's internal 9-volt battery is rechargeable. It does not need frequent replacing. Battery life under normal conditions is about three to six years.

NOTE

*When battery replacement is needed, use only a **nickel metal hydride (NiMH) 9 volt battery** in the siren. These batteries are widely available at local outlets.*

To Replace the Battery:

1. Refer to **POWER DISCONNECT** in the owner's manual. Follow the instructions to prevent the security module from actuating the siren.
2. Remove the siren box from the vehicle. Refer to the siren installation procedures for the specific model in this instruction sheet.
3. Open the battery cover by inserting a flat-blade screwdriver into one of the slots on the side of the siren box. Press until one corner of the cover pops up slightly.
4. Insert the screwdriver into the second slot. Press until the cover pops open. Remove the cover and gasket.
5. Remove the old battery from the siren box. Gently unfasten the snap connector from the battery. Save the grease coating the terminals.
6. Coat the terminals of the **new** NiMH nine-volt battery and the snap connector completely with the grease from the old connection.

NOTE

If not enough lubricant remains to cover the terminals completely, H-D Electrical Contact Lubricant is compatible. It is available from a Harley-Davidson dealer

7. Snap the connector onto the new battery. Install the battery into the siren box.
8. Set the siren box on a work surface with the battery opening facing up. Position the gasket and battery cover onto the siren box with the rounded corners facing out.
9. Press the cover down onto the siren box. Press the tabs in with the screwdriver until the tabs snap into the slots in the box.
10. Install the siren box into the vehicle.
11. Dispose of the old NiMH battery in accordance with local regulations.

SERVICE PARTS

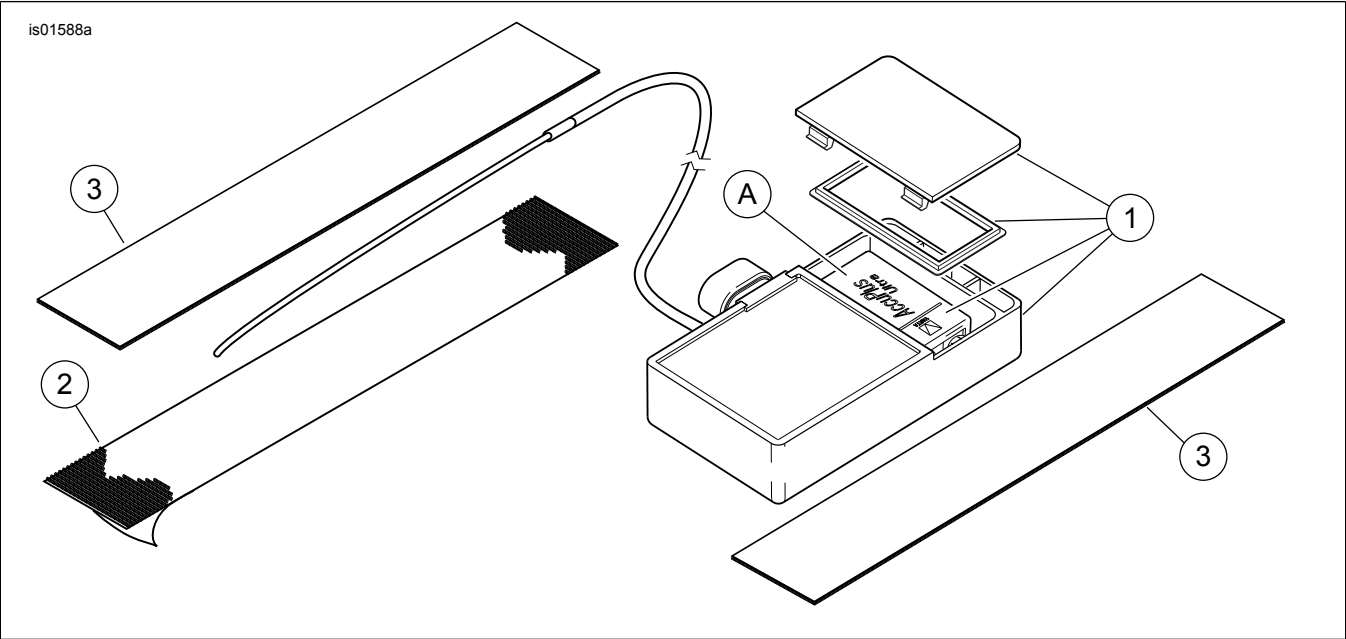

Figure 33. Service Parts, Smart Siren II Kit

Table 2. Service Parts

Item	Description (Quantity)	Part Number
1	Smart Siren II, security system	Not sold separately
2	Hook fastener, adhesive-backed, 210 x 38 mm (8½ x 1½ in)	Not sold separately
3	Loop fastener, plain-backed (2), 210 x 38 mm (8½ x 1½ in)	59274-01
Item mentioned in text:		
A	Battery, 9 volt NiMH	69309-10