



INSTRUCTIONS

J06526

2017-08-23



RIDER FOOTBOARD KIT

GENERAL

Kit Number

50500797, 50500798, 50500799

Models

For model fitment information, see the P&A Retail Catalog or the Parts and Accessories section of www.harley-davidson.com (English only).

NOTE

There may be decreased access to the jiffy stand tab on Softail models.

Installation Requirements

⚠ WARNING

Rider and passenger safety depend upon the correct installation of this kit. Use the appropriate service manual procedures. If the procedure is not within your capabilities or you do not have the correct tools, have a Harley-Davidson dealer perform the installation. Improper installation of this kit could result in death or serious injury. (00333b)

Kit Contents

See Figure 2 and Table 1.

INSTALLATION

1. See Figure 1. Remove e-clip (3), clevis pin (1), and return spring (2). Remove footboard. Save hardware for installation.
2. Clean and inspect footboard brackets. Replace if worn, rusted or damaged.

3. Install footboard.

- a. Insert the short end of the torsion spring (2) into the forward most hole in the footboard.
- b. While holding the spring in place, install the footboard and spring onto the mounting bracket.
- c. Install clevis pin (1).
- d. Install e-clip (3).
- e. Rotate the footboard up and push the torsion spring into the slot on the mounting bracket.

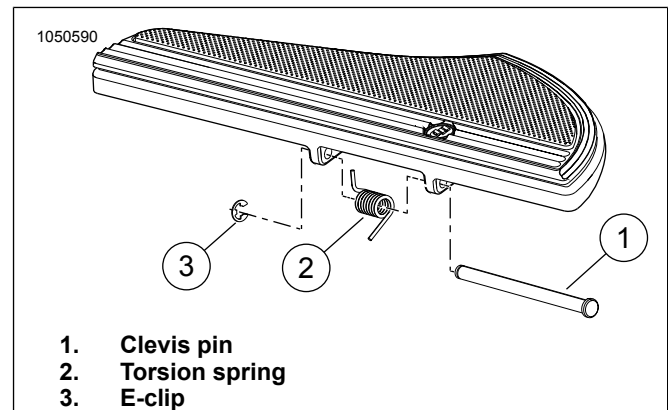

Figure 1. Rider Footboard Installation

4. Check that footboard pivots freely on clevis pin.
5. Repeat for opposite side.

NOTE

Avoid contacting chrome surfaces with abrasive materials (stones, sand, etc.) as damage will result.

SERVICE PARTS

1050732

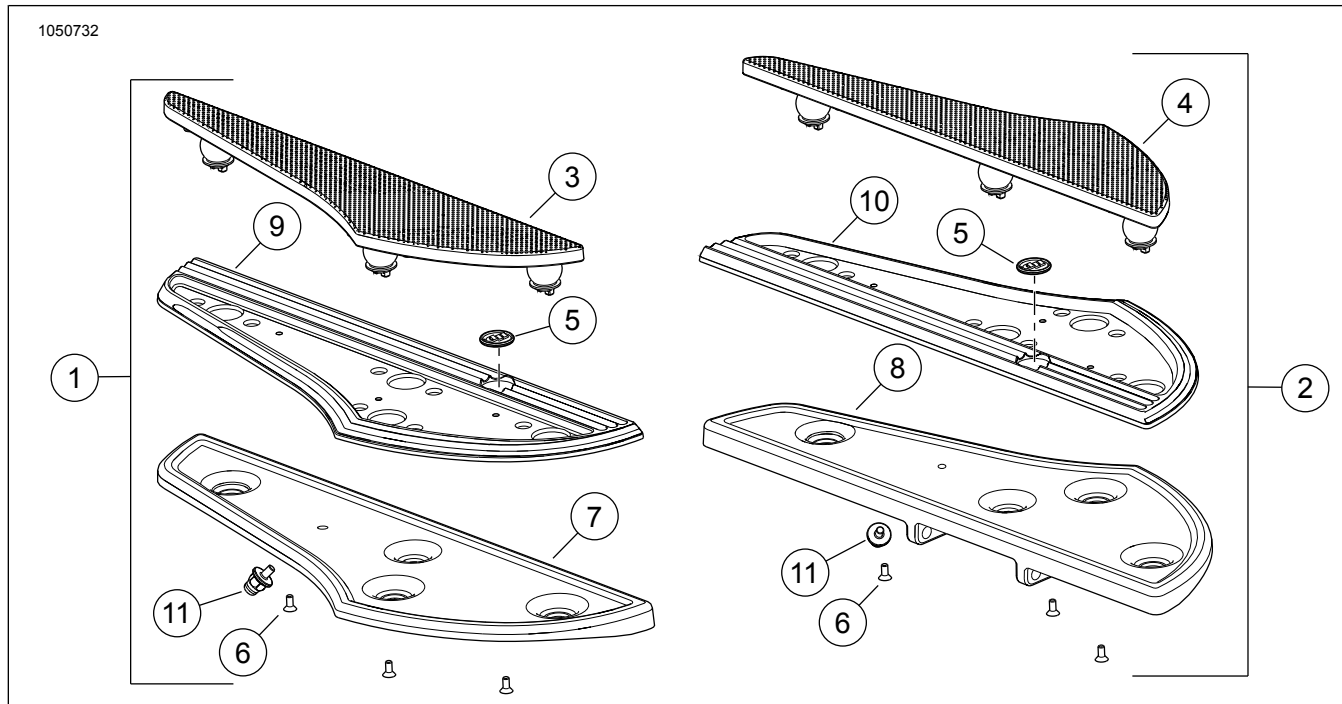

Figure 2. Service Parts: Rider Footboard

Table 1. Service Parts Table

Item	Description (Quantity)	Part Number
1	Rider Footboard Assembly, right (black) (not shown)	Not Sold Separately
	Rider Footboard Assembly, right (machine cut) (not shown)	Not Sold Separately
	Rider Footboard Assembly, right (chrome)	Not Sold Separately
2	Rider Footboard Assembly, left (black) (not shown)	Not Sold Separately
	Rider Footboard Assembly, left (machine cut) (not shown)	Not Sold Separately
	Rider Footboard Assembly, left (chrome)	Not Sold Separately
3	Rider Footboard Rubber Insert, right (all models)	50500556
4	Rider Footboard Rubber Insert, left (all models)	50500557
5	Medallion	14100874
6	Screw, #10-24 x 0.216 in (6)	Not Sold Separately
7	Rider Footboard Trim, right (black) (not shown)	50500828
	Rider Footboard Trim, right (chrome)	50501057
8	Rider Footboard Trim, left (black) (not shown)	50500827
	Rider Footboard Trim, left (chrome)	50501058
9	Rider Footboard Pan, right (black) (not shown)	Not Sold Separately
	Rider Footboard Pan, right (machine cut) (not shown)	Not Sold Separately
	Rider Footboard Pan, right (chrome)	Not Sold Separately
10	Rider Footboard Pan, left (black) (not shown)	Not Sold Separately
	Rider Footboard Pan, left (machine cut) (not shown)	Not Sold Separately
	Rider Footboard Pan, left (chrome)	Not Sold Separately
11	Wear Peg (all models) (2)	50500628