



# INSTRUCTIONS

J06311

2017-08-22



## MILWAUKEE-EIGHT CAM COVER

### GENERAL

#### Kit Number

25700602, 25700661, 25700710

#### Models

For model fitment information, see the P&A Retail Catalog or the Parts and Accessories section of [www.harley-davidson.com](http://www.harley-davidson.com) (English only).

### INSTALLATION REQUIREMENTS

#### ⚠ WARNING

Rider and passenger safety depend upon the correct installation of this kit. Use the appropriate service manual procedures. If the procedure is not within your capabilities or you do not have the correct tools, have a Harley-Davidson dealer perform the installation. Improper installation of this kit could result in death or serious injury. (00333b)

#### NOTE

This instruction sheet references Service Manual information. A Service Manual for your model motorcycle is required for this installation and is available from a Harley-Davidson Dealer.

### Additional Parts Required

Proper installation of this kit requires the separate purchase of one gasket (part no. 25700370).

### Kit Contents

See Figure 1 and Table 1.

### INSTALLATION

#### ⚠ WARNING

To prevent accidental vehicle start-up, which could cause death or serious injury, remove main fuse before proceeding. (00251b)

1. Remove main fuse. See the service manual.

#### NOTE

- **For vehicles equipped with security siren:** With security fob present, turn ignition switch ON. See the service manual. After system is disarmed, turn ignition switch OFF. **IMMEDIATELY** remove the main fuse.
- **For vehicles WITHOUT security siren:** See the service manual. Remove the main fuse.

2. Loosen or remove components necessary to access cam cover.

3. Drain oil.
4. See Figure 1. Remove cam cover (1).
5. Clean gasket surface.
6. Replace gasket.
7. Install cam cover. Tighten screws in sequence shown in service manual.  
Torque: 10.2–13.6 N·m (100–120 in-lbs)
8. Tighten or install components that were loosened or removed.
9. Fill with appropriate oil. See the service manual.
10. Install main fuse. See the service manual.

### SERVICE PARTS

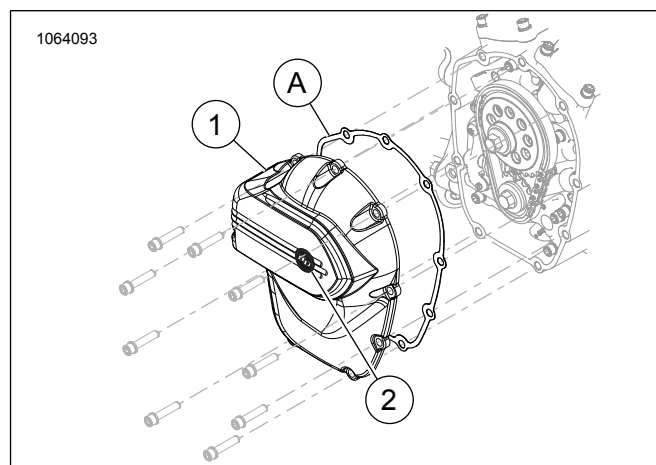

Figure 1. Milwaukee-Eight Cam Cover

Table 1. Service Parts

Item	Description (Quantity)	Part Number
1	Cam cover (1)	Not Sold Separately
2	Medallion (1)	14100874
Service Parts Required Sold Separately		
A	Gasket (1)	25700370