



INSTRUCTIONS

J06368

08-23-2017



SPRING LOADED RIDER FOOTPEG KIT

GENERAL

Kit Number

50500690, 50500709

Models

For model fitment information, see the P&A Retail Catalog or the Parts and Accessories section of www.harley-davidson.com (English only).

Additional Parts Required

⚠ WARNING

Rider and passenger safety depend upon the correct installation of this kit. Use the appropriate service manual procedures. If the procedure is not within your capabilities or you do not have the correct tools, have a Harley-Davidson dealer perform the installation. Improper installation of this kit could result in death or serious injury. (00333b)

NOTE

This instruction sheet references service manual information. A service manual for your model motorcycle is required for this installation and is available from a Harley-Davidson Dealer.

Kit Contents

See Figure 3 and Table 1.

INSTALLATION

1. See Figure 2. Your model motorcycle is equipped with a pin (4) and retaining clip (2), remove them and retain for future use. Save all hardware, including torsion spring (1), for installation of the new footpegs (3).

NOTE

See Figure 1. When performing the steps, verify that the spring is positioned inside of the footpeg.

2. Insert short leg of torsion spring (1) into hole in new footpeg (3). Align long leg of torsion spring (1) to hole in footpeg mount and insert. Rotate footpeg (3) into position in clevis and insert pin (4) through clevis, footpeg (3) and spring (1). Install retaining clip (2). Repeat on other side.

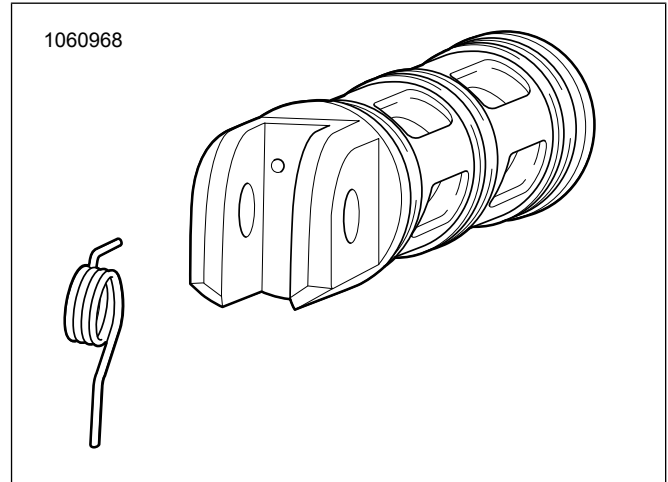

Figure 1. Torsion Spring

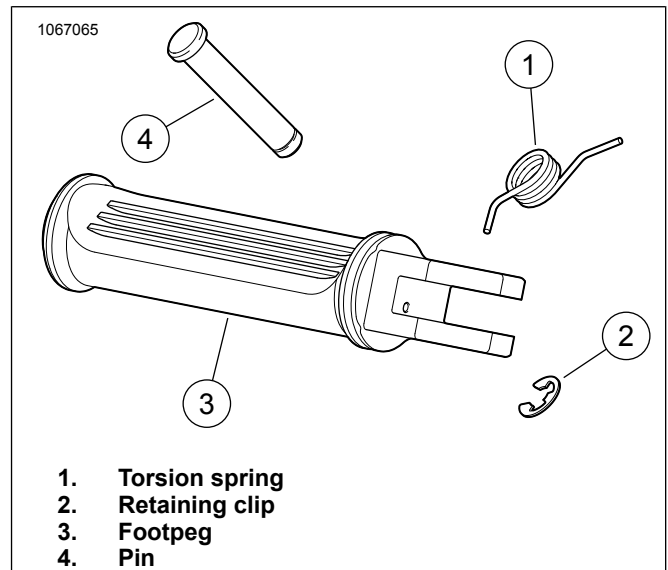

Figure 2. Rider Footpeg Torsion Spring Installation

CARE AND CLEANING GUIDELINES FOR BRASS PARTS

Cleaning Instructions

1. Verify part is dry and free of dirt or debris.
2. Place a small amount of Harley-Davidson® Chrome Clean & Shine on a microfiber cloth or detailing swab.
3. Using light pressure, rub the brass parts with the microfiber cloth. For hard to reach places or grooves, use the detailing swab.

Obtaining a Bright Finish

Brass parts will naturally age and darken with time. If a bright brass finish is preferred, place some Harley-Davidson Bare

Metal Polish on a microfiber cloth and lightly rub on the brass parts until they reach the desired brightness.

Slowing the Natural Aging Process

To slow the aging process of the brass parts, place a small amount of Harley-Davidson Glaze Poly Sealant on a microfiber cloth or detailing swab, and lightly rub on the parts until the sealant has soaked in.

Precautions

- Use of non-recommended cleaning, polishing and protective products will result in the removal of the aged finish from the brass parts.
- Prolonged contact with certain items (hands, gloves, boots, dust, etc.) and exposure to the elements will also alter all surface finishes and is NOT considered a defect.
- Avoid cleaning parts with abrasive and aggressive chemicals and abrasive cleaning pads.
- Avoid ammoniated products and bleach.
- Prolonged exposure to water will alter the brass finish. Wipe down parts after contact with water.
- Excess rubbing may lighten the surface appearance of the part.

SERVICE PARTS

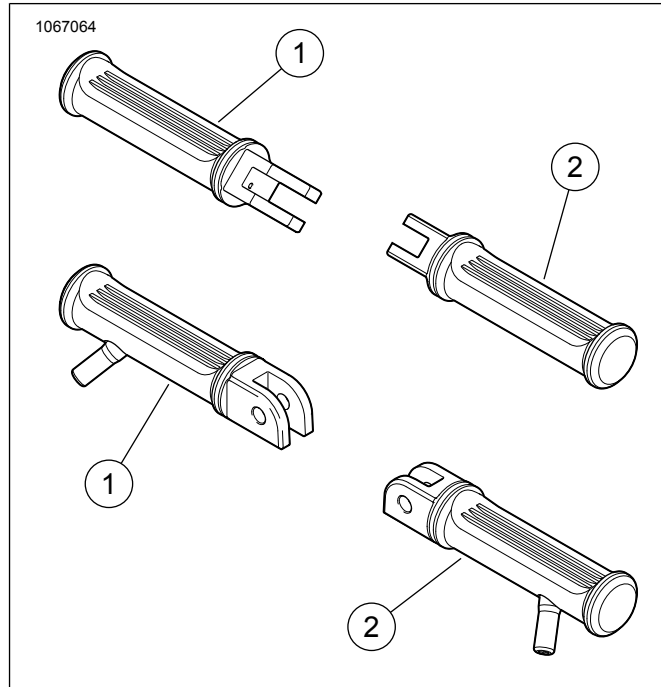

Figure 3. Service Parts: Footpeg Kit

Table 1. Kit Contents

Kit	Item	Description (Quantity)	Part Number
50500690	1	Left forward rider footpeg assembly	Not sold separately
	2	Right forward rider footpeg assembly	Not sold separately
50500709	1	Left middle rider footpeg	Not sold separately
	2	Right middle rider footpeg	Not sold separately