



INSTRUCTIONS

J04379

2017-08-22



BILLET SHIFTER PEG

GENERAL

Kit Numbers

49238-98, 49254-99, 49256-99, 35286-10, 34671-10, 33600093

Models

For model fitment information, see the P&A Retail Catalog or the Parts and Accessories section of www.harley-davidson.com (English only).

Kit Contents

See Figure 1 and Table 1.

INSTALLATION

1. Remove and discard the original equipment shifter peg. If needed, use a heat gun to apply heat to the shift lever and shifter peg threads to aid in peg removal.
2. See Figure 1. Discard retainer holding the screw on the new shifter peg.
3. Insert the screw through the peg into the shift lever. Tighten screw.

Torque: 15–20 N·m (11–15 ft-lbs)

CARE AND CLEANING GUIDELINES FOR BRASS PARTS

Cleaning Instructions

1. Verify part is dry and free of dirt or debris.
2. Place a small amount of Harley-Davidson® Chrome Clean & Shine on a microfiber cloth or detailing swab.
3. Using light pressure, rub the brass parts with the microfiber cloth. For hard to reach places or grooves, use the detailing swab.

Obtaining a Bright Finish

Brass parts will naturally age and darken with time. If a bright brass finish is preferred, place some Harley-Davidson Bare Metal Polish on a microfiber cloth and lightly rub on the brass parts until they reach the desired brightness.

Slowing the Natural Aging Process

To slow the aging process of the brass parts, place a small amount of Harley-Davidson Glaze Poly Sealant on a microfiber cloth or detailing swab, and lightly rub on the parts until the sealant has soaked in.

Precautions

- Use of non-recommended cleaning, polishing and protective products will result in the removal of the aged finish from the brass parts.
- Prolonged contact with certain items (hands, gloves, boots, dust, etc.) and exposure to the elements will also alter all surface finishes and is NOT considered a defect.
- Avoid cleaning parts with abrasive and aggressive chemicals and abrasive cleaning pads.
- Avoid ammoniated products and bleach.
- Prolonged exposure to water will alter the brass finish. Wipe down parts after contact with water.
- Excess rubbing may lighten the surface appearance of the part.

SERVICE PARTS

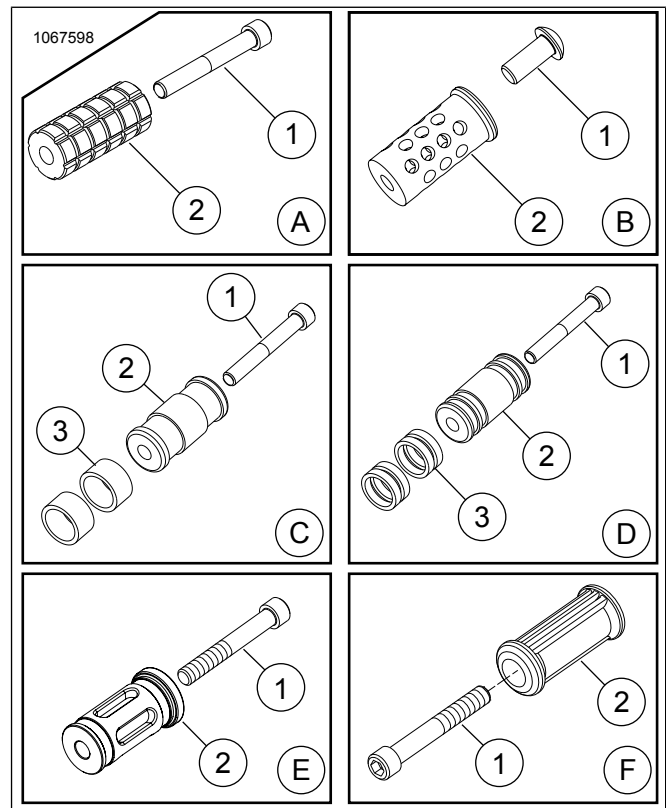

Figure 1. Service Parts: Billet Shifter Peg Kits

Table 1. Service Parts Table

| Item | Description (Quantity) | Part Number |
|-------------------------|---|---------------------|
| A - Kit 49238-98 | | |
| 1 | Screw, 5/16-24 x 2.25 socket head cap, lock-patch | Not Sold Separately |

Table 1. Service Parts Table

| Item | Description (Quantity) | Part Number |
|--------------------------------------|--|---------------------|
| 2 | Shifter peg | Not Sold Separately |
| 4 | Retainer, screw (discard before installation of kit) | Not Sold Separately |
| B - Kit 35286-10 | | |
| 1 | Screw, 5/16-24 x 0.75 socket head cap, lock-patch | 4808 |
| 2 | Shifter peg | Not Sold Separately |
| C - Kit 49256-99 | | |
| 1 | Screw, 5/16-24 x 2.25 socket head cap, lock-patch | Not Sold Separately |
| 2 | Shifter peg | Not Sold Separately |
| 3 | Rubber (2) | 11308 |
| 4 | Retainer, screw (discard before installation of kit) | Not Sold Separately |
| D - Kit 49254-99 and 34690-08 | | |
| 1 | Screw, 5/16-24 x 2.25 socket head cap, lock-patch | Not Sold Separately |
| 2 | Shifter peg | Not Sold Separately |
| 3 | Rubber (4) | 11306 |
| 4 | Retainer, screw (discard before installation of kit) | Not Sold Separately |
| E - Kit 34671-10 | | |
| 1 | Screw, 5/16-24 x 2.25 socket head cap, lock-patch | Not Sold Separately |
| 2 | Shifter peg | Not Sold Separately |
| 3 | Retainer, screw (discard before installation of kit) | Not Sold Separately |
| F - Kit 33600093 | | |
| 1 | Screw, 5/16-24 x 2.25 socket head cap, lock-patch | Not Sold Separately |
| 2 | Shifter peg | Not Sold Separately |