



INSTRUCTIONS

J06585

2017-08-22



BLACK CONSOLE KIT

GENERAL

Kit Numbers

70900821

Models

For model fitment information, see the P&A retail catalog or the Parts and Accessories section of www.harley-davidson.com (English only).

⚠ WARNING

Rider and passenger safety depend upon the correct installation of this kit. Use the appropriate service manual procedures. If the procedure is not within your capabilities or you do not have the correct tools, have a Harley-Davidson dealer perform the installation. Improper installation of this kit could result in death or serious injury. (00333b)

NOTE

This instruction sheet references service manual information. A service manual for this year/model motorcycle is required for this installation. One is available from a Harley-Davidson dealer.

Kit Contents

See Figure 1 and Table 1.

PREPARE

⚠ WARNING

To prevent accidental vehicle start-up, which could cause death or serious injury, remove main fuse before proceeding. (00251b)

1. Remove main fuse. See the service manual.

REMOVE AND INSTALL

1. This kit installs in the same manner as the original equipment (OE) console. See the service manual to remove and install the console.

DISASSEMBLE

1. Remove Instrument Module (IM). See the service manual.
2. Remove indicator lamps. See the service manual.

ASSEMBLE

1. See Figure 1. Clean the area on the console (2) for the medallion. See Adhesive Strips.
2. Remove the protective tape from the adhesive backing of the console medallion (1). Attach the medallion to the cleaned area on the console (2).
3. Attach the rubber moulding trim (3) to the sides of the console.
4. Install indicator lamps. See the service manual.
5. Install IM. See the service manual.

COMPLETE

1. Install main fuse. See the service manual.

Adhesive Strips

1. **NOTE**

- Ambient temperature between 21–38 °C (70–100 °F) for proper adhesion. Do not apply below 10 °C (50.0 °F).
- Parts cannot be repositioned after initial adhesive installation.
- Allow **at least** 24 hours after application before exposing the area to vigorous washing, strong water spray or extreme weather.
- The adhesive bond will increase to maximum strength after about 72 hours at normal room temperature.
- Do not clean with denatured alcohol, mineral spirits or other solvents. Damage to components occurs.

Using a 50:50 isopropyl alcohol/water solution, thoroughly clean surface. Allow to dry completely.

2. Install item into area.
 - a. With the adhesive backing still in place, test fit the item to the area.
 - b. Remove the adhesive backing.
 - c. Install the item to the area.
 - d. Press surface of the item firmly to make sure that there is good adhesion.

SERVICE PARTS

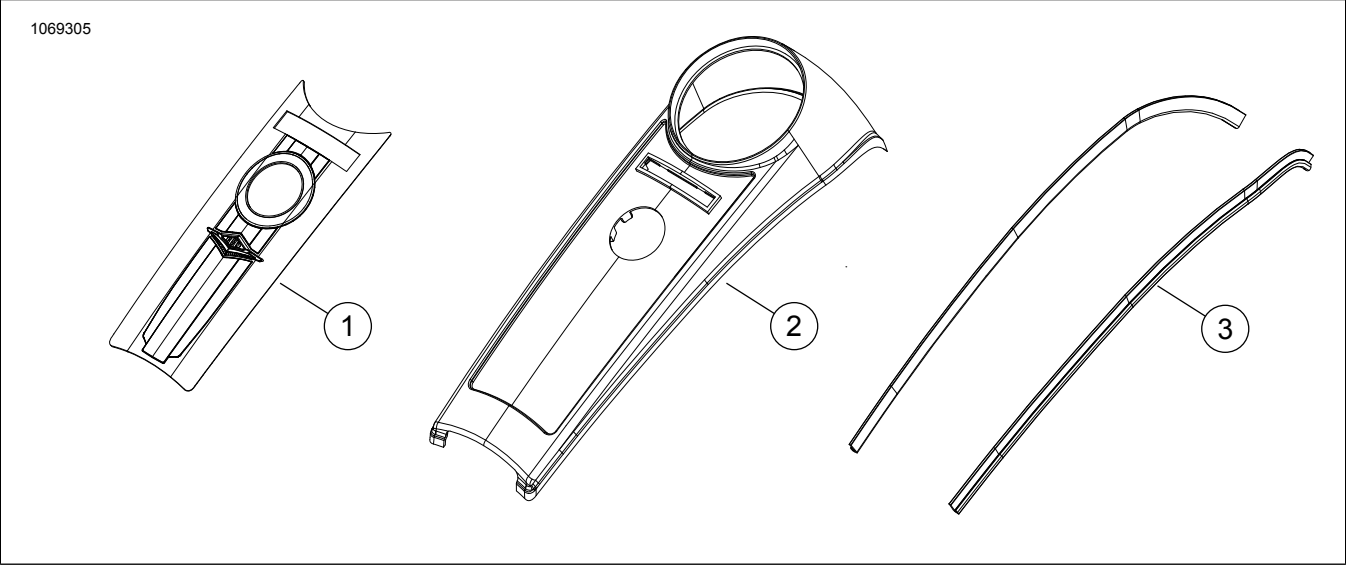

Figure 1. Service Parts: Black Console Kit

Table 1. Service Parts: Black Console Kit

Item	Description (Quantity)	Part Number
1	Console medallion	14101013
2	Console	70900744
3	Rubber moulding trim (2)	71294-08