



INSTRUCTIONS

J06441

2017-08-22



CHROME MID CONTROL BRACKET KIT

GENERAL

Kit Number

50500691

Models

For model fitment information, please see the P&A Retail Catalog or the Parts and Accessories section of www.harley-davidson.com (English only).

Additional Parts Required

This kit requires thread lock for proper installation. LOCTITE 243 MEDIUM STRENGTH THREADLOCKER AND SEALANT (BLUE) (99642-97)

⚠ WARNING

Rider and passenger safety depend upon the correct installation of this kit. Use the appropriate service manual procedures. If the procedure is not within your capabilities or you do not have the correct tools, have a Harley-Davidson dealer perform the installation. Improper installation of this kit could result in death or serious injury. (00333b)

SERVICE PARTS

1074200

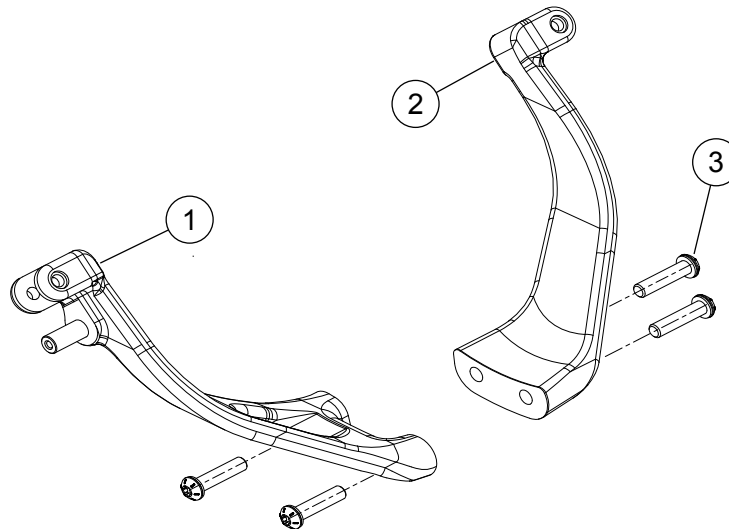

Figure 1. Service Parts: Chrome Mid Control Bracket Kit

NOTE

This instruction sheet references service manual information. A service manual for this year/model motorcycle is required for this installation. One is available from a Harley-Davidson dealer.

Kit Contents

See Figure 1 and Table 1.

REMOVE AND INSTALL

1. This kit installs in the same manner as the original equipment (OE) control brackets. See the service manual to remove and install the control brackets.

DISASSEMBLE

1. Disassemble control bracket. See the service manual.

ASSEMBLE

1. Assemble control bracket. See the service manual.



Table 1. Service Parts: Chrome Mid Control Bracket Kit

Item	Description (Quantity)	Part Number
1	Right footpeg bracket	50500995
2	Left footpeg bracket	50500994
3	Screw (4)	10200536