



INSTRUCTIONS

J06477

2018-01-16



SOFTAIL FAT HANDLEBAR RISER KIT

GENERAL

Kit Number

55900122, 55900123

Models

For model fitment information, see the P&A Retail Catalog or the Parts and Accessories section of www.harley-davidson.com (English only).

Installation Requirements

Proper installation of this kit requires the prior or concurrent installation of an appropriate Harley-Davidson 1-1/4 inch handlebar kit. Contact a Harley-Davidson dealer to determine which kits will fit your model motorcycle.

Proper installation of this kit may require longer cables, brake lines or wires. Contact a Harley-Davidson dealer to determine if your application requires additional parts.

⚠ WARNING

Rider and passenger safety depend upon the correct installation of this kit. Use the appropriate service manual procedures. If the procedure is not within your capabilities or you do not have the correct tools, have a Harley-Davidson dealer perform the installation. Improper installation of this kit could result in death or serious injury. (00333b)

NOTE

This instruction sheet references service manual information. A service manual for your model motorcycle is required for this installation and is available from a Harley-Davidson Dealer.

Kit Contents

See Figure 1 and Table 1.

PREPARATION

⚠ WARNING

To prevent accidental vehicle start-up, which could cause death or serious injury, remove main fuse before proceeding. (00251b)

1. Remove main fuse. See service manual.
2. Cover fuel tank with H-D service covers or clean shop towels to prevent scratching the finish.

REMOVAL

NOTE

If replacing the handlebars, reference the appropriate service manual to remove controls, hand levers, handlebar and risers. Note all electrical, cable and brake line connection routings and the order of riser hardware when removed.

If only the risers are being replaced, proceed as follows:

1. Remove handlebar clamp (or caps), discard clamp (or caps) and screws. See service manual.
2. Set handlebar on motorcycle.
3. Remove risers and discard. See service manual.

INSTALLATION

1. See Figure 1. Install the handlebar risers (3 or 6). See service manual.

NOTE

Leave handlebar risers loose.

2. Center handlebar (A) between risers using knurled areas (B) of handlebar as a guide.
3. Place handlebar clamp (2 or 5) in position.
4. Install screws (1 or 4). DO NOT tighten.
5. Raise handlebars to normal riding position and hold in position.
6. Secure handlebars.
 - a. Snug two front screws.

NOTE

A slight gap between upper clamp and risers should exist at front.

- b. Snug two rear screws.
- c. Tighten two rear screws.
Torque: 16.3–20.3 N·m (12–15 ft-lbs) *Handlebar rear clamp screws.*

NOTE

If installed or installing accessory handlebars follow torque specifications included with that instruction sheet.



- d. Tighten two front screws.
Torque: 16.3–20.3 N·m (12–15 ft-lbs) *Handlebar front clamp screws.*

- 7. Tighten riser mount nuts.
Torque: 40.7–54.3 N·m (30–40 ft-lbs) *Riser mount nuts.*

RETURN TO SERVICE

▲ WARNING

Be sure that all lights and switches operate properly before operating motorcycle. Low visibility of rider can result in death or serious injury. (00316a)

1. Install main fuse. See service manual.
2. Test front brake lever for pressure and operation.
3. Turn the ignition/light key switch to IGNITION and test lights and switches for proper operation.
4. Apply brake lever to test stop light lamp.

SERVICE PARTS

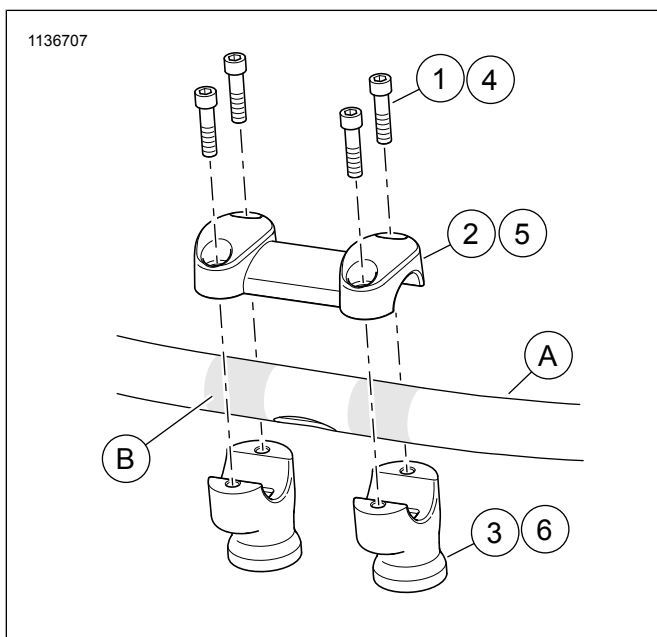

Figure 1.

Table 1. Service Parts Table

Item	Description (Quantity)	Part Number
	Chrome Fat Riser and Clamp kit	55900122
1	Screw, socket head (4)	4816A
2	Clamp, handlebar	Not Sold Separately
3	Riser, handlebar (2)	Not Sold Separately
	Black Fat Riser and Clamp kit	55900123
4	Screw, socket head (4)	3153
5	Clamp, handlebar	Not Sold Separately
6	Riser, handlebar (2)	Not Sold Separately
Items mentioned in text, but not included in kit:		
A	Handlebar	
B	Knurled area	