



INSTRUCTIONS

J00742

2020-09-22



SPORT LEXAN WINDSHIELD

GENERAL

Kit Number

58192-87A

Models

This kit fits 1987 and later models with 39mm forks and headlight eyebrow.

Installation Requirements

NOTE

Always pre-rinse screen with water to remove grit and soften dirt. Wash with mild liquid soap, lots of warm water, and a clean soft cloth or sponge. Rinse well to remove all soap residue. Dry with a chamois, flannel or moist sponge to prevent water spots.

Paint, grease: Use cotton wad moistened with turpentine, follow with wash as described above. This also works on label residue.

NOTE

If a hairline scratch or abrasion occurs on your windshield it can be minimized with a non-cleaning, non-silicone automotive polish. The polish will also make cleaning easier. These products tend to polish and fill scratches, making them invisible; Harley Glaze polish and sealant (p/n 99701-84), Johnson's Paste Wax, Maguiar's Mirror-glaze, Simonize Wax.

NOTICE

Harley-Davidson windshields are made of Lexan. Lexan is a more durable and distortion-resistant material than other types of motorcycle windshield material, but still requires attention and care to maintain. Failure to maintain Lexan properly can result in damage to the windshield. (00230b)

Kit Contents

Table 1. Kit Contents

Description	Qty	Description	Qty
U-clamp, 1 in.	2	Rubber Bushing	4
Nut, 3/8 in. Whizlok	2	Nut, 10-32 in. Whizlok	2
Washer, Beveled	4	Upright, Short	2
Cup Spacer	2	Fork Clamp, 39mm with Nut	2
Eyebolt, 3/8-16 in.	2	Angle Bracket	2
Lock Washer, Internal	2	Screw, Button Head Socket, 1/4-20 x 3/4 in.	2
Snap Cap	2	Washer, Flat, 1/4 ID	2
Screw, Nylon, 10-32 x 1 in.	3	Upright, Long	2

Table 1. Kit Contents

Description	Qty	Description	Qty
Washer, Dished	2	Windshield	1
Washer, Flat, 10 x 3/4 in.	4		

INSTALLATION

NOTE

This installation requires a flat blade screwdriver, 9/16 in. wrench, and a 3/16 in. hex wrench.

- See Figure 1. Support windshield on a non-abrasive surface and push an upright into each socket. DO NOT USE OIL, GREASE, OR SILICONE. Use water or saliva as a lubricant.

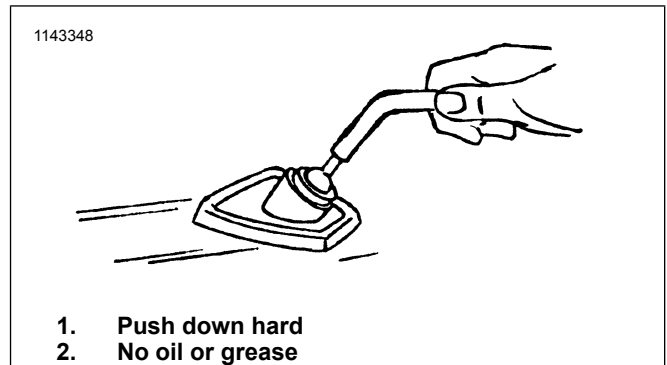

- Push down hard
- No oil or grease

Figure 1. Uprights into Shield

- See Figure 2. Place "U" clamp (6) around vertical segment of handlebar with open side of "U" clamp facing generally forward.
- Put cup spacer (2) and internal lock washer (3) on eyebolt (1).
- Slip eyebolt (1) through bottom of "U" clamp (6) from outside of handlebar. At the same time insert two beveled washers (4) into eyebolt inside "U" clamp (bevels toward each other), one on each side of handlebar.
- Start whizlok nuts (5) on eyebolt (1), but do not tighten.



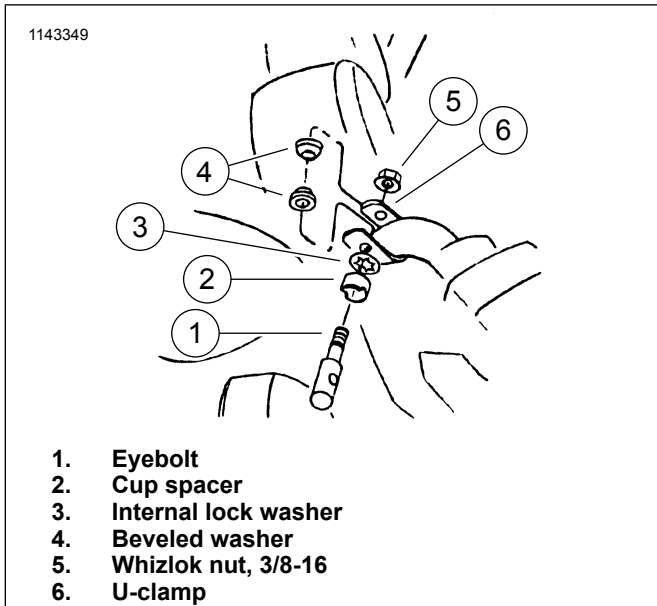

Figure 2. Assemble "U" Clamp

6. See Figure 3. Spread the fork clamps (4) and place around the top of the fork tubes so the flat side is to the outside and pointing forward, squeeze the clamps tight on the forks.
7. Bolt the angle brackets (3) to the fork clamps with the button hex screws (2) and flat washers (1). The ends of the angle brackets will point out.
8. Do not fully tighten the screws.

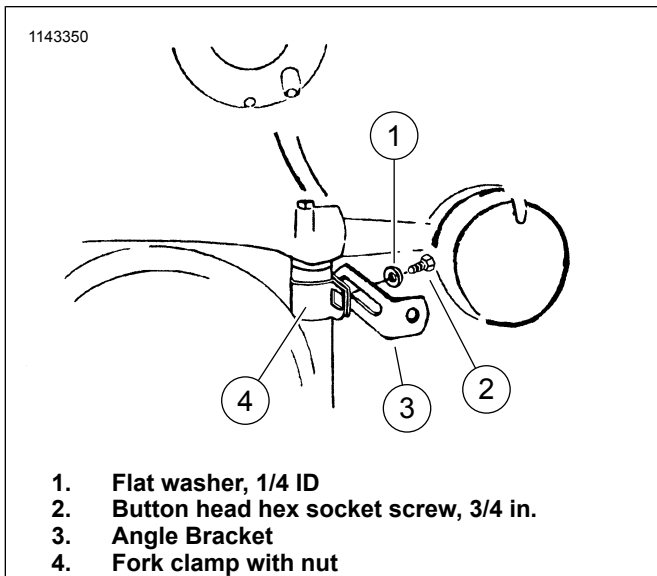

Figure 3. Assemble Lower Mount

9. See Figure 4. Slip upright into eyebolt "eyes" and tighten the nuts on the eyebolts until snug.
10. Assemble the lower mounts in the following order (front to rear): nylon screw (2), dished washer (3), flat washer (4), rubber bushing (5), windshield, rubber bushing (8), flat washer (7), angle bracket, whizlok nut (6).

11. Align shield for the desired angle and center it side to side. Gasket should rest on headlight cover.
12. Tighten the hardware in the following order: eyebolts, nylon screws, then fork clamp bolts.
13. Install snap caps (1) over nylon screws (2).

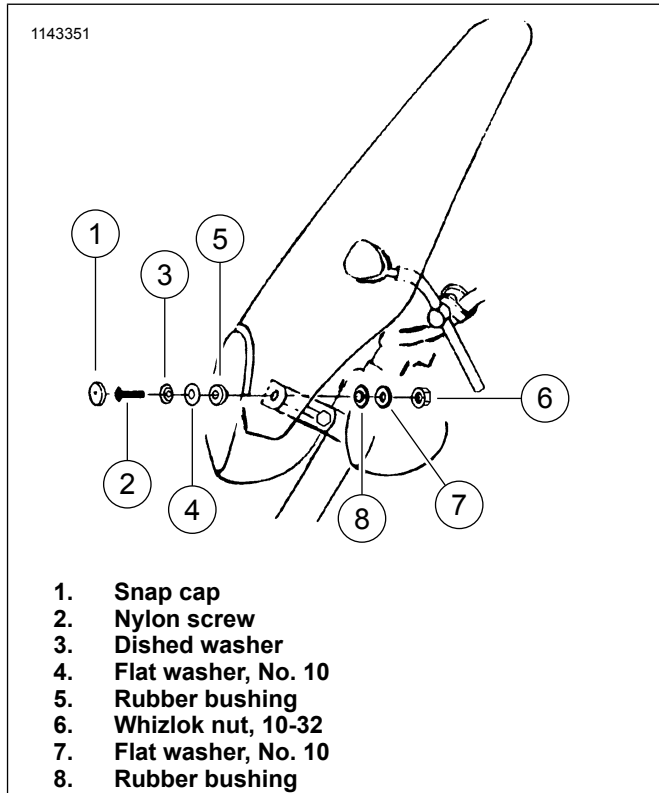

Figure 4. Mount Shield