



INSTRUCTIONS

J06488

2021-09-08



UPPER FORK STEM COVERS

GENERAL

Kit Number

45500308, 45500514, 45500515, 45500516, 45800113, 45500118, 45800117

Models

For model fitment information, see the P&A Retail Catalog or the Parts and Accessories section of www.harley-davidson.com (English only).

Kit Contents

See Figure 2 and Table 1.

INSTALLATION

1. See Figure 2. Place smaller slider tube cap covers (2) over slider tubes.
2. See Figure 1. Set screws must tighten against a flat (1) of fork nut as shown. Tighten.
Torque: 2.48–3.05 N·m (22–27 in-lbs)
3. **Kit 45500308 only.** See Figure 2. Remove stock fork stem nut cover.
4. Place larger fork stem nut cover (3) over fork stem nut.
5. Set screws must tighten against a flat (1) of fork nut as shown. Tighten.
Torque: 2.48–3.05 N·m (22–27 in-lbs)

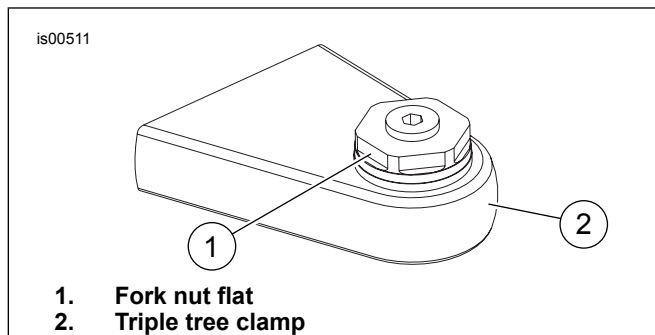

Figure 1. Fork Nut

3. Using light pressure, rub the brass parts with the microfiber cloth. For hard to reach places or grooves, use the detailing swab.

Obtaining a Bright Finish

Brass parts will naturally age and darken with time. If a bright brass finish is preferred, place some Harley-Davidson Bare Metal Polish on a microfiber cloth and lightly rub on the brass parts until they reach the desired brightness.

Slowing the Natural Aging Process

To slow the aging process of the brass parts, place a small amount of Harley-Davidson Glaze Poly Sealant on a microfiber cloth or detailing swab, and lightly rub on the parts until the sealant has soaked in.

Precautions

- Use of non-recommended cleaning, polishing and protective products will result in the removal of the aged finish from the brass parts.
- Prolonged contact with certain items (hands, gloves, boots, dust, etc.) and exposure to the elements will also alter all surface finishes and is NOT considered a defect.
- Avoid cleaning parts with abrasive and aggressive chemicals and abrasive cleaning pads.
- Avoid ammoniated products and bleach.
- Prolonged exposure to water will alter the brass finish. Wipe down parts after contact with water.
- Excess rubbing may lighten the surface appearance of the part.

SERVICE PARTS

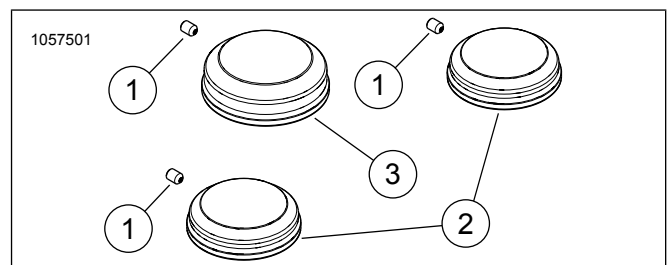

Figure 2. Service Parts: Fork Tube and Stem Cover Kit

CARE AND CLEANING GUIDELINES FOR BRASS PARTS

Cleaning Instructions

1. Verify part is dry and free of dirt or debris.
2. Place a small amount of Harley-Davidson® Chrome Clean & Shine on a microfiber cloth or detailing swab.



Table 1. Service Parts: Fork Tube and Stem Cover Kit

Item	Description (Quantity)	Part Number
1	Set Screw, with lock patch (3) (Kit 45500308)	3365
	Set Screw, with lock patch (2) (Kit 45500514)	
	Set Screw, with lock patch (2) (Kit 45500515)	
	Set Screw, with lock patch (2) (Kit 45500516)	
	Set Screw, with lock patch (2) (Kit 45800113)	
	Set Screw, with lock patch (2) (Kit 45800117)	
	Set Screw, with lock patch (2) (Kit 45800118)	
2	Cover, fork tube (2)	Not Sold Separately
	Cover, fork tube, chrome (2)	
	Cover, fork tube, black (2)	
	Cover, fork tube, machined black (2)	
3	Cover, fork tube, bronze (2)	Not Sold Separately
	Cover, fork stem nut (Kit 45500308)	