



INSTRUCTIONS

J02607

2018-08-21



HEEL/TOE SHIFT LEVER KITS

GENERAL

Kit Number

34023-08, 34535-00B, 34558-05A, 34045-10, 33600076, 33600255

Models

For model fitment information, see the P&A Retail Catalog or the Parts and Accessories section of www.harley-davidson.com (English only).

Installation Requirements

LOCTITE 243 MEDIUM STRENGTH THREADLOCKER AND SEALANT (BLUE) (99642-97) is required for the proper installation of this kit.

Kit Contents

See Figure 1 and Table 1.

REMOVAL

NOTE

- Before removing the original shift levers, note the orientation. You may want to replace them at the same position and angle.
- Original Equipment (OE) shift levers are installed from the top or bottom, depending on the model motorcycle.

1. See Figure 1. Remove OE shifter pegs (A) and retain for installation to new levers if desired.
2. Remove socket head screws (3).
3. Remove OE shift levers.

INSTALLATION

1. Position toe shifter lever (1) at the desired angle and so the counterbored screw hole is facing down.

NOTE

When toe and heel levers are positioned correctly, the socket head cap screws are installed from the bottom of both levers.

2. Slide toe shifter lever onto splined shifter shaft.
3. Align screw hole with notch on shaft.
4. Position heel shifter lever (2) at the desired angle and so the counterbored screw hole is facing down.
5. Slide heel shifter lever onto splined shifter shaft, Aligning screw hole with notch on shaft.
6. Apply threadlocker to socket head screws (3).
Consumable: LOCTITE 243 MEDIUM STRENGTH THREADLOCKER AND SEALANT (BLUE) (99642-97)
7. Insert screws into counterbored holes. Tighten.
Torque: 32–35 N·m (24–26 ft-lbs) *Socket head screw*

NOTE

For proper installation, ensure that the toe and heel shifter are completely installed on shifter shaft and applied torque meets but does not exceed given range.

8. Apply threadlocker onto shifter peg screw threads if using OE pegs.
Consumable: LOCTITE 243 MEDIUM STRENGTH THREADLOCKER AND SEALANT (BLUE) (99642-97)
9. Install shifter pegs onto new shift levers. Tighten.
Torque: 11–16.4 N·m (97–145 in-lbs) *Shifter peg screw*
10. Check for proper operation and clearance.



SERVICE PARTS

260721

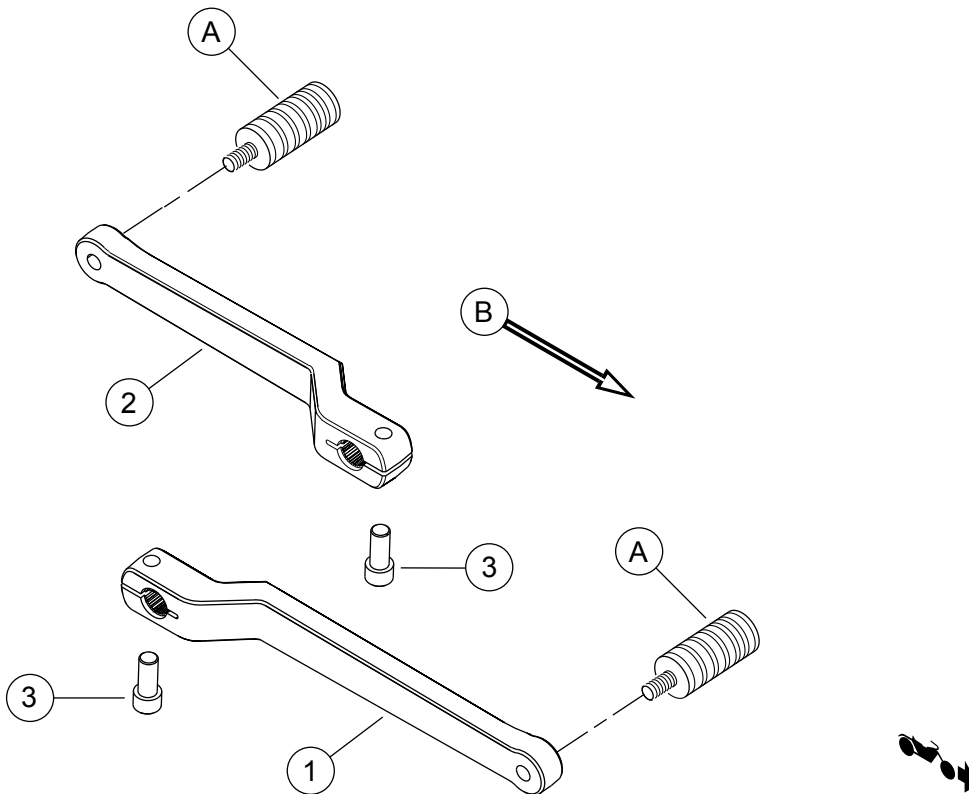

Figure 1. Service Parts: Shift Lever Kit (Generic Shown)

Table 1. Service Parts Table

Kit	Item	Description (Quantity)	Part Number
Kit 34023-08 Billet (black)	1	Toe shift lever (black)	Not sold separately
	2	Heel shift lever (black)	Not sold separately
	3	Hex socket head cap screw (2)	94332-91T
Kit 34535-00B Billet (chrome)	1	Toe shift lever (chrome)	Not sold separately
	2	Heel shift lever (chrome)	Not sold separately
	3	Hex socket head cap screw (2)	94332-91T
Kit 34558-05A Buckshot	1	Toe shift lever	33742-05A
	2	Heel shift lever	33747-07
	3	Hex socket head cap screw (2)	94332-91T
Kit 34045-10 Edge cut	1	Toe shift lever	Not sold separately
	2	Heel shift lever	Not sold separately
	3	Hex socket head cap screw (2)	94332-91T
Kit 33600076 Airflow	1	Toe shift lever	33600060
	2	Heel shift lever	33600061
	3	Hex socket head cap screw (2)	3275
Kit 33600255 Airflow (black)	1	Toe shift lever	33600225
	2	Heel shift lever	33600227
	3	Hex socket head cap screw (2)	3275
Items mentioned in text, but not included in kit:			
	A	Shifter peg (2)	
	B	Front of motorcycle	