



# INSTRUCTIONS

J06569

2018-08-21



## SOFTAIL DOMINION TRANSMISSION COVER

### GENERAL

#### Kit Number

34800047, 34800048

#### Models

For model fitment information, see the P&A Retail Catalog or the Parts and Accessories section of [www.harley-davidson.com](http://www.harley-davidson.com) (English only).

### INSTALLATION REQUIREMENTS

#### ⚠ WARNING

Rider and passenger safety depend upon the correct installation of this kit. Use the appropriate service manual procedures. If the procedure is not within your capabilities or you do not have the correct tools, have a Harley-Davidson dealer perform the installation. Improper installation of this kit could result in death or serious injury. (00333b)

#### NOTE

This instruction sheet references Service Manual information. A Service Manual for your model motorcycle is required for this installation and is available from a Harley-Davidson Dealer.

#### Additional Parts Required

Proper installation of this kit requires the separate purchase of one gasket (part no. 36805-06).

#### Kit Contents

See Figure 1 and Table 1

### INSTALLATION

#### ⚠ WARNING

To prevent accidental vehicle start-up, which could cause death or serious injury, remove main fuse before proceeding. (00251b)

1. Remove main fuse. See service manual.

#### NOTE

- For vehicles equipped with security siren: With security fob present, turn ignition switch ON. See service manual. After system is disarmed, turn ignition switch OFF. IMMEDIATELY remove the main fuse.
- For vehicles WITHOUT security siren: See service manual. Remove main fuse.

2. Loosen or remove components necessary to access transmission cover.

3. Drain transmission oil. See service manual.
4. See Figure 1. Remove transmission cover (1).
5. Clean gasket surface.
6. Replace gasket (A).
7. Install transmission cover (1). Tighten screws (2) in sequence shown in service manual.  
Torque: 10.2–13.6 N·m (100–120 in-lbs)
8. Tighten or install components that were loosened or removed.
9. Fill with appropriate oil. See service manual.
10. Install main fuse. See service manual.

### INSERT INSTALLATION (Optional)

1. Remove screws (2) from insert pockets and retain.
2. Install insert (B) with screws (2). Tighten.  
Torque: 2.03 N·m (18 in-lbs)

### SERVICE PARTS

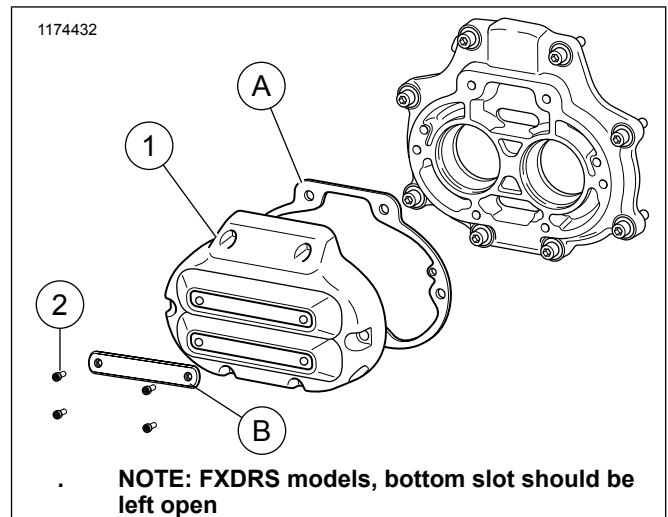

Figure 1. Transmission Cover

Table 1. Service Parts

Item	Description (Quantity)	Part Number
1	Transmission cover	Not Sold Separately
2	Screw (4)	10200659
Service Parts Required Sold Separately		
A	Gasket	36805-06



**Table 1. Service Parts**

<b>Item</b>	<b>Description (Quantity)</b>	<b>Part Number</b>
B	Insert:	
	Black	61400598
	Black w/HDMC	61400609
	Bronze	61400602
	Orange	61400606