



# INSTRUCTIONS





J03315

2019-08-21



## AIR CLEANER COVER

Table 1. General Information

Kits	Suggested Tools	Skill Level*	Time
27956-10, 29417-04, 29820-11, 29400366, 61300057, 61300058, 61301027, 61400007, 61400009, 61400019, 61400021, 61400049, 61400050, 61400052, 61400163, 61400164, 61400166, 61400167, 61400168, 61400170, 61400323	Safety Glasses, Torque Wrench	   	1 hour

(1) \*Tightening to torque value or other moderate tools and techniques required

### KIT CONTENTS

1282342

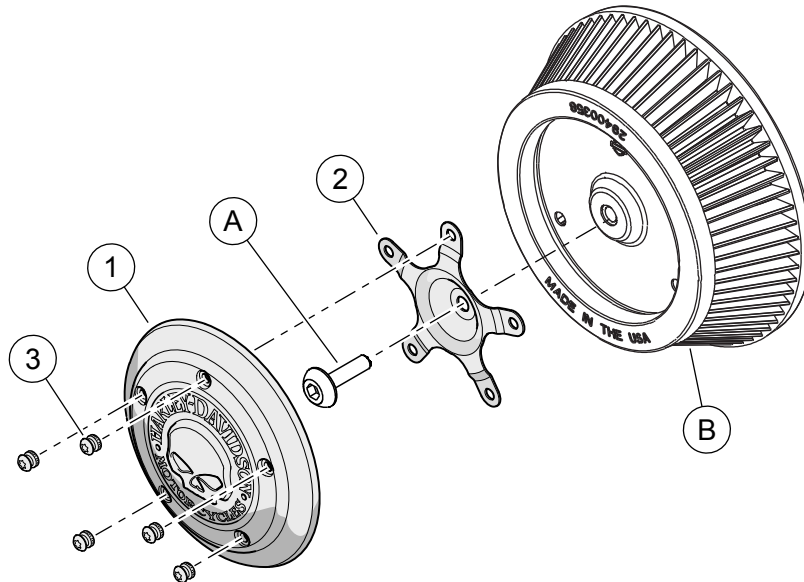

Figure 1. Kit Contents: Air Cleaner Cover



**Table 2. Kit Contents List: Air Cleaner Cover**

<input checked="" type="checkbox"/>	Item	Qty	Description	Part No.	Notes
<input type="checkbox"/>	1	1	Air cleaner cover	Not sold separately	
<input type="checkbox"/>	2	1	Bracket, mounting (5 hole)	29077-03	Kits 27956-10, 29417-04, 29820-11, 29400366, 61300057, 61301027, 61400049, 61400163, 61400167, 61400323
		1	Bracket, mounting (5 hole)	61400011	Kits 61300058, 61400007, 61400009, 61400021, 61400052, 61400166, 61400170
		1	Bracket, mounting (5 hole)	12700026	Kits 61400019, 61400050, 61400164, 61400168
<input type="checkbox"/>	3	5	Screw, Torx™, button head, chrome	94590-98	All kits except 29400366 3.4–4.2 N·m (30–37 <b>in-lbs</b> )
		5	Screw, Torx™, button head, black oxide	10200435	Kit 29400366 only 3.4–4.2 N·m (30–37 <b>in-lbs</b> )
		5	Screw, Torx™, button head, chrome	10200894	Kit 61301027 only 3.4–4.2 N·m (30–37 <b>in-lbs</b> )
Items below are not included in kit but are referenced in text:					
<input checked="" type="checkbox"/>	A		Original Equipment buttonhead screw		3.4–6.8 N·m (30–60 <b>in-lbs</b> )
<input checked="" type="checkbox"/>	B		Original Equipment air cleaner cover		

**NOTE**

Verify all contents are present in the kit before installing or removing items from vehicle.

## GENERAL

### Models

See the P&A Retail Catalog or the Parts and Accessories section of [www.harley-davidson.com](http://www.harley-davidson.com) (English only) for model fitment information.

Verify use of most current version of instruction sheet at: [www.harley-davidson.com/isheets](http://www.harley-davidson.com/isheets)

Contact Harley-Davidson Customer Support Center at 1-800-258-2464 (U.S. only) or 1-414-343-4056.

## Installation Requirements

**⚠ WARNING**

Rider and passenger safety depend upon the correct installation of this kit. If the procedure is not within your capabilities or you do not have the correct tools, have a Harley-Davidson dealer perform the installation. Improper installation of this kit could result in death or serious injury. (00308b)

## INSTALL

1. See Figure 1. Remove and save Original Equipment (OE) air cleaner cover screw (A).
2. Install mounting bracket (2) with screw (A).
  - a. Position a bracket arm at the 12 o'clock position.
  - b. Tighten screw (A).  
Torque: 3.4–6.8 N·m (30–60 **in-lbs**)

3. Install air cleaner cover (1) to bracket (2).
  - a. Align holes in cover with holes in bracket.
  - b. Install and partially tighten each screw (3).
  - c. Tighten screws (3) in a star pattern.  
Torque: 3.4–4.2 N·m (30–37 **in-lbs**)
4. If OE intake is removed, apply Warning Label (if included) in a clearly visible area. Harley-Davidson suggests attaching the sticker to the following:
  - a. **Softail:** Right side lower fender
  - b. **Dyna:** Right side swing arm.
  - c. **Touring/Trike:** Inner primary topside or side cover.