



# INSTRUCTIONS

J06749

2021-01-19



## BRAKE RESERVOIR COVER

Table 1. General Information

Kits	Suggested Tools	Skill Level <sup>(1)</sup>	Time
61301075	Safety Glasses, Torque Wrench		30 minutes

(1) Tightening to torque value or other moderate tools and techniques required

### KIT CONTENTS

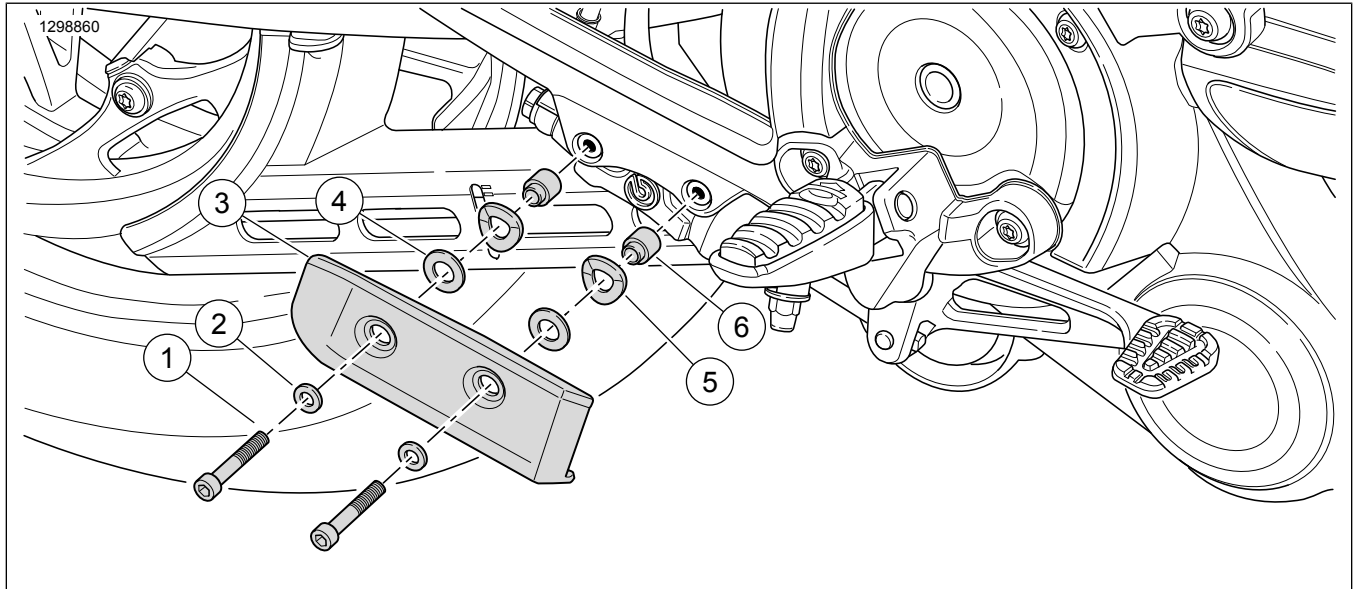

Figure 1. Kit Contents: Rear Brake Reservoir Cover Components

Table 2. Kit Contents: Rear Brake Reservoir Cover Components

<input checked="" type="checkbox"/>	Item	Qty	Description	Part No.	Notes
<input type="checkbox"/>	1	2	Screw	10200425	
<input type="checkbox"/>	2	2	Washer	10300194	
<input type="checkbox"/>	3	1	Cover	Not sold separately	
<input type="checkbox"/>	4	2	Washer, flat	6701	
<input type="checkbox"/>	5	2	Washer, spring	10600061	
<input type="checkbox"/>	6	2	Spacer, cover	61301120	

#### NOTE

Verify all contents are present in the kit before installing or removing items from vehicle.

### GENERAL

#### Models

For model fitment information, please see the P&A Retail Catalog or the Parts and Accessories section of [www.harley-davidson.com](http://www.harley-davidson.com) (English only).

Ensure you are using the most current version of the instruction sheet which is available at: [www.harley-davidson.com/isheets](http://www.harley-davidson.com/isheets)

Contact Harley-Davidson Customer Support Center at 1-800-258-2464 (U.S. only) or 1-414-343-4056.

## Installation Requirements

### ⚠ WARNING

Rider and passenger safety depend upon the correct installation of this kit. If the procedure is not within your capabilities or you do not have the correct tools, have a Harley-Davidson dealer perform the installation. Improper installation of this kit could result in death or serious injury. (00308b)

## REMOVE

1. See Figure 2. Remove Original Equipment (OE) screws (1) from rear brake cylinder.

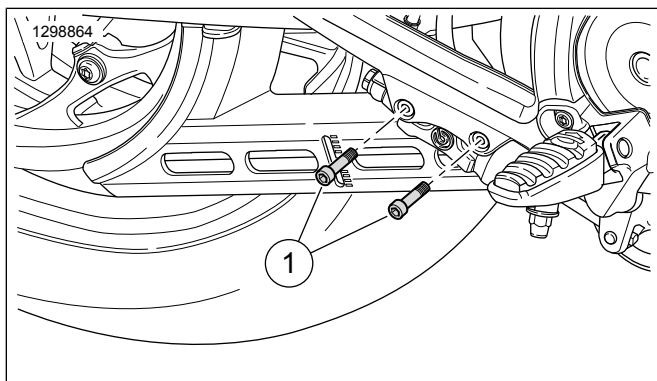

Figure 2. OE Screw Removal from Rear Brake Cylinder

## INSTALL

### NOTE

Verify spacers (61301120) are aligned with holes in carbon fiber trim prior to tightening screws (10200892).

1. See Figure 1. Install assembled cover to rear brake cylinder using **new** screws (1). Tighten.

Torque: 8–10 N·m (71–89 in-lbs)