



INSTRUCTIONS

J06779

2019-08-21



FLUSH MOUNT FUEL CAP KIT

GENERAL

Kit Number

61100158

Models

For model fitment information, see the P&A retail catalog or the Parts and Accessories section of www.harley-davidson.com (English only).

Kit Contents

See Figure 2 and Table 1.

INSTALL

⚠ WARNING

When servicing the fuel system, do not smoke or allow open flame or sparks in the vicinity. Gasoline is extremely flammable and highly explosive, which could result in death or serious injury. (00330a)

NOTE

Extended exposure of gas cap to a wet environment (rain/washing) may cause a small amount of water to collect between the pop-up housing and the threaded body. Simply remove the fuel filler cap and tilt to drain. Water cannot flow through the cap.

1. Remove Original Equipment (OE) fuel filler cap from fuel tank.
2. Clean and wipe inside surface of fuel tank filler cup, O-ring seal surface, and trim ring adhesive surface with a mixture of equal parts of isopropyl alcohol and distilled water.
3. Install fuel filler cap into fuel tank.
 - a. Turn fuel filler cap clockwise into fuel tank until tight.
 - b. Press down on cap.
 - c. Rotate one-eighth turn clockwise to secure cap in position.

4. NOTE

To remove fuel filler cap, press down on cap. Rotate one-eighth turn counterclockwise until cap pops up. Continue turning counterclockwise to remove.

See Figure 1. Mark position of trim ring with masking tape (1) or grease pencil.

5. Carefully cut masking tape at location (2) with a hobby knife making sure not to scratch trim ring or paint surface on fuel tank.
6. Peel all adhesive backing off trim ring.
7. Using gas cap to center and masking tape (or grease pencil mark) to align, press trim ring firmly into position for about ten seconds.

8. NOTE

Allow trim ring to cure for about 5-7 minutes before continuing with kit installation.

Peel masking tape off (or remove grease pencil mark) from trim ring and fuel tank.

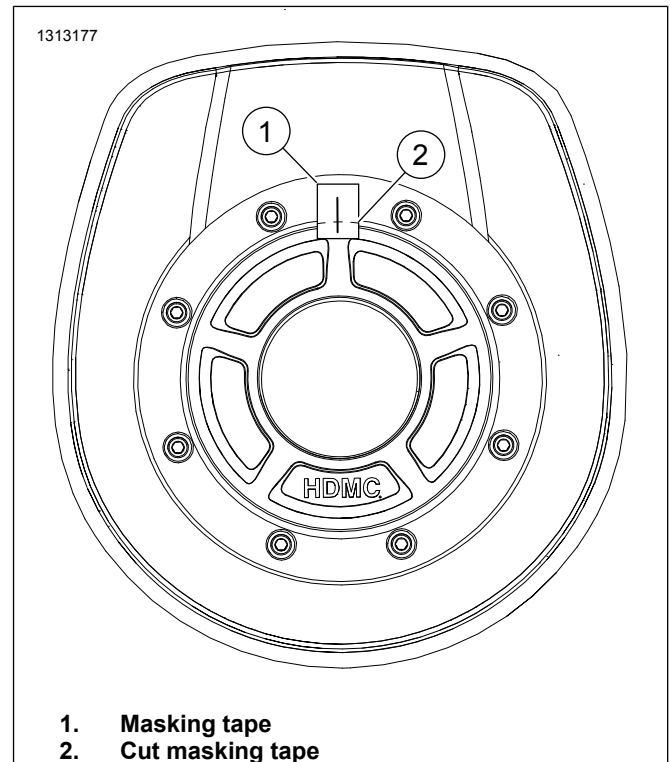

Figure 1. Align Trim Ring and Press into Place

SERVICE PARTS

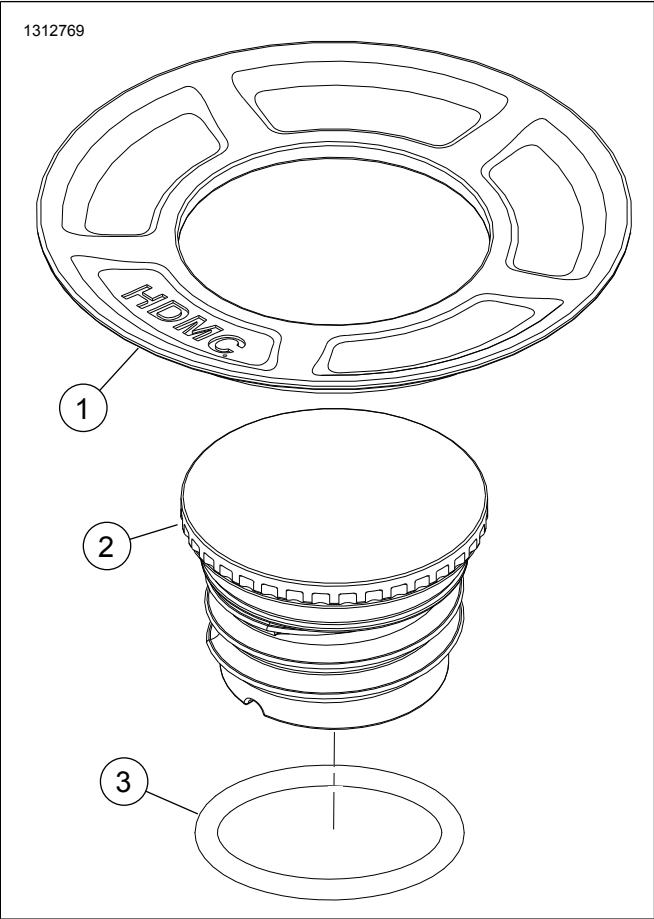

Figure 2. Service Parts: Flush-Mount Gas Cap Kit

Table 1. Service Parts

Item	Description (Quantity)	Part Number
1	Trim ring, black	61100157
2	Fuel filler cap	Not Sold Separately
3	O-ring	11900004