



# INSTRUCTIONS

94100025

2019-08-21



## ENGINE GUARD FOOTPEG BILLET MOUNTING KIT

### GENERAL

#### Kit Number

50957-02C, 54234-10A

#### Models

For model fitment information, see the P&A Retail Catalog or the Parts and accessories section of [www.harley-davidson.com](http://www.harley-davidson.com)

#### Additional Parts Required

This kit requires installing a set of footpegs, sold separately and available from a Harley-Davidson dealer.

#### Kit Contents

See Figure 1 and Table 1.

### INSTALLATION

1. See Figure 1. Position footpeg mount (3) and clamp (1) on engine guard.
2. Position footpeg mount (3) to allow footpeg to fasten on inboard side of engine guard.
3. Attach screws (4) to fasten footpeg mount in a comfortable location on engine guard.
4. Hand tighten each screw.
5. Alternate between screws when tightening. Tighten.  
Torque: 19 N·m (14 ft·lbs)
6. Install footpeg, sold separately.
  - a. Position spring washer (2) inside footpeg mount with square edge toward the inside of the mount.
  - b. Secure with clevis pin (5) and retaining ring (6).
7. Repeat steps 1-6 on the other side of the motorcycle.

### SERVICE PARTS

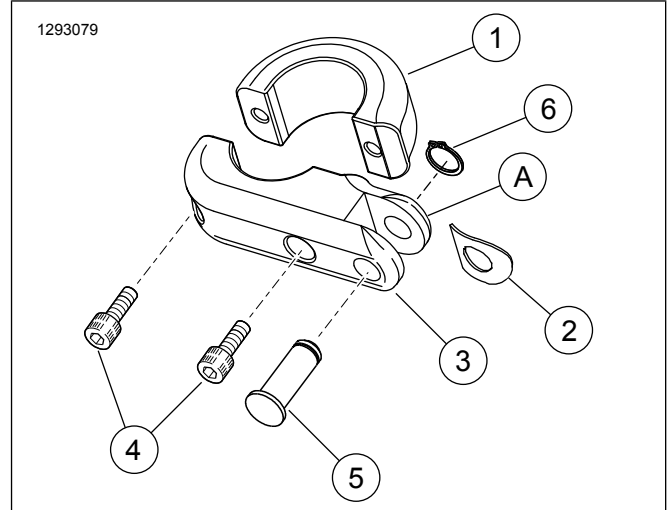

Figure 1. Service Parts: Engine-Guard Footpeg Billet Mounting Kit

Table 1. Service Parts Table

Kit	Item	Description (Quantity)	Part Number
50957-02C	1	Clamp, chrome (2)	51009-02A
	2	Spring washer (2)	50912-72
	3	Billet footpeg mount, chrome (2)	50501293
	4	Socket head screw (4)	4617
	5	Pin, clevis (2)	45041-01A
	6	Retaining ring (2)	11304
54234-10A	1	Clamp, black (2)	50500017
	2	Spring washer (2)	50912-72
	3	Billet footpeg mount, black (2)	50501292
	4	Socket head screw (4)	4617
	5	Pin, clevis (2)	50500501
	6	Retaining ring (2)	11304
<b>Items mentioned in text, but not included in kit:</b>			
	A	Position this part of the bracket toward the motorcycle	