



INSTRUCTIONS

J03321

2020-01-14



PASSENGER FOOTBOARD INSERT KITS

Table 1. General Information

Kits	Suggested Tools	Skill Level ⁽¹⁾	Time
50420-05, 50537-07, 52312-07, 50500090, 50501403, 50501796	Safety Glasses, Flat head screwdriver, Dish soap		1 hour

(1) Tightening to torque value or other moderate tools and techniques required

KIT CONTENTS

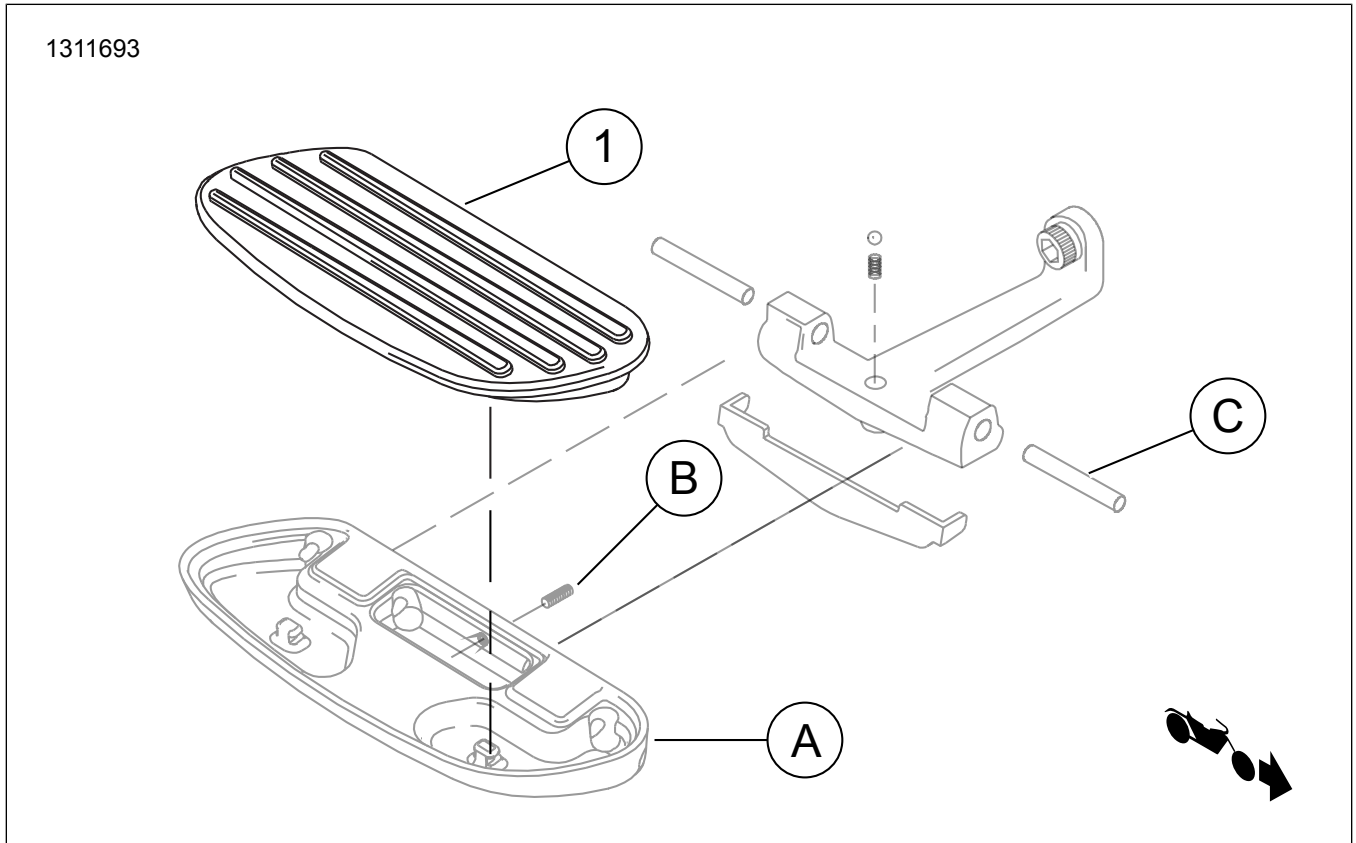

Figure 1. Kit Contents: Passenger Footboard Inserts Components (Right Side Shown)

Table 2. Kit Contents: Passenger Footboard Inserts Components

<input checked="" type="checkbox"/>	Item	Qty	Description	Part No.	Notes
<input type="checkbox"/>	1	1	Passenger footboard insert, right side (Kits: 50420-05, 50537-07, 50501403)	Not sold separately	
<input type="checkbox"/>			Passenger footboard insert, right side (Kit 52312-07, 50501796)	50823-07, 50501805	
<input type="checkbox"/>			Passenger footboard insert, right side (Kit 50500090)	50500061	
<input type="checkbox"/>	2	1	Passenger footboard insert, left side (Kits: 50420-05, 50537-07, 50501403), not shown	Not sold separately	
<input type="checkbox"/>			Passenger footboard insert, left side (Kit 52312-07, 50501796), not shown	50819-07, 50501807	
<input type="checkbox"/>			Passenger footboard insert, left side (Kit 50500090), not shown	50500060	
Items mentioned in text, but not included in kit:					
<input checked="" type="checkbox"/>	A	2	Footboard, passenger		
<input checked="" type="checkbox"/>	B	2	Set screw		
<input checked="" type="checkbox"/>	C	4	Pivot pins		

NOTE

Verify all contents are present in the kit before installing or removing items from vehicle.

GENERAL

Models

For model fitment information, please see the P&A Retail Catalog or the Parts and Accessories section of www.harley-davidson.com (English only).

Ensure you are using the most current version of the instruction sheet which is available at: www.harley-davidson.com/isheets

Contact Harley-Davidson Customer Support Center at 1-800-258-2464 (U.S. only) or 1-414-343-4056.

Installation Requirements

⚠ WARNING

Rider and passenger safety depend upon the correct installation of this kit. If the procedure is not within your capabilities or you do not have the correct tools, have a Harley-Davidson dealer perform the installation. Improper installation of this kit could result in death or serious injury. (00308b)

Separate purchase of a Swept Wing Passenger Footboard Kit and additional parts may be required for proper installation of this Passenger Footboard Insert Kit on your model motorcycle.

Also see the P&A Retail Catalog or the Parts and Accessories section of www.harley-davidson.com (English only) for a collection of matching Genuine Motor Accessory grips, pads and pegs that are available. These can be easily installed at the same time as this kit.

REMOVE

If replacing an insert or inserts on a vehicle currently equipped with Swept Wing Passenger Footboards:

Existing Footboard Insert Removal

NOTE

Carefully remove the currently install footboard insert to avoid damage to chrome surfaces.

1. Figure 1. Fold passenger footboard (A) into the UP position.
2. Loosen, but do not remove footboard insert setscrew (B).
3. With footboard folded DOWN, carefully raise an outside corner of existing insert (1) with a suitable flat head screwdriver, taking care to avoid damaging the chrome footboard pan.
4. Continue around the insert, using a second tool if necessary to pry existing insert (1) from footboard pan.
5. If replacing both inserts, repeat for the opposite footboard.

INSTALL

Swept Wing Passenger Footboard Installation

1. **If installing inserts on a vehicle NOT currently equipped with Swept Wing Passenger Footboards:**
 - a. Remove currently installed passenger **footboards** (if so equipped) per instructions included with Swept Wing Passenger Footboard Kit.
 - b. Remove currently installed passenger **footpegs** (if so equipped) by removing socket screw with lockwasher retaining the footpeg support bracket to rear fork (swingarm) bracket.
2. Follow instructions in Swept Wing Passenger Footboard Kit to install the passenger footboards.

Footboard Insert Installation

1. **ALL applications:** Center the two footboard pivot pins (C).
2. Use soapy water to moisten rubber dowel pins and pivot pin slots on bottom of **new** footboard insert.
3. Apply soapy water to the nubs on footboard pan.
4. Place insert into position with rubber dowel pins mating the holes in footboard pan.

NOTE

Medallion of Ride Free inserts should be toward rear of vehicle.

5. Firmly press insert into footboard until dowel pins pop into place and insert securely seats on nubs.
6. Fold passenger floorboard UP.
7. Tighten setscrew to secure insert.
8. Repeat steps for opposite side.

NOTE

Avoid contact of chrome surfaces with abrasive materials (stones, sand, etc.) as damage will result.