



INSTRUCTIONS

J06655

2020-08-24



SEISMIC FRONT WHEEL KITS

GENERAL

⚠ WARNING

Install only wheels and installation kits approved for your model motorcycle. Contact a Harley-Davidson dealer to verify fitment. Mismatching wheels and installation kits or installing wheels not approved for your model can cause loss of control, which could result in death or serious injury. (00610c)

- Chrome Clean & Shine (93600031 (US) / 93600082 (International))
- Glaze Poly Sealant (93600026 (US) / 93600079 (International))
- Harley® Preserve Bare Aluminum Protectant (99845-07)
- Harley® Wheel and Spoke Brush (43078-99)
- Wheel & Tire Cleaner (93600024 (US) / 93600076 (International))

Kit Numbers

43300575, 43300582, 43300583, 43300585

Models

For model fitment information, see the P&A Retail Catalog or the Parts and Accessories section of www.harley-davidson.com (English only).

Kit Contents

This kit includes a custom wheel only. See Figure 2 and Table 3 for kit contents.

Additional Parts Required

Proper installation of this kit requires the separate purchase of the following parts which are available at a Harley-Davidson dealer:

- Tires. Refer to Table 2.
- Wheel Installation Kit. Refer to Table 4 and Table 5 to determine required installation kit.
- Brake Disc Screws. See Figure 1 and Table 1.
- WHEEL BEARING INSTALLER/REMOVER 94143-09A.

Recommended Products

The following Harley-Davidson Genuine Motor Accessories are recommended for proper maintenance and cleaning:

⚠ WARNING

Rider and passenger safety depend upon the correct installation of this kit. Use the appropriate service manual procedures. If the procedure is not within your capabilities or you do not have the correct tools, have a Harley-Davidson dealer perform the installation. Improper installation of this kit could result in death or serious injury. (00333b)

NOTE

This instruction sheet references service manual information. A service manual for your model motorcycle is required for this installation and is available from a Harley-Davidson dealer.

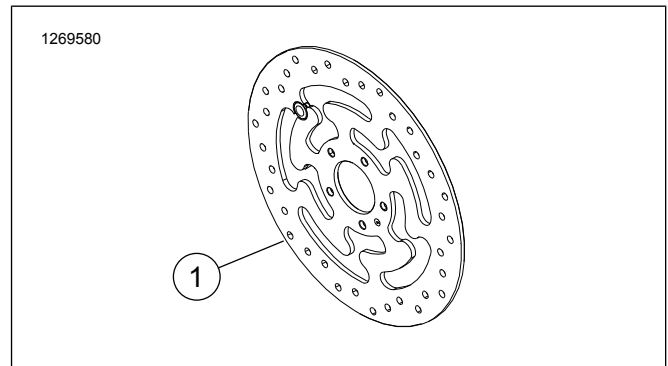

Figure 1. Front Brake Disc

Table 1. Front Disc Hardware Fitment

Brake Disc	Hardware
Closed disc	5 Stock disc screws (3655A) Chrome screw kit (46646-05) includes 5 screws
NOTE: Models equipped with dual front brakes and models being equipped with a wheel with dual brake mounting surfaces require twice as many screws and washers (10 total screws or 2 chrome screw kits if available).	

INSTALLATION

1. Remove existing front wheel assembly. Retain axle, axle nut, brake disc and wheel spacers for kit installation. See the service manual.

NOTE

- Install valve stem (40999-87) included in the installation kit.
2. See Figure 2. Install valve stem assembly on wheel. See the service manual.



NOTE

Install the primary bearing first using appropriate service manual and WHEEL BEARING INSTALLER/REMOVER 94143-09A.

- The left side of the wheel has a groove machined into the hub to identify it as the primary bearing side.
- The wheel should be installed so that the groove is on the left side of the motorcycle.
- The brake disc is installed on the left side of the wheel.

NOTICE

Do not re-use brake disc/rotor screws. Re-using these screws can result in torque loss and damage to brake components. (00319c)

3. Assemble the wheel installation, kit components and brake disc(s) to wheel, using the appropriate service parts table. See the service manual.
4. When installing tire, ensure protective covers are installed on the tire mounting machine to avoid paint chipping.
5. Install previously removed wheel spacers. See service manual.

6. Install front wheel (1), stock axle and stock axle nut. See service manual.

MAINTENANCE AND CLEANING

Parts must be maintained regularly so that they keep their original shine and luster.

1. Clean heavily-soiled wheel surfaces using Wheel & Tire Cleaner, applied with Harley Wheel and Spoke Brush.
2. Thoroughly clean wheel with a good quality cleaner, such as Wheel & Tire Cleaner.
3. After cleaning and polishing, seal the finish with a good quality sealer, such as Glaze Poly Sealant.

⚠ WARNING

Harley-Davidson recommends the use of its specified tires. Harley-Davidson vehicles are not designed for operation with non-specified tires, including snow, moped and other special-use tires. Use of non-specified tires can adversely affect stability, handling or braking and lead to loss of vehicle control, which could result in death or serious injury. (00024d)

Table 2. Specified Tire Combination

Kit Installation	Specified Tire	Front Tire Part No.	Rear Tire Part No.
2018 and later FXBR/FXBRS	Michelin Scorcher "11"	43100035	43189-11
2018 and later FLFB/FLFBS	Michelin Scorcher "11"	43100037	43189-11

SERVICE PARTS

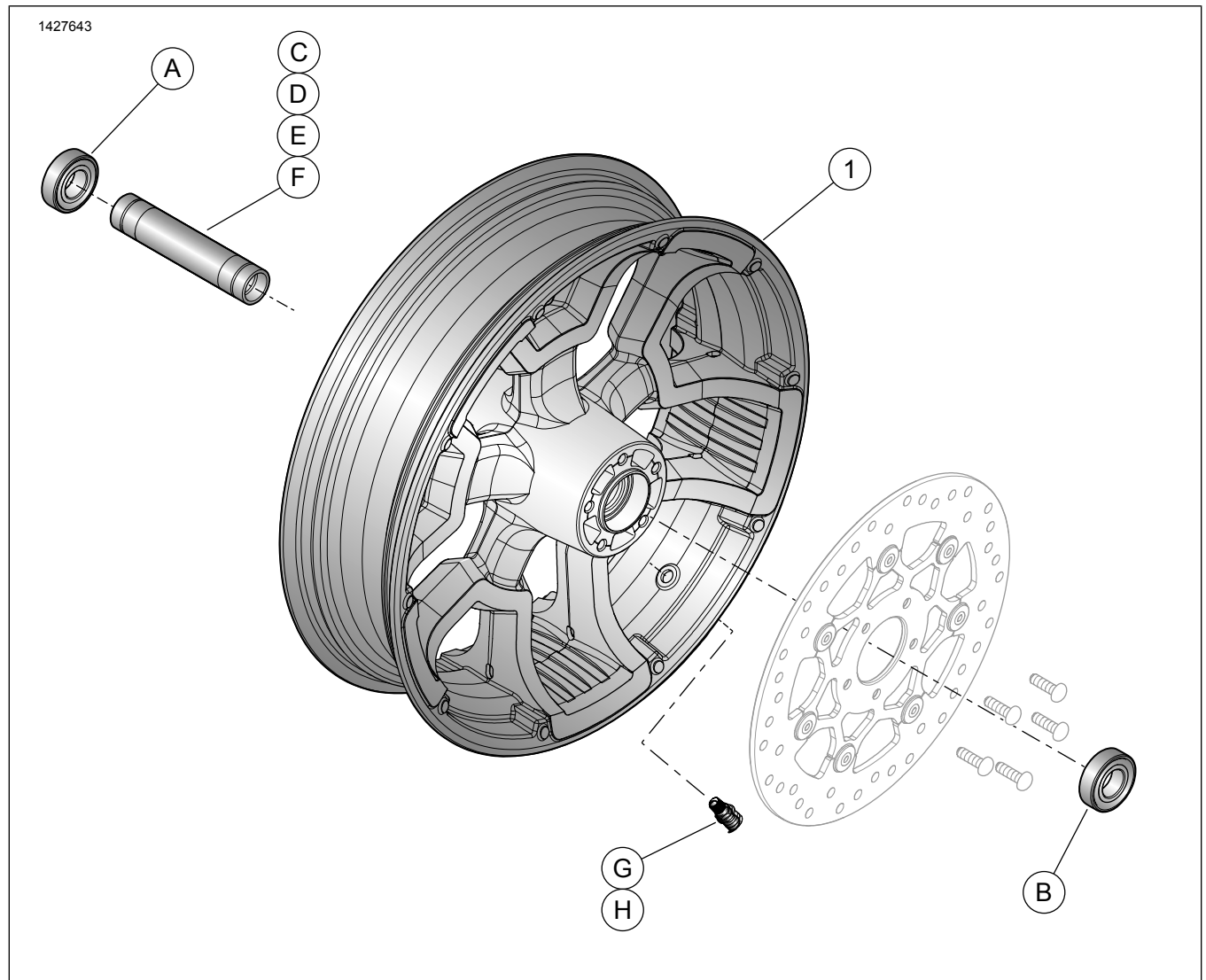

Figure 2. Service Parts: Front Wheel Kit

Table 3. Service Parts and Wheel Kit Contents

Kit	Item	Description (Quantity)	Part Number
43300575, 43300582, 43300583, 43300585	1	Wheel	Not Sold Separately
Visual indicator mentioned in text:			
	2	Groove	

Table 4. Front 25 mm Bearing ABS Wheel Installation Kit (42400034)

Front 25 mm Bearing ABS Wheel Installation Kit (42400034)		Item Quantity Used and Description									
Fitment	Wheel Size	A	B	C	D	E	F	G	H		
2018 and later FXFB	16 x 3.0	1	1	0	1	0	0	1	1		
2018 and later FL5B	18 x 3.5	1	1	0	1	0	0	1	1		
2018 and later FLFB/FLFBS	18 x 4.5	1	1	1	0	0	0	1	1		
2018 and later FXBB and FXLR	19 x 2.5	1	1	0	0	1	0	1	1		
2018 and later FXBR/FXBRS	21 x 3.5	1	1	0	0	0	1	1	1		
Installation kits are designed to work with many different wheel styles and fitments. Contact a Harley-Davidson dealer to verify that the wheel and installation kits are both designed and approved for the motorcycle they are being installed on.		A	Bearing, Regular					9276B			
		B	Bearing, ABS					9252A			
		C	Axle Sleeve					43300480			
		D	Axle Sleeve					43300483			
		E	Axle Sleeve					43300454			
		F	Axle Sleeve					43300457			
		G	Valve Stem, Pull Thru					40999-87			
		H	Valve Stem, Cap					41123-79			

Table 5. Front 25 mm Bearing Wheel Installation Kit (42400033)

Front 25 mm Bearing Wheel Installation Kit (42400033)		Item Quantity Used and Description				
Fitment	Wheel Size	A	D	E	G	H
2018 and later FXFB	16 x 3.0 in	2	1	0	1	1
2018 and later FXBB, and FXLR	19 x 2.5 in	2	0	1	1	1
Installation kits are designed to work with many different wheel styles and fitments. Contact a Harley-Davidson dealer to verify that the wheel and installation kits are both designed and approved for the motorcycle they are being installed on.		A	Bearing, Regular (2)		9276B	
		D	Axle Sleeve		43300483	
		E	Axle Sleeve		43300454	
		G	Valve Stem, Pull Thru		40999-87	
		H	Valve Stem, Cap		41123-79	