



INSTRUCTIONS





J06751

2020-08-24



CHARGE DOOR

Table 1. General Information

Kits	Suggested Tools	Skill Level ⁽¹⁾	Time
61301084, 61301193	Safety Glasses, Torque wrench, Flat-head screwdriver (small)	   	1 hour

(1) Tightening to torque value or other moderate tools and techniques required

KIT CONTENTS

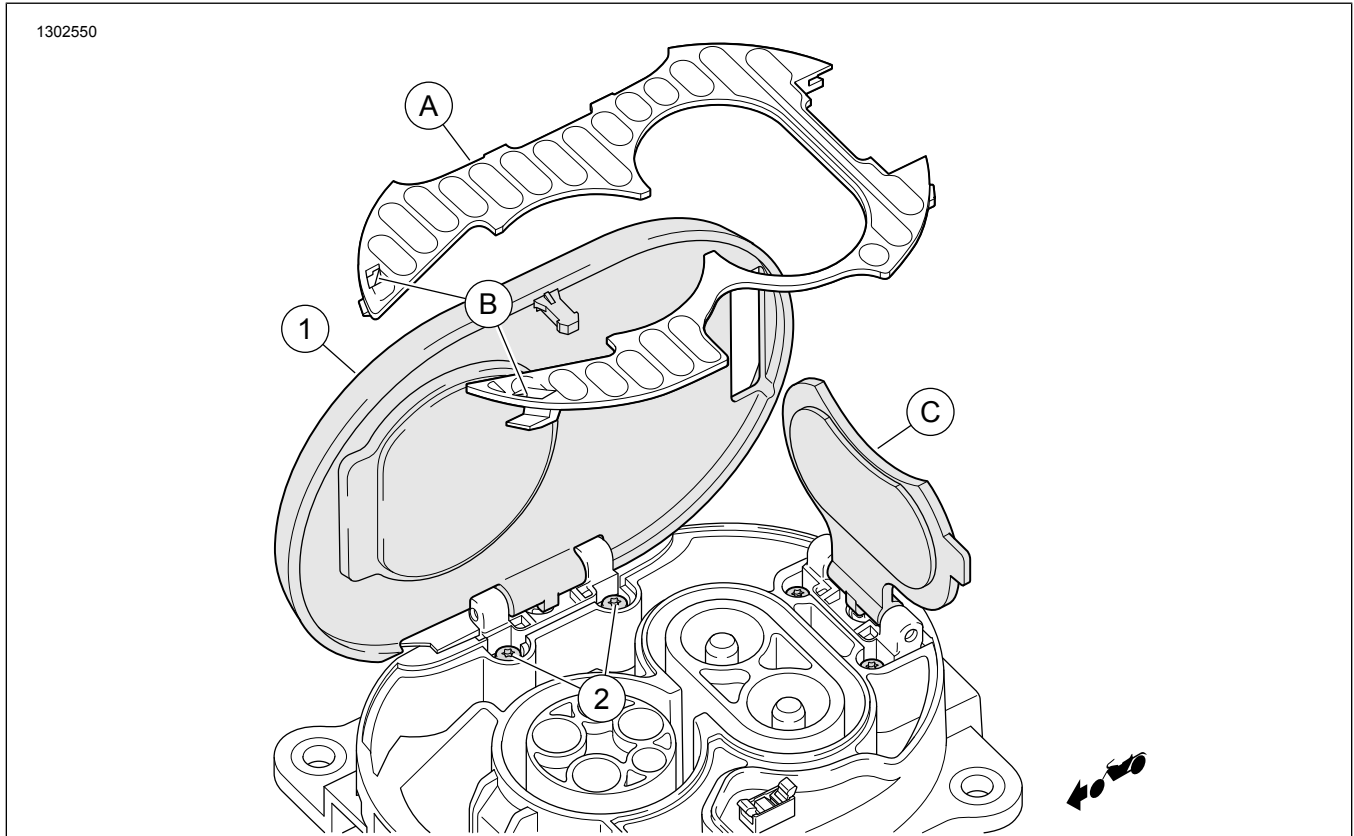

Figure 1. Kit Contents: Charge Door

Table 2. Kit Contents: Charge Door

<input checked="" type="checkbox"/>	Item	Qty	Description	Part No.	Notes
<input type="checkbox"/>	1		AC Door assembly	Not sold separately	
<input type="checkbox"/>			Medallion cover		
<input type="checkbox"/>	2	2	Mounting screw	10200882	1–1.25 N·m (9–11 in-lbs)
Item mentioned in text but not included in kit					
<input checked="" type="checkbox"/>	A		Faceplate		
<input checked="" type="checkbox"/>	B		Faceplate slots		
<input checked="" type="checkbox"/>	C		DC door assembly		

NOTE

Verify all contents are present in the kit before installing or removing items from vehicle.

GENERAL

Models

For model fitment information, please see the P&A Retail Catalog or the Parts and Accessories section of www.harley-davidson.com (English only).

Ensure you are using the most current version of the instruction sheet which is available at: www.harley-davidson.com/isheets

Contact Harley-Davidson Customer Support Center at 1-800-258-2464 (U.S. only) or 1-414-343-4056.

Installation Requirements

▲ WARNING

Rider and passenger safety depend upon the correct installation of this kit. If the procedure is not within your capabilities or you do not have the correct tools, have a Harley-Davidson dealer perform the installation. Improper installation of this kit could result in death or serious injury. (00308b)

REMOVE

1. See Figure 1. Open Original Equipment (OE) AC door assembly (1).
2. Remove faceplate (A).
 - a. Open DC door assembly (C).
 - b. Gently insert small flathead screwdriver into slots (B) to release clips.
 - c. Pull towards center of vehicle to remove.
3. Remove mounting screws (2).
4. Remove AC door assembly (1).

INSTALL

1. See Figure 1. Install **new** AC door assembly (1).
2. Secure with **new** mounting screws (2) from kit. Tighten. Torque: 1–1.25 N·m (9–11 **in-lbs**)
3. Install faceplate (A).
4. Close DC door assembly (C).
5. Close AC door assembly (1).