



INSTRUCTIONS

94100242

2022-09-26



TANK BAG PAN AMERICA

GENERAL INFORMATION

Table 1. General Information

Kits	Suggested Tools	Skill Level ⁽¹⁾
93300129	Safety Glasses	
<i>(1) Only simple tools and techniques required</i>		

KIT CONTENTS

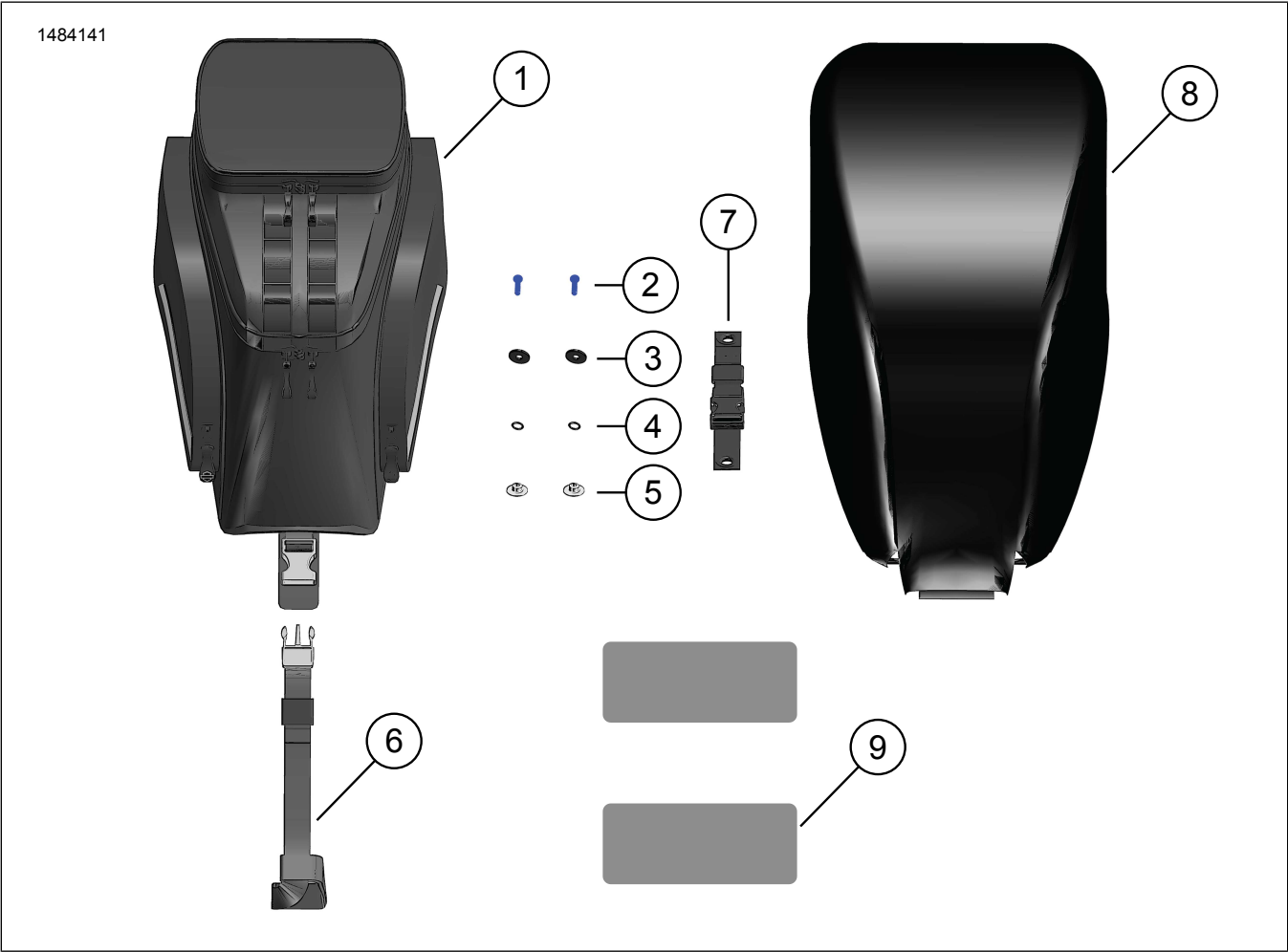

Figure 1. Kit Contents: Tank Bag Kit

Table 2. Kit Contents: Tank Bag Kit

<input checked="" type="checkbox"/>	Verify that all contents are present in the kit before installing or removing items from vehicle.				
	Item	Qty	Description	Part No.	Notes
<input type="checkbox"/>	1	1	Bag, tank	Not sold separately	
<input type="checkbox"/>	2	2	Screw	10201138	
<input type="checkbox"/>	3	2	Washer	10300236	
<input type="checkbox"/>	4	2	O-ring	11159	
<input type="checkbox"/>	5	2	Spacer	12400206	
<input type="checkbox"/>	6	1	Strap, front	93300154	
<input type="checkbox"/>	7	1	Strap set, tank, rear	93300146	
<input type="checkbox"/>	8	1	Rain cover	93300152	
<input type="checkbox"/>	9	2	Protective tape	11100303	

GENERAL

Models

For model fitment information, see the Parts and Accessories (P&A) Retail Catalog or the Parts and Accessories section of www.harley-davidson.com.

Verify that the most current version of the instruction sheet is used. It is available at: h-d.com/isheets

Contact Harley-Davidson Customer Support Center at 1-800-258-2464 (U.S. only) or 1-414-343-4056.

Installation Requirements

⚠ WARNING

Rider and passenger safety depend upon the correct installation of this kit. Use the appropriate service manual procedures. If the procedure is not within your capabilities or you do not have the correct tools, have a Harley-Davidson dealer perform the installation. Improper installation of this kit could result in death or serious injury. (00333b)

NOTE

This instruction sheet references service manual information. A service manual for the year and model motorcycle is required for this installation and is available from:

- A Harley-Davidson dealer.
- H-D Service Information Portal, a subscription-based access available for most 2001 and newer models. For more information see *Frequently ask questions about subscriptions*.

⚠ WARNING

See the Accessories and Cargo section in your owner's manual. Improper cargo loading or accessory installation can cause component failure and adversely affect stability, handling and performance, which could result in death or serious injury. (00021b)

- Do not exceed 5 lbs (2.3 kg) total weight contents and attachments.
- Verify that all straps are secured.
- Periodically recheck load.

⚠ WARNING

Do not exceed the motorcycle's Gross Vehicle Weight Rating (GVWR) or Gross Axle Weight Rating (GAWR). Exceeding these weight ratings can lead to component failure and adversely affect stability, handling and performance, which could result in death or serious injury. (00016f)

- GVWR is the total weight of the motorcycle, accessories, rider, passenger and cargo that can be safely carried.
- GAWR is the maximum amount of weight that can be safely carried on one axle.
- GVWR and GAWR are shown on the information plate, located on the frame downtube.

PREPARE

1. Remove seat. See service manual.

REMOVE

1. See Figure 2. Remove Original Equipment (OE) screws (1) from tank console (2). Discard.

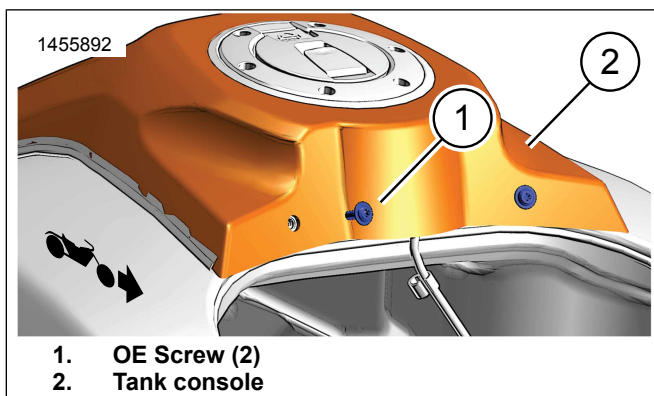

Figure 2. Tank Console

INSTALL

1. See Figure 3. Install front mounting straps to tank console.
 - a. See Figure 3. Install spacer (1), mounting strap (2), O-ring (3), washer (4) and screw (5).

NOTE

Install spacer (1) with grooved side facing toward tank.

- b. Secure screw (5). Tighten.
Torque: 3.9–4.8 N·m (35–42 in-lbs)
2. See Figure 4. Install rear strap (1) under tank (2).
 - a. Thread rear strap between rear tank mount and tank.
 - b. Pull buckle through loop at other end of strap.
 - c. Eliminate slack in strap system.
3. See Figure 5. Position tank bag on tank.
4. See Figure 7. Secure front mounting straps to tank bag by connecting quick release buckles.
5. See Figure 7. Secure rear mounting strap to tank bag by connecting quick release buckle.
6. Pull straps snug to eliminate slack in strap system.
7. Install protective tape to fuel tank.
 - a. See Figure 6. Check for widest point (1) of tank bag.
 - b. Test fit protective tape (1) where tank bag touches the fuel tank. Note location.
 - c. Remove tank bag (3).
 - d. Clean area with 50/50 alcohol and water mixture.
 - e. Wipe dry with clean cloth.
 - f. Peel backing from protective tapes (1) and install in noted location..
 - g. Install tank bag (3).

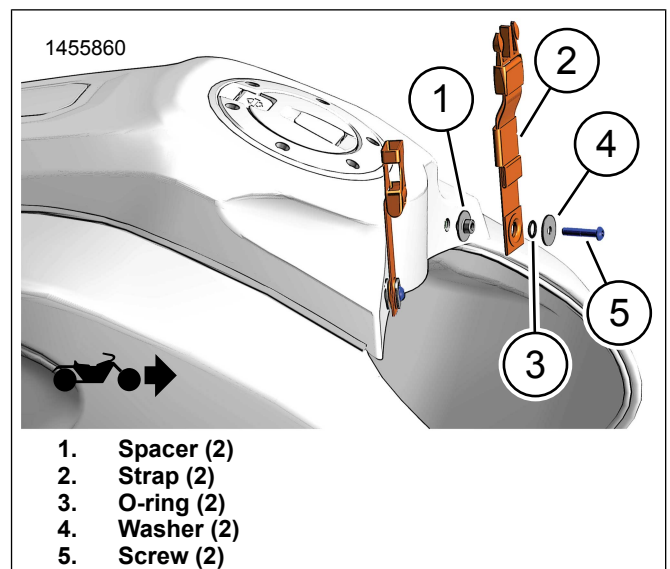

Figure 3. Front Strap Install

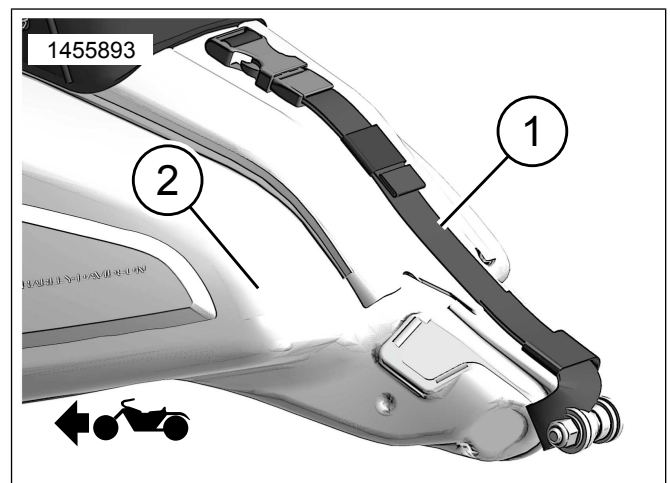

Figure 4. Rear Strap Install



Figure 5. Tank Bag Installed

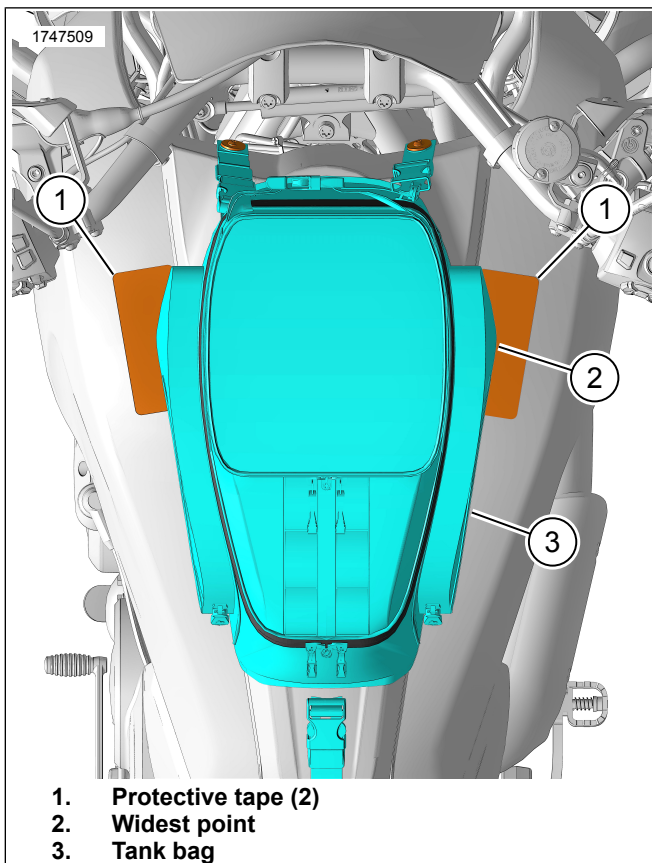

Figure 6. Protective Tape

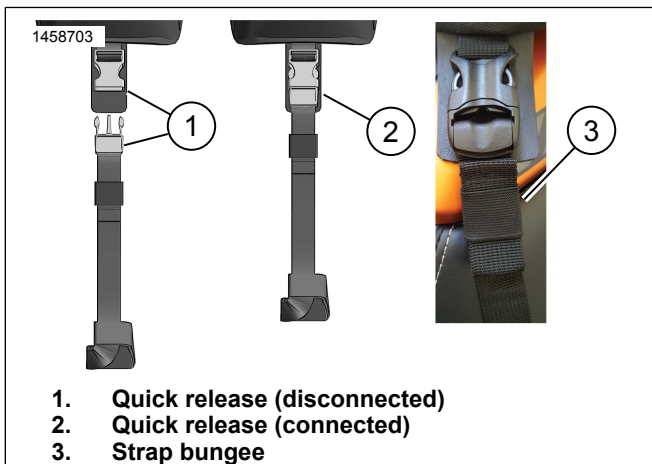

Figure 7. Quick Release Buckle

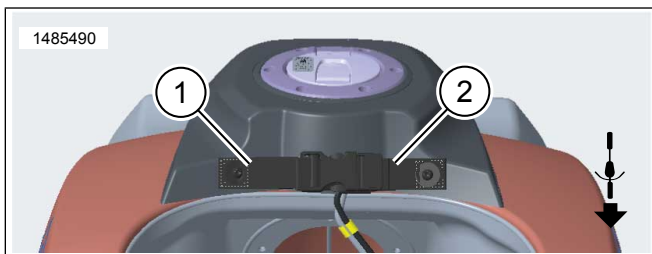

Figure 8. Front Straps in Stowed Position

COMPLETE

NOTE

Zipper pulls have loops so that a small lock can be used for added security.

1. Install seat. After installing seat, pull up on seat to verify that it is secure. See service manual.
2. Pull straps tight to secure bag.
3. Check that bag is securely fastened to vehicle.
4. See Figure 7. Secure any excess strap length using strap bungee (3).
5. See Figure 8. Clip front two straps (1,2), attached to tank console, together when tank bag is removed from vehicle.
 - a. See Figure 7. Secure excess strap length using strap bungee (3).

RAIN COVER

1. Pull rain cover over entire bag.
2. Pull draw string at bottom of cover to tighten.
3. Secure with barrel lock
4. Make sure the rain cover is tucked completely under tank bag.

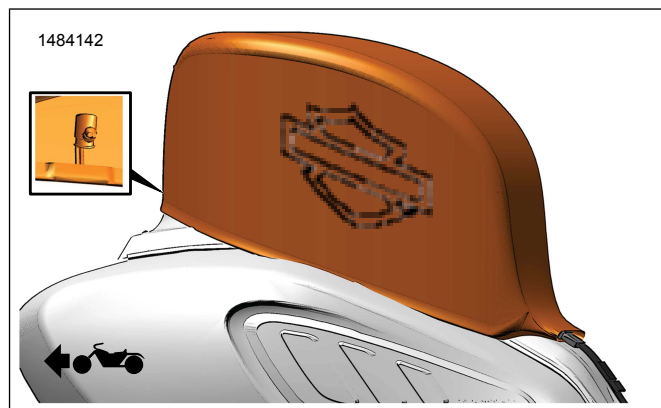

Figure 9. Rain Cover Installed

MAINTENANCE

1. Use a lint-free cloth to wipe off any dust or dirt.
2. Thoroughly clean outer surface with warm water and a mild detergent.
3. Allow material to dry naturally and completely before use or storage.
4. Do not use washing machine or dryer.
5. Do not use artificial means to dry material quickly.
6. Contains one or more of the following materials: Polyester, Polypropylene, POM, EPDM Rubber, Vinyl.