



INSTRUCTIONS

94100093

2023-09-22



SIDE CASE MOUNTING KIT

GENERAL INFORMATION

Table 1. General Information

Kits	Suggested Tools	Skill Level ⁽¹⁾
90202087A	Safety Glasses, Torque Wrench	
<i>(1) Tightening to torque value or other moderate tools and techniques required</i>		

KIT CONTENTS

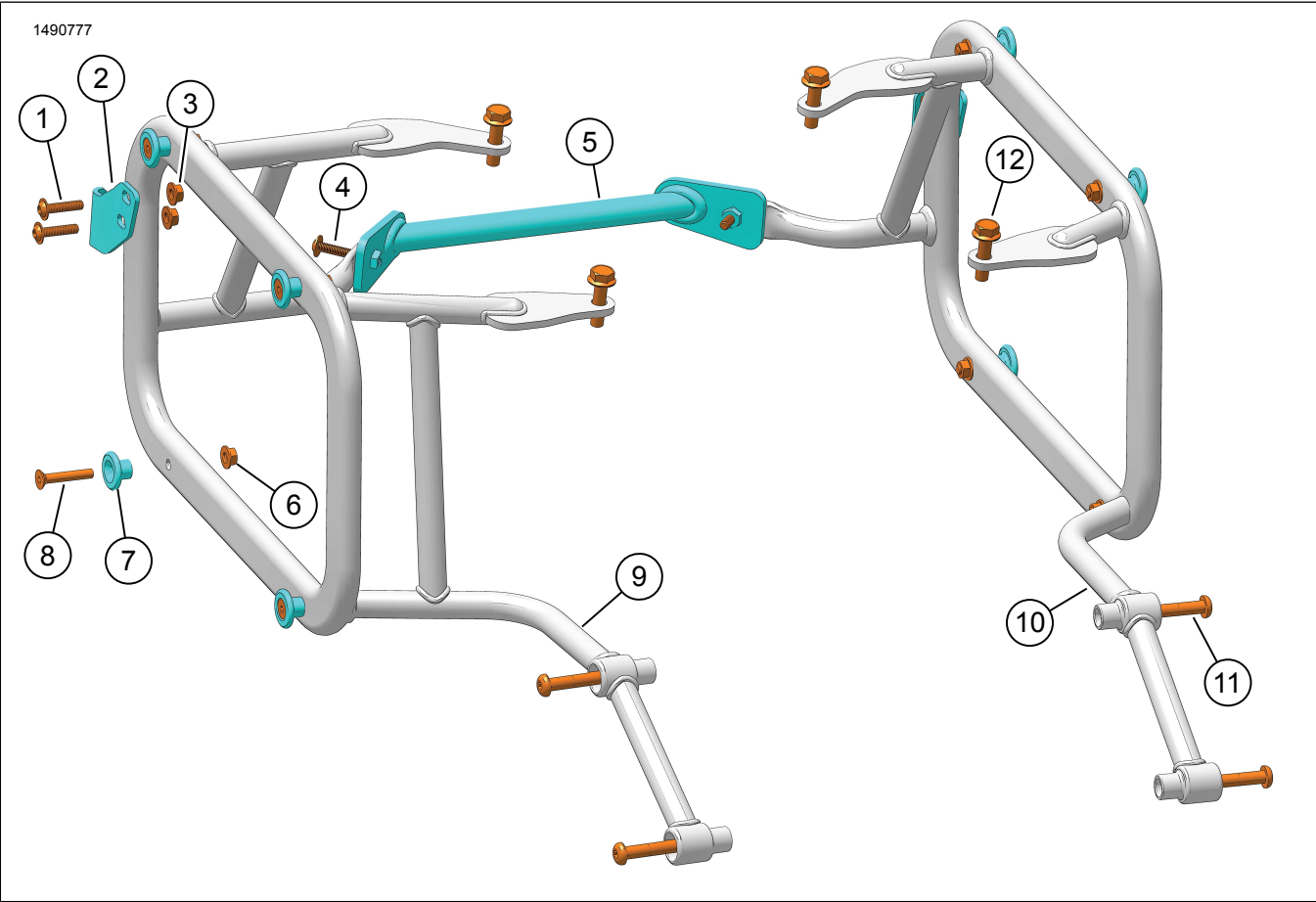

Figure 1. Kit Contents: Side Case Mounting

Table 2. Kit Contents: Side Case Mounting

<input checked="" type="checkbox"/>	Verify that all contents are present in the kit before installing or removing items from vehicle.				
	Item	Qty	Description	Part No.	Notes
<input type="checkbox"/>	1	1	Flange button head screw	10201135	
<input type="checkbox"/>	2	1	Latch bracket, right	90202100	
			Latch bracket, left	90202101	
<input type="checkbox"/>	3	4	Locknut	10100152	
<input type="checkbox"/>	4	2	Flange button head screw	10201135	
<input type="checkbox"/>	5	1	Support link	90202092A	
<input type="checkbox"/>	6	8	Locknut	10100152	
<input type="checkbox"/>	7	8	Docking point	90202341	
<input type="checkbox"/>	8	8	Flat head screw	10201134	
<input type="checkbox"/>	9	1	Right saddlebag support	90202090A	
<input type="checkbox"/>	10	1	Left saddlebag support	90202091A	
<input type="checkbox"/>	11	4	Screw, TORX™	10201300	
<input type="checkbox"/>	12	4	Screw, hex flange	10201294	

GENERAL

Models

For model fitment information, see the Parts and Accessories (P&A) Retail Catalog or the Parts and Accessories section of www.harley-davidson.com.

Verify that the most current version of the instruction sheet is used. It is available at: h-d.com/isheets

Contact Harley-Davidson Customer Support Center at 1-800-258-2464 (U.S. only) or 1-414-343-4056.

Installation Requirements

⚠ WARNING

Rider and passenger safety depend upon the correct installation of this kit. Use the appropriate service manual procedures. If the procedure is not within your capabilities or you do not have the correct tools, have a Harley-Davidson dealer perform the installation. Improper installation of this kit could result in death or serious injury. (00333b)

NOTE

This instruction sheet references service manual information. A service manual for the year and model motorcycle is required for this installation and is available from:

- A Harley-Davidson dealer.
- H-D Service Information Portal, a subscription-based access available for most 2001 and newer models. For more information see *Frequently ask questions about subscriptions*.

PREPARE

1. See Figure 2. Remove seat pillion (1) and seat (2). See service manual.
2. Remove screws (3). Support passenger footrests as needed.

INSTALL

1. See Figure 3. Position passenger footrest and install left saddlebag support assembly (2).
2. Install screws (1 and 3). Do not tighten completely.
3. Repeat procedure for right side.
4. See Figure 4. Install support link (2).
5. Install screws (4). Do not tighten completely.
6. Make sure all three pieces are positioned and installed properly.
7. See Figure 3. Tighten screws.
 - a. Hex flange screw (1):
Torque: 28.5–32.5 N·m (252–288 **in-lbs**)
 - b. TORX Screw (3):
Torque: 21–25 N·m (186–221 **in-lbs**)

8. See Figure 4. Tighten button head flange screw (4).
Torque: 8–10 N·m (71–89 in-lbs)

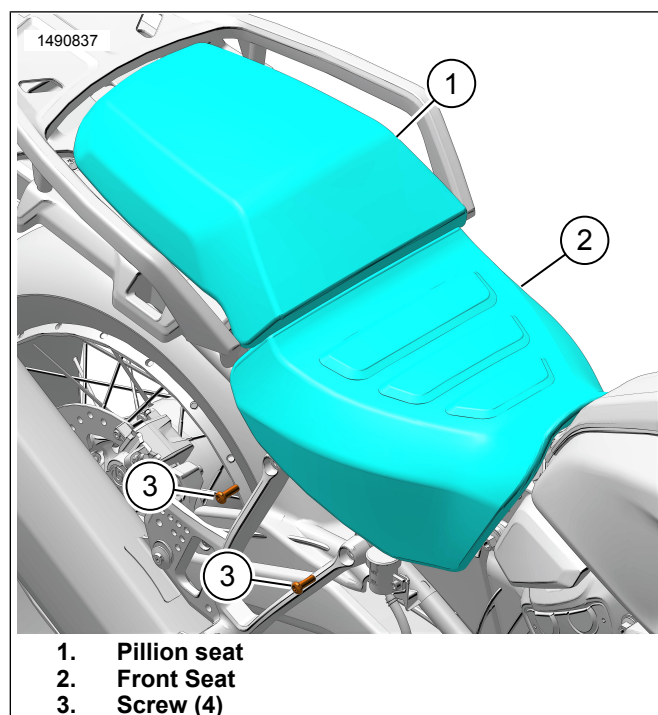

Figure 2. Seat

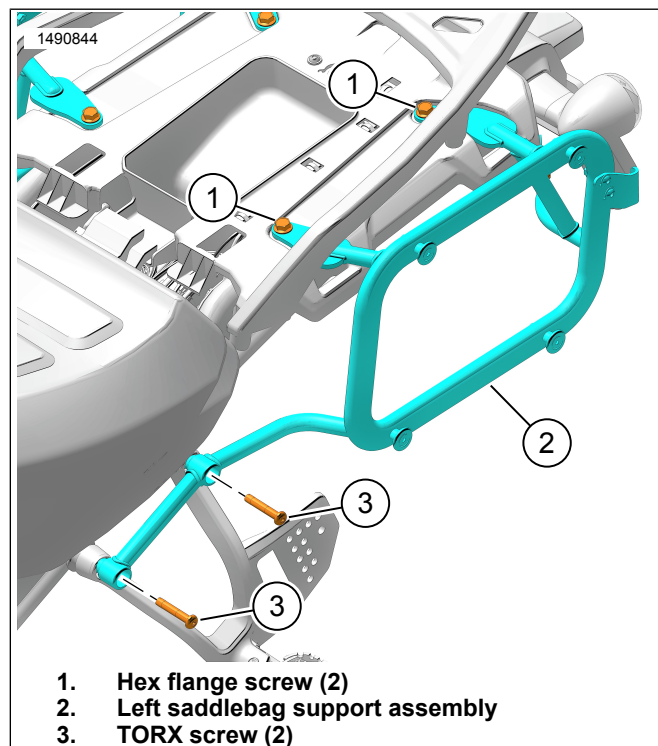

Figure 3. Saddlebag Support Assembly

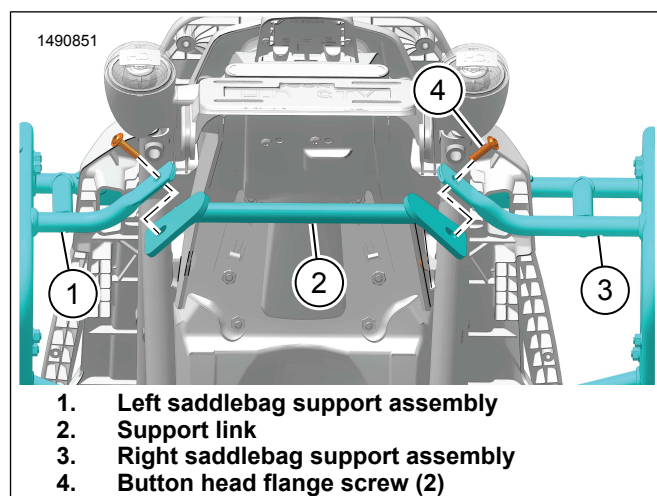

Figure 4. Support Link

LATCH AND DOCKING POINT

NOTE

- Docking points and latch brackets do not come installed.
- If using soft luggage, do not install docking points or latch brackets.
- If using aluminum luggage, install docking points and latch brackets.

Latch

1. See Figure 1. Position latch bracket (2) to saddlebag support assembly (10, 11).
 - a. Make sure latch bracket (2) is installed for the appropriate side.
2. Install screws (1) and nuts (3). Tighten.
Torque: 9.5 N·m (7 ft-lbs)

Docking Point

1. See Figure 1. Position docking point (8) to saddlebag support assembly (10, 11).
2. Install screw (9) and nut (7). Tighten.
Torque: 9.5 N·m (7 ft-lbs)
3. Repeat steps until all docking points have been installed.

COMPLETE

1. See Figure 2. Install seat (2) and seat pillion (1). See service manual.