



INSTRUCTIONS

94100203

2021-03-08



17 INCH LACED REAR WHEEL KIT

GENERAL

▲ WARNING

Install only wheels and installation kits approved for your model motorcycle. Contact a Harley-Davidson dealer to verify fitment. Mismatching wheels and installation kits or installing wheels not approved for your model can cause loss of control, which could result in death or serious injury. (00610c)

Kit Numbers

40900814

Models

For model fitment information, see the P&A Retail Catalog or the Parts and Accessories section of www.harley-davidson.com (English only).

Kit Contents

See Figure 1 and Table 2.

Installation Requirements

NOTE

This instruction sheet references service manual information. A service manual for your model motorcycle is required for this installation and is available from a Harley-Davidson dealer.

▲ WARNING

Rider and passenger safety depend upon the correct installation of this kit. Use the appropriate service manual procedures. If the procedure is not within your capabilities or you do not have the correct tools, have a Harley-Davidson dealer perform the installation. Improper installation of this kit could result in death or serious injury. (00333b)

Proper installation of this kit requires the separate purchase of the following parts which are available at a Harley-Davidson dealer:

- Recommend tires. Refer to Table 2.
- Wheel Installation Kit. Refer to Table 4.
- Brake Disc Hardware. Refer to Table 1.
- WHEEL BEARING INSTALLER/REMOVER (PART NUMBER: HD-44060D)

Table 1. Rear Disc Hardware

Brake Disc	Hardware
Standard (OE)	Stock disc screws (Qty 5) (Part No.41500020)

Table 2. Specified Tire Combination

Kit Installation	Specified Tire	Front Tire Part No.
2021 and later Pan America	Michelin Scorcher	43200042
	Michelin Anakee Wild	43200050

PREPARE

1. Remove existing rear wheel assembly. See service manual.
 - a. Retain axle, axle nut, brake disc, and wheel spacers for kit installation

INSTALLATION

NOTE

If vehicle is not equipped with Tire Pressure Monitoring System (TPMS), install valve stem (40999-87) included in the installation kit.

If equipped with TPMS, reuse valve stem.

Cotter pin or spring clip for the axle nut must be replaced. Both are available for purchase from a Harley-Davidson dealer.

1. See Figure 1. Install valve stem assembly on wheel (1). See service manual.

NOTICE

Do not re-use brake disc/rotor screws. Re-using these screws can result in torque loss and damage to brake components. (00319c)

2. Assemble wheel installation kit components, stock brake disc, and sprocket to wheel using the appropriate service parts table. See service manual.
 - a. Install ABS bearing first. Red side against the wheel.
 - b. ABS bearing is installed on the brake rotor side.
 - c. Install regular bearing lettered side away from wheel.

d. Regular bearing is installed on compensator side.

COMPLETE

3. When installing the tire, ensure protective covers are installed on the tire mounting machine to avoid paint chipping.

1. Install rear wheel (1), stock axle, and stock spacers to motorcycle. See service manual.

SERVICE PARTS

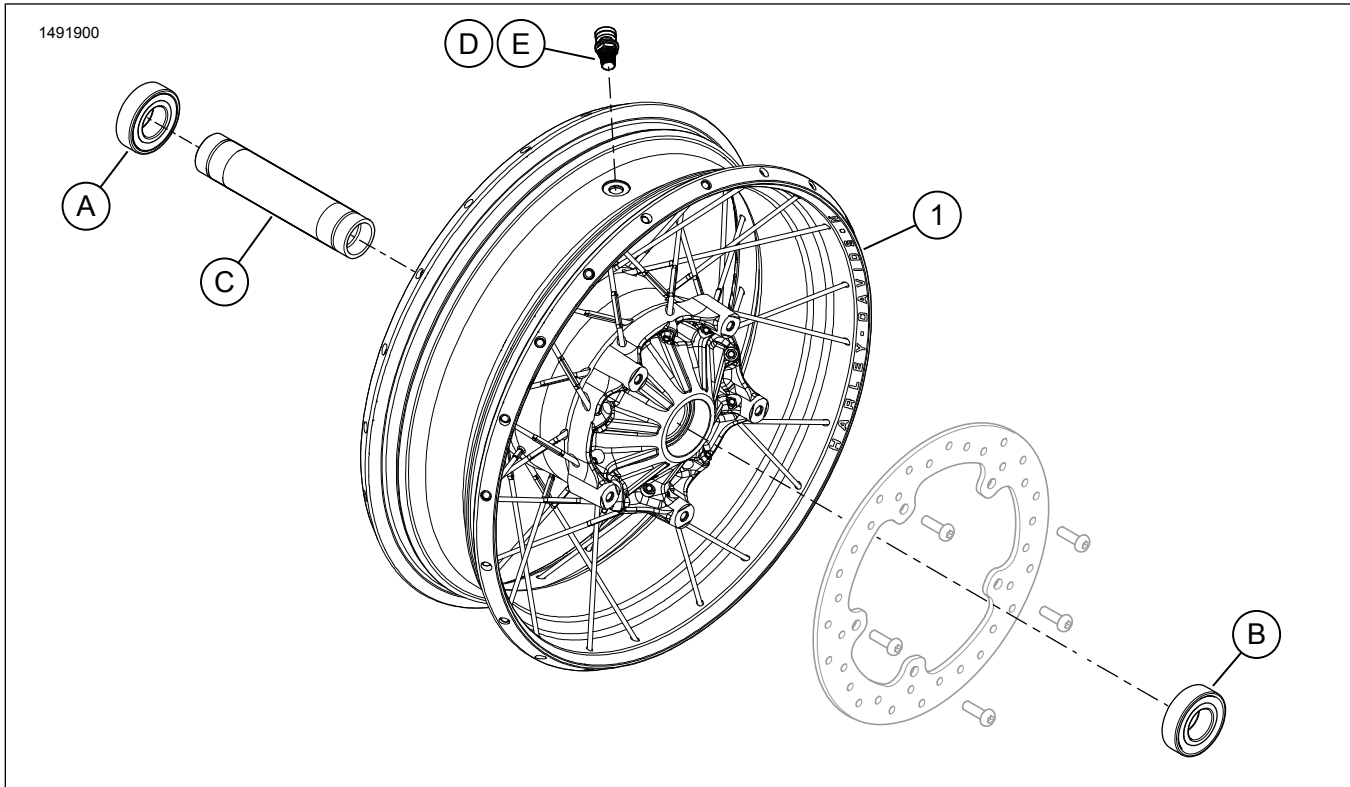

Figure 1. Service Parts: Rear Wheels (16-inch Shown)

Table 3. Service Parts and Wheel Kit Contents

Kit	Item	Description (Quantity)	Part Number
40900814	1	Wheel	Not Sold Separately

Table 4. Rear 25 mm Bearing ABS Wheel Installation Kit (42400039)

Rear 25mm Bearing ABS Wheel Installation Kit (42400039)		Item Quantity Used and Description				
Fitment	Wheel Size	A	B	C	D	E
2021 and later Pan America	17 x 4.5 inch	1	1	0	1	1
Installation kits are designed to work with many different wheel styles and fitments. Contact a Harley-Davidson dealer to verify that the wheel and installation kits are both designed and approved for the motorcycle they are being installed on.		A	Bearing, Regular	9276B		
		B	Bearing, ABS	9252A		
		C	Axle Sleeve	40900707		
		D	Valve Stem, Pull Thru	40999-87		
		E	Valve Stem, Cap	41123-79		