



INSTRUCTIONS

94100012

2022-09-23



SCREAMIN' EAGLE REMOTE RESERVOIR REAR SHOCKS (OHLINS®)

GENERAL INFORMATION

Table 1. General Information

Kits	Suggested Tools	Skill Level ⁽¹⁾
54000193	Safety Glasses, Torque Wrench	
<i>(1) Special tools or techniques required for installation</i>		

KIT CONTENTS

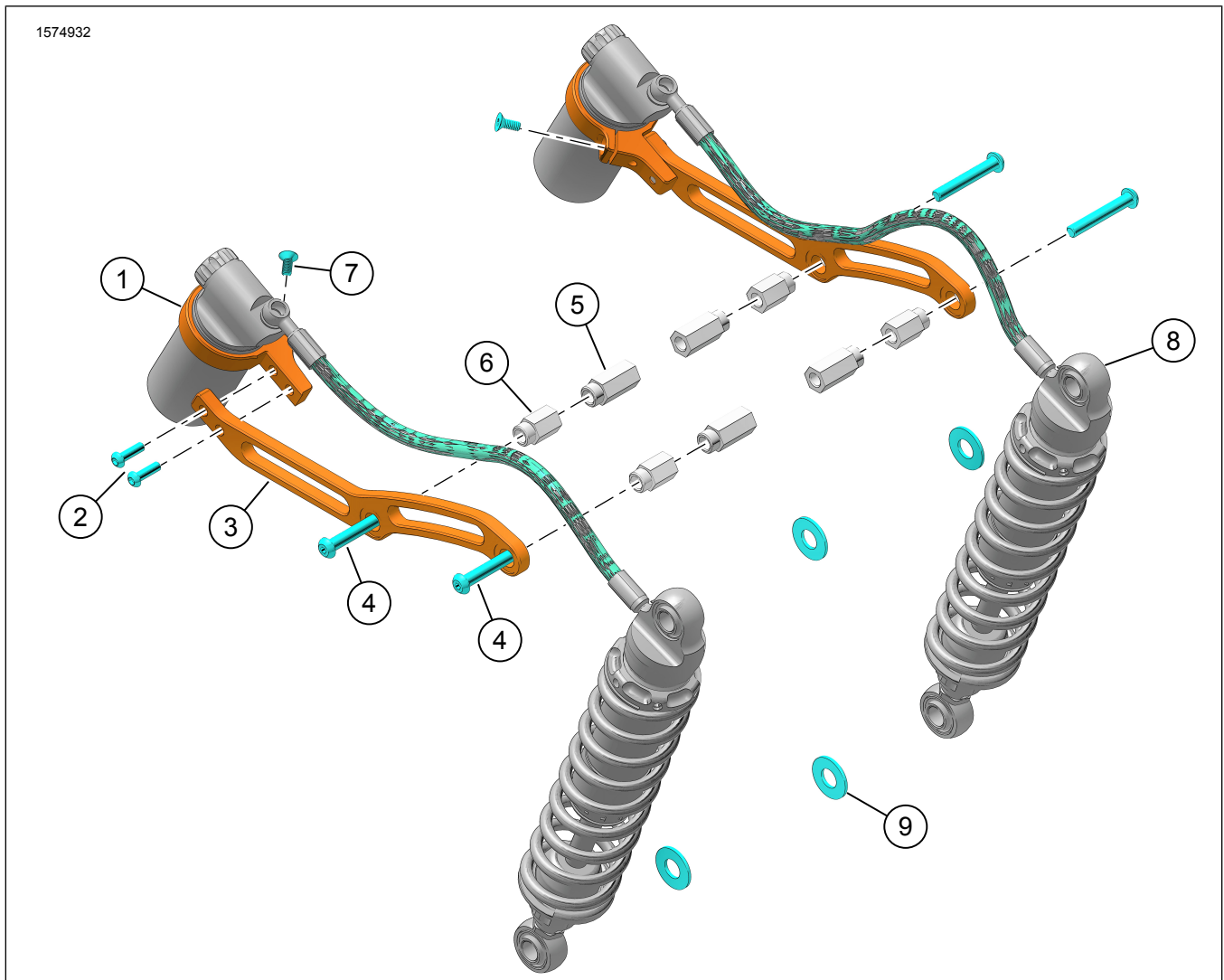

Figure 1. Kit Contents: Screamin' Eagle Remote Reservoir Rear Shocks (Ohlins)

Table 2. Kit Contents: Screamin' Eagle Remote Reservoir Rear Shocks (Ohlins)

<input checked="" type="checkbox"/>	Verify that all contents are present in the kit before installing or removing items from vehicle.				
Item	Qty	Description	Part No.	Notes	
<input type="checkbox"/>	1	2	Clamp bracket	Not sold separately	Included in Shock Bracket service kit (Part No. 54000296)
<input type="checkbox"/>	2	4	Screw, short head	3832M	
<input type="checkbox"/>	3	2	Mounting bracket	Not sold separately	Included in Shock Bracket service kit (Part No. 54000296)
<input type="checkbox"/>	4	4	Screw, long	10200850	
<input type="checkbox"/>	5	4	Spacer, long	54000298	
<input type="checkbox"/>	6	4	Spacer, short	54000297	
<input type="checkbox"/>	7	2	Screw, flat head	10201180	
<input type="checkbox"/>	8	2	Shock with reservoir	54000194	
<input type="checkbox"/>	9	4	Washer (4)	6590HW	

GENERAL

Models

For model fitment information, see the Parts and Accessories (P&A) Retail Catalog or the Parts and Accessories section of www.harley-davidson.com.

Verify that the most current version of the instruction sheet is used. It is available at: h-d.com/isheets

Contact Harley-Davidson Customer Support Center at 1-800-258-2464 (U.S. only) or 1-414-343-4056.

Installation Requirements

▲ WARNING

Rider and passenger safety depend upon the correct installation of this kit. Use the appropriate service manual procedures. If the procedure is not within your capabilities or you do not have the correct tools, have a Harley-Davidson dealer perform the installation. Improper installation of this kit could result in death or serious injury. (00333b)

NOTE

This instruction sheet references service manual information. A service manual for the year and model motorcycle is required for this installation and is available from:

- A Harley-Davidson dealer.
- H-D Service Information Portal, a subscription-based access available for most 2001 and newer models. For more information see *Frequently ask questions about subscriptions*.

PREPARE

1. Set vehicle upright. See service manual.
 - a. Secure with tie-downs.
2. Raise rear of vehicle. See service manual.

3. Remove saddlebags. See service manual.

REMOVE

1. Remove OE rear shocks absorbers. See service manual.
 - a. Save screws and washers for later use.
2. See Figure 2. Remove OE screws (2) from fender strut (1).

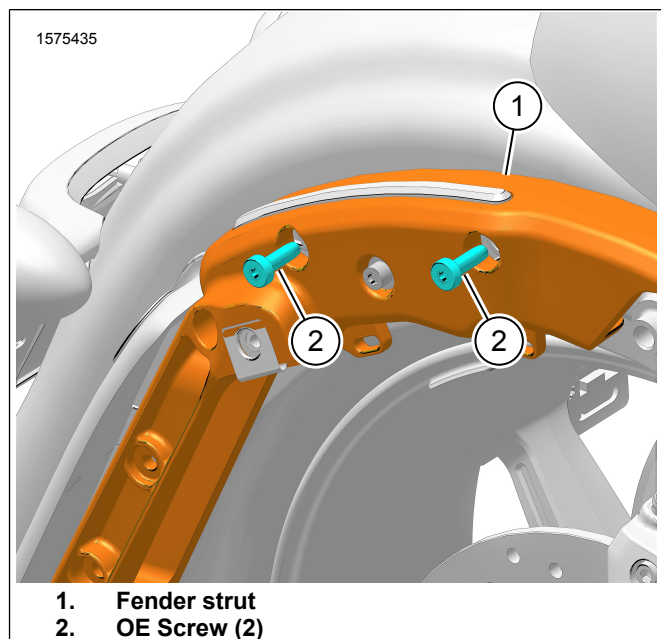

Figure 2. Fender Strut Screws

INSTALL

1. See Figure 3. Install appropriate spacers (3) into mounting bracket (4). Tighten.

Torque: 11–11 N·m (8–8 ft-lbs) *Mounting bracket spacer*

NOTE

See Figure 4. For spacer selection, reference the accessory that is used on the vehicle.

- a. **Short Spacer:** Use with Tour Pak (1) or saddlebag support insert (2). Other accessory inserts can be used like the 4-Point Docking Hardware Kit.
 - b. **Long Spacer:** Use with fender strut insert (3).
 - c. Apply thread locker to mounting spacers (3).
LOCTITE 262 HIGH STRENGTH THREADLOCKER AND SEALANT (RED) (94759-99)
2. See Figure 3. Apply thread locker to screw (5).
Consumable: LOCTITE 262 HIGH STRENGTH THREADLOCKER AND SEALANT (RED) (94759-99)
 3. Install mounting bracket (4).
 - a. Install screws (5). Tighten.
Torque: 27 N·m (20 ft-lbs)
 4. Install screw (2). Do not tighten completely.
 5. See Figure 5. Install shock assembly.

NOTE

Reuse original OE mounting hardware. See service manual or reference parts catalog for model year of vehicle.

- a. Install OE mounting hardware (4).
 - b. Install screw (4) to shock assembly (5).
 - c. Install inner washer (3).
 - d. Install screw (4) to frame. Do not tighten completely.
 - e. Repeat procedure for other screw.
 - f. Tighten screws (4). See service manual.
6. Install reservoir (1) in clamp bracket.
 - a. Adjust as needed for proper hose (2) routing.
 7. See Figure 3. Install clamp bracket (1) to mounting bracket (4).
 - a. Install screws (6). Tighten.
Torque: 7 N·m (62 in-lbs)
 8. See Figure 6. Tighten screw (2).
Torque: 3 N·m (27 in-lbs)
 9. See Figure 7. Secure hose with cable straps.

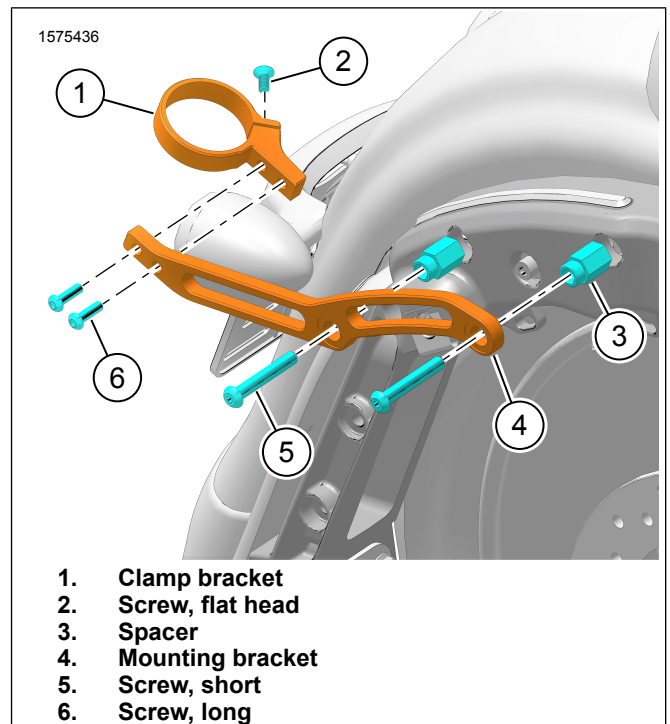

Figure 3. Mounting Brackets

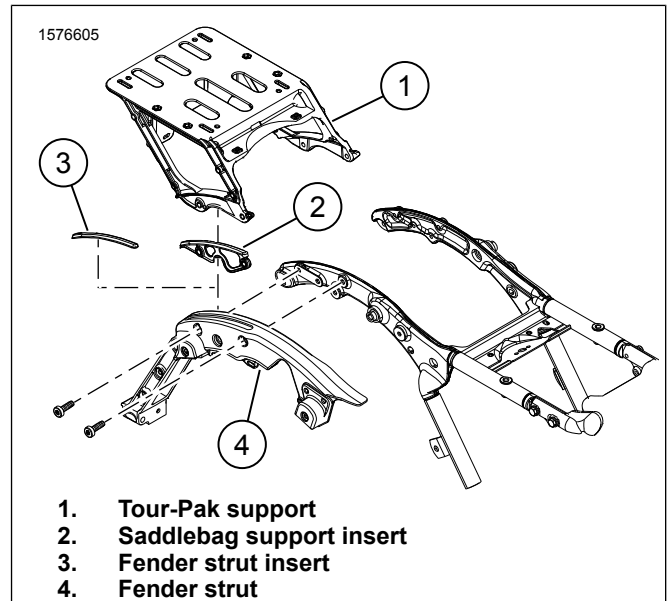

Figure 4. Spacer Accessories Selection

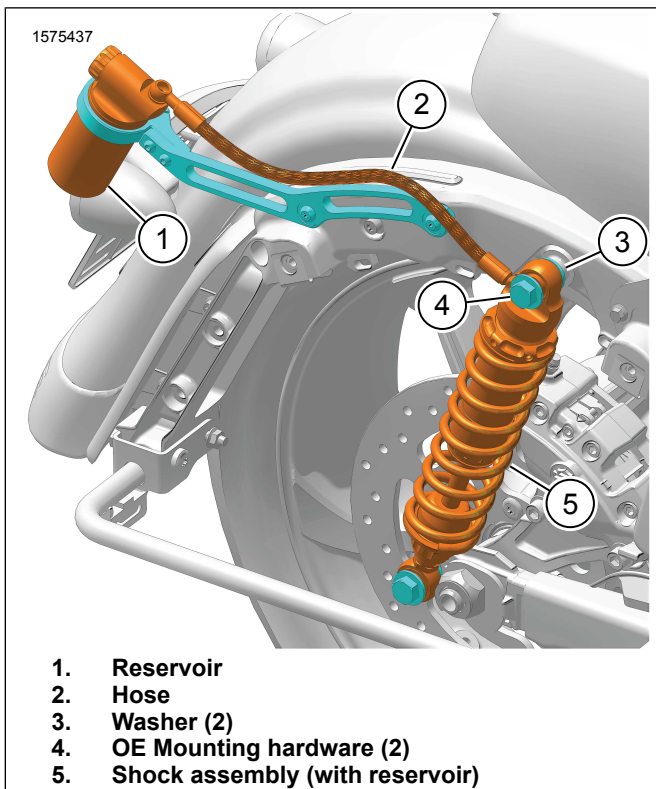

Figure 5. Shock Assembly

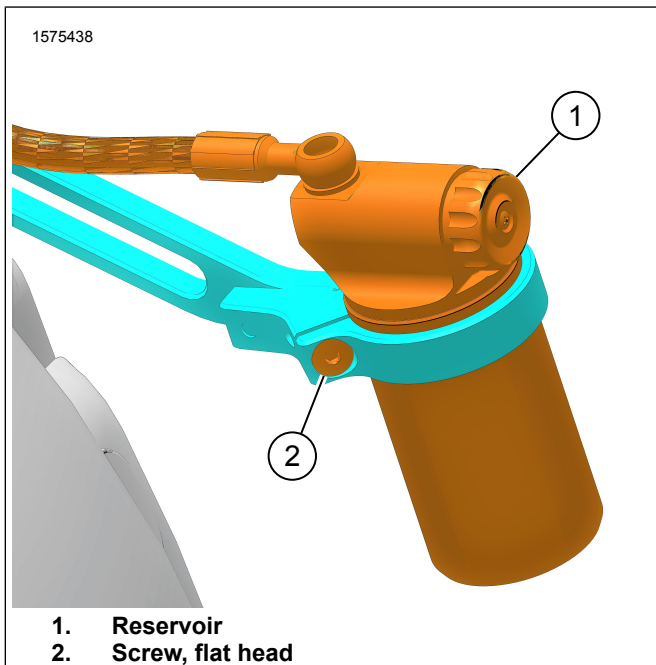

Figure 6. Clamp Bracket Screw

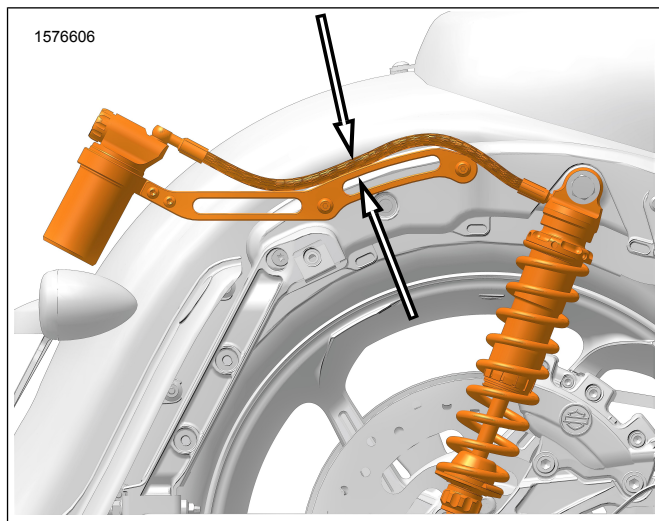

Figure 7. Cable Strap Placement

COMPLETE

NOTE

Ohlins shocks are pre-set at Harley-Davidson's original equipment length.

Adjusting length could result in tire and fender contact or axle and muffler contact at travel limits on some vehicles.

1. Reference Ohlins owner's manual for: Setting up, adjustments, spring preload, compression damping, rebound damping adjust length and general setup.
2. Install saddlebags. See service manual.

Table 3.

Rear Shocks	Compression ¹	Rebound ¹
Without Tourpak		
Solo rider	15	13
Solo rider with luggage	13	11
Solo rider with passenger	8	5
Solo rider with luggage and passenger	7	4
With Tourpak		
Solo rider	13	10
Solo rider with luggage	8	5
Solo rider with passenger	6	3
Solo rider with luggage and passenger	5	2

¹ Damping adjuster settings are done by tightening adjuster clockwise until it stops and then turning the adjuster counter clockwise to the first click (this is position 0), then count clicks while turning adjuster counter-clockwise to the desired setting.

Table 4.

Suspension Preload Table																							
		Without Tourpak - Additional Weight of Passenger, Cargo and Accessories																					
LB		0	10	20	30	40	50	60	70	80	90	100	110	120	130	140	150	160	170	180	190	200	210
KG		0	5	9	14	18	23	27	32	36	41	45	50	54	59	64	68	73	77	82	87	92	97
		With Tourpak - Additional Weight of Passenger, Cargo and Accessories																					
LB		0	10	20	30	40	50	60	70	80	90	100	110	120	130	140	150	160	170	180	190	200	210
KG		0	5	9	14	18	23	27	32	36	41	45	50	54	59	64	68	73	77	82	87	92	97
RIDER WEIGHT		Measurement Reading																					
		Top of Spring Preload Adjuster (2) to Bottom of Shock Upper Body (1)																					
LB		Measurement Reading (3) in Millimeters (mm)																					
KG																							
150	68	6	7	8	9	10	11	12	13	14	15	16	17	18	19	20	21	22	23	24	25	26	27
160	73	6	7	8	9	10	11	12	13	14	15	16	17	18	19	20	21	22	23	24	25	26	27
170	77	7	8	9	10	11	12	13	14	15	16	17	18	19	20	21	22	23	24	25	26	27	28
180	82	8	9	10	11	12	13	14	15	16	17	18	19	20	21	22	23	24	25	26	27	28	29
190	86	9	10	11	12	13	14	15	16	17	18	19	20	21	22	23	24	25	26	27	28	29	30
200	91	9	10	11	12	13	14	15	16	17	18	19	20	21	22	23	24	25	26	27	28	29	30
210	95	10	11	12	13	14	15	16	17	18	19	20	21	22	23	24	25	26	27	28	29	30	31
220	100	11	12	13	14	15	16	17	18	19	20	21	22	23	24	25	26	27	28	29	30	31	32
230	104	12	13	14	15	16	17	18	19	20	21	22	23	24	25	26	27	28	29	30	31	32	Max
240	109	12	13	14	15	16	17	18	19	20	21	22	23	24	25	26	27	28	29	30	31	32	Max
250	113	13	14	15	16	17	18	19	20	21	22	23	24	25	26	27	28	29	30	31	32	Max	
260	118	14	15	16	17	18	19	20	21	22	23	24	25	26	27	28	29	30	31	32	Max		
270	122	15	16	17	18	19	20	21	22	23	24	25	26	27	28	29	30	31	32	Max			

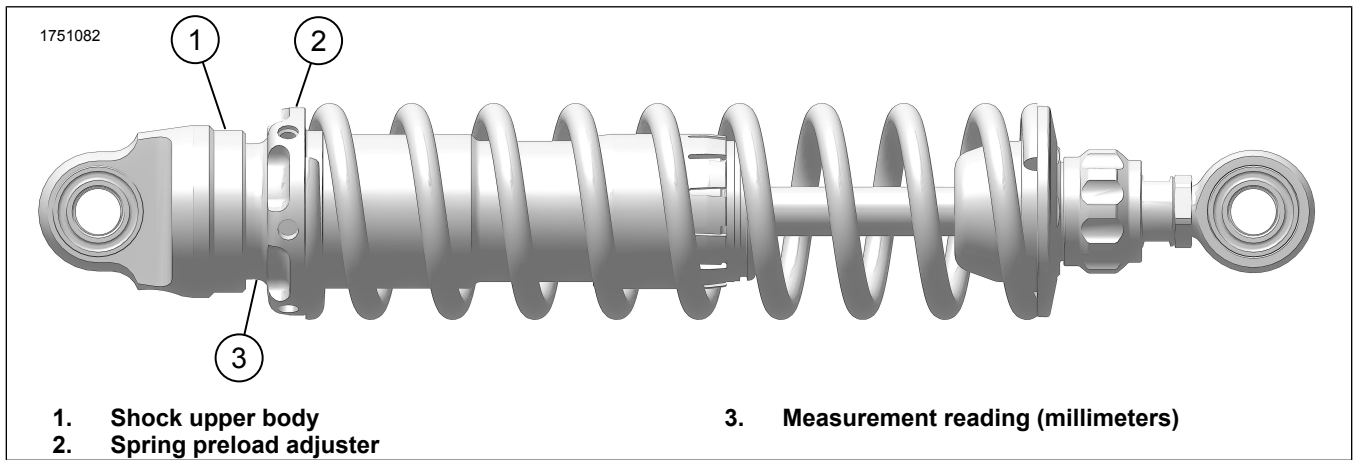

Figure 8. Measurement Reading