



INSTRUCTIONS

J06809

2022-01-26



DRAG SEAT

GENERAL INFORMATION

Table 1. General Information

Kits	Suggested Tools	Skill Level ⁽¹⁾
52000452, 52000461	Safety Glasses, Torque Wrench	

(1) Tightening to torque value or other moderate tools and techniques required

KIT CONTENTS

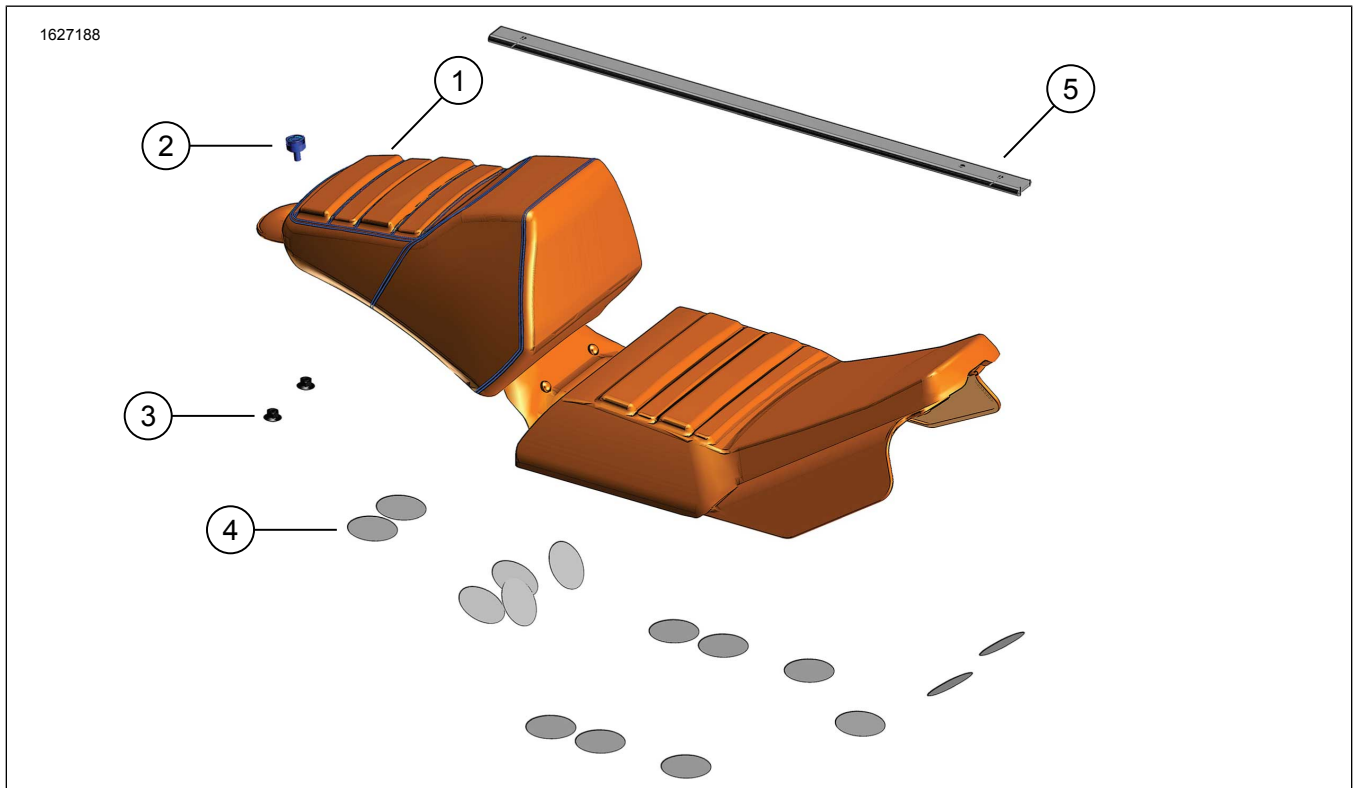

Figure 1. Kit Contents: Seat

Table 2. Kit Contents: Seat Kit

Verify that all contents are present in the kit before installing or removing items from vehicle.					
<input checked="" type="checkbox"/>	Item	Qty	Description	Part No.	Notes
<input type="checkbox"/>	1	1	Seat assembly, clear	52000453	
<input type="checkbox"/>			Seat assembly, black	52000460	
<input type="checkbox"/>	2	1	Screw	10500093	
<input type="checkbox"/>	3	2	Nut	7499	
<input type="checkbox"/>	4	15	Tape, protective	11100176	
<input type="checkbox"/>	5	1	Grab strap	52400287	



GENERAL

Models

For model fitment information, see the Parts and Accessories (P&A) Retail Catalog or the Parts and Accessories section of www.harley-davidson.com.

Verify that the most current version of the instruction sheet is used. It is available at: h-d.com/isheets

Contact Harley-Davidson Customer Support Center at 1-800-258-2464 (U.S. only) or 1-414-343-4056.

Installation Requirements

▲ WARNING

Rider and passenger safety depend upon the correct installation of this kit. Use the appropriate service manual procedures. If the procedure is not within your capabilities or you do not have the correct tools, have a Harley-Davidson dealer perform the installation. Improper installation of this kit could result in death or serious injury. (00333b)

NOTE

This instruction sheet references service manual information. A service manual for the year and model motorcycle is required for this installation and is available from:

- A Harley-Davidson dealer.
- H-D Service Information Portal, a subscription-based access available for most 2001 and newer models. For more information see *Frequently ask questions about subscriptions*.

REMOVE

1. Remove seat. See service manual.

INSTALL

NOTE

Reserve Original Equipment (OE) grab strap hardware for later use.

1. Install pillion in desired position.
2. See Figure 2. Tighten pillion screws (1).
Torque: 5.4–8.1 N·m (4–6 ft-lbs)
3. See Figure 1. Test fit seat (1) on vehicle.
4. **Models with separate passenger and rider seats:** See Figure 1. Remove fender nuts and replace with nuts (3).
5. Mark locations where bumpers sits on vehicle surface.
6. Apply protective tape (3) beneath each rubber bumper, including fuel tank.
7. See Figure 3. Apply protective tape (3) to under seat bracket.

NOTE

- Verify fuel tank is protected when installing base. Careful to avoid contact between metallic seat base and tank.
 - Vehicles without saddlebag guard may require significant downward force while pushing seat forward during install. This will provide adequate compression of grommets for install.
8. Place seat (1) into position.
 - a. Verify seat tongue is engaged with vehicle seat bracket before pushing seat forward.
 9. Hold rear of seat approximately 76.2 mm (3 in) above fender.
 - a. Firmly push front of seat downward and forward until slot engages tongue and seat locks into place.
 10. Align seat pillion screw hole with fender hole.
 11. Press rear of seat downward until aluminum base reaches fender.
 12. Secure seat (1) to fender with seat screw (2). Tighten.
Torque: 5.4–8.1 N·m (4–6 ft-lbs)
 13. Tuck end of grab strap (4) into slot.
 - a. Secure **new** grab strap with OE screw and washer. Tighten.
Torque: 5.4–8.1 N·m (4–6 ft-lbs)
 14. Pull up on seat to verify that it is secure.

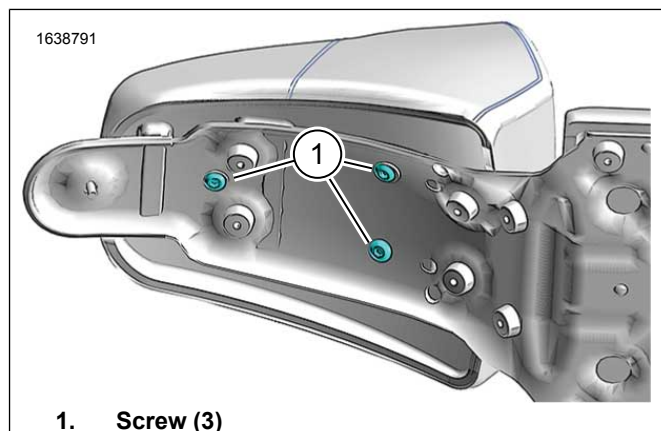

Figure 2. Pillion Screws

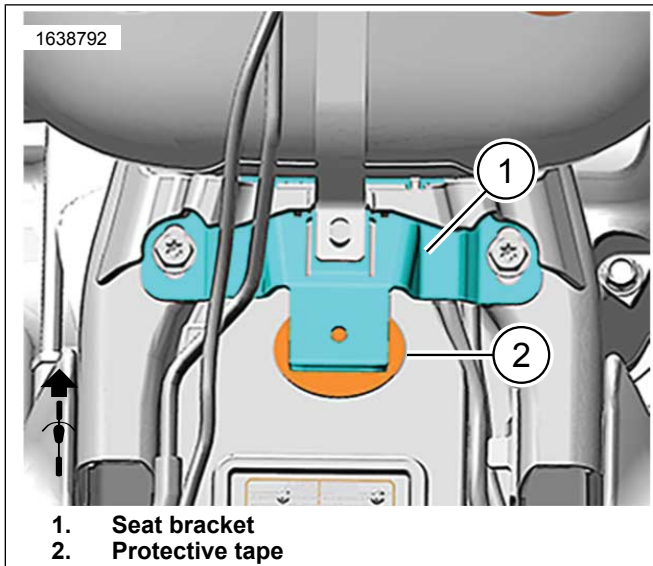

Figure 3. Protective Tape / Seat Bracket

MAINTENANCE

Aluminum seat base is raw and unfinished. To remove inconsistencies that develop over time, use 120 grit sandpaper to return to original finish. Test in an inconspicuous area before touching up prominent surfaces. Careful to follow original direction of brushing.