



INSTRUCTIONS

J05766

2022-10-17



WINDSHIELD/WIND DEFLECTOR KIT

GENERAL INFORMATION

Table 1. General Information

Kits	Suggested Tools	Skill Level ⁽¹⁾
57400204, 57400205, 57400206, 57400213, 57400224, 57400225, 57400226, 57400227, 57400228, 57400229, 57400243, 57400528	Safety Glasses, Torque Wrench	
<i>(1) Tightening to torque value or other moderate tools and techniques required</i>		

KIT CONTENTS

There are no service parts available with this kit.

GENERAL

NOTE

This instruction sheet **may have a Supplemental Video** to assist installer in clarifying a certain part of the assembly. A linked video would be located at the end of this instruction sheet.

Models

For model fitment information, see the Parts and Accessories (P&A) Retail Catalog or the Parts and Accessories section of www.harley-davidson.com.

Verify that the most current version of the instruction sheet is used. It is available at: h-d.com/isheets

Contact Harley-Davidson Customer Support Center at 1-800-258-2464 (U.S. only) or 1-414-343-4056.

Installation Requirements

▲ WARNING

Rider and passenger safety depend upon the correct installation of this kit. Use the appropriate service manual procedures. If the procedure is not within your capabilities or you do not have the correct tools, have a Harley-Davidson dealer perform the installation. Improper installation of this kit could result in death or serious injury. (00333b)

NOTE

This instruction sheet references service manual information. A service manual for the year and model motorcycle is required for this installation and is available from:

- A Harley-Davidson dealer.
- H-D Service Information Portal, a subscription-based access available for most 2001 and newer models. For more information see *Frequently ask questions about subscriptions*.

REMOVE

1. See Figure 1. Loosen but do not remove three screws (1) (with flat washers) securing windshield/wind deflector to fairing.
2. Raise and remove windshield/wind deflector.

INSTALL

1. See Figure 1. Place the windshield/wind deflector into position between inner and outer fairings engaging the slotted holes in the windshield/wind deflector with the threaded bosses on the inner fairing.
2. Tighten three screws (1).
Torque: 2.8–3.4 N·m (25–30 in-lbs)

COMPLETE

▲ WARNING

Failure to provide adequate clearance between stationary and moving parts can cause loss of control, which could result in death or serious injury. (00378a)

NOTE

Check mounting hardware periodically. Never ride with loose mounts. A loose mount can cause extra stress on other mounts, as well as the windshield itself and could result in premature failure of components.

1. Install windshield. See owner's manual.
2. Inspect windshield upon completion of installation.
 - a. Be sure windshield mounting does not restrict full left or full right movement of front fork assembly.
 - b. If restriction does occur, adjust windshield as needed until proper clearance is obtained.



MAINTENANCE

Care and Cleaning

NOTICE

Polycarbonate windshields/wind deflectors require proper attention and care to maintain. Failure to maintain polycarbonate properly can result in damage to the windshield/wind deflector. (00483e)

- Do not use benzene, paint thinner, gasoline or any other type of harsh cleaner on the windshield/wind deflector. Doing so will damage the surface.
- Do not clean polycarbonate in hot sun or high temperature.
- Powdered, abrasive or alkaline cleanser will damage the windshield/wind deflector.
- Sunlight reflections off of the inside curvature of a windshield/wind deflector can, at certain times of the day, cause extreme heat build-up on motorcycle instruments. Exercise care in parking. Park facing the sun, place an opaque object over the instruments, or adjust the windshield/wind deflector to avoid reflections.

See owner's manual for a full list of care and cleaning instructions and products approved for use on Harley-Davidson windshield/wind deflectors.

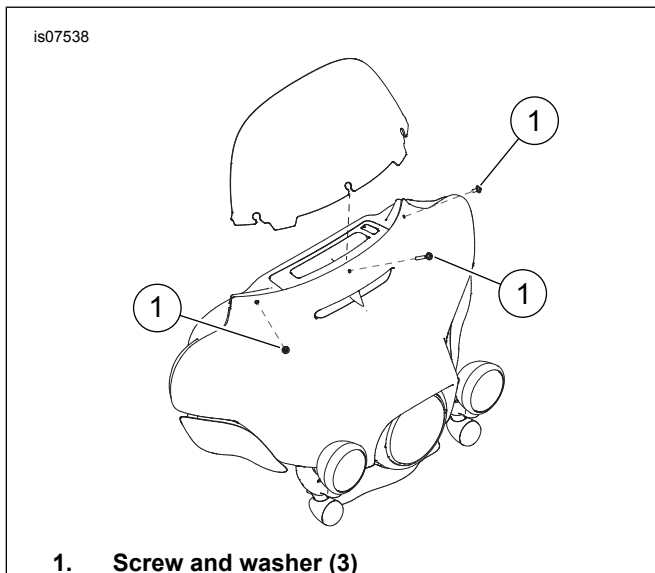

Figure 1. Windshield/Wind Deflector Installation