



INSTRUCTIONS

J05808

2024-01-23



TIE-DOWN BRACKETS FOR TOURING

GENERAL INFORMATION

Table 1. General Information

Kits	Suggested Tools	Skill Level ⁽¹⁾
93500011, 93500030	Safety Glasses, Torque Wrench	

(1) Tightening to torque value or other moderate tools and techniques required

KIT CONTENTS

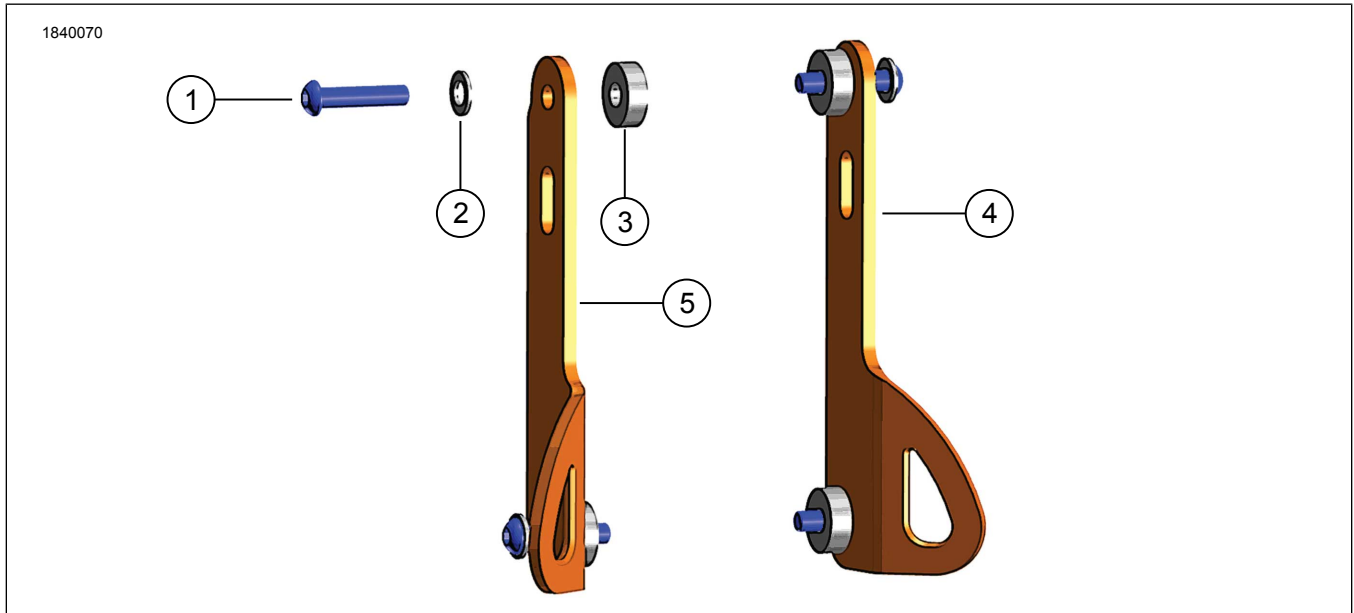

Figure 1. Kit Contents: Tie-Down Brackets

Table 2. Kit Contents: Tie-Down Bracket Kit

Verify that all contents are present in the kit before installing or removing items from vehicle.					
<input checked="" type="checkbox"/>	Item	Qty	Description	Part No.	Notes
<input type="checkbox"/>	1	4	Screw	3140	
<input type="checkbox"/>	2	4	Washer	6702	
<input type="checkbox"/>	3	4	Spacer	12400240	
<input type="checkbox"/>	4	1	Tie-down bracket, right	Not sold separately	
<input type="checkbox"/>	5	1	Tie-down bracket, left	Not sold separately	

GENERAL

Models

For model fitment information, see the Parts and Accessories (P&A) Retail Catalog or the Parts and Accessories section of www.harley-davidson.com.

Verify that the most current version of the instruction sheet is used. It is available at: h-d.com/isheets

Contact Harley-Davidson Customer Support Center at 1-800-258-2464 (U.S. only) or 1-414-343-4056.



Installation Requirements

⚠ WARNING

Rider and passenger safety depend upon the correct installation of this kit. Use the appropriate service manual procedures. If the procedure is not within your capabilities or you do not have the correct tools, have a Harley-Davidson dealer perform the installation. Improper installation of this kit could result in death or serious injury. (00333b)

NOTE

This instruction sheet references service manual information. A service manual for the year and model motorcycle is required for this installation and is available from:

- A Harley-Davidson dealer.
- H-D Service Information Portal, a subscription-based access available for most 2001 and newer models. For more information see *Frequently ask questions about subscriptions*.

PREPARE

1. Remove main fuse. See service manual.

REMOVE

1. Remove Original Equipment (OE) acorn nuts, screws and upright bar.
 - a. Retain upright bar and discard acorn nuts and screws.
2. Disconnect turn signal.

INSTALL

FLHTCU/FLHTK/FLHX/FLHXS:

NOTE

Tie down brackets are side specific. Brackets install with tie-down slots to the rear, angling outward and down.

1. See Figure 2. Route OE turn signal wire through slot on **new** tie-down bracket (1).
2. Connect turn signal.
3. See Figure 2. Install tie-down bracket (1), OE upright bar (A) with turn signal, spacers (4), screws (2) and washers (3).
4. Tighten screws.
Torque: 8–12 N·m (71–106 **in-lbs**)
5. Tighten screws once more.
Torque: 20–24 N·m (177–212 **in-lbs**)
6. Repeat steps on opposite side.

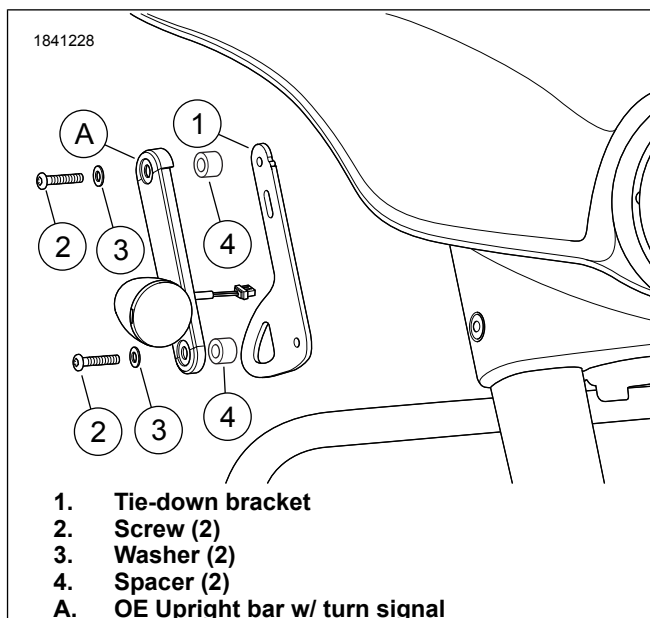

Figure 2. Tie-down Bracket Remove/Install (Right side shown)

COMPLETE

1. Install main fuse. See service manual.