



INSTRUCTIONS

J05414

2024-01-24



MIRROR KITS

GENERAL INFORMATION

Table 1. General Information

Kits	Suggested Tools	Skill Level ⁽¹⁾
91315-04, 91657-02, 91696-05A, 91697-06A, 91965-98, 92096-05, 92190-06, 92398-09, 92410-09, 92416-08, 92423-08, 92441-10, 56000006, 56000090, 56000135, 56000136, 56000137, 56000171, 56000262, 56000294, 56000301, 56000305, 56000343, 56000344	Safety Glasses, Torque Wrench	
<i>(1) Tightening to torque value or other moderate tools and techniques required</i>		

KIT CONTENTS

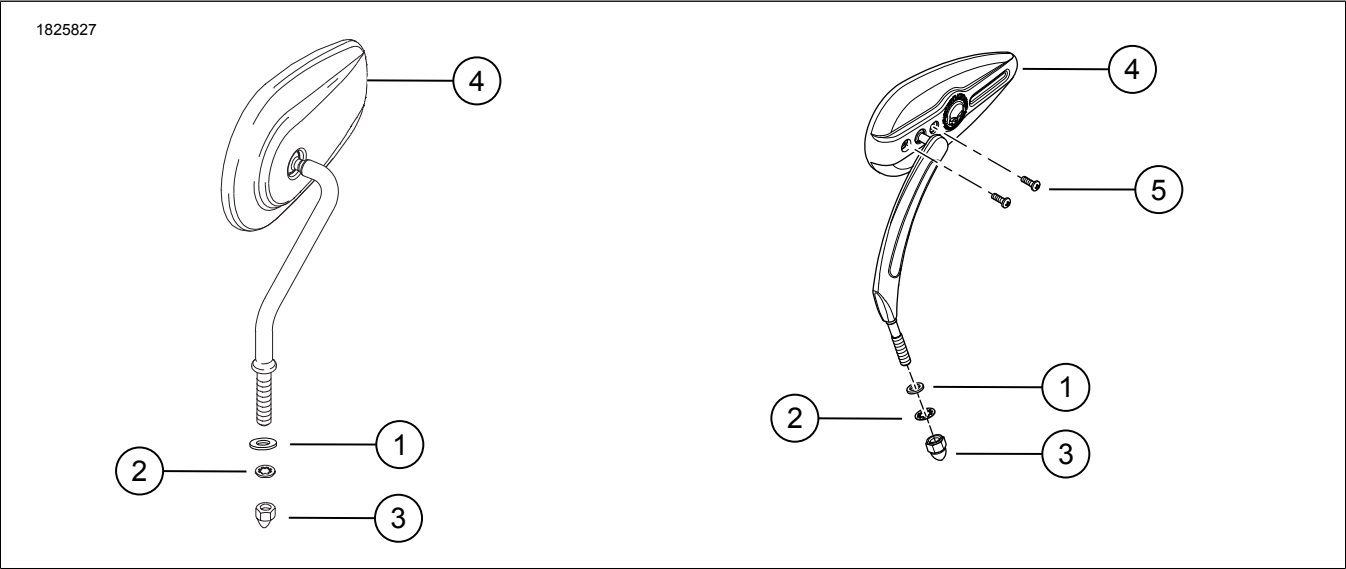

Figure 1. Kit Contents: Mirror Kits

Table 2. Kit Contents: Mirror Kits

Verify that all contents are present in the kit before installing or removing items from vehicle.					
<input checked="" type="checkbox"/>	Item	Qty	Description	Part No.	Notes
<input type="checkbox"/>	1	4	Flat washer	6771A (silver) 6926 (black)	For all other kits
<input type="checkbox"/>		2	Flat washer, black	12404 (black)	Kits 56000135, 56000171, 56000294, 5600305
<input type="checkbox"/>	2	2	Lockwasher	7127 (silver) 7155 (black)	
<input type="checkbox"/>				7155	Kit 56000301
<input type="checkbox"/>	3	2	Acorn nut	7736 (silver) 8196 (black)	
<input type="checkbox"/>				7331 (silver)	Kit 56000301
<input type="checkbox"/>				7352 (black)	Kits 56000135, 56000294, 56000305
<input type="checkbox"/>				10400082 (black)	Kits 56000343, 56000344
<input type="checkbox"/>	4	1	Mirror, left / right	Not sold separately	Kits 91315-04 (Willie G Skull, Chrome), 91965-98 (Aluminator), 92190-06 (Split Vision), 92398-09 (Tribal Black), 92410-09 (Tribal, Chrome), 92441-10 (Edge Cut Stem), 56000006 (Slipstream), 56000090 (Edge Cut Dome), 56000171 (Willie G Skull, Blk)
<input type="checkbox"/>			Mirror, left Mirror, right	91928-03 91927-03	Kit 91657-02 (Bullet)
<input type="checkbox"/>			Mirror, left Mirror, right	92176-05A 92175-05A	Kit 91696-05A (Tailfin)
<input type="checkbox"/>			Mirror, left Mirror, right	92063-06A 92062-06A	Kit 91697-06A (Profile Custom)
<input type="checkbox"/>			Mirror, left Mirror, right	91949-05 91987-05	Kit 92096-05 (Buckshot Chrome)
<input type="checkbox"/>			Mirror, left Mirror, right	92417-08 92419-08	Kit 92416-08 (Buckshot Black)
<input type="checkbox"/>			Mirror, left Mirror, right	92424-08 92426-08	Kit 92423-08 (Dome Billet)
<input type="checkbox"/>			Mirror, left Mirror, right	56000125 56000126	Kit 56000135 (Airflow, Black)
<input type="checkbox"/>			Mirror, left Mirror, right	56000138 56000139	Kit 56000136 (Dominion, Black)
<input type="checkbox"/>			Mirror, left Mirror, right	56000146 56000147	Kit 56000137 (Dominion, Bronze)
<input type="checkbox"/>			Mirror, left Mirror, right	56000274 56000275	Kit 56000262 (66 Collection, Black)
<input type="checkbox"/>			Mirror, left Mirror, right	56000300 56000295	Kit 56000294 (Empire, Black)
<input type="checkbox"/>			Mirror, left Mirror, right	56000302 56000306	Kit 56000301 (Empire, Chrome)
<input type="checkbox"/>			Mirror, left Mirror, right	56000303 56000299	Kit 56000305 (Empire, Black Edge Cut)
<input type="checkbox"/>			Mirror, left Mirror, right	56000372 56000370	Kit 56000343 (Switchback, Black)
<input type="checkbox"/>			Mirror, left Mirror, right	56000373 56000371	Kit 56000344 (Switchback, Silver)
<input type="checkbox"/>	5	2	Adjustment screw	Not sold separately	

GENERAL

Models

For model fitment information, see the Parts and Accessories (P&A) Retail Catalog or the Parts and Accessories section of www.harley-davidson.com.

Verify that the most current version of the instruction sheet is used. It is available at: h-d.com/isheets

Contact Harley-Davidson Customer Support Center at 1-800-258-2464 (U.S. only) or 1-414-343-4056.

Installation Requirements

⚠ WARNING

Rider and passenger safety depend upon the correct installation of this kit. If the procedure is not within your capabilities or you do not have the correct tools, have a Harley-Davidson dealer perform the installation. Improper installation of this kit could result in death or serious injury. (00308b)

XG MODELS

REMOVE

1. See Figure 2. Remove mirror.
 - a. Remove mirror (1).
 - b. Remove tube nut (3).
 - c. Remove mirror mount (4).

INSTALL

1. See Figure 2. Install mirror.
 - a. Install mirror mount (4). Tighten.
Torque: 11.7–14.3 N·m (104–127 in-lbs)
 - b. Install tube nut (3) to mirror stem (2). Hand tighten.
 - c. Install mirror and tube nut to mirror mount. Hand tighten.
 - d. Adjust mirror.
 - e. Tighten tube nut.
Torque: 11.7–14.3 N·m (104–127 in-lbs)

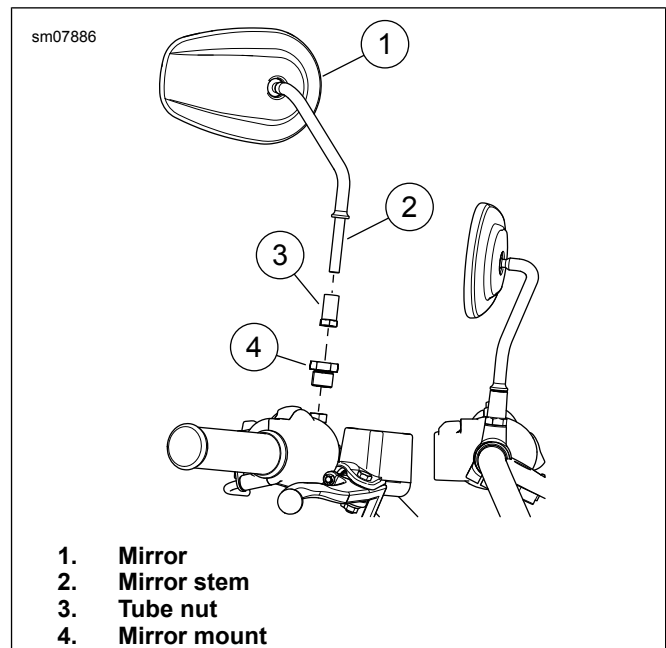

Figure 2. Mirror

ALL OTHER MODELS

REMOVE

1. Remove and discard existing mirror.
 - a. Discard any lockwashers and acorn nuts used to mount Original Equipment (OE) mirror.

INSTALL

1. See Figure 1. Install flat washer (1) on mirror stud (top position) for all mirrors except Part No. 91696-05A, 92398-09 and 92410-09.
2. **Vehicles with turn signals mounted to underside of hand lever housings (except 2004 and later XL models):** Secure left side mirror with lockwasher (2) and acorn nut (3) from kit.
3. Secure right side mirror with lockwasher (2) and acorn nut (3) from kit and turn signal retainer only.
4. **Vehicles with turn signals mounted away from hand lever housings:** Insert mirror studs into holes in hand lever housings.
 - a. Secure mirrors with flat washers (1) in top and bottom positions, lockwashers (2) and acorn nuts (3) from kit.
5. Adjust mirrors for proper field of vision and tighten. Check adjustment and reposition if necessary.

NOTE

Harley-Davidson Motor Company cannot test, and make specific fitment recommendations concerning every possible mirror, and handlebar combination. Therefore, after installing new mirrors or handlebars and before operating vehicle, check that mirrors provide operator a clear view to the rear.

- a. Tighten acorn nut (3).
Torque: 14–16 N·m (10–12 ft-lbs)

Mirror Pivot Adjustment

1. **Kits 56000136, 56000137, 56000171: Adjust pivot tension.**
 - a. See Figure 1. Incrementally torque adjustment screws (5) as required. Tighten.
Torque: 1.1–4 N·m (10–35 **in-lbs**)
 - b. Check mirror pivot resistance and continue to torque as needed. **Do not exceed 35 in-lbs.**