



# INSTRUCTIONS

94100448

2024-01-24



## LOW-PROFILE SOLO TOURING SEAT

### GENERAL INFORMATION

Table 1. General Information

Kits	Suggested Tools	Skill Level <sup>(1)</sup>
52000690, 52000691	Safety Glasses, Torque Wrench	
(1) Only simple tools and techniques required		

### KIT CONTENTS

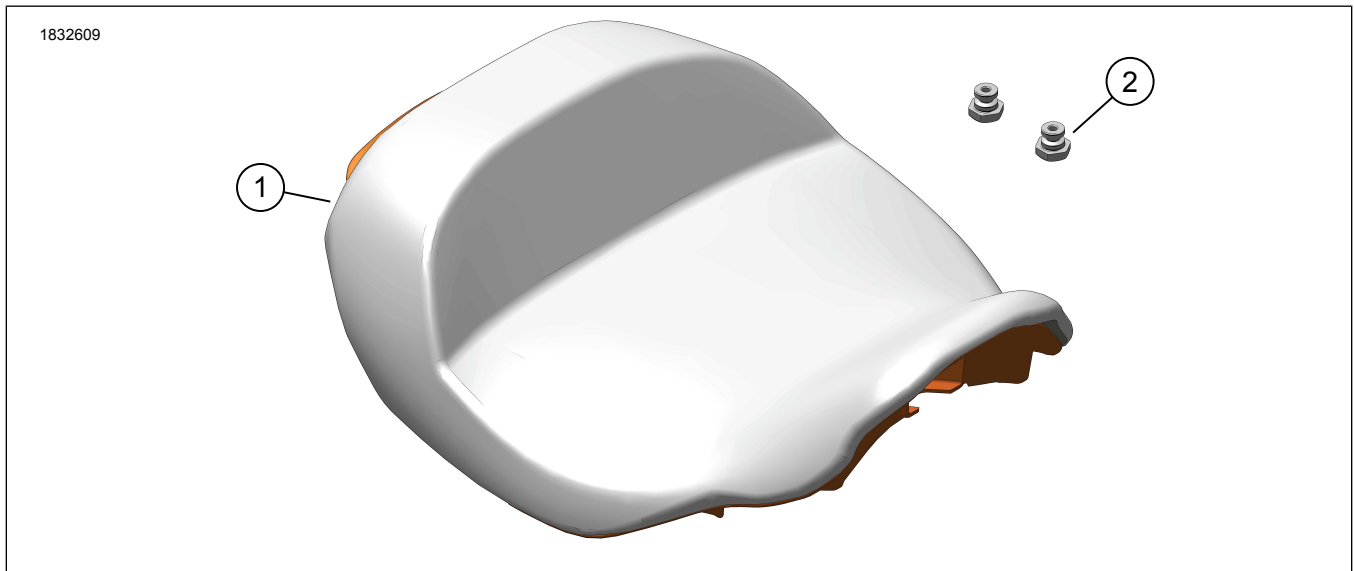

Figure 1. Kit Contents: Low-Profile Solo Touring Seat

Table 2. Kit Contents: Low-Profile Solo Touring Seat

<input checked="" type="checkbox"/>	Verify that all contents are present in the kit before installing or removing items from vehicle.				
	Item	Qty	Description	Part No.	Notes
<input type="checkbox"/>	1	1	Seat	Not sold separately	
<input type="checkbox"/>	2	2	Custom nut	10400077	

### GENERAL

#### Models

For model fitment information, see the Parts and Accessories (P&A) Retail Catalog or the Parts and Accessories section of [www.harley-davidson.com](http://www.harley-davidson.com).

Verify that the most current version of the instruction sheet is used. It is available at: [h-d.com/isheets](http://h-d.com/isheets)

Contact Harley-Davidson Customer Support Center at 1-800-258-2464 (U.S. only) or 1-414-343-4056.

### Installation Requirements

#### ⚠ WARNING

Rider and passenger safety depend upon the correct installation of this kit. Use the appropriate service manual procedures. If the procedure is not within your capabilities or you do not have the correct tools, have a Harley-Davidson dealer perform the installation. Improper installation of this kit could result in death or serious injury. (00333b)

#### NOTE

This instruction sheet references service manual information. A service manual for the year and model motorcycle is required for this installation and is available from:

- A Harley-Davidson dealer.
- H-D Service Information Portal, a subscription-based access available for most 2001 and newer models. For more information see *Frequently ask questions about subscriptions*.

## PREPARE

1. Remove Original Equipment (OE) seat. See service manual.
  - a. Remove grab strap and nuts.

## REMOVE

1. See Figure 2. Remove nuts (1).
  - a. Leave plastic retaining washers (2) installed.

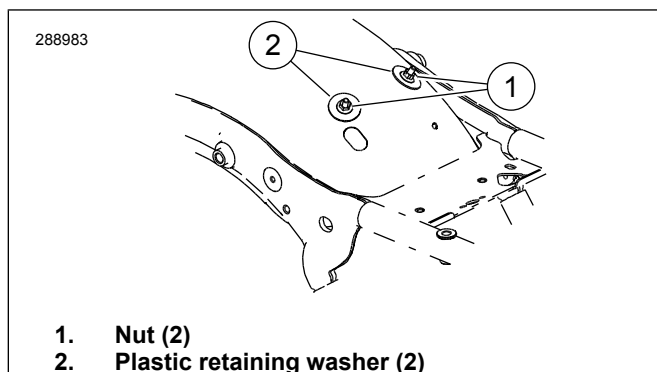

Figure 2. Plastic Retaining Washer

## INSTALL

### NOTE

- If a pillion seat kit is being installed, install passenger grab strap from that kit onto studs and under seat.
- When a solo seat is installed without a passenger seat, passenger footpegs or footboards and passenger grab strap must be removed.

1. See Figure 3. Install new solo seat (2).
  - a. Position seat until front tab engages frame and rear of seat over mounting studs.
2. Install seat custom nuts (1) onto studs.
  - a. If a pillion is not being installed, pull down flap at the rear of the seat to cover the mounting studs.

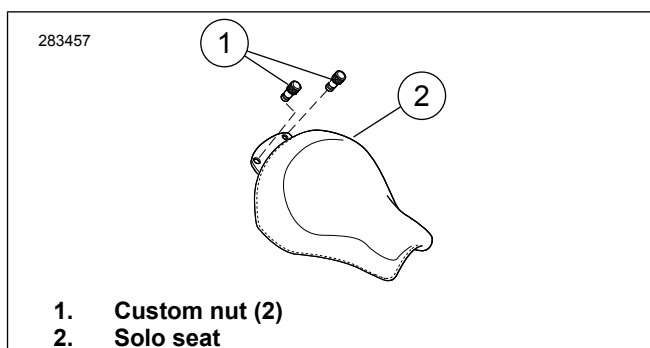

Figure 3. Solo Seat

## COMPLETE

1. After installing seat, pull upward on seat to be sure it is locked in position.