



INSTRUCTIONS

94100508

2024-01-23



OVERWATCH THROW-OVER SADDLEBAG SUPPORT

GENERAL INFORMATION

Table 1. General Information

Kits	Suggested Tools	Skill Level ⁽¹⁾
90202689	Safety Glasses, Torque Wrench	
<i>(1) Tightening to torque value or other moderate tools and techniques required</i>		

KIT CONTENTS

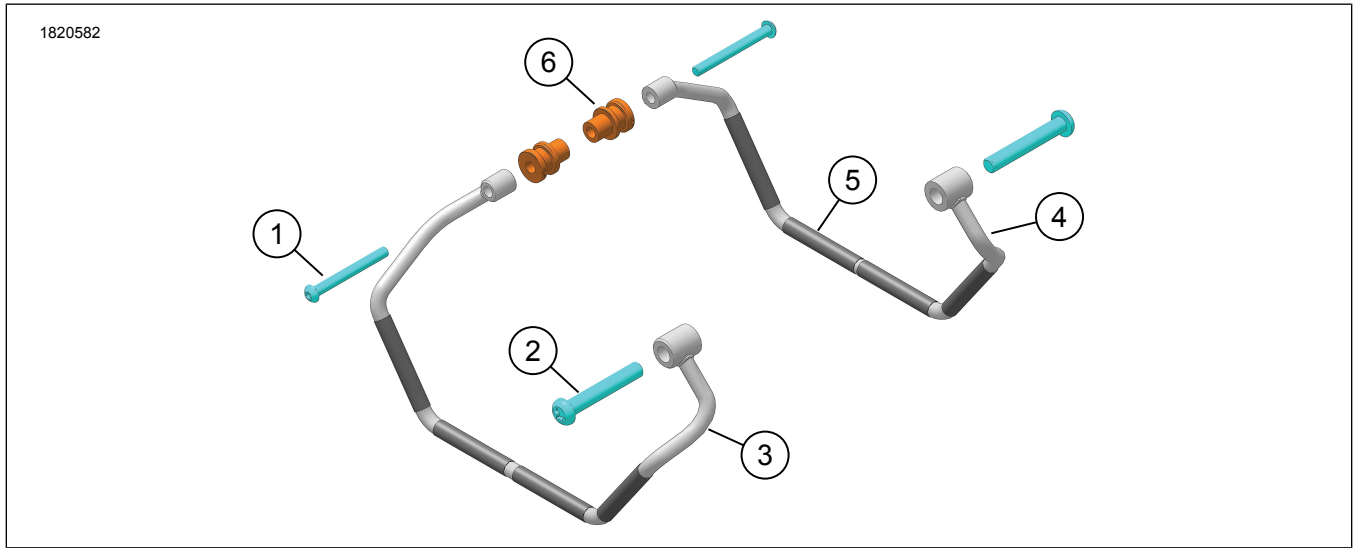

Figure 1. Kit Contents: Overwatch Throw-Over Saddlebag Support

Table 2. Kit Contents: Overwatch Throw-Over Saddlebag Support

Verify that all contents are present in the kit before installing or removing items from vehicle.					
<input checked="" type="checkbox"/>	Item	Qty	Description	Part No.	Notes
<input type="checkbox"/>	1	2	M8 Screw	10201264	
<input type="checkbox"/>	2	2	M12 Screw	10201409	
<input type="checkbox"/>	3	1	Right support	90202691	
<input type="checkbox"/>	4	1	Left support	90202690	
<input type="checkbox"/>	5	8	Protector	90202798	
<input type="checkbox"/>	6	2	Docking point	52300746	

GENERAL

Models

For model fitment information, see the Parts and Accessories (P&A) Retail Catalog or the Parts and Accessories section of www.harley-davidson.com.

Verify that the most current version of the instruction sheet is used. It is available at: h-d.com/isheets

Contact Harley-Davidson Customer Support Center at 1-800-258-2464 (U.S. only) or 1-414-343-4056.

Installation Requirements

⚠ WARNING

Rider and passenger safety depend upon the correct installation of this kit. Use the appropriate service manual procedures. If the procedure is not within your capabilities or you do not have the correct tools, have a Harley-Davidson dealer perform the installation. Improper installation of this kit could result in death or serious injury. (00333b)

NOTE

This instruction sheet references service manual information. A service manual for the year and model motorcycle is required for this installation and is available from:

- A Harley-Davidson dealer.
- H-D Service Information Portal, a subscription-based access available for most 2001 and newer models. For more information see *Frequently ask questions about subscriptions*.

PREPARE

1. Raise Rear Wheel for Service. See service manual.
 - a. Secure with tie-downs.
2. Remove main fuse. See service manual.

INSTALL

1. See Figure 2. Remove and discard rear fender screw (1).
2. Remove and discard top shock screw (2).
 - a. Support shock (3) to prevent vehicle damage.
3. See Figure 3. Position right support (4) and shock.
4. Loosely install M12 screw (3).
5. Position docking point (2) and right support (4).
6. Loosely install M8 screw (1).
7. Adjust assembly as needed.
8. Tighten M12 screw (3).
Torque: 61–68 N·m (45–50 ft-lbs) *M12 Screw*
9. Tighten M8 screw (1).
Torque: 15–18.5 N·m (11–14 ft-lbs) *M8 Screw*
10. Install protector.
 - a. Spread open slit on protector (5).
 - b. Install protector (5) onto saddlebag support as shown.
11. Repeat procedure on opposite side.

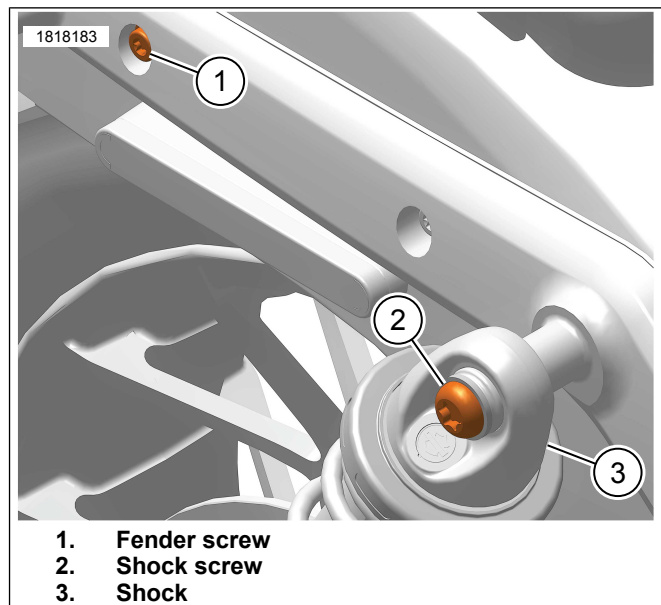

Figure 2. OE Components

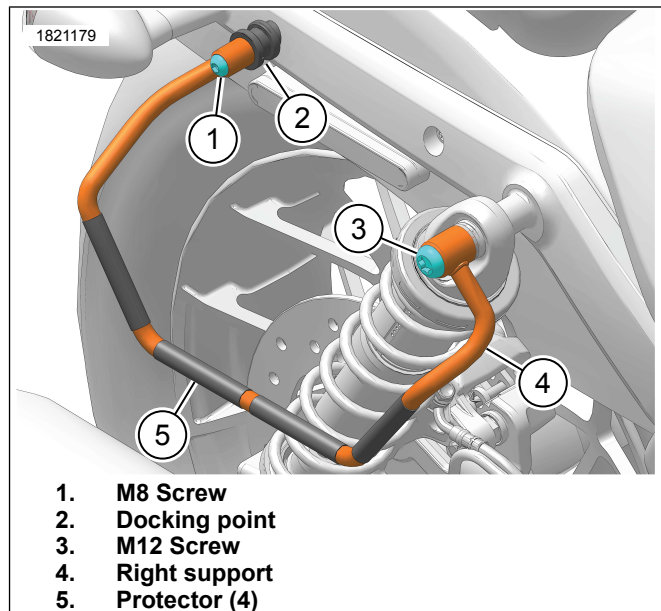

Figure 3. Saddlebag Support

COMPLETE

1. Install main fuse. See service manual.